

June 2, 2020

STATE OF RHODE ISLAND AND PROVIDENCE PLANTATION
DEPARTMENT OF ADMINISTRATION

DIVISION OF PURCHASES BID NO. 7602854

RHODE ISLAND DEPARTMENT OF TRANSPORTATION

RHODE ISLAND CONTRACT NO.2020-CH-019

FEDERAL-AID PROJECT NO. FAP Nos: BHO-0185(001), NHP-0005(030)

Rt 5 - Lambert Lind Hwy C-1 (Mayfield Ave - I-95)

Mayfield Avenue to Interstate 95 Bridge

CITY/TOWN OF Cranston, Warwick

COUNTY OF PROVIDENCE, KENT

NOTICE TO PROSPECTIVE BIDDERS

ADDENDUM NO. 5 Prospective bidders and all concerned are hereby notified of the following changes in the Plans, Specifications, Proposal and Distribution of Quantities for this contract. These changes shall be incorporated in the Plans, Specifications, Proposal and Distribution of Quantities, and shall become an integral part of the Contract Documents.

A. Clarification

1. General

A further clarification to all Bidders using Quest Lite software: If you have imported Addendum 1 - 4 bid files you must delete these files from your Quest Lite software and import the Addendum 5 bid file only.

B. Contract Documents

1. Specifications - Job Specific

a. Index Pages ii thru iii

Delete Index Pages ii thru iii in their entirety and insert the revised Index Pages ii thru iii (R-2) attached to this Addendum No. 5. The revisions made on this page are as follows:

- Items L06.9903, L06.9907, L06.9910, L06.9911, L06.9920 thru L06.9923 sizes were updated.

- Item L06.9913 description and size was updated.

- Item L06.9924 was added to the Contract.

b. Page JS-90

Delete Page JS-90 in its entirety and insert the revised Page JS-90 (R-2) attached to this Addendum No. 5. The revisions made on this page are as follows:

- Items L06.9903, L06.9907, L06.9910, L06.9911, L06.9920 thru L06.9923 sizes were updated.
- Item L06.9913 description and size was updated.
- Item L06.9924 was added to the Contract.

c. Pages JS-98 thru 99

Delete Pages JS-98 thru 99 in their entirety and insert the revised Pages JS-98 thru 99 (R-2) attached to this Addendum No. 5. The revisions made on this page are as follows:

- Method of Measurement section was updated.
- Basis of Payment section was updated.

C. Distribution of Quantities

1. Index Page 3

Delete Index Page 3 in its entirety and insert the revised Index Page 3 (R-2) attached to this Addendum No. 5. The revisions made on this page are as follows:

- Items L06.9903, L06.9907, L06.9910, L06.9911, L06.9920 thru L06.9923 sizes were updated.
- Item L06.9913 description and size was updated.

2. Index Page 6

Delete Index Page 6 in its entirety and insert the revised Index Page 6 (R-3) attached to this Addendum No. 5. The revisions made on this page are as follows:

- Item L06.9924 Maple - 'Red Sunset' 2.5-3 Inch Caliper was added to the Contract.

3. Page 4

Delete Page 4 in its entirety and insert the revised Page 4 (R-2) attached to this Addendum No. 5. The revisions made on this page are as follows:

- Item No. 012, Item Code 201.9901 Demolition and Site Preparation

4. Pages 32 thru 34, 35a, and 36

Delete Pages 32 thru 34, 35a, and 36 in its entirety and insert the revised Pages 32 thru 34 (R-2), 35a (R-1), and 36 (R-2) attached to this Addendum No. 5. The revisions made on these pages are as follows:

- Item No. 128, Item Code L06.9903 Tupelo – ‘Wildfire’ 1.5-2 Inch Caliper
- Item No. 132, Item Code L06.9907 Spruce – ‘Colorado Blue’ 6-7 Feet
- Item No. 133, Item Code L06.9908 Arborvitae – ‘Green Giant’ 6-7 Feet
- Item No. 136, Item Code L06.9910 American Arborvitae – ‘Skinner Dwarf’ 3-4 Feet
- Item No. 137, Item Code L06.9911 Whitespire Birch – ‘Whitespire’ 7-8 Feet Clump
- Item No. 139, Item Code L06.9913 London Plantree 3-3.5 Inch Caliper
- Item No. 146, Item Code L06.9920 Dwarf Maiden Grass – ‘Yakushima’ 1 Gal.
- Item No. 147, Item Code L06.9921 Weigela – ‘Wine and Rose’ 24-36 Inch
- Item No. 148, Item Code L06.9922 Lilac Tree – ‘Anthony Waterer’ 24-36 Inch
- Item No. 149, Item Code L06.9923 Daylily – ‘Happy Returns’ 1 Gal.

5. Page 59

Delete Page 59 in its entirety and insert the revised Page 59 (R-1) attached to this Addendum No. 5. The item added on this page is as follows:

- Item No. 247, Item Code L06.9924 Maple – ‘Red Sunset’ 2.5-3 Inch Caliper

D. Drawings/Plans - Change/Addition

1. Volume 1 - F.A. Project No. NHP-0005(030)

a. Sheets 86 thru 89 - Landscape Plan Nos. 1 thru 3 and Landscape Details

Delete Sheets 86 thru 89 in their entirety and insert the revised Sheets 86 (R-1), 87 (R-2), 88 (R-1), and 89 (R-2) attached to this Addendum No. 5.

E. Other Item Changes

1. 201.9901 - DEMOLITION AND SITE PREPARATION

Quantity Updated to "100000.00". Only Acceptable Bid Price of "\$1.00" Added.

2. 401.9901 - PAY ADJUSTMENTS

Only Acceptable Bid Price of "\$1.00" Added.

3. L06.9903 - TUPELO - 'WILDFIRE' 1.5-2 INCH CALIPER

Description Updated To "TUPELO - 'WILDFIRE' 1.5-2 INCH CALIPER".

4. L06.9907 - SPRUCE - 'COLORADO BLUE' 6-7 FEET
Description Updated To "SPRUCE - 'COLORADO BLUE' 6-7 FEET".
5. L06.9908 - ARBORVITAE - 'GREEN GIANT' 6-7 FEET
Quantity Updated To "20.00".
6. L06.9910 - AMERICAN ARBORVITAE - 'SKINNER DWARF' 3-4 FEET
Description Updated To "AMERICAN ARBORVITAE - 'SKINNER DWARF' 3-4 FEET".
7. L06.9911 - WHITESPIRE BIRCH - 'WHITESPIRE' 7-8 FEET CLUMP
Description Updated To "WHITESPIRE BIRCH - 'WHITESPIRE' 7-8 FEET CLUMP".
8. L06.9913 - LONDON PLANTREE 3-3.5 INCH CALIPER
Description Updated To "LONDON PLANTREE 3-3.5 INCH CALIPER".
9. L06.9920 - DWARF MAIDEN GRASS - 'YAKUSHIMA' 1 GAL.
Description Updated To "DWARF MAIDEN GRASS - 'YAKUSHIMA' 1 GAL.".
10. L06.9921 - WEIGELA - 'WINE AND ROSE' 24-36 INCH
Description Updated To "WEIGELA - 'WINE AND ROSE' 24-36 INCH".
11. L06.9922 - LILAC TREE - 'ANTHONY WATERER' 24-36 INCH
Description Updated To "LILAC TREE - 'ANTHONY WATERER' 24-36 INCH".
12. L06.9923 - DAYLILY - 'HAPPY RETURNS' 1 GAL.
Description Updated To "DAYLILY - 'HAPPY RETURNS' 1 GAL.".
13. L06.9924 - MAPLE - 'RED SUNSET' 2.5-3 INCH CALIPER
Quest Item Added. Quantity Updated To "6.00".

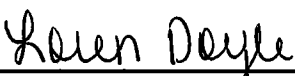
for: 
RI Department of Transportation
Administrator, Division of Project Management

A. CLARIFICATION (No Attachments)

B. CONTRACT DOCUMENTS

703.9902	Install 6 Inch Sanitary Force Main Sewer Pipe	JS-47
800.9901	Route 5 Bridge No. 0185	JS-53
803.0100	Remove and Dispose Existing Superstructure	JS-54
803.0200	Remove and Dispose Existing Substructure	
803.9901	Galvanic Encapsulation System	JS-56
805.9901	Temporary Earth Retaining Systems	JS-60
808.9901	Ultra High-Performance Concrete (UHPC) Link Slab	JS-62
901.9901	Guardrail Steel Beam Single Face – Test Level 3 (MASH)	JS-68
901.9902	Trailing End Anchorage Section for Guardrail (MASH)	JS-69
901.9903	Guardrail Transition (MASH) to Existing Guardrail	JS-70
905.9901	Exposed Aggregate Concrete Sidewalk	JS-71
905.9902	Permeable Pavers	JS-73
905.9903	Brick Walk Removed and Relaid	JS-75
906.9910	Curbing and Sidewalks	JS-76
916.9901	Temporary Traffic Control for Rehabilitation of Bridge No. 185	JS-78
917.9901	Remove and Reset USPS Mailbox	JS-81
920.9901	Concrete Filled Grout Bags for Scour	JS-82
937.1000	Maintenance and Movement Traffic Protection	JS-86
938.1000	Price Adjustments	JS-87
945.0200	Remove and Salvage Traffic Signal Equipment	JS-88
L02.1000	Seeding	JS-89
L06.9901	Amelanchier – ‘Autumn Brilliance’ 2-2.5 Inch Caliper	JS 90
L06.9902	Maple – ‘October Glory’ 2-2.5 Inch Caliper	
L06.9903	Tupelo – ‘Wildfire’ 1.5-2 Inch Caliper	
L06.9904	Spruce – ‘Hoopsi Blue’ 5-6 Feet	
L06.9905	Spruce – ‘Hoopsi Blue’ 7-8 Feet	
L06.9906	Spruce – ‘Hoopsi Blue’ 8-10 Feet	

L06.9907	Spruce – ‘Colorado Blue’ 6-7 Feet	
L06.9908	Arborvitae – ‘Green Giant’ 6-7 Feet	
L06.9909	Arborvitae – ‘Emerald Green’ 8-10 Feet	
L06.9910	American Arborvitae – ‘Skinner Dwarf’ 3-4 Feet	
L06.9911	Whitespire Birch – ‘Whitespire’ 7-8 Feet Clump	
L06.9912	American Redbud 2-2.5 Inch Caliper	
L06.9913	London Plantree 3-3.5 Inch Caliper	
L06.9914	Lilac Tree – ‘Ivory Silk’ 2-2.5 Inch Caliper	
L06.9915	Azalea – ‘Pink & Sweet’ 18-24 Inch	
L06.9916	Arctic Fire Red Twig Dogwood – ‘Farrow’ 3-4 Feet	
L06.9917	Winterberry – ‘Jim Dandy’ 18-24 Inch	
L06.9918	Winterberry – ‘Red Sprite’ 24-36 Inch	
L06.9919	Double Knockout Rose – ‘Radtko’ 24-36 Inch	
L06.9920	Dwarf Maiden Grass – ‘Yakushima’ 1 Gal.	
L06.9921	Weigela – ‘Wine and Rose’ 24-36 Inch	
L06.9922	Lilac Tree – ‘Anthony Waterer’ 24-36 Inch	
L06.9923	Daylily – ‘Happy Returns’ 1 Gal.	
L06.9924	Maple – ‘Red Sunset’ 2.5-3 Inch Caliper	
L15.9901	Decorative Crushed Stone	JS-110
L15.9902	Decorative Boulders	JS-111
T01.9901	National Grid Precast Concrete Manhole	JS-112
T01.9902	National Grid 8-5” PVC Conduit	JS-118
T01.9903	National Grid Bridge-Mounted Fiberglass Conduit	JS-132
T04.9901	Video Detection System Cable	JS-136
T13.9901	Video Detection Camera	
T13.9902	Video Detection System Hardware	
T04.9902	19 AWG 6 Pair Twisted Shielded Communication Cable 300V	JS-140
T11.9901	45 Foot Standard Load Steel Curved Traffic Signal Mast Arm, Pole and Foundation Std. 19.2.0 (Gloss Black)	JS-141
T11.9902	Dual Curved Mast Arm (25x35) Galvanized Steel Traffic Signal Post and Foundation Std. 19.2.0 (Gloss Black)	
T11.9903	30 Foot Standard Load Steel Traffic Signal Mast Arm, Pole and Foundation Std. 19.2.0 (Gloss Black)	JS-143
T11.9904	40 Foot Standard Load Steel Traffic Signal Mast Arm, Pole and Foundation Std. 19.2.0 (Gloss Black)	
T11.9905	45 Foot Standard Load Steel Traffic Signal Mast Arm, Pole and Foundation Std. 19.2.0 (Gloss Black)	
T11.9906	Steel Traffic Signal Span Pole and Foundation Std. 19.3.0 (Gloss Black)	

JOB SPECIFIC

- L06.9901 AMELANCHIER – ‘AUTUMN BRILLIANCE’ 2-2.5 INCH CALIPER**
- L06.9902 MAPLE – ‘OCTOBER GLORY’ 2-2.5 INCH CALIPER**
- L06.9903 TUPELO – ‘WILDFIRE’ 1.5-2 INCH CALIPER**
- L06.9904 SPRUCE – ‘HOOPSI BLUE’ 5-6 FEET**
- L06.9905 SPRUCE – ‘HOOPSI BLUE’ 7-8 FEET**
- L06.9906 SPRUCE – ‘HOOPSI BLUE’ 8-10 FEET**
- L06.9907 SPRUCE – ‘COLORADO BLUE’ 6-7 FEET**
- L06.9908 ARBORVITAE – ‘GREEN GIANT’ 6-7 FEET**
- L06.9909 ARBORVITAE – ‘EMERALD GREEN’ 8-10 FEET**
- L06.9910 AMERICAN ARBORVITAE – ‘SKINNER DWARF’ 3-4 FEET**
- L06.9911 WHITESPIRE BIRCH – ‘WHITESPIRE’ 7-8 FEET CLUMP**
- L06.9912 AMERICAN REDBUD 2-2.5 INCH CALIPER**
- L06.9913 LONDON PLANTREE 3-3.5 INCH CALIPER**
- L06.9914 LILAC TREE – ‘IVORY SILK’ 2-2.5 INCH CALIPER**
- L06.9915 AZALEA – ‘PINK & SWEET’ 18-24 INCH**
- L06.9916 ARCTIC FIRE RED TWIG DOGWOOD – ‘FARROW’ 3-4 FEET**
- L06.9917 WINTERBERRY – ‘JIM DANDY’ 18-24 INCH**
- L06.9918 WINTERBERRY – ‘RED SPRITE’ 24-36 INCH**
- L06.9919 DOUBLE KNOCKOUT ROSE – ‘RADTKO’ 24-36 INCH**
- L06.9920 DWARF MAIDEN GRASS – ‘YAKUSHIMA’ 1 GAL.**
- L06.9921 WEIGELA – ‘WINE AND ROSE’ 24-36 INCH**
- L06.9922 LILCA TREE – ‘ANTHONY WATERER’ 24-36 INCH**
- L06.9923 DAYLILY – ‘HAPPY RETURNS’ 1 GAL.**
- L06.9924 MAPLE – ‘RED SUNSET’ 2.5-3 INCH CALIPER**

If in the Engineer's opinion, plant materials and/or workmanship is deficient, acceptance will not be granted, and the Maintenance Period for all the plants shall be extended until plant replacements are made or other deficiencies are corrected. All dead and unsatisfactory plants shall be removed promptly from the project. Replacement plants shall conform in all respects to the Specifications for the original plants and shall be planted in the same manner.

Establishment Period: One Year

The purpose of the Establishment Period is to nurture plants through at least one full growing season and one full winter. All plants shall be inspected by the Engineer one year after Conditional Acceptance and shall be alive and in satisfactory growth at the end of that time. The Contractor is responsible for arranging inspection early enough in the season to allow adequate time to procure and install replacement material.

At the end of the Establishment Period, each plant shall show healthy growth on at least 75 percent of its terminal stems, as determined by the Engineer. Determination of healthy growth shall include, but is not necessarily limited to, viable leaves (in season) and terminal buds, as well as live cambium. Plants found to be unacceptable shall be removed promptly from the site and replaced immediately or during the next normal planting season, as permitted by the specifications.

Planted areas shall be free of weeds and debris, and plantings shall be re-mulched as necessary. The Engineer will inspect the replacement planting work upon the request of the Contractor. Request for inspection, shall be received by the Engineer at least ten days before the anticipated date of inspection.

Stakes and guying, if any, shall be removed from all plants before Final Acceptance.

Upon acceptance of the work of replacement planting, the Engineer shall issue a written Certificate of Final Acceptance for all plants installed under this Section to the Contractor.

METHOD OF MEASUREMENT. “Amelanchier – ‘Autumn Brilliance’ 2-2.5 inch Caliper”, “Maple – ‘October Glory’ 2-2.5 Inch Caliper”, “Tupelo – ‘Wildfire’ 1.5-2 Inch Caliper”, “Spruce – ‘Hoopsi Blue’ 5-6 Feet”, “Spruce – ‘Hoopsi Blue’ 7-8 Feet”, “Spruce – ‘Hoopsi Blue’ 8-10 Feet”, “Spruce – ‘Colorado Blue’ 6-7 Feet”, “Arborvitae – ‘Green Giant’ 6-7 Feet”, “Arborvitae – ‘Emerald Green’ 8-10 Feet”, “American Arborvitae – ‘Skinner Dwarf’ 3-4 Feet”, “Whitespire Birch – ‘Whitespire’ 7-8 Feet Clump”, “American Redbud 2-2.5 Inch Caliper”, “London Plantree 3-3.5 Inch Caliper”, “Lilac Tree – ‘Ivory Silk’ 2-2.5 Inch Caliper, “Azalea – ‘Pink & Sweet’ 18-24 Inch”, “Arctic Fire Red Twig Dogwood – ‘Farrow’ 3-4 Feet”, “Winterberry – ‘Jim Dandy’ 18-24 Inch”, “Winterberry – ‘Red Sprite’ 24-36 Inch”, “Double Knockout Rose – ‘Radtko’ 24-36 Inch”, “Dwarf Maiden Grass – ‘Yakushima’ 1 Gal.”, “Weigela – ‘Wine and Rose’ 24-36 Inch”, “Lilac Tree – ‘Anthony Waterer’ 24-36 Inch”, “Daylily – ‘Happy Returns’ 1 Gal.”, and “Maple – ‘Red Sunset’ 2.5-3 Inch Caliper” shall be measured for payment by the number per "Each" for each unit installed and accepted by the Engineer.

BASIS OF PAYMENT. “Amelanchier – ‘Autumn Brilliance’ 2-2.5 inch Caliper”, “Maple – ‘October Glory’ 2-2.5 Inch Caliper”, “Tupelo – ‘Wildfire’ 1.5-2 Inch Caliper”, “Spruce – ‘Hoopsi Blue’ 5-6 Feet”, “Spruce – ‘Hoopsi Blue’ 7-8 Feet”, “Spruce – ‘Hoopsi Blue’ 8-10 Feet”, “Spruce – ‘Colorado Blue’ 6-7 Feet”, “Arborvitae – ‘Green Giant’ 6-7 Feet”, “Arborvitae – ‘Emerald Green’ 8-10 Feet”, “American Arborvitae – ‘Skinner Dwarf’ 3-4 Feet”, “Whitespire Birch – ‘Whitespire’ 7-8 Feet Clump”, “American Redbud 2-2.5 Inch Caliper”, “London Plantree 3-3.5 Inch Caliper”, “Lilac Tree – ‘Ivory Silk’ 2-2.5 Inch Caliper”, “Azalea – ‘Pink & Sweet’ 18-24 Inch”, “Arctic Fire Red Twig Dogwood – ‘Farrow’ 3-4 Feet”, “Winterberry – ‘Jim Dandy’ 18-24 Inch”, “Winterberry – ‘Red Sprite’ 24-36 Inch”, “Double Knockout Rose – ‘Radtko’ 24-36 Inch”, “Dwarf Maiden Grass – ‘Yakushima’ 1 Gal.”, “Weigela – ‘Wine and Rose’ 24-36 Inch”, “Lilac Tree – ‘Anthony Waterer’ 24-36 Inch”, “Daylily – ‘Happy Returns’ 1 Gal.”, and “Maple – ‘Red Sunset’ 2.5-3 Inch Caliper” will be paid for at their respective contract unit prices per each as listed in the Bid. The prices so-stated constitute full and complete compensation for all labor, materials, equipment, and incidentals to provide plant pit excavation, soil preparation, soil amendments, planting mix preparation, loam for planting mix, mycorrhizal fungi planting, plant protection, bark mulch including placement, watering, maintenance, disposal of unsuitable soils, and all other incidentals required for furnishing and installing the plantings in accordance with the drawings, and as directed by the Engineer.

C. DISTRIBUTION OF QUANTITIES

Table of Contents - Distribution of Quantities

Project Name - Rt 5 - Lambert Lind Hwy C-1 (Mayfield Ave - I-95)
 Estimate Name - Addendum No. 5
 R.I. Contract No. - 2020-CH-019
 FAP Nos: BHO-0185(001), NHP-0005(030)

ItemCode	Description	Page
916.9901	TEMPORARY TRAFFIC CONTROL FOR REHABILITATION OF BRIDGE NO. 185	27
917.9901	REMOVE AND RESET USPS MAILBOX	27
919.0101	TEST PITS	27
920.0085	PLACED STONE RIPRAP R-3, R-4, R-5 STANDARD 8.3.0	27
920.9901	CONCRETE FILLED GROUT BAGS FOR SCOUR	28
922.0100	TEMPORARY CONSTRUCTION SIGNS STANDARD 29.1.0 AND 27.1.1	28
923.0105	DRUM BARRICADE STANDARD 26.2.0	28
923.0125	PLASTIC PIPE TYPE III BARRICADE STANDARD 26.3.1	28
923.0200	FLUORESCENT TRAFFIC CONES STANDARD 26.1.0	28
924.0113	ADVANCE WARNING ARROW PANEL	29
925.0112	PORTABLE CHANGEABLE MESSAGE SIGN	29
929.0110	FIELD OFFICE	29
931.0110	CLEANING AND SWEEPING PAVEMENT	29
932.0100	CUTTING AND MATCHING ASPHALT	29
935.0400	REMOVING BITUMINOUS PAVEMENT BY MICRO MILLING	30
936.0100	MOBILIZATION AND DEMOBILIZATION	30
937.0200	MAINTENANCE AND MOVEMENT TRAFFIC PROTECTION	30
943.0200	TRAINEE MAN-HOURS	30
945.0200	REMOVE AND SALVAGE TRAFFIC SIGNAL EQUIPMENT	30
L01.0102	LOAM BORROW 4 INCHES DEEP	31
L02.0102	RESIDENTIAL SEEDING (TYPE 2)	31
L05.0506	JUTE MESH	31
L06.0513	WOOD CHIPS FURNISH AND SPREAD 4'' DEPTH	31
L06.9901	AMELANCHIER - 'AUTUMN BRILLIANCE' 2-2.5 INCH CALIPER	32
L06.9902	MAPLE - 'OCTOBER GLORY' 2-2.5 INCH CALIPER	32
L06.9903	** ITEM DELETED **	32
L06.9904	** ITEM DELETED **	32
L06.9903	TUPELO - 'WILDFIRE' 1.5-2 INCH CALIPER	32
L06.9904	SPRUCE - 'HOOPSI BLUE' 5-6 FEET	33
L06.9905	SPRUCE - 'HOOPSI BLUE' 7-8 FEET	33
L06.9906	SPRUCE - 'HOOPSI BLUE' 8-10 FEET	33
L06.9907	SPRUCE - 'COLORADO BLUE' 6-7 FEET	33
L06.9908	ARBORVITAE - 'GREEN GIANT' 6-7 FEET	33
L06.9911	** ITEM DELETED **	33
L06.9909	ARBORVITAE - 'EMERALD GREEN' 8-10 FEET	34
L06.9910	AMERICAN ARBORVITAE - 'SKINNER DWARF' 3-4 FEET	34
L06.9911	WHITESPIRE BIRCH - 'WHITESPIRE' 7-8 FEET CLUMP	34
L06.9912	AMERICAN REDBUD 2-2.5 INCH CALIPER	34
L06.9913	LONDON PLANTREE 3-3.5 INCH CALIPER	34
L06.9914	LILAC TREE - 'IVORY SILK' 2-2.5 INCH CALIPER	35
L06.9915	AZALEA - 'PINK & SWEET' 18-24 INCH	35
L06.9916	ARCTIC FIRE RED TWIG DOGWOOD - 'FARROW' 3-4 FEET	35
L06.9917	WINTERBERRY - 'JIM DANDY' 18-24 INCH	35
L06.9918	WINTERBERRY - 'RED SPRITE' 24-36 INCH	35
L06.9919	DOUBLE KNOCKOUT ROSE - 'RADTKO' 24-36 INCH	35
L06.9920	DWARF MAIDEN GRASS - 'YAKUSHIMA' 1 GAL.	35
L06.9921	WEIGELA - 'WINE AND ROSE' 24-36 INCH	36
L06.9922	LILAC TREE - 'ANTHONY WATERER' 24-36 INCH	36
L06.9923	DAYLILY - 'HAPPY RETURNS' 1 GAL.	36
L11.0102	TREE PLANT PROTECTION DEVICE STANDARD 51.1.0	36
L11.0103	SHRUB PLANT PROTECTION DEVICE STANDARD 51.2.0	37
L15.9901	DECORATIVE CRUSHED STONE	37
L15.9902	DECORATIVE BOULDERS	37

Table of Contents - Distribution of Quantities

Project Name - Rt 5 - Lambert Lind Hwy C-1 (Mayfield Ave - I-95)

Estimate Name - Addendum No. 5

R.I. Contract No. - 2020-CH-019

FAP Nos: BHO-0185(001), NHP-0005(030)

ItemCode	Description	Page
T16.9902	REMOVE AND STOCKPILE PRIVATE SIGN	55
T20.4506	REMOVE PAVEMENT MARKING LINE - LESS THAN OR EQUAL TO 6 INCHES WIDE	55
T20.4508	REMOVE PAVEMENT MARKING LINE - GREATER THAN 6 INCHES WIDE	56
T20.9901	EPOXY RESIN PAVEMENT MARKINGS - ALL SIZES, ALL COLORS	56
T20.9902	TEMPORARY AND PERMANENT PAVEMENT MARKINGS - WORDS, ARROWS, AND SYMBOLS	56
T20.9903	TEMPORARY PAVEMENT MARKINGS - ALL TYPES, COLORS, AND WIDTHS	56
701.0612	REINFORCED CONCRETE PIPE M 170 CLASS V 12 INCH	56
701.0615	REINFORCED CONCRETE PIPE M 170 CLASS V 15 INCH	57
701.8003	PIPE BEDDING CLASS C	57
702.0533	PRECAST CONCRETE APRON STONE 38'' STANDARD 7.1.8	57
906.0230	CEMENT CONCRETE SLOPE FACE CURB PRECAST STRAIGHT STANDARD 7.2.0	57
906.0231	CEMENT CONCRETE SLOPE FACE CURB PRECAST CIRCULAR STANDARD 7.2.0	58
920.0150	BEDDING FOR RIPRAP FS-2 STANDARD 8.3.0	58
920.0200	FILTER FABRIC FOR RIP-RAP	58
818.9901	FULL RECONSTRUCTION OF ABUTMENT JOINTS	58
818.9902	FULL RECONSTRUCTION OF PIER JOINTS	59
818.9903	FULL DEPTH DECK REMOVAL AND LINK SLAB CONSTRUCTION	59
937.9901	MAINTENANCE OF TRAFFIC BRIDGE 068101	59
L06.9924	MAPLE - 'RED SUNSET' 2.5-3 INCH CALIPER	59

Distribution of Quantities

Project Name - Rt 5 - Lambert Lind Hwy C-1 (Mayfield Ave - I-95)

Estimate Name - Addendum No. 5

R.I. Contract No. - 2020-CH-019

FAP Nos: BHO-0185(001), NHP-0005(030)

Item No.	Item Code	Description	UM	Qty.	Pay Code	Seq. No.
011	201.0610 Cont.	SIGN AND STRIPING PLANS (SS)				
		CONTINGENCY		15.00	0004	01
		SS-01		8.00	0004	01
		SS-02		16.00	0004	01
		SS-03		4.00	0004	01
		SS-04		7.00	0004	01
		SS-05		13.00	0004	01
		SS-06		7.00	0004	01
		SS-07		15.00	0004	01
		SS-09		2.00	0004	01
		SS-10		4.00	0004	01
		SS-11		3.00	0004	01
		SS-12		6.00	0004	01
Item 201.0610 Total:				100.00		
012	201.9901	DEMOLITION AND SITE PREPARATION	EACH			
		SITE PREP PLANS (SP)				
		SP-07 & SP-08		100,000.00	0004	01
Item 201.9901 Total:				100,000.00		
013	201.9902	REMOVE AND DISPOSE STONES	SY			
		SITE PREP PLANS (SP)				
		CONTINGENCY		20.00	0004	01
		SP-03		150.00	0004	01
		SP-04		90.00	0004	01
		SP-05		40.00	0004	01
Item 201.9902 Total:				300.00		
014	201.9903	REMOVE AND RELOCATE BUS SHELTER	EACH			
		GENERAL PLANS (GP)				
		GEN-01		1.00	0004	01
Item 201.9903 Total:				1.00		

Distribution of Quantities

Project Name - Rt 5 - Lambert Lind Hwy C-1 (Mayfield Ave - I-95)

Estimate Name - Addendum No. 5

R.I. Contract No. - 2020-CH-019

FAP Nos: BHO-0185(001), NHP-0005(030)

Item No.	Item Code	Description	UM	Qty.	Pay Code	Seq. No.
123	L06.0513 Cont.	GEN-02		60.00	0004	01
		GEN-03		30.00	0004	01
		GEN-04		70.00	0004	01
		GEN-05		30.00	0004	01
		GEN-11		30.00	0004	01
		GEN-12		90.00	0004	01
Item L06.0513 Total:				500.00		
124	L06.9901	AMELANCHIER - 'AUTUMN BRILLIANCE'	EACH			
		2-2.5 INCH CALIPER				
		LANDSCAPE PLANS (LA)				
		LA-03		4.00	0004	01
Item L06.9901 Total:				4.00		
125	L06.9902	MAPLE - 'OCTOBER GLORY' 2-2.5 INCH	EACH			
		CALIPER				
		LANDSCAPE PLANS (LA)				
		LA-02		1.00	0004	01
Item L06.9902 Total:				1.00		
126	L06.9903	MAPLE - 'RED SUNSET' 2.5-3 INCH	EACH			
		CALIPER				
		LANDSCAPE PLANS (LA)				
		LA-02		5.00	0004	01
		LA-03		6.00	0004	01
Item L06.9903 Total:				**DELETED**		
127	L06.9904	TULIP TREE 2.5-3 INCH CALIPER	EACH			
		LANDSCAPE PLANS (LA)				
		LA-02		1.00	0004	01
Item L06.9904 Total:				**DELETED**		
128	L06.9903	TUPELO - 'WILDFIRE' 1.5-2 INCH	EACH			

Distribution of Quantities

Project Name - Rt 5 - Lambert Lind Hwy C-1 (Mayfield Ave - I-95)

Estimate Name - Addendum No. 5

R.I. Contract No. - 2020-CH-019

FAP Nos: BHO-0185(001), NHP-0005(030)

Item No.	Item Code	Description	UM	Qty.	Pay Code	Seq. No.
128	L06.9903	Cont. CALIPER				
		LANDSCAPE PLANS (LA)				
		LA-02		2.00	0004	01
Item L06.9903 Total:				2.00		
129	L06.9904	SPRUCE - 'HOOPSI BLUE' 5-6 FEET	EACH			
		LANDSCAPE PLANS (LA)				
		LA-02		3.00	0004	01
		LA-03		5.00	0004	01
Item L06.9904 Total:				8.00		
130	L06.9905	SPRUCE - 'HOOPSI BLUE' 7-8 FEET	EACH			
		LANDSCAPE PLANS (LA)				
		LA-02		8.00	0004	01
Item L06.9905 Total:				8.00		
131	L06.9906	SPRUCE - 'HOOPSI BLUE' 8-10 FEET	EACH			
		LANDSCAPE PLANS (LA)				
		LA-03		5.00	0004	01
Item L06.9906 Total:				5.00		
132	L06.9907	SPRUCE - 'COLORADO BLUE' 6-7 FEET	EACH			
		LANDSCAPE PLANS (LA)				
		LA-02		1.00	0004	01
Item L06.9907 Total:				1.00		
133	L06.9908	ARBORVITAE - 'GREEN GIANT' 6-7 FEET	EACH			
		LANDSCAPE PLANS (LA)				
		LA-02		11.00	0004	01
		LA-03		9.00	0004	01
Item L06.9908 Total:				20.00		
134	L06.9911	ARBORVITAE - 'EMERALD GREEN' 6-7	EACH			

Distribution of Quantities

Project Name - Rt 5 - Lambert Lind Hwy C-1 (Mayfield Ave - I-95)

Estimate Name - Addendum No. 5

R.I. Contract No. - 2020-CH-019

FAP Nos: BHO-0185(001), NHP-0005(030)

Item No.	Item Code	Description	UM	Qty.	Pay Code	Seq. No.
134	L06.9911	Cont. FEET				
		LANDSCAPE PLANS (LA)				
		LA-02		20.00	0004	01
Item L06.9911 Total:				**DELETED**		
135	L06.9909	ARBORVITAE - 'EMERALD GREEN' 8-10 FEET	EACH			
		LANDSCAPE PLANS (LA)				
		LA-03		21.00	0004	01
Item L06.9909 Total:				21.00		
136	L06.9910	AMERICAN ARBORVITAE - 'SKINNER DWARF' 3-4 FEET	EACH			
		LANDSCAPE PLANS (LA)				
		LA-01		7.00	0004	01
Item L06.9910 Total:				7.00		
137	L06.9911	WHITESPIRE BIRCH - 'WHITESPIRE' 7-8 FEET CLUMP	EACH			
		LANDSCAPE PLANS (LA)				
		LA-02		7.00	0004	01
Item L06.9911 Total:				7.00		
138	L06.9912	AMERICAN REDBUD 2-2.5 INCH CALIPER	EACH			
		LANDSCAPE PLANS (LA)				
		LA-02		3.00	0004	01
Item L06.9912 Total:				3.00		
139	L06.9913	LONDON PLANTREE 3-3.5 INCH CALIPER	EACH			
		LANDSCAPE PLANS (LA)				
		LA-02		3.00	0004	01
Item L06.9913 Total:				3.00		

Distribution of Quantities

Project Name - Rt 5 - Lambert Lind Hwy C-1 (Mayfield Ave - I-95)

Estimate Name - Addendum No. 5

R.I. Contract No. - 2020-CH-019

FAP Nos: BHO-0185(001), NHP-0005(030)

Item No.	Item Code	Description	UM	Qty.	Pay Code	Seq. No.
145	L06.9919	Cont.				
				Item L06.9919 Total:	14.00	
146	L06.9920	DWARF MAIDEN GRASS - 'YAKUSHIMA' 1 EACH GAL.				

Distribution of Quantities

Project Name - Rt 5 - Lambert Lind Hwy C-1 (Mayfield Ave - I-95)

Estimate Name - Addendum No. 5

R.I. Contract No. - 2020-CH-019

FAP Nos: BHO-0185(001), NHP-0005(030)

Item No.	Item Code	Description	UM	Qty.	Pay Code	Seq. No.
146	L06.9920 Cont.	LANDSCAPE PLANS (LA)				
		LA-02		15.00	0004	01
Item L06.9920 Total:				15.00		
147	L06.9921	WEIGELA - 'WINE AND ROSE' 24-36 INCH LANDSCAPE PLANS (LA)	EACH			
		LA-01		6.00	0004	01
Item L06.9921 Total:				6.00		
148	L06.9922	LILAC TREE - 'ANTHONY WATERER' 24-36 INCH LANDSCAPE PLANS (LA)	EACH			
		LA-01		14.00	0004	01
Item L06.9922 Total:				14.00		
149	L06.9923	DAYLILY - 'HAPPY RETURNS' 1 GAL. LANDSCAPE PLANS (LA)	EACH			
		LA-01		61.00	0004	01
Item L06.9923 Total:				61.00		
150	L11.0102	TREE PLANT PROTECTION DEVICE STANDARD 51.1.0 SITE PREP PLANS (SP)	EACH			
		SP-01		2.00	0004	01
		SP-02		5.00	0004	01
		SP-03		1.00	0004	01
		SP-04		6.00	0004	01
		SP-05		3.00	0004	01
		SP-09		1.00	0004	01
		SP-11		1.00	0004	01
		SP-12		6.00	0004	01

Distribution of Quantities

Project Name - Rt 5 - Lambert Lind Hwy C-1 (Mayfield Ave - I-95)

Estimate Name - Addendum No. 5

R.I. Contract No. - 2020-CH-019

FAP Nos: BHO-0185(001), NHP-0005(030)

Item No.	Item Code	Description	UM	Qty.	Pay Code	Seq. No.
243	818.9901	Cont.				
		Item 818.9901 Total:		2.00		
244	818.9902	FULL RECONSTRUCTION OF PIER JOINTS	EACH			
		BRIDGE NO. 068101				
		BRIDGE NO. 068101		2.00	0014	02
		Item 818.9902 Total:		2.00		
245	818.9903	FULL DEPTH DECK REMOVAL AND LINK	LS			
		SLAB CONSTRUCTION				
		BRIDGE NO. 068101				
		BRIDGE NO. 068101		1.00	0014	02
		Item 818.9903 Total:		1.00		
246	937.9901	MAINTENANCE OF TRAFFIC BRIDGE	LS			
		068101				
		BRIDGE NO. 068101				
		BRIDGE NO. 068101		1.00	0014	02
		Item 937.9901 Total:		1.00		
247	L06.9924	MAPLE - 'RED SUNSET' 2.5-3 INCH	EACH			
		CALIPER				
		LANDSCAPE PLANS (LA)				
		LA-03		6.00		
		Item L06.9924 Total:		6.00		

D. DRAWINGS/PLANS – CHANGE/ADDITION

PLANT LIST - THIS SHEET ONLY

Trees				
Key	Botanical Name Common Name	Qty.	Size	Notes
AROG	<i>Acer rubrum</i> 'October Glory' October Glory Maple	1	2"-2.5" Cal.	B&B
BP	<i>Betula populifolia</i> 'Whitespire' Whitespire Birch	7	7-8' Clump	B&B
CC	<i>Cercis canadensis</i> American Redbud	3	2"-2.5" Cal.	B&B
LP	<i>Platanus x acerifolia</i> London Plantree	3	3"-3.5" cal.	B&B
NSW	<i>Nyssa sylvatica</i> 'Wildfire' Wildfire Tupelo	2	1.5" -2" Cal	B&B
PP	<i>Picea pungens</i> Colorado Blue Spruce	1	6'-7'	B&B
PPH-1	<i>Picea pungens</i> 'Hoopsii' Hoopsii Blue Spruce	3	5'-6'	B&B
PPH-2	<i>Picea pungens</i> 'Hoopsii' Hoopsii Blue Spruce	8	7'-8'	B&B
TPGG	<i>Thuja plicata</i> 'Green Giant' Green Giant Arborvitae	11	6'-7'	B&B
SHRUBS				
APS	<i>Azalea viscosum</i> 'Pink & Sweet' Pink & Sweet Azalea	27	18"-24"	Cont.
CS	<i>Cornus stolonifera</i> 'Farrow' Arctic Fire red Twig Dogwood	3	3'-4'	B&B
IVJ	<i>Ilex verticillata</i> 'Jim Dandy' Jim Dandy Winterberry	4	18"-24"	B&B
IVR	<i>Ilex verticillata</i> 'Red Sprite' Red Sprite Winterberry	17	24"-36"	Cont.
RR	<i>Rosa x 'Radtko'</i> Double Knock Out Rose	14	24"-36"	Cont.
GRASSES				
MS	<i>Miscanthus sinensis</i> 'Takushima' Dwarf Maiden Grass	15	1 Gal	Cont.

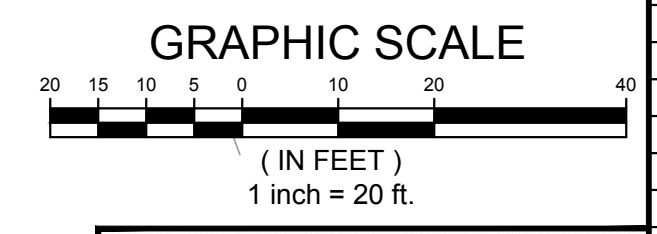
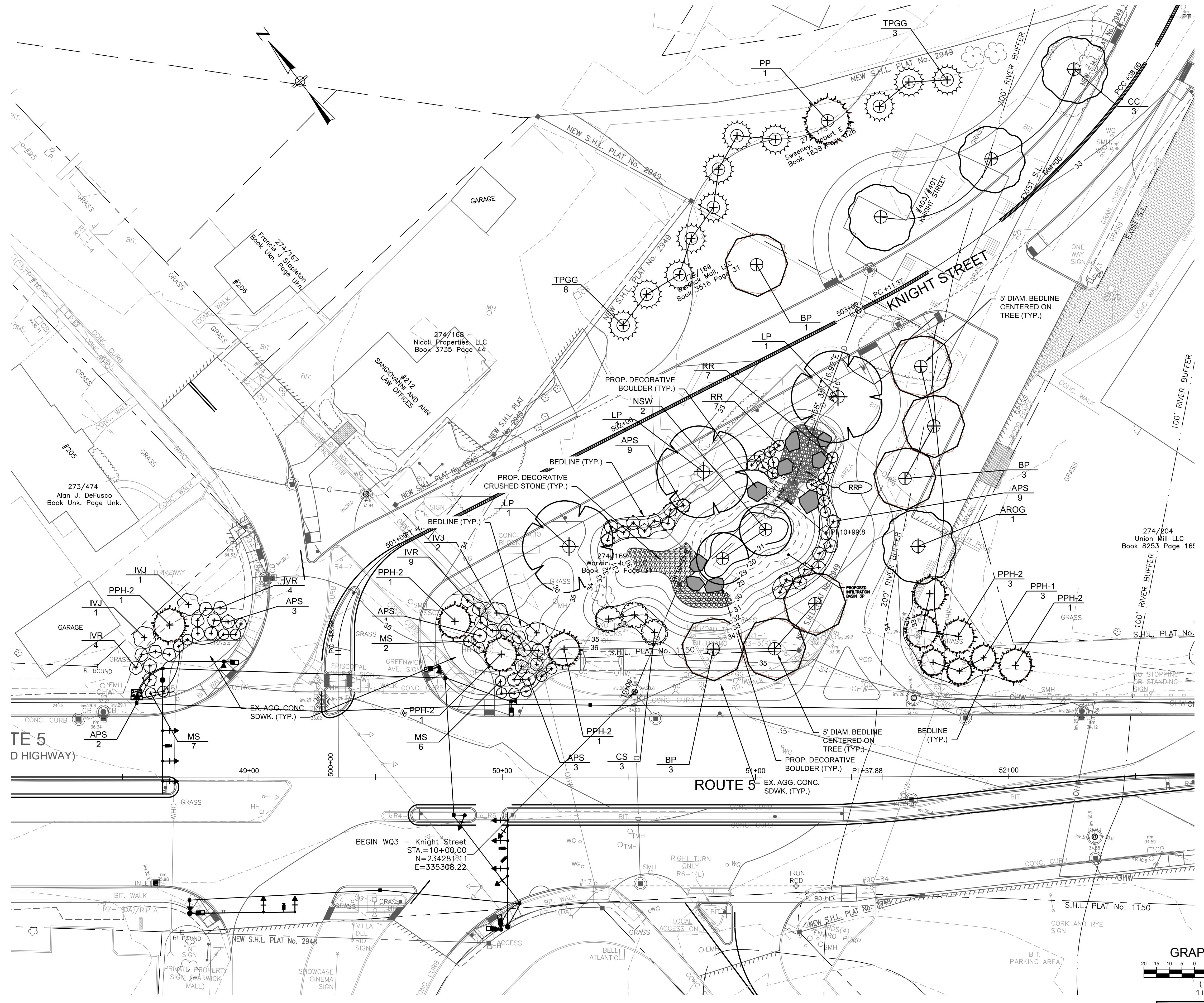

REVISIONS		
NO.	DATE	BY
1	4/20	CC
2	6/1	NS

RHODE ISLAND
DEPARTMENT OF TRANSPORTATION

**HIGHWAY IMPROVEMENTS
TO
ROUTE 5 (CONTRACT No. 1)**
WARWICK AND CRANSTON, RHODE ISLAND

LANDSCAPE PLAN No. 2

CHECKED BY _____ DATE _____ SCALE 1"=20'

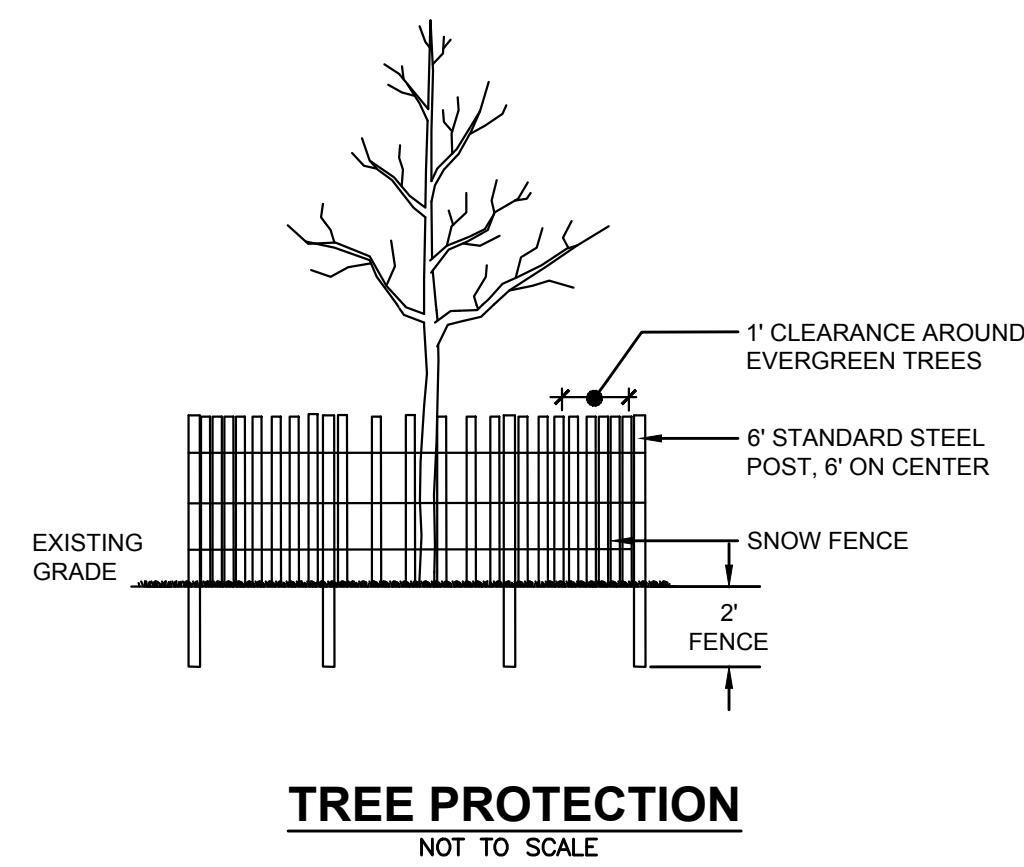

TREE PROTECTION
NOT TO SCALE

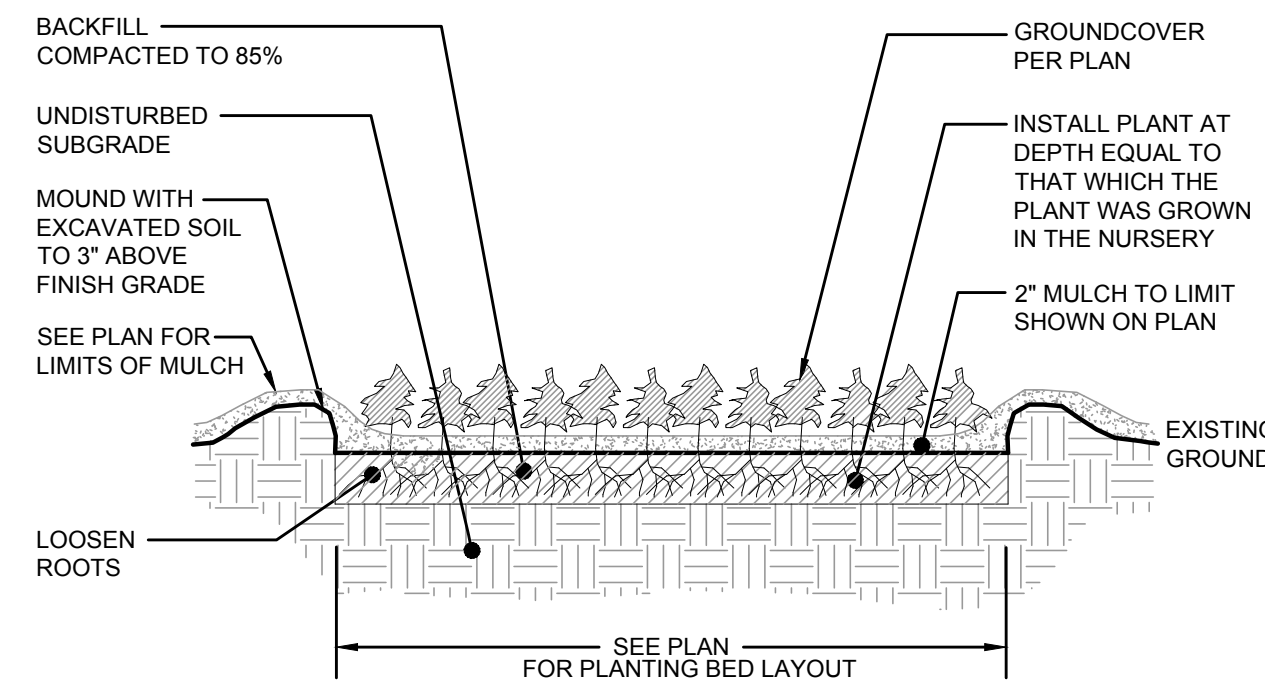

GROUNDCOVER PLANTING
NOT TO SCALE

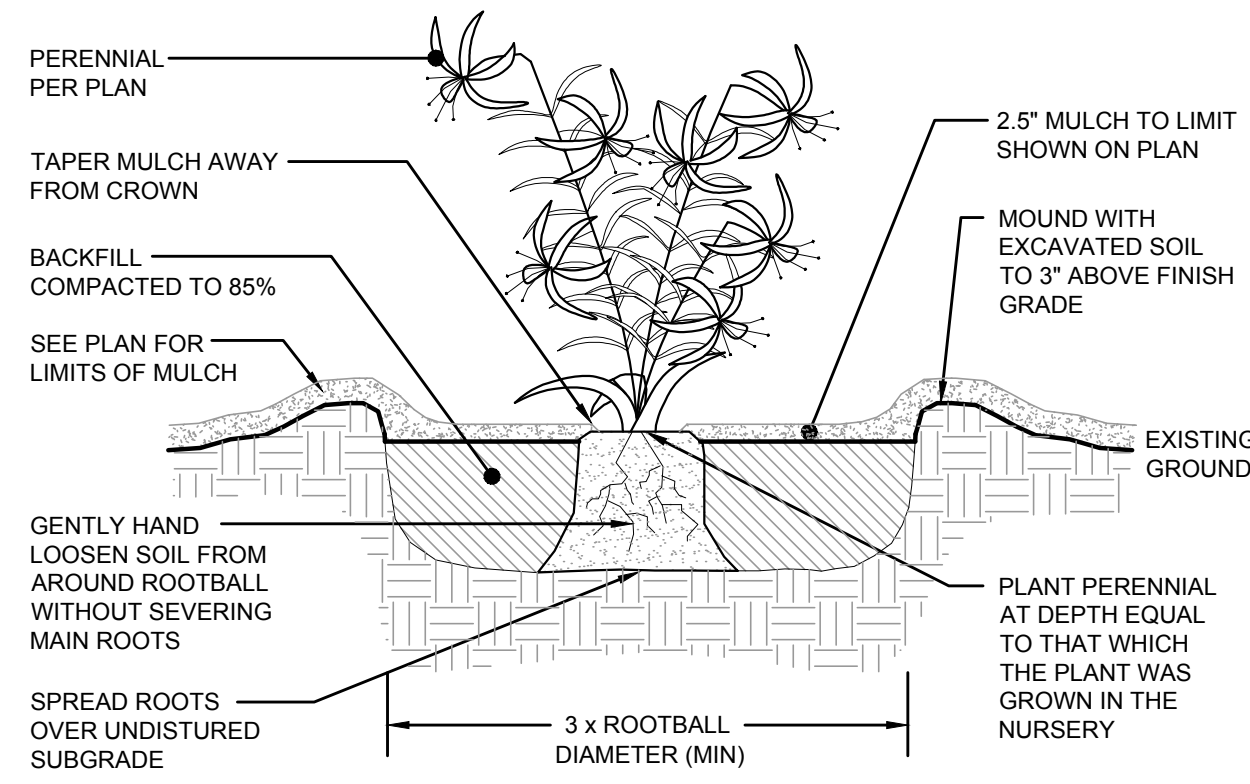

PERENNIALS & GRASSES PLANTING
NOT TO SCALE

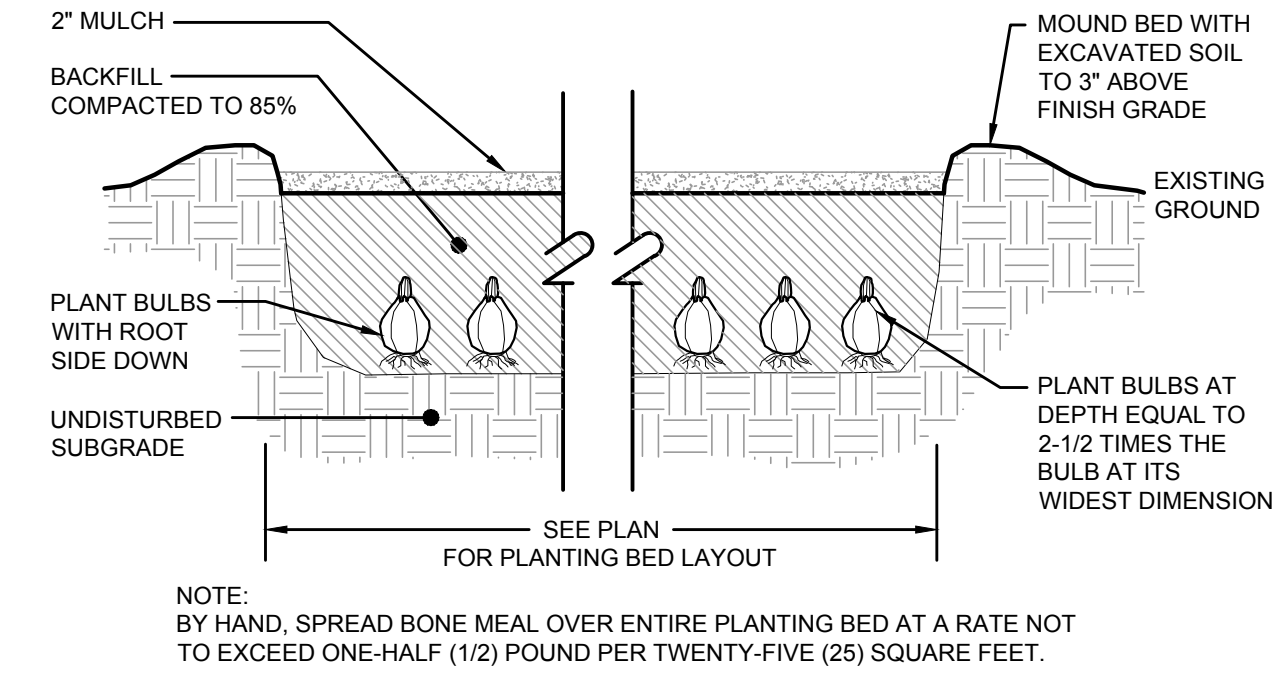

BULB PLANTING

NOTE: BY HAND, SPREAD BONE MEAL OVER ENTIRE PLANTING BED AT A RATE NOT TO EXCEED ONE-HALF (1/2) POUND PER TWENTY-FIVE (25) SQUARE FEET.

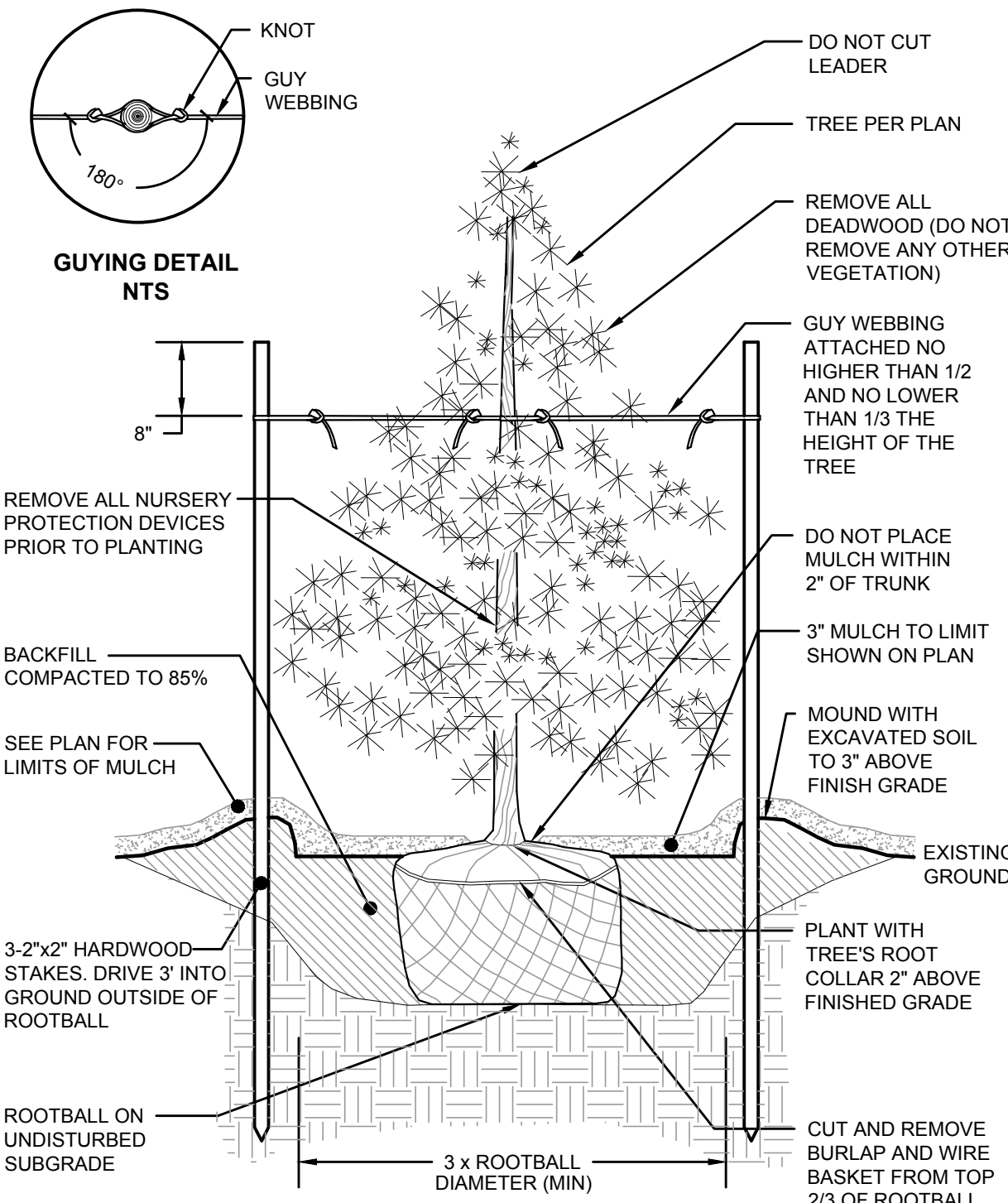

EVERGREEN TREE STAKING & PLANTING
NOT TO SCALE

NOTE: AFTER THE GUARANTEE PERIOD THE CONTRACTOR WILL BE RESPONSIBLE FOR THE REMOVAL OF STAKES AND GUY WEBBING.

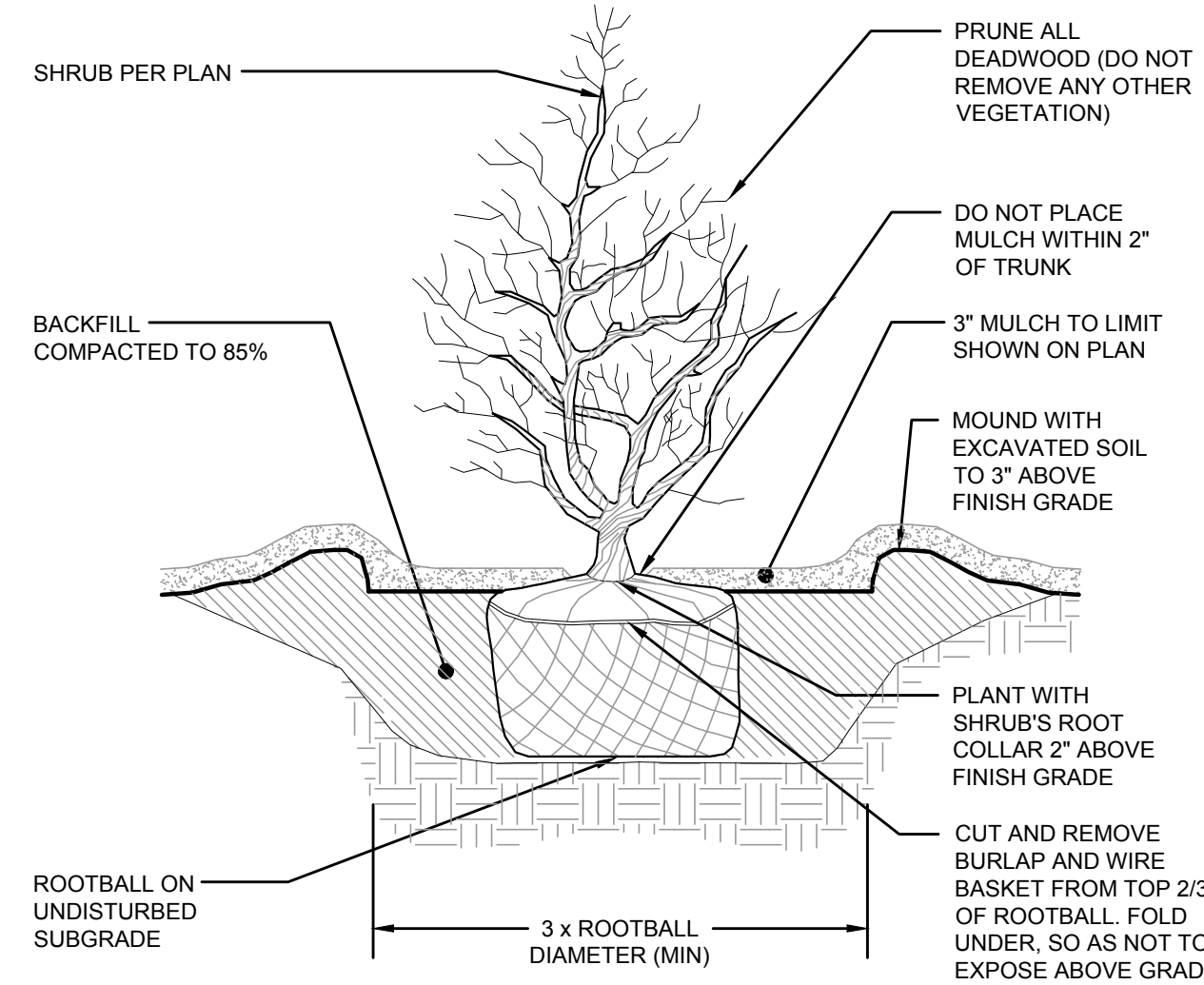

SHRUB PLANTING
NOT TO SCALE

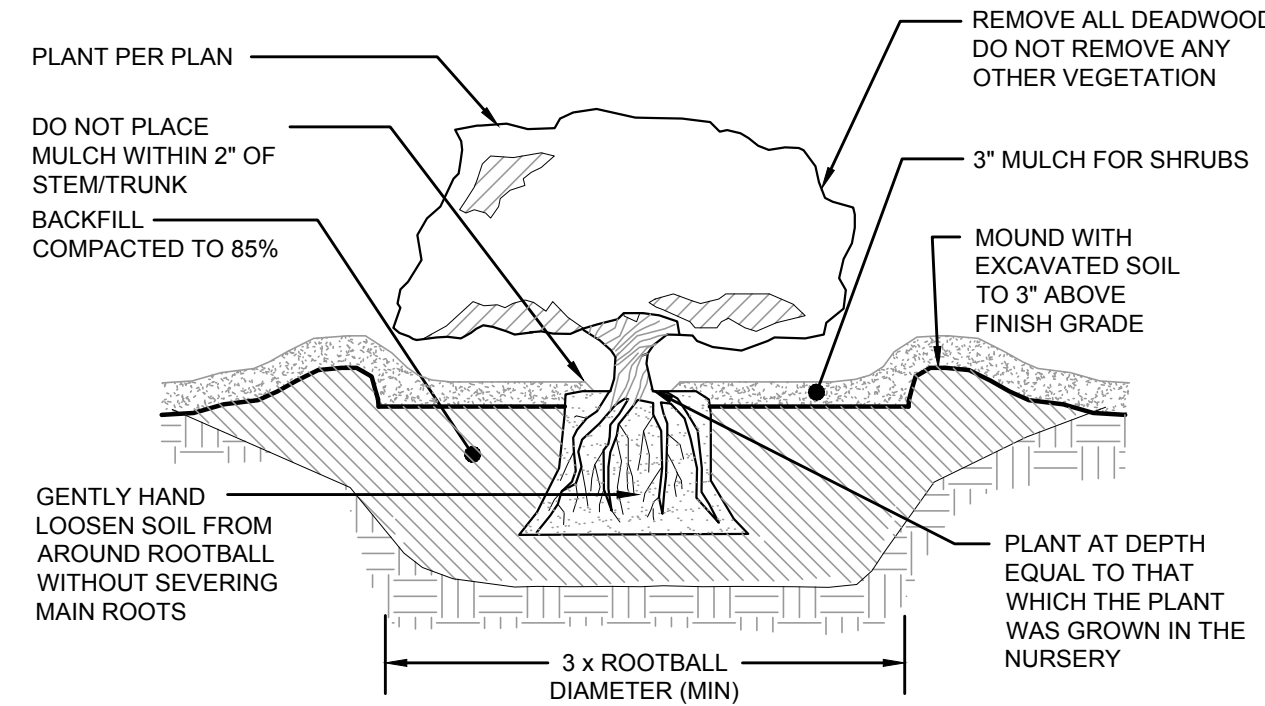

CONTAINER GROWN SHRUB PLANTING
NOT TO SCALE

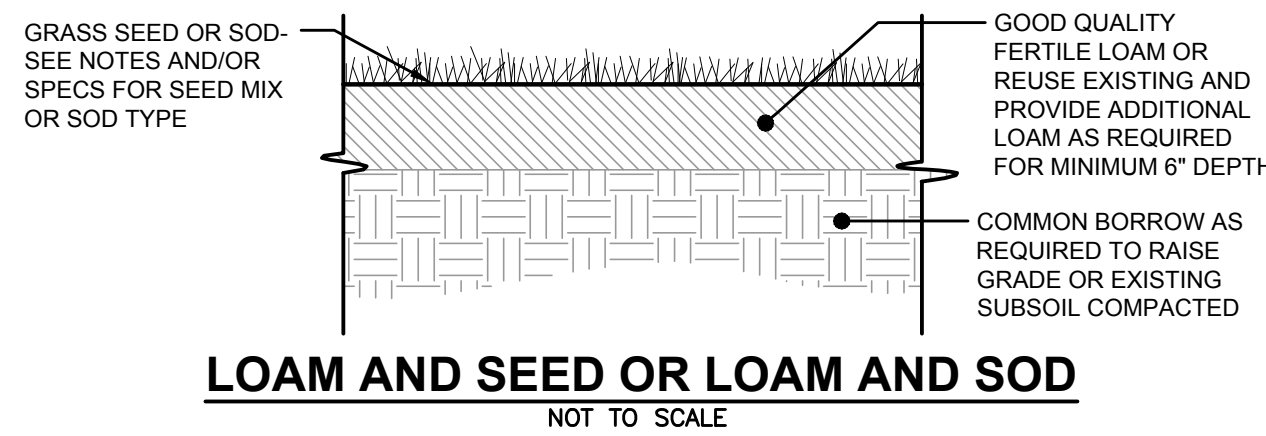

LOAM AND SEED OR LOAM AND SOD
NOT TO SCALE

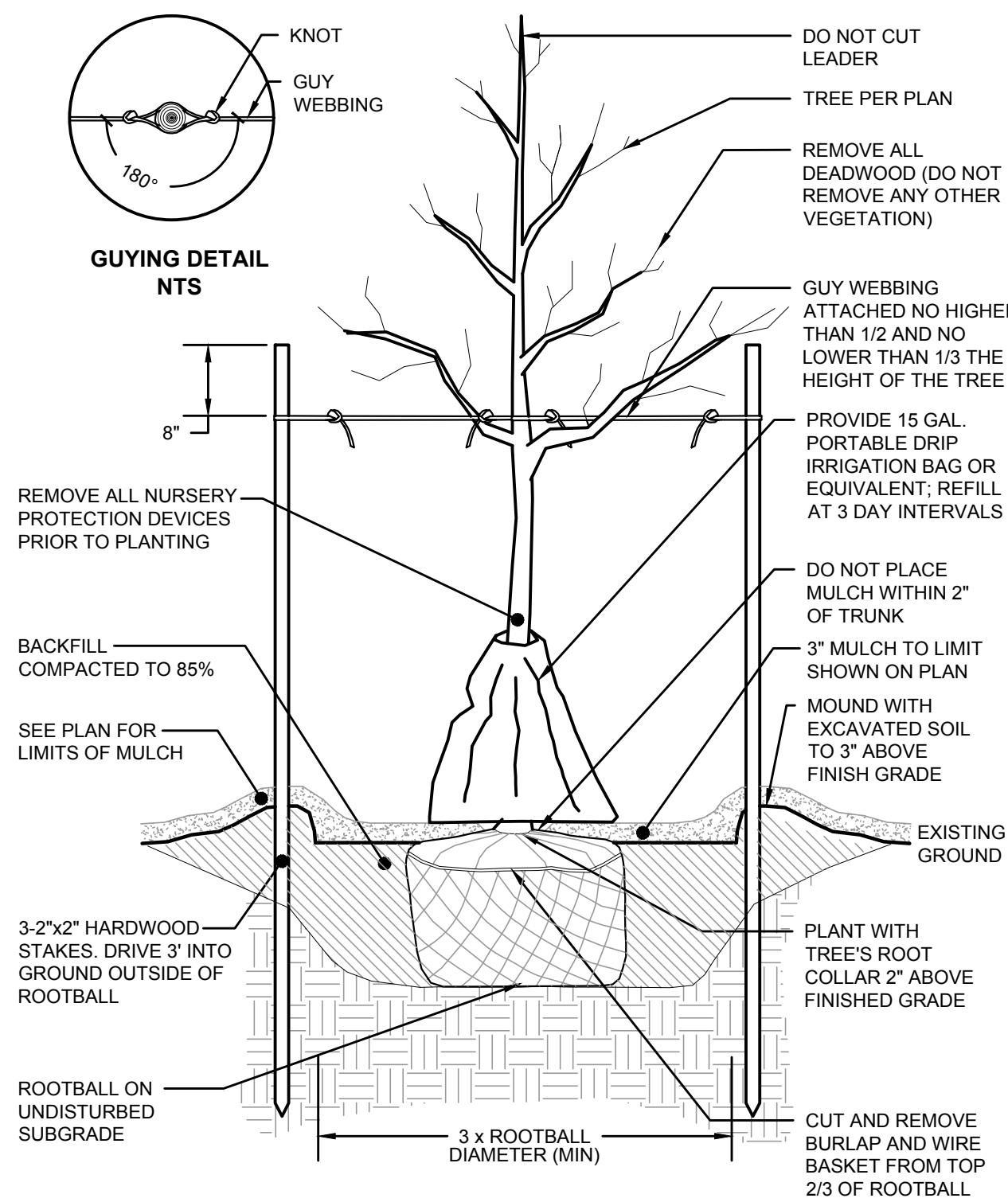

DECIDUOUS TREE STAKING & PLANTING
NOT TO SCALE

NOTE: AFTER THE GUARANTEE PERIOD THE CONTRACTOR WILL BE RESPONSIBLE FOR THE REMOVAL OF STAKES AND GUY WEBBING.

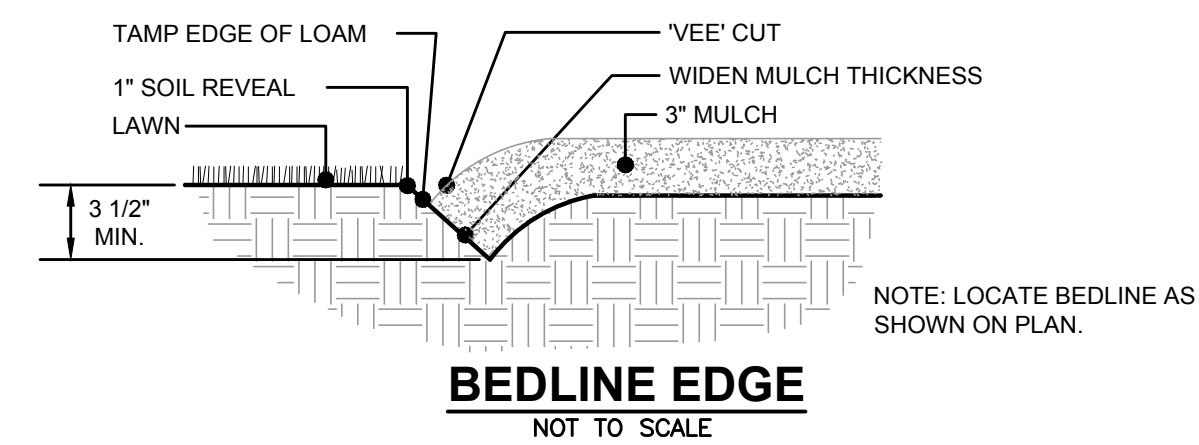

BEDLINE EDGE
NOT TO SCALE

NOTE: LOCATE BEDLINE AS SHOWN ON PLAN.

TOTAL PLANT LIST				
Trees				
Key	Botanical Name Common Name	Qty.	Size	Notes
AGAB	Amelanchier x 'Grandiflora' Autumn Brilliance Amelanchier	4	2"-2.5" Cal.	B&B
AROG	Acer rubrum 'October Glory' October Glory Maple	1	2"-2.5" Cal.	B&B
ARRS	Acer rubrum 'Red Sunset' Red Sunset Maple	6	2.5"-3" Cal	B&B
BP	Betula populifolia 'Whitespire' Whitespire Birch	7	7-8' Clump	B&B
CC	Cercis canadensis American Redbud	3	2"-2.5" Cal.	B&B
LP	Platanus x acerifolia London Planetree	3	3"-3.5" cal.	B&B
NSW	Nyssa sylvatica 'Wildfire' Wildfire Tupelo	2	1.5" -2" Cal	B&B
PP	Picea pungens Colorado Blue Spruce	1	6'-7'	B&B
PPH-1	Picea pungens 'Hoopsii' Hoopsi Blue Spruce	8	5'-6'	B&B
PPH-2	Picea pungens 'Hoopsii' Hoopsi Blue Spruce	8	7'-8'	B&B
PPH-3	Picea pungens 'Hoopsii' Hoopsi Blue Spruce	5	8'-10'	B&B
SRIS	Syringa reticulata 'Ivory Silk' Ivory Silk Tree Lilac	8	2" - 2.5" cal.	B&B
TPGG	Thuja plicata 'Green Giant' Green Giant Arborvitae	20	6'-7'	B&B
TOS-2	Thuja occidentalis 'Smaragd' Emerald Green Arborvitae	21	8'-10'	B&B
TSD	Thuja 'Skinner Dwarf' Skinner Dwarf American Arborvitae	7	3-4'	B&B
SHRUBS				
APS	Azalea viscosum 'Pink & Sweet' Pink & Sweet Azalea	27	18"-24"	Cont.
CS	Cornus stolonifera 'Farrow' Arctic Fire red Twig Dogwood	3	3'-4'	B&B
IVJ	Ilex verticillata 'Jim Dandy' Jim Dandy Winterberry	4	18"-24"	B&B
IVR	Ilex verticillata 'Red Sprite' Red Sprite Winterberry	17	24"-36"	Cont.
RR	Rosa x 'Radtko' Double Knock Out Rose	14	24"-36"	Cont.
SPAW	Spiraea japonica 'Anthony Waterer' Anthony Waterer Spirea	14	24"-36"	Cont.
WFWR	Weigela florida 'Wine and Rose' Wine and Rose Weigela	6	24"-36"	Cont.
PERENNIALS AND GRASSES				
HHR	Hemerocallis 'Happy Returns' Happy Returns Daylily	61	1 Gal.	Cont.
MS	Miscanthus sinensis 'Takushima' Dwarf Maiden Grass	15	1 Gal.	Cont.

REVISIONS		
NO.	DATE	BY
1	4/20	CC
2	6/1	NS

RHODE ISLAND
DEPARTMENT OF TRANSPORTATION
HIGHWAY IMPROVEMENTS
TO
ROUTE 5 (CONTRACT No. 1)
WARWICK AND CRANSTON, RHODE ISLAND

LANDSCAPE DETAILS



CHECKED BY _____ DATE _____ SCALE AS SHOWN

E. OTHER ITEM CHANGES (No Attachments)