

November 22, 2019

STATE OF RHODE ISLAND AND PROVIDENCE PLANTATION
DEPARTMENT OF ADMINISTRATION

DIVISION OF PURCHASES BID NO. 7599844

RHODE ISLAND DEPARTMENT OF TRANSPORTATION

RHODE ISLAND CONTRACT NO.2019-CH-088

FEDERAL-AID PROJECT NO. FAP Nos: NHPG-8888(240), NHP-RESF(415)

I-95 (Charles St - Lonsdale Ave)

Charles Street to Lonsdale Avenue
CITY/TOWN OF Pawtucket, Providence
COUNTY OF PROVIDENCE

NOTICE TO PROSPECTIVE BIDDERS

ADDENDUM NO. 1 Prospective bidders and all concerned are hereby notified of the following changes in the Plans, Specifications, Proposal and Distribution of Quantities for this contract. These changes shall be incorporated in the Plans, Specifications, Proposal and Distribution of Quantities, and shall become an integral part of the Contract Documents.

A. Contract Documents

1. CS Pages - Index page ii

Delete page CS-ii in its entirety and replace it with revised page CS-ii(R-1) attached to this Addendum No. 1. Appendix C has been added.

2. Appendix C - Pavement Cores

Add Appendix C - Pavement Cores, attached to this Addendum No. 1.

B. Plans

1. Sheet No. 6 - Typical Sections

Delete Sheet No. 6 in its entirety and replace it with revised Sheet No. 6 (R-1) attached to this Addendum No.1. The Typical Sections have been revised to show new micromilling and pavement depths.

2. General Plans 1-15

Delete General Plans 1-15 in their entirety and replace them with revised General Plans 1-15(R-1). The micromilling depths have been revised.

ADDENDUM NO. 1

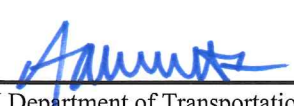
RI Department of Transportation

 Administrator, Division of Project Management

ATTACHMENTS

INDEX
GENERAL PROVISIONS – CONTRACT SPECIFIC

(R-1)

<u>PARAGRAPH</u>	<u>TITLE</u>	<u>PAGE</u>
21.	Transportation Management Plan	CS-7
22.	Environmental Permits	CS-7
Appendix A	Transportation Management Plan	
Appendix B	Initial Rideability Report	
Appendix C	Pavement Cores	

APPENDIX C

PAVEMENT CORES

RHODE ISLAND DEPARTMENT OF TRANSPORTATION MATERIALS AND QUALITY ASSURANCE

PAVEMENT CORE REPORT

File No: 2959

Date: 11/14/2019

RI Contract No: 2019-CH-088	F.A.P. No: nhp-resf-415	Project: I-95 Resurfacing
Town / City: Providence/Pawtucket	Cored By: Penkala, Colbert, Montes De Oca	
Limits: Charles Street to Lonsdale Avenue		

Comments:

Core ID	Station		Curb Reveal		Depth		Depth		Depth		Depth		Total Depth		Gravel: From / To	
	Lateral Offset	ROAD DESCRIPTION	LATITUDE	LONGITUDE	Material	Qualifier	Material	Qualifier	Material	Qualifier	Material	Qualifier	Material	Qualifier	Material	Qualifier
C-1	14.6	EDGE OF CURB	LIGHT POLE 3684	41.8467	-71.411	8	1.2"	Friction Course	1/2	2.2"	1.2"	Friction Course	4.6"			
NB			NORTHBOUND LANE 3													
C-10	5.8	EDGE OF SHOULDER BARRIER	LIGHT POLE 3795	41.865	-71.4036	1.3"	Friction Course	1/2	1.6"	2.5"	3/8	Friction Course	7.4"			
SB			SOUTHBOUND RIGHT SHOULDER													
C-11	12.6	EDGE OF CURB	LIGHT POLE 3801	41.8614	-71.4047	3.1	1"	Friction Course	1/2	2.5"	1.4"	Friction Course	6.7"			
SB			SOUTHBOUND LANE 3													
C-12	7.7	EDGE OF CURB	LIGHT POLE 8707	41.85	-71.4111	8	2"	Friction Course	1/2	2.7"			4.7"			
SB			SOUTHBOUND LANE 4													
C-13	13.4	EDGE OF CURB	POLE 3696	41.8456	-71.4112	9	1.5"	Friction Course	1/2	2.3"			3.8"			
SB			SOUTHBOUND LANE 3													
C-14	15	EDGE OF CURB	LIGHT POLE 3697	41.8445	-71.4112	9	2.1"	Friction Course	1/2	2"	1.2"	Friction Course	5.3"			
SB			SOUTHBOUND LANE 3													
C-15	33.4"	SOUTH OF LIGHT POLE 3697				9	1.4"	Friction Course	1/2	2"	2.3"	Friction Course	6.4"			
SB			SOUTHBOUND RIGHT SHOULDER*													

Core ID	Station		Curb Reveal	Depth		Material	Qualifier	Depth	Material	Qualifier	Depth	Material	Qualifier	Depth	Material	Qualifier	Total Depth	Gravel: From / To
	Lateral Offset	LATITUDE		LONGITUDE														
Direction	Road Description																	Core Notes
C-16	AT LIGHT POLE 3676					1.8"	Friction Course	2.5"	1.5"	8"							13.8"	
	23.6	EDGE OF CENTER BARRIER	41.8473	-71.4111		Friction Course	1/2	Friction Course		Concrete								
NB	NORTHBOUND LANE 2																	L3/L4 BOND BREAK
C-17	AT LIGHT POLE 3677					1.2"	Friction Course	2.6"	1.1"	1"							15"	
	12.9	EDGE OF CENTER BARRIER	41.8484	-71.411		Friction Course	1/2	Friction Course	3/8	Friction Course	Concrete							
NB	NORTHBOUND LANE 1																	L4/L5 BOND BREAK
C-18	113"NORTH OF LIGHT POLE 3678					1.6"	Friction Course	3.5"	0.9"	2"							16.8"	
	24	EDGE OF CENTER BARRIER	41.8494	-71.4109		Friction Course	1/2	Friction Course	3/8	Friction Course	Concrete							
NB	NORTHBOUND LANE 2							ANT SEE LIFT										
C-19	AT LIGHT POLE 3723					1.8"	Friction Course	2.5"	1.1"	1"							15.4"	
	12.9	EDGE OF CENTER BARRIER	41.852	-71.4099		Friction Course	1/2	Friction Course	3/8	Friction Course	Concrete							
NB	NORTHBOUND LANE 1																	L4/L5 BOND BREAK
C-2	LIGHT POLE 3685			8.3		1.3"	Friction Course	2"	1"	1.7"							6"	
	4.7	EDGE OF CURB	41.8478	-71.4109		Friction Course	1/2	Friction Course	3/8	Friction Course								
NB	NORTHBOUND RIGHT SHOULDER								BANK RUN									
C-20	AT LIGHT POLE 3711					2"	Friction Course	3.1"	1"	1.7"							16.5"	
	26.3	EDGE OF CENTER BARRIER	41.8549	-71.407		Friction Course	1/2	Friction Course	3/8	3/4	Concrete							
NB	NORTHBOUND LANE 2									BANK RUN								L4/L5 BOND BREAK
C-21	AT LIGHT POLE 3714					2.8"	Friction Course	2"	1.2"	2"							16.2"	
	12.5	EDGE OF CENTER BARRIER	41.8577	-71.4049		Friction Course	1/2	Friction Course	3/8	Friction Course	Concrete							
NB	NORTHBOUND LANE 1																	L4/L5 BOND BREAK
C-22	AT LIGHT POLE 3749					1.6"	Friction Course	2.4"	1.3"	1.7"							7"	
	24.6	EDGE OF CENTER BARRIER	41.8594	-71.4043		Friction Course	1/2	Friction Course	3/8	Friction Course								
NB	NORTHBOUND LANE 2																	
C-23	AT LIGHT POLE 3789					1.4"	Friction Course	2.1"	1.9"								5.4"	
	12.3	EDGE OF CENTER BARRIER	41.863	-71.4043		Friction Course	1/2	Friction Course										
NB	NORTHBOUND LANE 1																	
C-24	AT LIGHT POLE 3854					1.6"	Friction Course	2"	1.2"	1.5"							15.5"	
	27.2	EDGE OF CENTER BARRIER	41.8689	-71.401		Friction Course	1/2	Friction Course	3/8	Friction Course	Concrete							
SB	SOUTHBOUND LANE 2																	L4/L5 BOND BREAK
C-25	AT LIGHT POLE 3857					1.5"	Friction Course	3.2"	2.2"	9.2"							16.1"	
	13	EDGE OF CENTER BARRIER	41.8671	-71.4021		Friction Course	1/2	Friction Course	3/4	Concrete								
SB	SOUTHBOUND LANE 1																	L3/L4 BOND BREAK

Core ID	Station		Curb Reveal	Depth		Depth	Material	Qualifier	Depth		Depth	Material	Qualifier	Material	Depth	Total Depth	Gravel: From / To
	Lateral Offset	LATITUDE		LONGITUDE	Material				Qualifier	Material							
Direction	Road Description																
C-26	AT LIGHT POLE 8588					2.2"		Friction Course	3.2"	1.5"	1"					7.9"	
	25.2	EDGE OF CENTER BARRIER	41.8633	-71.4043	Friction Course				1/2	3/8	3/4						
SB	SOUTHBOUND LANE 2																
C-27	AT LIGHT POLE 3751					1.2"			2.5"	1.2"	1"					5.9"	
	12.9	EDGE OF CENTER BARRIER	41.8609	-71.4045	Friction Course				1/2	3/8	Friction Course						
SB	SOUTHBOUND LANE 1																
C-28	AT LIGHT POLE 3756					1.7"			3.4"	2"	0.4"	9"				16.5"	
	25.6	EDGE OF CENTER BARRIER	41.8562	-71.4059	Friction Course				1/2	3/8	Friction Course	Concrete					
SB	SOUTHBOUND LANE 2															L4/L5 BOND BREAK	
C-29	AT CENTER LIGHT POLE 3710					1.5"			4"	2"	8.1"					15.6"	
	13.2	EDGE OF CENTER BARRIER	41.8541	-71.4081	Friction Course				1/2	Friction Course	Concrete						
SB	SOUTHBOUND LANE 1															L3/L4 BOND BREAK	
C-3	LIGHT POLE 3720				8	1.4"			1.7"	1.2"	1.4"					5.7"	
	14	EDGE OF CURB	41.8544	-71.4074	Friction Course				1/2	3/8	Friction Course						
NB	NORTHBOUND LANE 3																
C-30	AT CENTER LIGHT POLE 3679					1.5"			2.7"	1.6"	1.2"					7"	
	24.8	EDGE OF CENTER BARRIER	41.8505	-71.4108	Friction Course				1/2	3/8	Friction Course						
SB	SOUTHBOUND LANE 2																
C-31	AT CENTER LIGHT POLE 3676					1.7"			2.8"	1.5"	7.7"					13.7"	
	13.2	EDGE OF CENTER BARRIER	41.8473	-71.4112	Friction Course				1/2	Friction Course	Concrete						
SB	SOUTHBOUND LANE 1																
C-4	14'4" SOUTH OF LIGHT POLE 8698				8	1.4"			1.7"							3.1"	
	14.8	EDGE OF CURB	41.8582	-71.4046	Friction Course				1/2								
NB	NORTHBOUND LANE 3																
C-5	121' NORTH OF LIGHT POLE 8698					1.3"			1.2"	1.9"						4.4"	
	6.9	Edge of Pavement	41.8585	-71.4044	Friction Course				1/2	Friction Course							
NB	NORTHBOUND RIGHT SHOULDER																
C-6	LIGHT POLE 3792				4.5	1.5"			1.5"	2"	1.8"					6.8"	
	12.7	EDGE OF CURB	41.8647	-71.4035	Friction Course				1/2	3/8	Friction Course						
NB	NORTHBOUND LANE 3																
C-7	LIGHT POLE 3811				2.4	1.3"			2.4"	1.5"	1.4"					6.6"	
	17.5	EDGE OF CURB	41.8695	-71.4006	Friction Course				1/2	3/8	1/2						
NB	NORTHBOUND LANE 3																

Core ID	Station		Curb Reveal	Depth		Depth		Depth		Depth		Total Depth	Gravel: From / To	
	Lateral Offset	Longitudinal		Material	Qualifier	Material	Qualifier	Material	Qualifier	Material	Qualifier		Cored To	Core Notes
C-8	Road Description		1.5	2.1"	1.9"	3.4"						7.4"		
	4.6	EDGE OF CURB	41.8701	-71.4001	Friction Course	1/2	1/2							
NB	NORTHBOUND RIGHT SHOULDER					BANK RUN								
C-9	Road Description			1.7"	2.6"	1.5"	1.3"					7.1"		
	13.4	EDGE OF EDGE BARRIER	41.8677	-71.4019	Friction Course	1/2	3/8	Friction Course						
SB	SOUTHBOUND LANE 3													
Average Depth:			1.6"	2.41"	1.58"									

☒ P.E.
 ☐ Final
 ☐ Acceptance
 ☐ Special Projects

Technician R. Mozzi / Monica E. Wiggins Date 11/20/19
 (Print / Sign)

Materials Engineer [Signature] Date 11/21/19
 (Print / Sign)

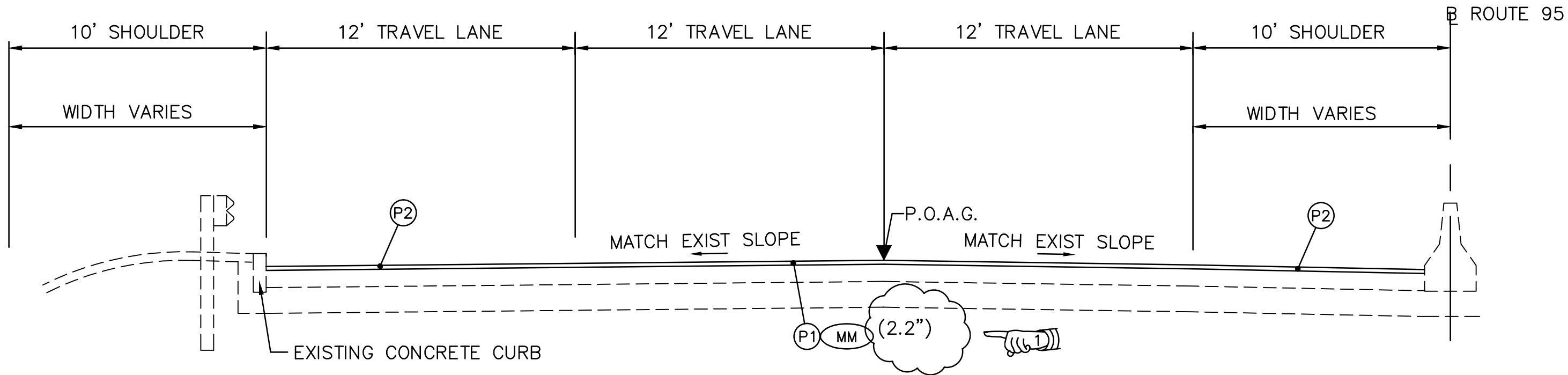

TYPICAL 3 - LANE SECTION (NORMAL) I-95 SOUTHBOUND

SCALE : 1"=4'

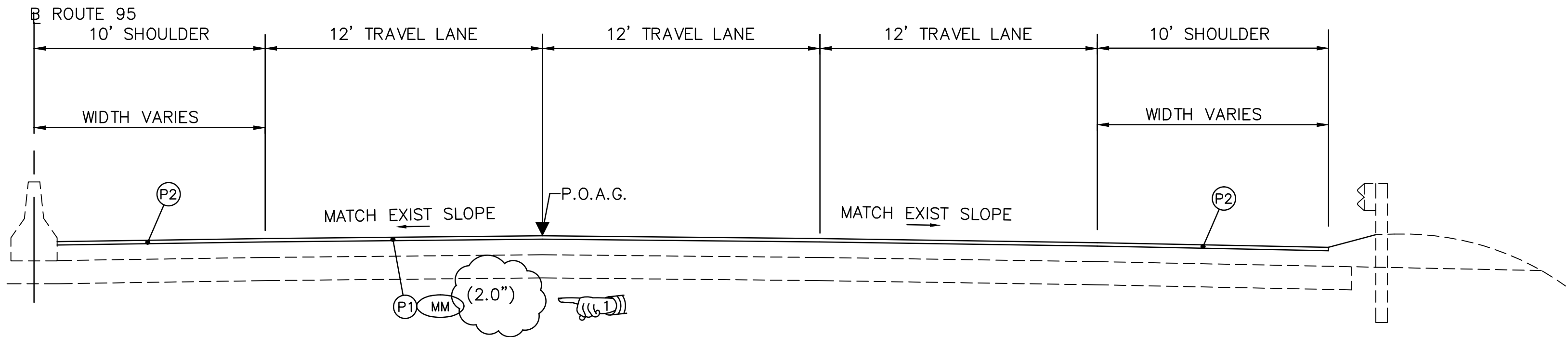

TYPICAL 3 - LANE SECTION (NORMAL) I-95 NORTHBOUND

SCALE : 1"=4'

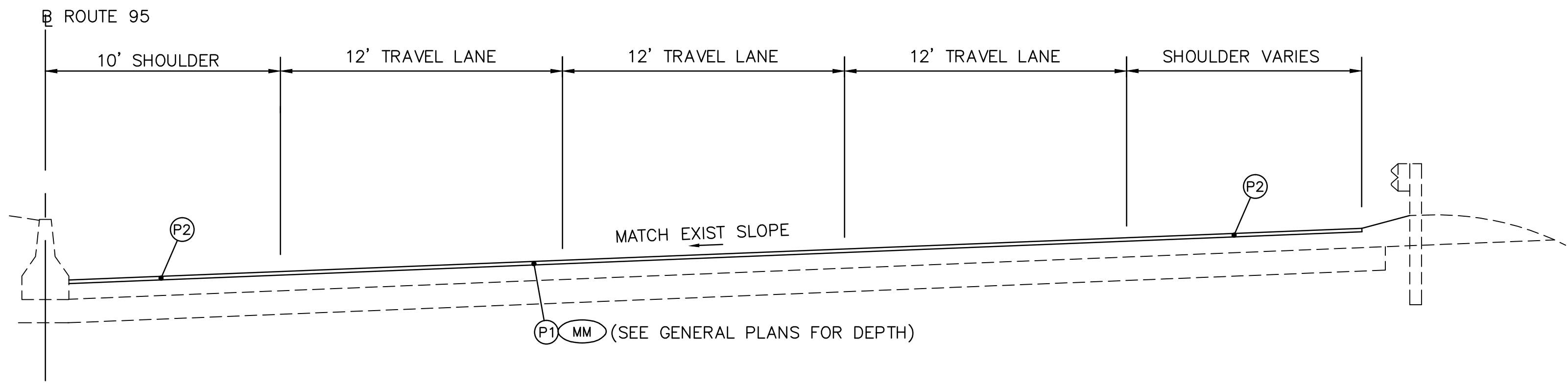

TYPICAL 3 - LANE SECTION (SUPERELEVATED) I-95

SCALE : 1"=4'

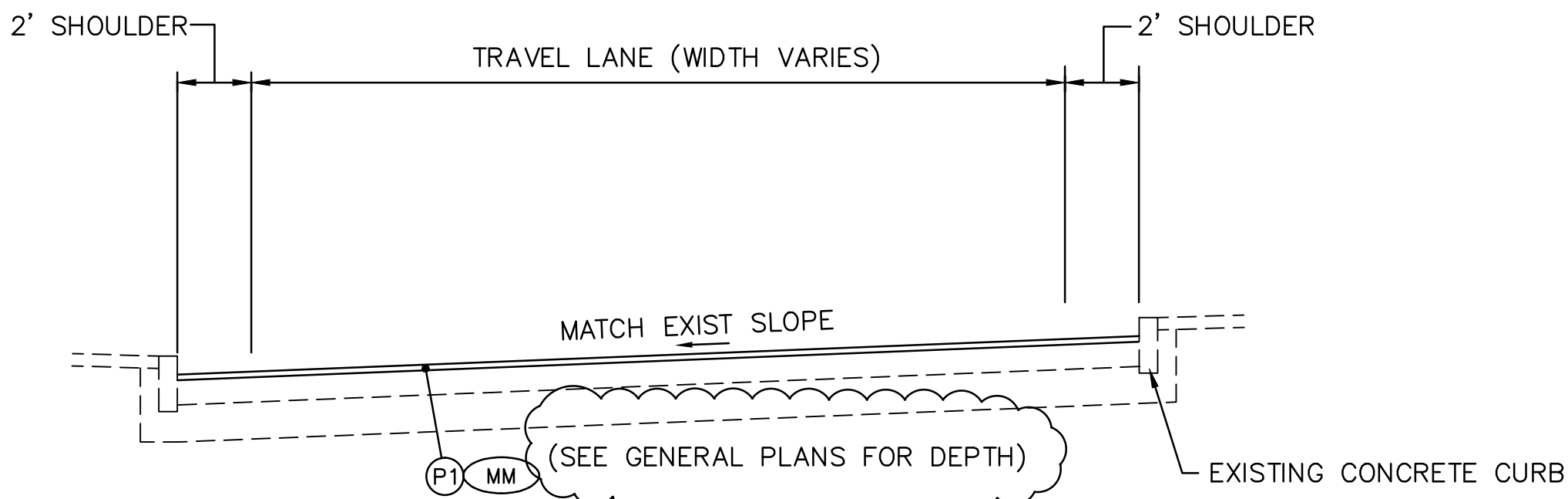

TYPICAL SECTION RAMP

SCALE : 1"=4'

PAVEMENT LEGEND

- (P1) 1 1/2" FRICTION COURSE
CLEAN & SWEEP PAVEMENT
ASPHALT EMULSION TACK COAT
- (P2) 1 1/2" FRICTION COURSE FOR
SHOULDERS SWEEP PAVEMENT
ASPHALT EMULSION TACK COAT
- (MM) MICROMILLING (DEPTH)
- P.O.A.G. POINT OF APPLICATION OF
CENTERLINE GRADE

REVISIONS			RHODE ISLAND	
NO.	DATE	BY	DEPARTMENT OF TRANSPORTATION	
1	11/21/19	RCC	I - 95 RESURFACING - 2B	
			CHARLES STREET TO LONSDALE AVENUE	
			PROVIDENCE, PAWTUCKET,	RHODE ISLAND
			TYPICAL SECTIONS	
			CHECKED BY _____ DATE _____ SCALE AS SHOWN	

Gordon R. Archibald, Inc.
Civil and Environmental Engineers
Pawtucket, Rhode Island

FED. ROAD DIV. NO.	STATE	FEDERAL AID PROJECT NO.	FISCAL YEAR	SHEET NO.	TOTAL SHEETS
1	RI		2019	7	53

R-1

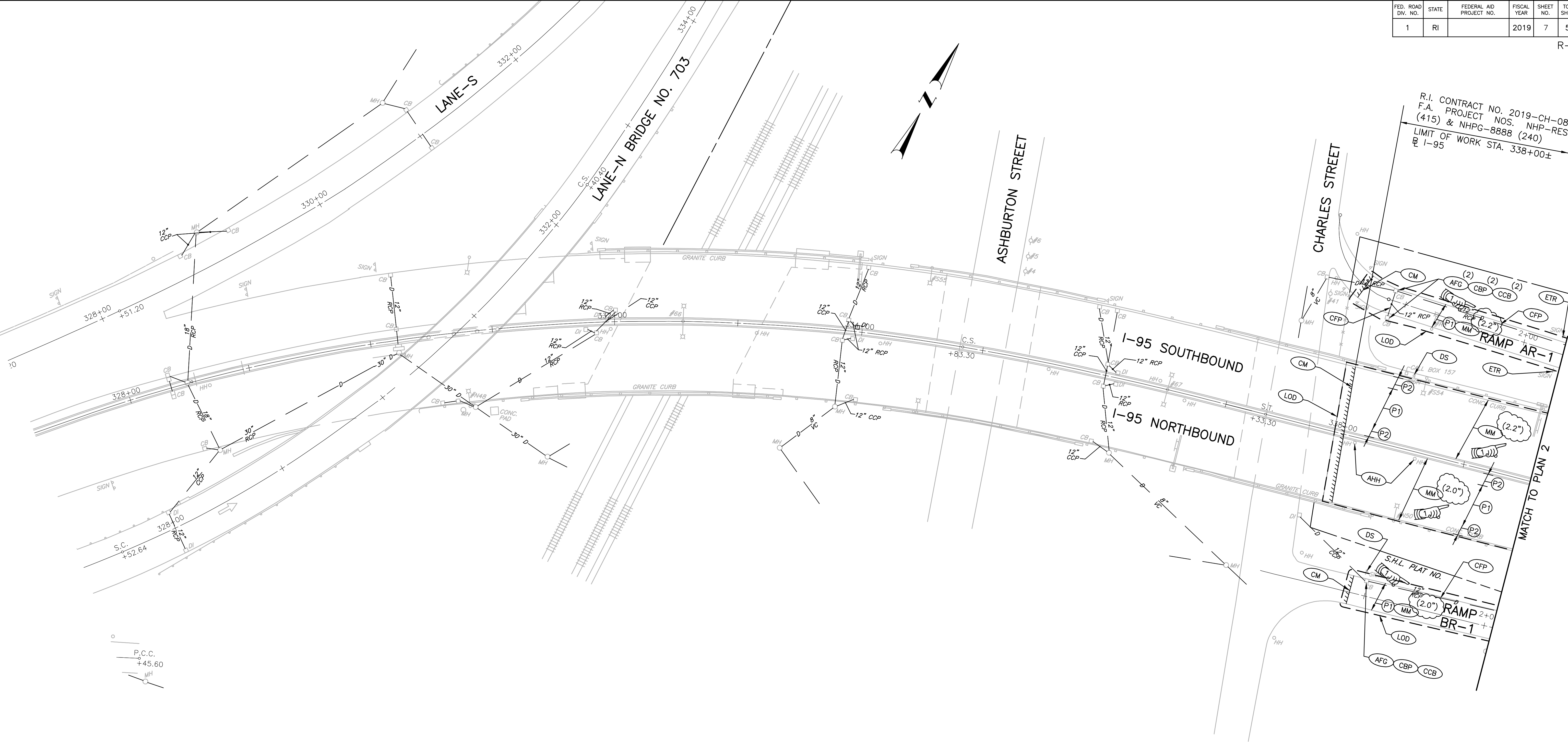

R.I. CONTRACT NO. 2019-CH-088
F.A. PROJECT NOS. NHP-RESF
(415) & NHPG-8888 (240)
LIMIT OF WORK STA. 338+00±
E I-95

NOTE:

PLAN SCALE

1. THESE PLANS WERE PREPARED SOLELY AS A GUIDE FOR THE CONTRACTOR IN DEFINING LIMITS OF WORK AND GENERAL LOCATION OF THE PROPOSED IMPROVEMENTS. THEY WERE COMPILED FROM EXISTING RIDOT CONSTRUCTION DRAWINGS. THEY ARE **NOT** TRUE TO SCALE. ACCORDINGLY, ALL DIMENSIONS AND DISTANCES SHOULD BE VERIFIED AND/OR ADJUSTED IN THE FIELD, AS REQUIRED, TO PROPERLY ACCOMPLISH THE INTENT OF THE DESIGN.

REVISIONS			RHODE ISLAND	
NO.	DATE	BY	DEPARTMENT OF TRANSPORTATION	
1	11/21/19	RCC	I - 95 RESURFACING - 2B	
			CHARLES STREET TO LONSDALE AVENUE	
			PROVIDENCE, PAWTUCKET,	RHODE ISLAND
			GENERAL PLAN - 1	
			CHECKED BY _____ DATE _____ SCALE 1" = 40'	

Gordon R. Archibald, Inc.
Civil and Environmental Engineers
Pawtucket, Rhode Island

FED. ROAD DIV. NO.	STATE	FEDERAL AID PROJECT NO.	FISCAL YEAR	SHEET NO.	TOTAL SHEETS
1	RI		2019	9	53

R-1

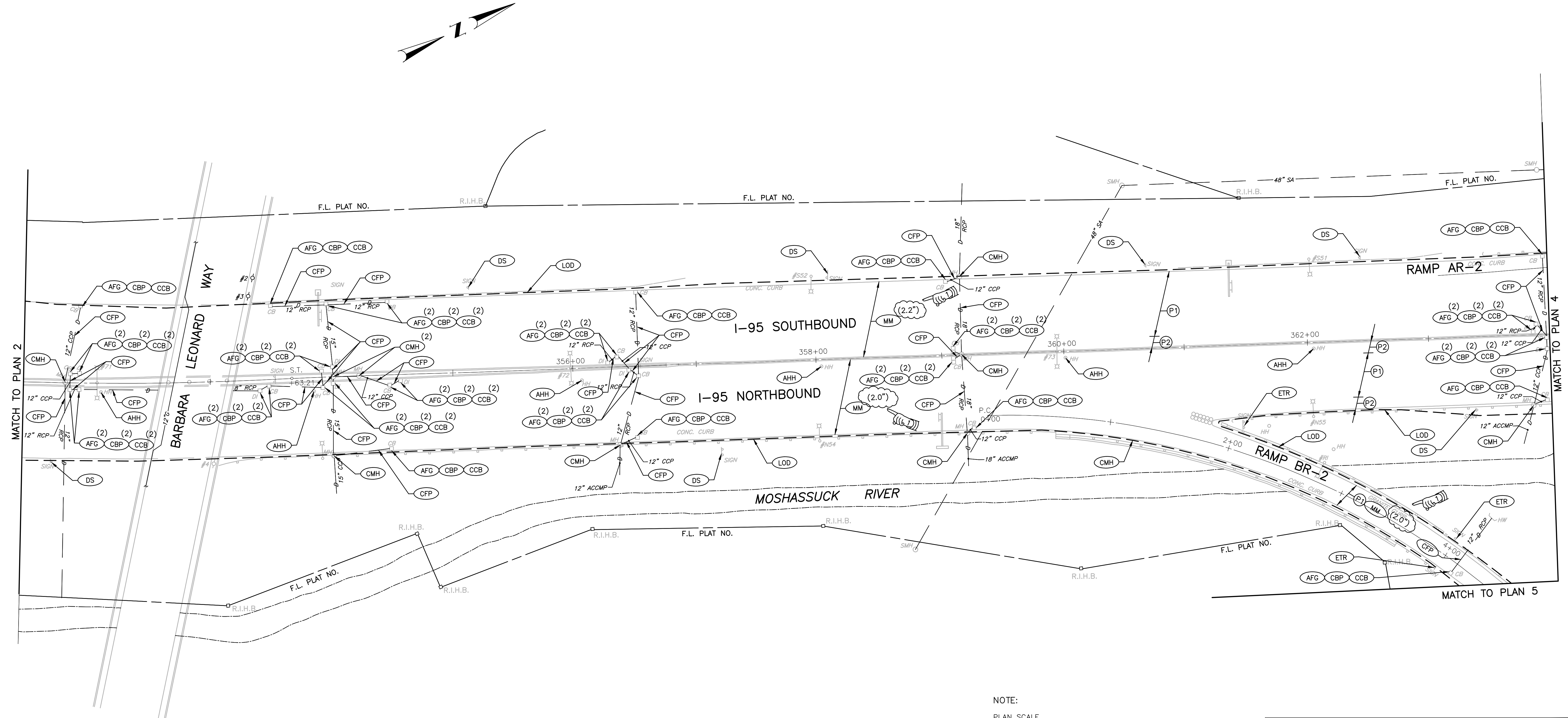

NOTE:

PLAN SCALE

1. THESE PLANS WERE PREPARED SOLELY AS A GUIDE FOR THE CONTRACTOR IN DEFINING LIMITS OF WORK AND GENERAL LOCATION OF THE PROPOSED IMPROVEMENTS. THEY WERE COMPILED FROM EXISTING RIDOT CONSTRUCTION DRAWINGS. THEY ARE NOT TRUE TO SCALE. ACCORDINGLY, ALL DIMENSIONS AND DISTANCES SHOULD BE VERIFIED AND/OR ADJUSTED IN THE FIELD, AS REQUIRED, TO PROPERLY ACCOMPLISH THE INTENT OF THE DESIGN.

[illegible]

RHODE ISLAND
DEPARTMENT OF TRANSPORTATION

I - 95 RESURFACING - 2B
CHARLES STREET TO LONSDALE AVENUE

PROVIDENCE, PAWTUCKET, RHODE ISLAND

GENERAL PLAN - 3

CHECKED BY _____ DATE _____ SCALE 1" = 40'

0082D_V1_009_GENERAL_003 - ADD_001

ADDENDUM NO. 1



FED. ROAD DIV. NO.	STATE	FEDERAL AID PROJECT NO.	FISCAL YEAR	SHEET NO.	TOTAL SHEETS
1	RI		2019	12	53

R-1

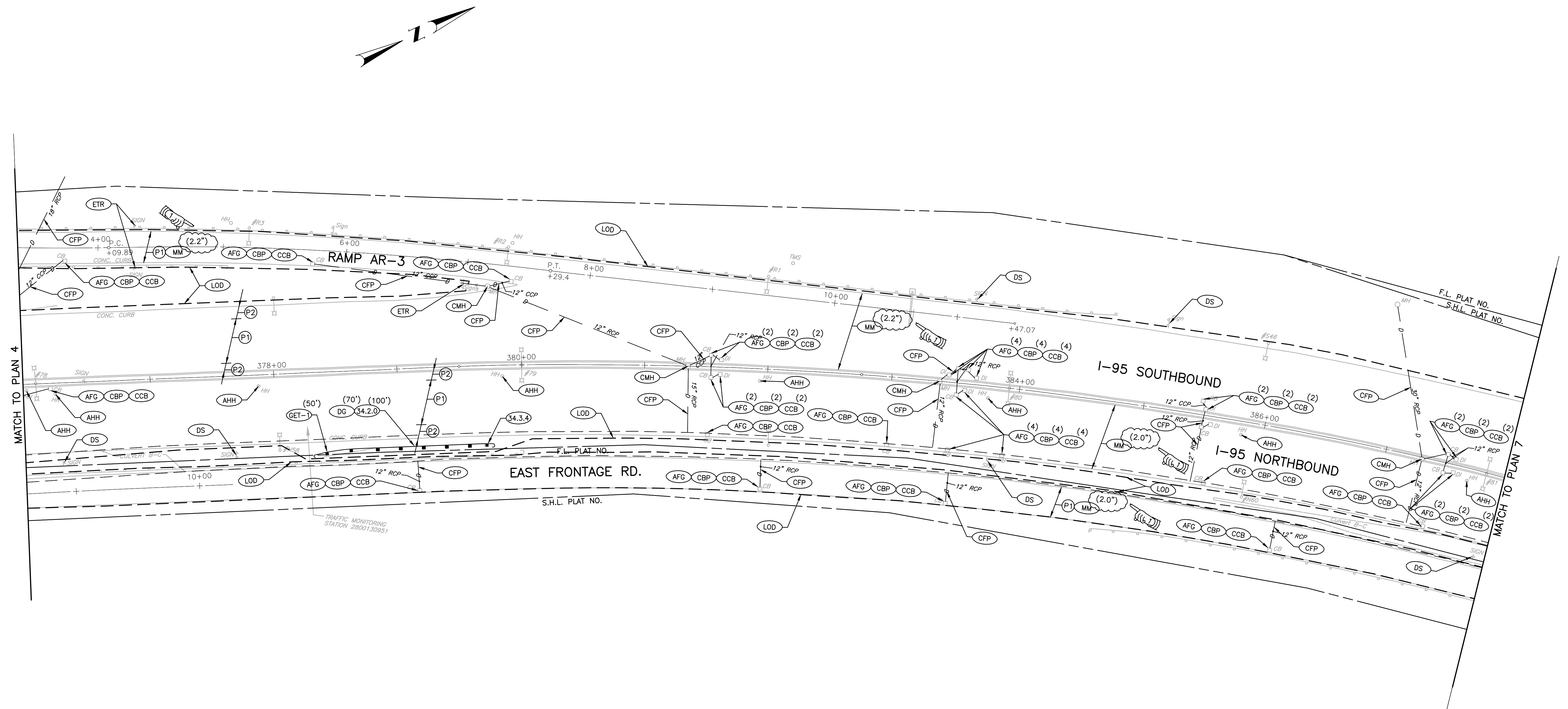

NOTE:

PLAN SCALE

1. THESE PLANS WERE PREPARED SOLELY AS A GUIDE FOR THE CONTRACTOR IN DEFINING LIMITS OF WORK AND GENERAL LOCATION OF THE PROPOSED IMPROVEMENTS. THEY WERE COMPILED FROM EXISTING RIDOT CONSTRUCTION DRAWINGS. THEY ARE NOT TRUE TO SCALE. ACCORDINGLY, ALL DIMENSIONS AND DISTANCES SHOULD BE VERIFIED AND/OR ADJUSTED IN THE FIELD, AS REQUIRED, TO PROPERLY ACCOMPLISH THE INTENT OF THE DESIGN.

[illegible]

RHODE ISLAND
DEPARTMENT OF TRANSPORTATION

I - 95 RESURFACING - 2B
CHARLES STREET TO LONSDALE AVENUE

PROVIDENCE, PAWTUCKET, RHODE ISLAND

GENERAL PLAN - 6

CHECKED BY _____ DATE _____ SCALE 1" = 40'



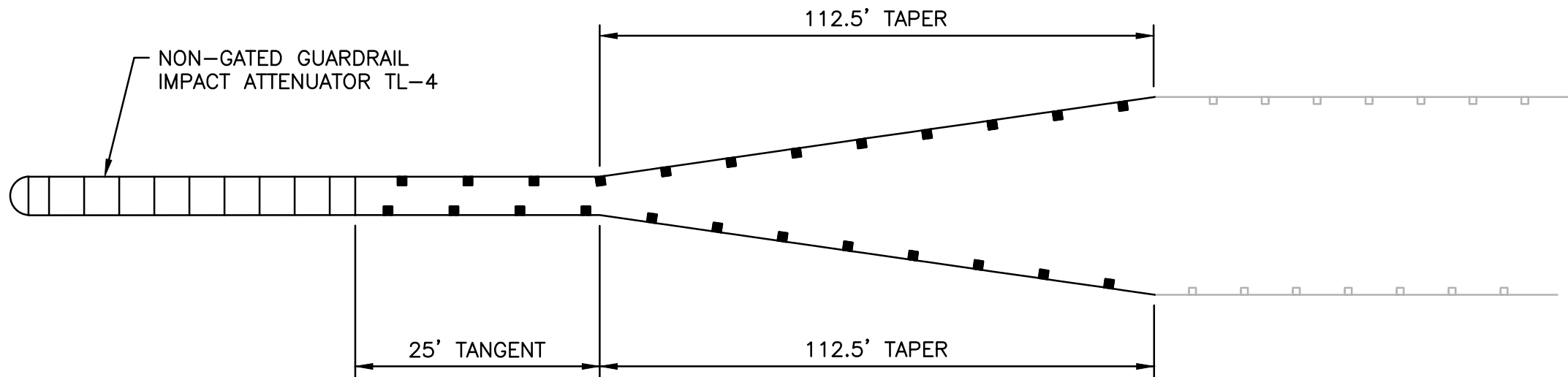
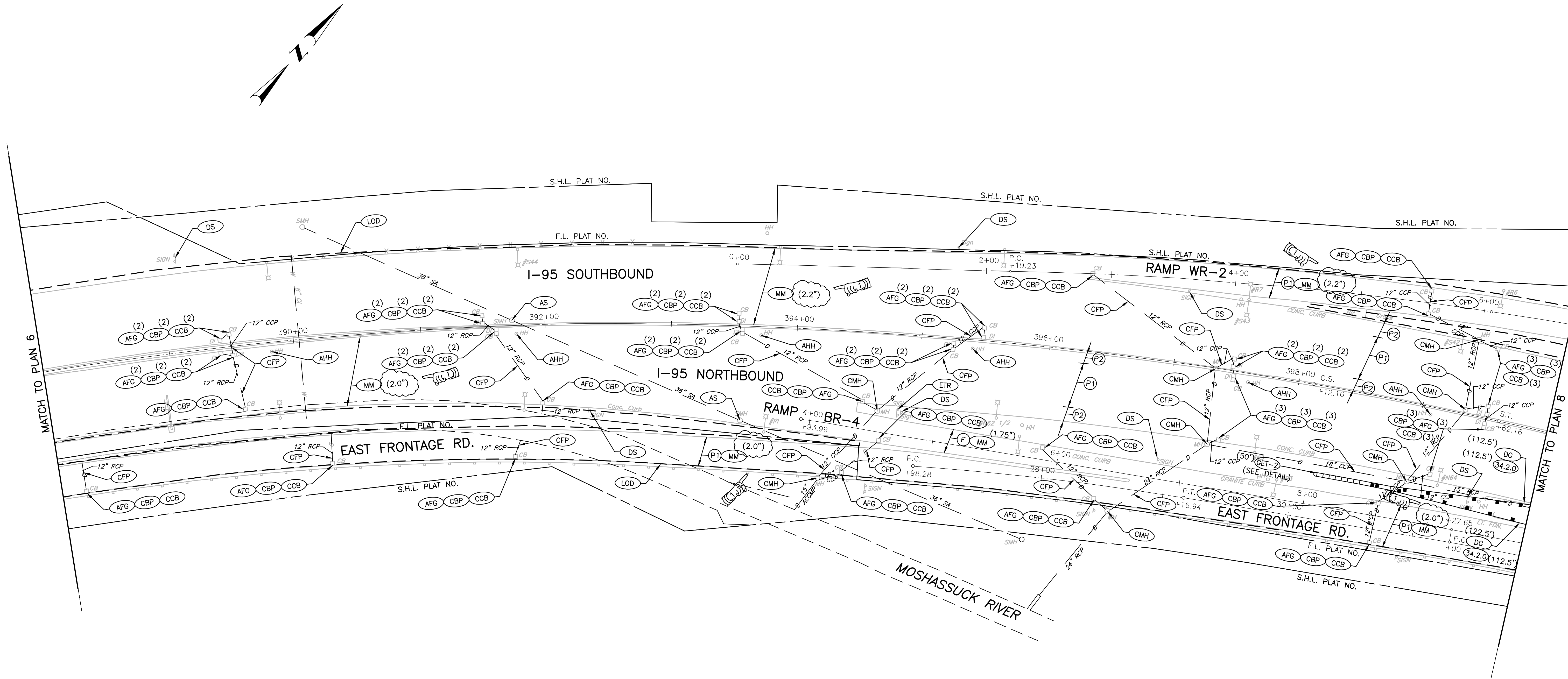

GUARDRAIL DETAIL (GET-1)
NOT TO SCALE

NOTE:
PLAN SCALE
1. THESE PLANS WERE PREPARED SOLELY AS A GUIDE FOR THE CONTRACTOR IN DEFINING LIMITS OF WORK AND GENERAL LOCATION OF THE PROPOSED IMPROVEMENTS. THEY WERE COMPILED FROM EXISTING RIDOT CONSTRUCTION DRAWINGS. THEY ARE NOT TRUE TO SCALE. ACCORDINGLY, ALL DIMENSIONS AND DISTANCES SHOULD BE VERIFIED AND/OR ADJUSTED IN THE FIELD, AS REQUIRED, TO PROPERLY ACCOMPLISH THE INTENT OF THE DESIGN.

REVISIONS			RHODE ISLAND DEPARTMENT OF TRANSPORTATION	
NO.	DATE	BY		
1	11/21/19	RCC	I - 95 RESURFACING - 2B CHARLES STREET TO LONSDALE AVENUE	
			PROVIDENCE, PAWTUCKET, RHODE ISLAND	
			GENERAL PLAN - 7	
			CHECKED BY _____ DATE _____ SCALE 1" = 40'	

Gordon R. Archibald, Inc.
Civil and Environmental Engineers
Pawtucket, Rhode Island

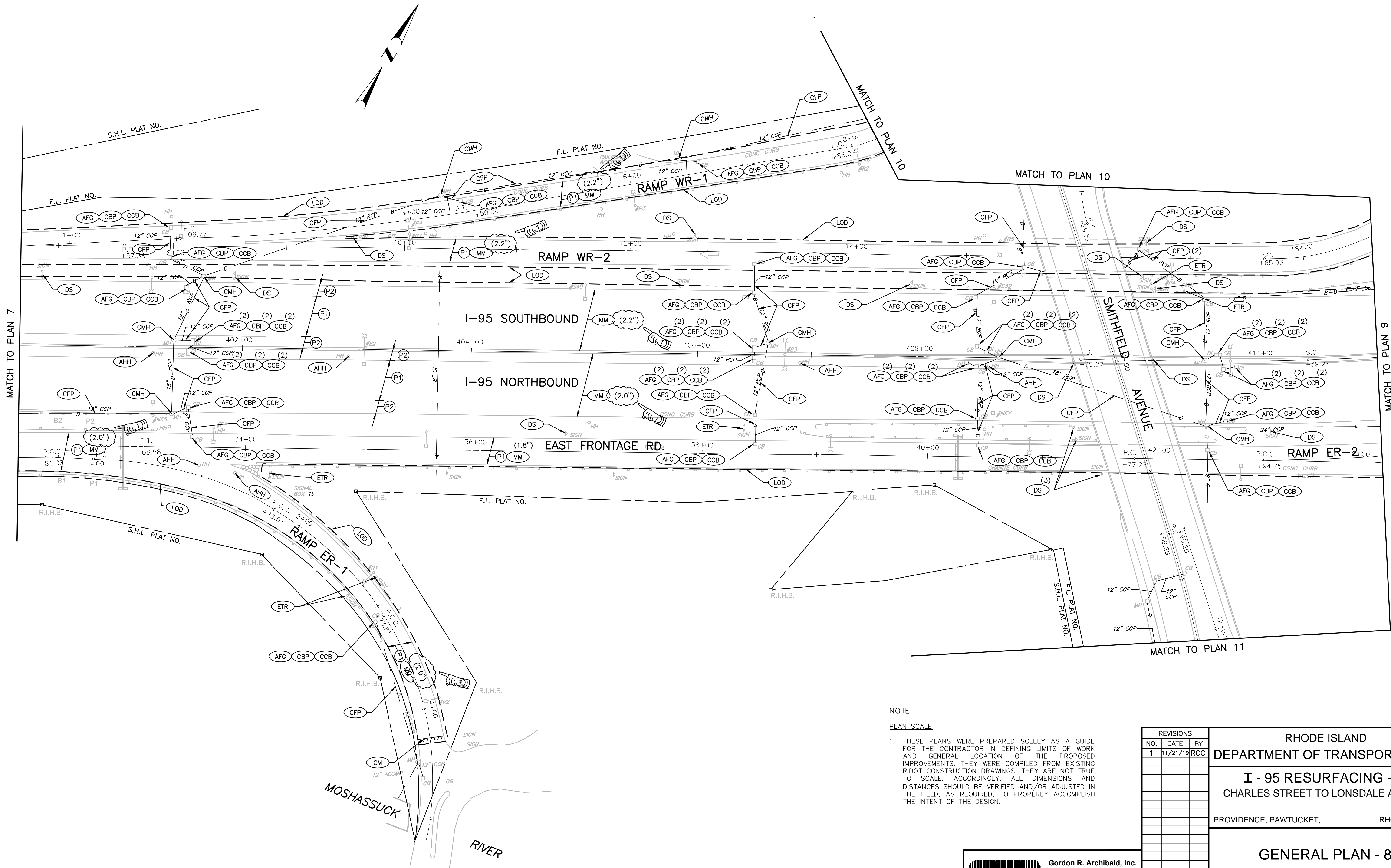

NOTE:
PLAN SCALE
1. THESE PLANS WERE PREPARED SOLELY AS A GUIDE FOR THE CONTRACTOR IN DEFINING LIMITS OF WORK AND GENERAL LOCATION OF THE PROPOSED IMPROVEMENTS. THEY WERE COMPILED FROM EXISTING RIDOT CONSTRUCTION DRAWINGS. THEY ARE NOT TRUE TO SCALE. ACCORDINGLY, ALL DIMENSIONS AND DISTANCES SHOULD BE VERIFIED AND/OR ADJUSTED IN THE FIELD, AS REQUIRED, TO PROPERLY ACCOMPLISH THE INTENT OF THE DESIGN.

REVISIONS			RHODE ISLAND DEPARTMENT OF TRANSPORTATION	
NO.	DATE	BY		
1	11/21/19	RCC	I - 95 RESURFACING - 2B CHARLES STREET TO LONSDALE AVENUE	
			PROVIDENCE, PAWTUCKET, RHODE ISLAND	
			GENERAL PLAN - 8	
			CHECKED BY _____ DATE _____ SCALE 1" = 40'	

Gordon R. Archibald, Inc.
Civil and Environmental Engineers
Pawtucket, Rhode Island

FED. ROAD DIV. NO.	STATE	FEDERAL AID PROJECT NO.	FISCAL YEAR	SHEET NO.	TOTAL SHEETS
1	RI		2019	18	53

R-1

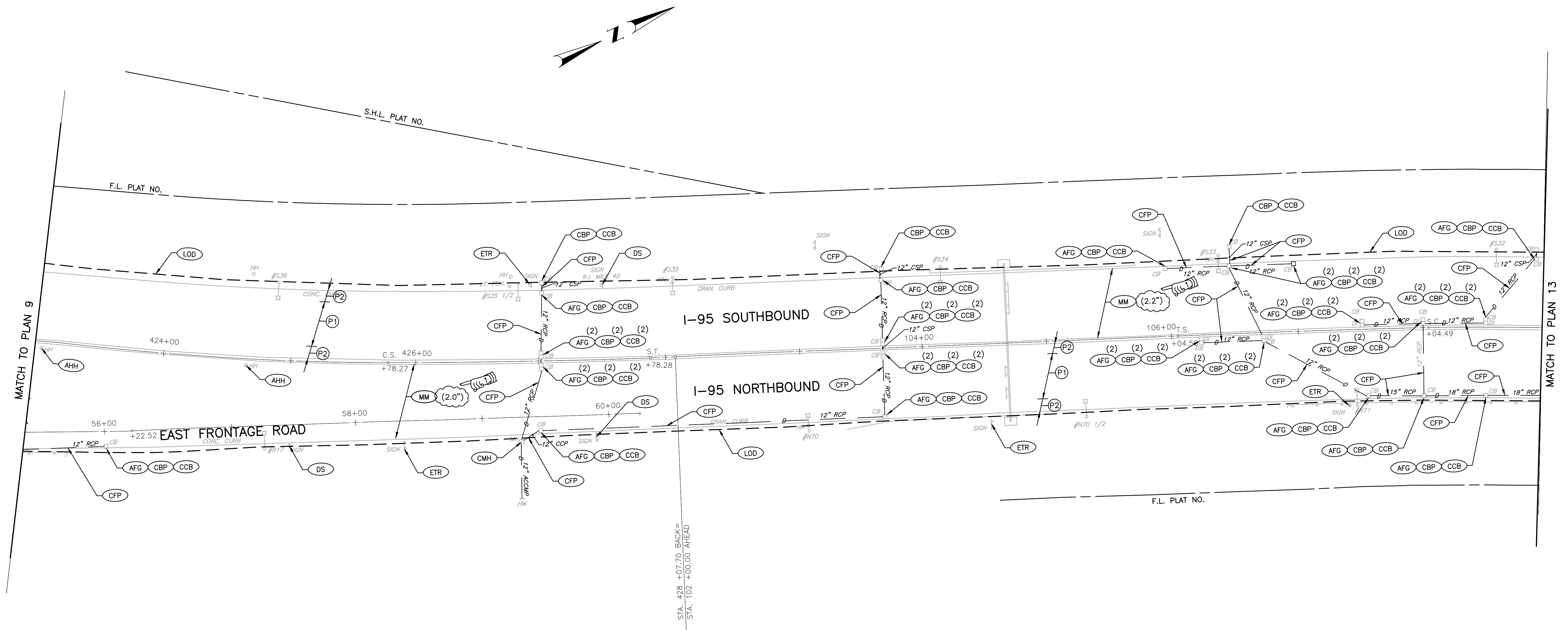

NOTE:

PLAN SCALE

1. THESE PLANS WERE PREPARED SOLELY AS A GUIDE FOR THE CONTRACTOR IN DEFINING LIMITS OF WORK AND GENERAL LOCATION OF THE PROPOSED IMPROVEMENTS. THEY WERE COMPILED FROM EXISTING RIDOT CONSTRUCTION DRAWINGS. THEY ARE NOT TRUE TO SCALE. ACCORDINGLY, ALL DIMENSIONS AND DISTANCES SHOULD BE VERIFIED AND/OR ADJUSTED IN THE FIELD, AS REQUIRED, TO PROPERLY ACCOMPLISH THE INTENT OF THE DESIGN.

[illegible]

RHODE ISLAND
DEPARTMENT OF TRANSPORTATION

I - 95 RESURFACING - 2B
CHARLES STREET TO LONSDALE AVENUE

PROVIDENCE, PAWTUCKET, RHODE ISLAND

GENERAL PLAN - 12

CHECKED BY _____ DATE _____ SCALE 1" = 40'



Gordon R. Archibald, Inc.
Civil and Environmental Engineers
Pawtucket, Rhode Island

ADDENDUM NO. 1

0082D_V1_018_GENERAL_012 - ADD_001

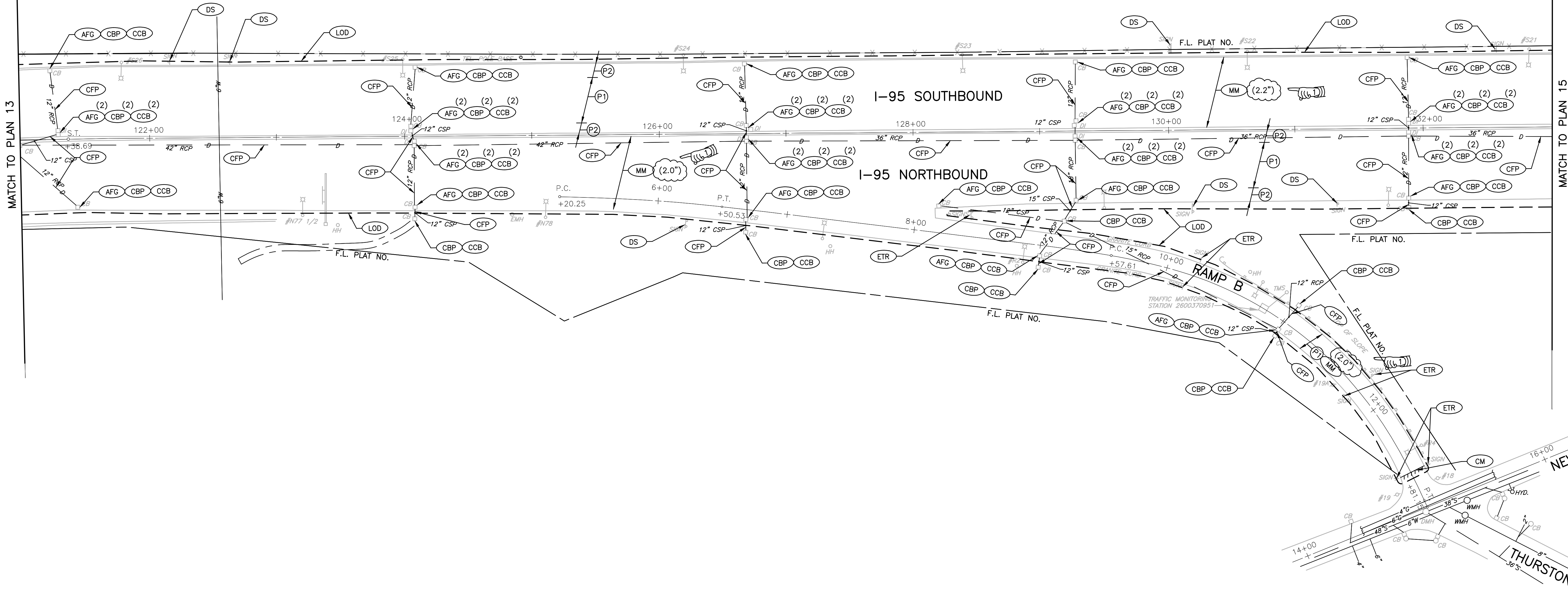

NOTE:
PLAN SCALE
1. THESE PLANS WERE PREPARED SOLELY AS A GUIDE FOR THE CONTRACTOR IN DEFINING LIMITS OF WORK AND GENERAL LOCATION OF THE PROPOSED IMPROVEMENTS. THEY WERE COMPILED FROM EXISTING RIDOT CONSTRUCTION DRAWINGS. THEY ARE NOT TRUE TO SCALE. ACCORDINGLY, ALL DIMENSIONS AND DISTANCES SHOULD BE VERIFIED AND/OR ADJUSTED IN THE FIELD, AS REQUIRED, TO PROPERLY ACCOMPLISH THE INTENT OF THE DESIGN.

Gordon R. Archibald, Inc.
Civil and Environmental Engineers
Pawtucket, Rhode Island

REVISIONS			RHODE ISLAND DEPARTMENT OF TRANSPORTATION	
NO.	DATE	BY		
			I - 95 RESURFACING - 2B CHARLES STREET TO LONSDALE AVENUE	
			PROVIDENCE, PAWTUCKET, RHODE ISLAND	
			GENERAL PLAN - 14	
			CHECKED BY _____ DATE _____ SCALE 1" = 40'	

