



**REQUEST FOR QUOTE (RFQ) – BID# 7599793**

**2019-CB-101 BRIDGE GROUP 62 - MANVILLE AVENUE BRIDGE**

**SUBMISSION DEADLINE: Friday, October 18, 2019 at 02:00 PM (ET)**

**PRE-BID CONFERENCE:**

☒ **NO**  
☐ **YES** \_\_\_\_\_

**Mandatory:** ☐ **NO**

☐ **YES:** Any vendor who intends to submit a bid proposal in response to this solicitation must have its designated representative attend the mandatory pre-bid conference. The representative must register at the pre-bid conference and disclose the identity of the vendor whom he/she represents. Because attendance at the pre-bid conference is mandatory, a vendor's failure to attend and register at the pre-bid conference shall result in disqualification of the vendor's bid proposal as non-responsive to the solicitation.

*Lisa Hill*

**Buyer Name:** Lisa Hill

**Title:** Assistant Administrator

**QUESTIONS** Prospective bidders are hereby notified that all questions pertaining to this contract must be submitted to the Department of Transportation in writing through its website at <http://www.dot.ri.gov/contracting/bids> by accessing the questions & answers menu located within the 'contracting', then 'bidding opportunities' link. Response to the submitted questions will also be posted under this link, phone calls will not be accepted.

**SURETY REQUIRED:** YES

**BOND REQUIRED:** YES

**DISK BASED BID:** ☐ **NO**

☒ **YES:** See attached Disk Based Bidding Information

**NOTE TO VENDORS:**

Vendors must register on-line at the Rhode Island Division of Purchases website at [www.purchasing.ri.gov](http://www.purchasing.ri.gov). Offers received without the completed four-page Rhode Island Vendor Information Program (RIVIP) Generated Bidder Certification Cover Form attached may result in disqualification.

**THIS IS NOT A BIDDER CERTIFICATION FORM**



State of Rhode Island Department of Administration  
Division of Purchases

**RHODE ISLAND DEPARTMENT OF TRANSPORTATION**

**REVISED**  
**November 20, 2013**

**NOTICE TO VENDORS**

Each bid proposal for a *public works project* must include a "public copy" to be available for public inspection upon the opening of bids. **Bid proposals that do not include a copy for public inspection will be deemed nonresponsive.**

To comply with this requirement, *in addition to* the Quest Lite compatible electronic copy and one hard copy, bid proposals for *highway and bridge public works projects* must also include a duplicate original of the Quest Lite compatible electronic copy on a *read-only* CD-R media disc as the "public copy."

The public copy disc must be separately enclosed in a protective cover clearly marked "Public Copy" and include the following information (all available from the Bidder Certification Cover Form): (1) title of solicitation; (2) name of bidder and RIVIP vendor ID number; (3) bid number; and (4) date of bid.

The public copy may redact any trade secrets or commercial or financial information which is of a privileged or confidential nature pursuant to the "Access to Public Records Act," R. I. Gen. Laws §§ 38-2-1 *et seq.*

For further information on how to comply with this statutory requirement, see R. I. Gen. Laws §§ 37-2-18(b) and (j). Also see Procurement Regulations 5.11, 5.13, and 12.102.05 accessible at [www.purchasing.ri.gov](http://www.purchasing.ri.gov).

**State of Rhode Island and Providence Plantations  
Department of Transportation**

**Notice to Contractors  
Special Provisions  
Proposal  
Contract Agreement  
Contract Bond**

**for the Performance of**

**Rhode Island Contract Number: 2019-CB-101**

**Rhode Island Federal-Aid\State-Aid Project                      BRO-0396(002)  
Numbers:**

**Project:      Bridge Group 62 - Manville Br**

**Limits:      Sta. -1+10 - Sta. 8+40.00**

**City/Town: Cumberland**

**County:      PROVIDENCE**

**Submitted By:** \_\_\_\_\_

**Address:** \_\_\_\_\_

\_\_\_\_\_

\_\_\_\_\_

**Name of Surety:** \_\_\_\_\_

**Total Bid:** \_\_\_\_\_

**(BIDDER MUST FILL IN ALL ABOVE SPACES)**

The basis of award of the Contract will be the total bid for all quantities of work in the proposal subject to review and correction as provided for in the Rhode Island Department of Transportation Standard Specifications for Road and Bridge Construction and Standard Details.

NOTE: The State of Rhode Island Standard Specifications for Road and Bridge Construction and Standard Details consists of the following:

- The Rhode Island Standard Specifications for Road and Bridge Construction, Amended December 2010, with all revisions.
- The Rhode Island Standard Details, 1998 Edition, with all revisions.
- The Rhode Island Bridge Standard Details, 2010 Edition, with all revisions.
- The Division of Purchases Procurement Regulations Adopted December 2010.

**\* Refer to Section 12.102.05 PREPARATION OF PROPOSAL of the STATE OF RHODE ISLAND  
PROCUREMENT REGULATIONS regarding the use of Quest Lite software for bid preparation.**

The above documents may be obtained at the Rhode Island Department of Transportation, Contracts and Specifications Office, upon request.

**STATE OF RHODE ISLAND AND PROVIDENCE PLANTATIONS  
DEPARTMENT OF ADMINISTRATION - DIVISION OF PURCHASES**

**NOTICE TO HIGHWAY AND BRIDGE CONTRACTORS**

Sealed Proposals addressed to the State Purchasing Agent, Rhode Island Department of Administration, Division of Purchases, One Capitol Hill, Providence, Rhode Island 02903, will be opened and read in public on October 18, 2019 at 2:00PM. All bidders MUST register online at [www.purchasing.ri.gov](http://www.purchasing.ri.gov). A Bidder Certification Cover Sheet MUST accompany each bid. Bid item description and quantities estimated for this project will also be available online. Should you need assistance in registering or downloading a bid, call (401) 222-3766. Failure to comply will result in mandatory disqualification per Item 4 of Section 12.102.12 of the Division of Purchases Procurement Regulations Adopted December 2010 and RI General Law 37-2-17 which references the RI Vendor Information Program (RIVIP).

**DESCRIPTION: Rhode Island Contract No. 2019-CB-101, Federal-Aid Project No. BRO-0396(002), is for the Replacement of Manville Bridge No. 396, Main Street/Manville Hill Rd over the Blackstone River, Blackstone River Bike Way, and the Providence and Worcester Railroad (P&W) Main Line, in the Towns of Lincoln and Cumberland, Providence County, Rhode Island. Coordination will be required with P&W and the Rhode Island Department of Environmental Management for access to and work around the existing railroad and bike path facilities.**

**The work associated with the Replacement of Manville Bridge No. 396 generally consists of, but is not limited to (a) soil strengthening behind the existing abutments, (b) removing and disposing the existing superstructure and portions of the existing substructure, (c) modifying the existing substructure units, (d) performing concrete and masonry substructure repairs, (e) installing a new composite steel beam/concrete deck superstructure with concrete sidewalks, granite curb, metal railing, and an asphalt wearing surface, (f) installing approach slabs and moment slabs, and (g) relocating an existing gas main supported on the bridge. The work will be conducted in a single phase with the bridge closed to traffic during construction. A detour will be posted during the closure**

**Roadway work associated with the project generally consists of, but is not limited to (a) full depth reconstruction of the bridge approaches, (b) micro-milling and overlay, (c) adjustment and replacement of roadway utility structures (such as frame & cover, frames & grates, gate valve boxes, etc.), (d) cleaning and flushing drainage structures, (e) removing, resetting and installing new curbing and sidewalk at the specified locations within the project limits, (f) installing pavement markings, and (g) signal improvements.**

**Overhead utilities and an underground gas main are present at Bridge No. 396. The overhead utilities are to remain in place during construction. The gas main supported on the bridge will be relocated to another location on the bridge.**

**The project wide installation of erosion controls and maintenance and protection of traffic will be required during the construction period along with all other incidentals complete in place and accepted by the Resident Engineer.**

**The Contractor will be required, in accordance with the provisions of the Disadvantaged Business Enterprise Affirmative Action Certification for Contractors and Consultants, to meet the established Race-Conscious Goal, or Contract Goal, of not less than 5.00 percent of the contract bid price, to the Contractors, Subcontractors, and/or suppliers which qualify as Disadvantaged Business Enterprises (DBE's). Failure by the Contractor to demonstrate every good faith effort in fulfilling its DBE commitment during the construction period will result in the reduction in contract payments by the amount determined by multiplying the awarded contract value by the established DBE percentage, and subtracting the dollar value of the work actually performed by DBE contractors. This action will not preclude RIDOT from imposing sanctions or other remedies available as specified in paragraph (I)(C) of the Disadvantaged Business Enterprise Affirmative Action Certification for Contractors and Consultants.**

Computer Disks for competitive bidding for the above described work will be furnished by the Department of Transportation, Division of Administrative Services, Contracts & Specifications Office, Room 108, Two Capitol Hill, Providence, Rhode Island, 02903, Tel.Number (401) 222-2495. The Plans, Specifications and Special Provisions may also be examined on or after September 27, 2019 every weekday except holidays between the hours of 8:00 AM and 4:00 PM.

The Bid Package consists of a single compact disk (CD) containing the following items: Construction Plans, Standard Specifications for Road and Bridge Construction, Compilations of Approved Specifications, Required Contract Provisions for Federal-Aid Construction Contracts, RI Division of Purchases Procurement Regulations, General Provisions, Rhode Island Standard Details, Rhode Island Bridge Standard Details, Federal Wage Rates, Contract-Specific General Provisions, Job-Specific Specifications, Distribution of Quantities, Appendices (if applicable), Quest Lite bid file, Quest Lite installation software and a Quest Lite User Manual. Only complete bid packages will be issued.

RIDOT is currently in the process of acquiring the right-of-way which consists of four (4) temporary easements that are necessary for construction. We anticipate Right-of-Way Certification will be issued on or before November 22, 2019. All right-of-way actions are being performed in compliance with the Uniform Relocation Assistance and Real Property Acquisition Policies Act of 1970 for federally-assisted projects. Additionally, the construction contract should not be awarded and notice to proceed cannot be issued until the right-of-way is certified to confirm the Department has both physical and legal possession of the areas needed for construction.

Prospective Bidders are hereby notified that all questions pertaining to this Contract must be submitted to the Department of Transportation in writing through its website at <http://www.dot.ri.gov/contracting/bids/> by accessing the Questions & Answers Menu located within the "Contracting", then "Contract Opportunities" link. Responses to the submitted questions will also be posted under this link. PHONE CALLS WILL NOT BE ACCEPTED.

For help with RIDOT's Quest Lite bid preparation software, please contact the Contracts & Specifications Office, Room 108, Two Capitol Hill, Providence, Rhode Island, 02903, Tel. Number (401)-222-2495 or e-mail [Quest@dot.ri.gov](mailto:Quest@dot.ri.gov).

Please also note that all Bidding Documents required to be submitted and in fact submitted to the Purchasing Agent as part of a bid will be considered returned to the State and need not be returned to RIDOT.

A bid bond payable to the State of Rhode Island, in the amount of 5% of the total or gross sum of the bid must be furnished by each bidder. The Proposal Guaranty will be furnished by surety companies authorized/licensed to do business in the State of Rhode Island. The State reserves the right to retain the surety of all bidders until the successful bidder enters into the Contract or until such time as the award or cancellation of the Contract is announced at which point Sureties will be returned to all bidders by the State of Rhode Island. A performance bond of one hundred (100) percent of the contract price with a satisfactory surety company will be required of the successful bidder. All surety companies must be listed with The Department of the Treasury, Fiscal Services, Circular 570, (Latest Revision published by the Federal Register). The Department of Transportation reserves the right to reject any or all bids.

Required Contract Provisions - The attention of prospective bidders is called to the fact that this project is to be bid upon and the contract executed subject to all applicable federal laws and regulations for carrying out the provisions of the Federal-Aid Highway program..

Wages of labor on Federal -Aid Highway Projects - the prevailing rate of wages for laborers and mechanics employed by contractors or subcontractors on the initial construction of highway projects on the Federal - Aid Highway System, authorized under the Federal Highway Act of 1968, shall be paid wages at rates not less than those prevailing on the same type of work on similar construction in the immediate locality as determined by the United States Secretary of Labor, in accordance with the Act of August 30, 1935, known as the Davis - Bacon Act, under Decision Nos. 1 through 6 as applicable.

Prevailing wage rates and Davis - Bacon Wage Determination Reference Materials are available online at [www.purchasing.ri.gov](http://www.purchasing.ri.gov). It is advisable to print only the pages applicable to this bid; the rates active on the Rhode Island Vendor Information Program's bid solicitation date for this project are applicable for the duration of the contract resulting from this bid.

Work Hours Act of 1962 - This contract is subject to Work Hours Act of 1962, Public Law 87-581 and implementing regulations.

There will be no Pre-Bid Conference scheduled for this project.

## **SPECIAL NOTE**

ANY REFERENCE TO THE RHODE ISLAND DEPARTMENT OF PUBLIC WORKS OR THE DIRECTOR OF PUBLIC WORKS SHOULD BE REVISED TO THE RHODE ISLAND DEPARTMENT OF TRANSPORTATION AND THE DIRECTOR OF TRANSPORTATION RESPECTIVELY.

## **NOTICE TO ALL BIDDERS**

The Rhode Island Department of Transportation, in accordance with Title VI of the Civil Rights Act of 1964, 42 U.S.C. §§ 2000d - 2000d-4 and 49 C.F.R. Part 21, Nondiscrimination in Federally-Assisted Programs of the Department of Transportation - Effectuation of Title VI of the Civil Rights Act of 1964, issued pursuant to such Act, hereby notifies all bidders that it will affirmatively insure that in any contract entered into pursuant to this advertisement, Disadvantaged Business Enterprises will be afforded full opportunity to submit bids in response to this invitation and will not be discriminated against on the grounds of race, color, sex, national origin, age, or disability in consideration for an award.

To report bid rigging activities call: **1-800-424-9071**

The U.S. Department of Transportation (DOT) operates the above toll-free hotline Monday through Friday, 8:00 a.m. to 5:00 p.m. eastern time. Anyone with knowledge of possible bid rigging, bidder collusion, or other fraudulent activities should use the hotline to report such activities.

The hotline is part of the DOT's continuing effort to identify, and investigate highway construction contract fraud and abuse and is operated under the direction of the DOT Inspector General. All information will be treated confidentially and caller anonymity will be respected.

**Item List**

Date: 9/20/2019

Estimate Name - Advertising  
 Project Name - Bridge Group 62 - Manville Br  
 R.I. Contract No. - 2019-CB-101  
 FAP Nos. - BRO-0396(002)

Seq No.	Item Code	Description	Quantity	UM
001	201.0301	CUTTING AND DISPOSING ISOLATED TREES AND STUMPS (4" - 24")	1.00	EACH
002	201.0401	REMOVE AND DISPOSE GRANITE CURB	465.00	LF
003	201.0402	REMOVE AND DISPOSE CONCRETE CURB	263.00	LF
004	201.0403	REMOVE AND DISPOSE SIDEWALKS	611.00	SY
005	201.0409	REMOVE AND DISPOSE FLEXIBLE PAVEMENT	2,321.00	SY
006	201.0414	REMOVE AND DISPOSE PIPE - ALL SIZES	330.00	LF
007	201.0415	REMOVE AND DISPOSE GUARDRAIL AND POST ALL TYPES	190.00	LF
008	201.0428	REMOVE AND DISPOSE FRAME AND GRATE OR FRAME AND COVER	1.00	EACH
009	201.0610	REMOVE AND DISPOSE DIRECTIONAL, WARNING, REGULATORY, SERVICE, AND STREET SIGNS	16.00	EACH
010	201.9901	REMOVE AND SALVAGE TRAFFIC SIGNAL EQUIPMENT AT TRAFFIC SIGNAL NO. 108	1.00	LS
011	201.9952	SAMPLING AND TESTING CONTAMINATED SOIL	5.00	EACH
012	201.9954	REMOVE, STOCKPILE, HANDLE, HAUL, AND DISPOSE CONTAMINATED SOIL	150,000.00	EACH
013	202.0100	EARTH EXCAVATION	741.00	CY
014	202.0201	ROCK EXCAVATION MECHANICAL	40.00	CY
015	203.0100	STRUCTURAL EXCAVATION EARTH	630.00	CY
016	203.0700	PERVIOUS FILL	485.00	CY
017	203.9901	CONTROL OF WATER BRIDGE NO. 039601	1.00	LS
018	204.0100	TRIMMING AND FINE GRADING	4,231.00	SY
019	206.0301	COMPOST FILTER SOCK	3,774.00	LF
020	209.9901	INLET SEDIMENT CONTROL DEVICE	11.00	EACH
021	212.2100	MAINTENANCE AND CLEANING OF EROSION AND POLLUTION CONTROLS	1.00	LS
022	213.0100	PLACEMENT OF MILLINGS BENEATH GUARDRAIL	220.00	LF
023	302.0100	GRAVEL BORROW SUBBASE COURSE	606.00	CY
024	401.1000	CLASS 19.0 HMA	430.00	TON
025	401.2100	MODIFIED CLASS 12.5 HMA	433.00	TON
026	401.4100	MODIFIED CLASS 4.75 HMA	121.00	TON
027	403.0300	ASPHALT EMULSION TACK COAT	5,954.00	SY
028	601.0300	CLASS A PORTLAND CEMENT CONCRETE	35.00	CY
S029	700.9901	UTILITY LOCATING	1.00	LS
S030	700.9903	8-INCH STEEL GAS MAIN	315.00	LF
031	702.0516	FRAME AND GRATE, HIGH CAPACITY, STANDARD 6.3.4	1.00	EACH

## Item List

Date: 9/20/2019

Estimate Name - Advertising  
 Project Name - Bridge Group 62 - Manville Br  
 R.I. Contract No. - 2019-CB-101  
 FAP Nos. - BRO-0396(002)

Seq No.	Item Code	Description	Quantity	UM
032	702.0542	GRANITE APRON STONE 5FT. STANDARD 7.3.7	1.00	EACH
033	702.0543	GRANITE APRON STONE 38" STANDARD 7.3.8	1.00	EACH
034	707.1000	ADJUST SANITARY MANHOLE	8.00	EACH
035	707.1900	ADJUST FRAME & COVER TO GRADE	6.00	EACH
036	707.2000	ADJUST FRAME AND GRATE TO GRADE	11.00	EACH
037	708.9040	CLEANING AND FLUSHING PIPE ALL SIZES	750.00	LF
038	708.9041	CLEANING CATCH BASINS ALL TYPES AND SIZES	11.00	EACH
039	711.0110	3" PAVED WATERWAY CLASS I-1 STANDARD 8.4.0	14.00	SY
040	713.8269	ADJUST WATER GATE BOXES TO GRADE	2.00	EACH
041	713.8300	ADJUST GAS GATE BOXES TO GRADE	13.00	EACH
042	800.9901	MANVILLE BRIDGE NO. 396	1.00	LS
043	803.0100	REMOVE AND DISPOSE EXISTING SUPERSTRUCTURE	1.00	LS
044	803.0300	PARTIAL REMOVAL AND DISPOSAL OF EXISTING CONCRETE MASONRY	230.00	CY
045	803.0500	TEMPORARY DECK UNDERSIDE AND SIDE PROTECTIVE SHIELDING	28,200.00	SF
S046	804.9902	CONCRETE MICROPILES	97.00	EACH
S047	804.9903	PILE LOAD TEST	4.00	EACH
048	810.0210	GALVANIZED BAR REINFORCEMENT GRADE 60	200.00	LBS
049	810.0702	WELDED WIRE FABRIC (GALVANIZED)	200.00	SF
050	817.2112	REPAIRS TO STRUCTURE CONCRETE MASONRY - PATCHING MORTAR	61.00	CF
051	836.0100	STRUCTURAL CONCRETE CRACK REPAIR BY EPOXY-RESIN BASE ADHESIVE INJECTION	20.00	LF
S052	901.0191	GUARDRAIL STEEL BEAM ANCHORAGE TRAILING END SECTION STANDARD 34.3.4	1.00	EACH
S053	901.0193	GUARDRAIL STEEL BEAM SINGLE FACE STANDARD 34.2.0	160.00	LF
S054	901.0199	GUARDRAIL END TREATMENT, ENERGY ABSORBING TERMINAL	2.00	EACH
055	903.0410	TEMPORARY CHAIN LINK FENCE	360.00	LF
056	903.0411	TEMPORARY CHAIN LINK GATE	2.00	EACH
057	905.0110	PORTLAND CEMENT SIDEWALK MONOLITHIC STANDARD 43.1.0	62.00	CY
058	905.0115	PORTLAND CEMENT CONCRETE DRIVEWAY STANDARD 43.5.0	5.00	CY
059	906.0110	GRANITE CURB, QUARRY SPLIT STRAIGHT, STANDARD 7.3.0	208.00	LF
060	906.0111	GRANITE CURB, QUARRY SPLIT CIRCULAR, STANDARD 7.3.0	115.00	LF
061	906.0118	6' GRANITE TRANSITION CURB, QUARRY SPLIT SPECIAL TRANSITION STANDARD 7.3.2	6.00	EACH
062	906.0119	3' GRANITE TRANSITION CURB STANDARD 7.3.1	2.00	EACH



**Item List**

Date: 9/20/2019

Estimate Name - Advertising  
 Project Name - Bridge Group 62 - Manville Br  
 R.I. Contract No. - 2019-CB-101  
 FAP Nos. - BRO-0396(002)

Seq No.	Item Code	Description	Quantity UM
063	906.0120	GRANITE WHEELCHAIR RAMP CURB STANDARDS 7.3.3, 43.3.0 AND 43.3.1	16.00 EACH
064	906.0130	GRANITE RAMP STONE STRAIGHT STANDARD 7.3.9	4.00 EACH
065	906.0131	GRANITE RAMP STONE CIRCULAR STANDARD 7.3.9	4.00 EACH
066	906.0700	REMOVE, HANDLE, HAUL TRIM RESET CURB EDGING, STRAIGHT, CIRCULAR ALL TYPES	390.00 LF
067	907.0100	WATER FOR DUST CONTROL	72.00 MGA L
068	914.5010	FLAGPERSONS	2,250.00 MHRS
069	914.5020	FLAGPERSONS - OVERTIME	225.00 MHRS
070	916.0600	SHOCK ABSORBING BARRIER MODULES	1.00 GRP
071	919.0101	TEST PITS	5.00 EACH
072	922.0100	TEMPORARY CONSTRUCTION SIGNS STANDARD 29.1.0 AND 27.1.1	1,133.50 SF
073	923.0105	DRUM BARRICADE STANDARD 26.2.0	12,000.00 BDAY
074	923.0120	PLASTIC PIPE BARRICADE STANDARD 26.3.0	15.00 EACH
075	923.0200	FLUORESCENT TRAFFIC CONES STANDARD 26.1.0	55.00 EACH
076	923.9901	LONGITUDINAL CHANNELIZING DEVICES	72.00 LF
077	925.0112	PORTABLE CHANGEABLE MESSAGE SIGN	7,650.00 PDAY
078	926.9901	UNANCHORED BARRIER FOR TEMPORARY TRAFFIC CONTROL (MASH TL-3)	110.00 LF
079	929.0110	FIELD OFFICE	24.00 PMO
080	931.0110	CLEANING AND SWEEPING PAVEMENT	131.00 HSY
081	932.0100	CUTTING AND MATCHING ASPHALT	380.00 LF
082	932.0200	FULL-DEPTH SAWCUT OF BITUMINOUS PAVEMENT	1,015.00 LF
083	932.0220	FULL DEPTH SAWCUT OF BITUMINOUS SIDEWALK/DRIVEWAY	22.00 LF
084	932.0230	FULL DEPTH SAWCUT OF PORTLAND CEMENT CONCRETE SIDEWALK/DRIVEWAY	45.00 LF
085	935.0400	REMOVING BITUMINOUS PAVEMENT BY MICRO MILLING	3,386.00 SY
086	936.0100	MOBILIZATION AND DEMOBILIZATION	1.00 LS
087	937.0200	MAINTENANCE AND MOVEMENT TRAFFIC PROTECTION	1.00 LS
088	942.0200	DETECTABLE WARNING PANEL STANDARD 48.1.0	88.00 SF
089	943.0200	TRAINEE MAN-HOURS	1,300.00 MHRS
S090	L01.0102	LOAM BORROW 4 INCHES DEEP	1,207.00 SY
S091	L02.0102	RESIDENTIAL SEEDING (TYPE 2)	1,207.00 SY
092	L06.0513	WOOD CHIPS FURNISH AND SPREAD 4" DEPTH	40.00 SY
093	L10.0101	MECHANICAL TREE AND SHRUB ROOT PRUNING	100.00 LF

**Item List**

Date: 9/20/2019

Estimate Name - Advertising  
 Project Name - Bridge Group 62 - Manville Br  
 R.I. Contract No. - 2019-CB-101  
 FAP Nos. - BRO-0396(002)

Seq No.	Item Code	Description	Quantity	UM
094	L11.0103	SHRUB PLANT PROTECTION DEVICE STANDARD 51.2.0	250.00	LF
095	L11.0104	DRIP-LINE TREE PROTECTION DEVICE STANDARD 51.1.1	110.00	LF
S096	T04.5303	14 AWG 3 CONDUCTOR CABLE	666.00	LF
S097	T04.5305	14 AWG 5 CONDUCTOR CABLE	384.00	LF
S098	T04.5307	14 AWG 7 CONDUCTOR CABLE	166.00	LF
099	T04.9901	VIDEO DETECTION CABLE	565.00	LF
S100	T05.0400	BREAK INTO EXISTING HANDHOLE	2.00	EACH
101	T05.1030	ADJUST HANDHOLE TO GRADE	3.00	EACH
S102	T06.5130	3 INCH SCHEDULE 40 POLYVINYL CHLORIDE PLASTIC CONDUIT - UNDERGROUND	35.00	LF
S103	T11.2008	TRAFFIC SIGNAL STANDARD,8 FOOT,STD 19.4.0 ALUMINUM PEDESTAL POLE AND FOUNDATION	2.00	EACH
S104	T12.9901	MODIFY TRAFFIC SIGNAL CONTROLLER AND CABINET	1.00	LS
105	T12.9902	VIDEO DETECTION SYSTEM HARDWARE UNIT	4.00	EACH
106	T12.9903	VIDEO DETECTION SYSTEM MONITOR	1.00	EACH
S107	T13.8210	ACCESSIBLE PEDESTRIAN DETECTOR - PUSHBUTTON WITH SIGN	6.00	EACH
108	T13.9901	VIDEO DETECTION CAMERA	4.00	EACH
S109	T14.9901	RETROFIT EXISTING PEDESTRIAN SIGNAL WITH COUNTDOWN TIMER	2.00	EACH
S110	T14.9902	RETROFIT EXISTING TWO-WAY PEDESTRIAN SIGNAL WITH COUNTDOWN TIMER	1.00	EACH
S111	T14.9903	ONE-WAY BRACKET MOUNTED LED PEDESTRIAN SIGNAL WITH COUNTDOWN TIMER 12-INCH	2.00	EACH
S112	T15.0100	DIRECTIONAL REGULATORY AND WARNING SIGNS	85.00	SF
113	T18.9901	GUARDRAIL END DELINEATOR- RED	2.00	EACH
114	T18.9902	GUARDRAIL END DELINEATOR- GREEN	1.00	EACH
S115	T20.0706	6 INCH WHITE WATERBORNE PAINT PAVEMENT MARKINGS	1,720.00	LF
S116	T20.0712	12 INCH WHITE WATERBORNE PAINT PAVEMENT MARKINGS	1,350.00	LF
S117	T20.0904	4 INCH YELLOW WATERBORNE PAINT PAVEMENT MARKINGS	1,987.00	LF
118	T20.1410	WATERBORNE PAINT PAVEMENT MARKING WORD ("ONLY", "STOP", "YIELD", "AHEAD", "XING", "SCHOOL", OR OTHER) STANDARD 20.1.0	4.00	EACH
S119	T20.2406	6 INCH WHITE FINAL EPOXY RESIN PAVEMENT MARKINGS	1,720.00	LF
S120	T20.2412	12 INCH WHITE FINAL EPOXY RESIN PAVEMENT MARKINGS	1,350.00	LF

**Item List**

Date: 9/20/2019

Estimate Name - Advertising  
 Project Name - Bridge Group 62 - Manville Br  
 R.I. Contract No. - 2019-CB-101  
 FAP Nos. - BRO-0396(002)

Seq No.	Item Code	Description	Quantity UM
S121	T20.2506	6 INCH WHITE INTERIM EPOXY RESIN PAVEMENT MARKINGS	1,840.00 LF
122	T20.2512	12 INCH WHITE INTERIM EPOXY RESIN PAVEMENT MARKINGS	1,350.00 LF
S123	T20.2804	4 INCH YELLOW FINAL EPOXY RESIN PAVEMENT MARKINGS	1,987.00 LF
S124	T20.2904	4 INCH YELLOW INTERIM EPOXY RESIN PAVEMENT MARKINGS	1,675.00 LF
125	T20.3410	FINAL EPOXY RESIN PAVEMENT MARKING WORD ("ONLY", "STOP", "YIELD", "AHEAD", "XING", "SCHOOL", OR OTHER) STANDARD 20.1.0	4.00 EACH
126	T20.4506	REMOVE PAVEMENT MARKING LINE - LESS THAN OR EQUAL TO 6 INCHES WIDE	3,515.00 LF
127	T20.4508	REMOVE PAVEMENT MARKING LINE - GREATER THAN 6 INCHES WIDE	1,350.00 LF
128	T20.4520	REMOVE PAVEMENT MARKING WORD ("ONLY", "STOP", "YIELD", "AHEAD", "XING", "SCHOOL", OR OTHER)	4.00 EACH

RHODE ISLAND DEPARTMENT OF TRANSPORTATION

**\* THIS IS A DISK-BASED BID \***

**ELECTRONIC BIDDING  
PROCEDURE NOTICE**

**ALL BID OFFERS MUST BE PREPARED USING THE QUEST LITE BID  
PREPARATION SOFTWARE PACKAGE**

Bidders MUST register in person at the RIDOT Contract Administration office to obtain the necessary Bidder Registration and Digital ID codes for the Quest Lite software.

**RIDOT Provides:**

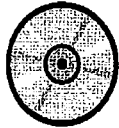

CD

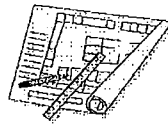

Plans (on CD)

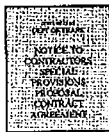

Contract Documents  
(on CD)



DOQ Report  
(on CD)

**Bidder Must Submit:**

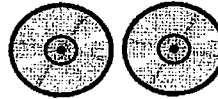

2 High-Density  
Compact Disks  
(CDs) w/Quest Lite  
Bid "zip" file\*\*



Completed &  
Signed Proposal  
(Hard Copy)

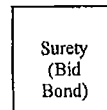

Bid Surety  
(Hard Copy)

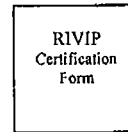

Completed & Signed  
(Hard Copy)

Contact the Contracts & Specifications Office at 222-2495 to request technical assistance on issues directly related to the Quest Lite software  
Office Hours: 8:00 AM – 4:00 PM

**\*\*Refer to the RIDOA "Notice to Contractors" for additional information on the  
"Public Copy" submission requirements.**

**NO BID OFFER WILL BE CONSIDERED**

**UNLESS ACCOMPANIED BY A COMPACT DISK (CD)**

**CONTAINING THE BID PROPOSAL FILE**

**GENERATED BY THE QUEST LITE BID PREPARATION SOFTWARE**

*Failure to comply will result in a mandatory disqualification per Section 12.102.07 of the RI  
Dept of Administration Division of Purchases Procurement Regulations*

Rhode Island Department of Transportation (RIDOT)

**Notice to Contractors**

**THIS IS A DISK-BASED BID**

Bid offers will be accepted *only on a CD generated by RIDOT-supplied software called Quest Lite; each CD must be accompanied by a hard copy signed offer printed from the software and submitted at the Bid Opening.* Minimum computer hardware and operating system requirements are listed here. *Training is strongly recommended for all new bidders and others unfamiliar with these procedures. SEE BELOW.*

**CONTACT:** **RIDOT CONTRACTS & SPECIFICATIONS**  
Rm. 108, Two Capitol Hill, Providence, RI 02903  
Phone: **401-222-2495**  
Hours: **Mon – Fri, 8:00AM – 4:00PM**

**1. Required Registration Codes for Each Bidder.**

Registration Codes for RIDOT software are necessary to install and use the software; a firm only needs to register once to acquire secure, unique bidder identification codes to be used with all RIDOT disk-based construction project bids. Bidders must retain these codes for future use.

**2. The required Quest Lite installation software and all applicable Contract Documents are provided on a CD-ROM.**

The Contract Documents include the RI DOA Division of Purchases Procurement Regulations, RI Standard Specifications, Amended December 2010 and all revisions, the RI Standard Details for Highway and Bridge Construction, Bridge Standard Details, General Provisions, Special Provisions, Distribution of Quantities and Engineering Plans, and all other applicable documents

**3. Minimum Computer Hardware and Operating System Requirements.**

- Windows XP SP2 w/Pentium IV processor
- CD-ROM Drive, Floppy Drive, Printer & 15" Monitor (17" recommended)
- 20GB Hard Disk with 1GB free (40 GB with 5 GB free recommended)
- 512 MB RAM (1 GB recommended)
- 32 MB Video Card (64 MB SVGA recommended)
- Internet Explorer 6.0 SP 2

**4. Addenda, when necessary, are available on Purchases' RIVIP website.**

**at:** <http://www.purchasing.ri.gov/RIVIP/BidSearch.asp>

RIDOT will make all necessary addenda available at Purchases' web site. It is the plan-holders responsibility to poll the RIVIP to keep up-to-date on addenda.

**5. Training may be requested up to three days prior to the Bid Opening.**

Training is provided on request. Arrangements must be made through the RIDOT Contracts & Specifications Office at least three (3) days prior to the Bid Opening of the project.

**6. Technical Support.**

Assistance is available upon request by contacting the Contracts & Specifications office during work hours or emailing [Quest@dot.ri.gov](mailto:Quest@dot.ri.gov).

01/25/2011

# NOTICE TO HIGHWAY AND BRIDGE CONTRACTORS

Rhode Island Department of Transportation (RIDOT)  
Contracts and Specifications

## ELECTRONIC BIDDING PROCEDURES QUEST LITE UPGRADE

Effective January 1, 2011, bid offers for all RIDOT Contracts requiring the use of the Department's Quest Lite bid preparation software **MUST** be prepared using **Quest Lite Version 040408 (2.8.4)**. Failure to comply with this requirement could result in the disqualification of your bid offer.

Full installation and upgrade-only software packages, including installation directions, for Quest Lite Version **040408 (2.8.4)** will be provided on the Project Advertising CD's, which are available to prospective bidders through the Contracts and Specifications office on or after the scheduled project advertising date.

Contractors presently using Quest Lite Version 040407 (2.8.3) need only install the upgrade package to complete the conversion, **UNLESS** a previous upgrade installation was used to upgrade from 2.8.2 to 2.8.3, in which case these installations must be removed and the full installation performed. Earlier versions (2.8.2 or lower) will require the full installation in all instances.

For technical assistance, contact the Contracts and Specifications office at 222-2495.

01/21/11

## QUEST LITE VERSION 4.4.8 (2.8.4)

### UPGRADE & FULL INSTALLATION

All bid offers prepared using the Department of Transportation's Quest Lite software must use the Quest Lite Version 040408 (2.8.4). If there is no Quest Lite installation, then the full installation must be completed. For earlier versions of Quest Lite, either the upgrade or full installation will be required to be completed. Both versions (upgrade and full installation) are provided on this project CD.

Before proceeding with any installations, note the following:

1. All users must register with the Department of Transportation in order to use Quest Lite. At the time of registration, users are provided with a set of unique company ID codes (Site Code, Bidder Code and company Short Name). Users **MUST RETAIN** these codes for future use.
2. Many users who currently have Quest Lite installed will only require the installation of the upgrade version. To determine if the upgrade installation is sufficient, the present version of the Quest Lite installation must be determined. This is accomplished in Quest Lite by clicking on Help/About. If the present version is 040407 (2.8.3) then the upgrade installation is sufficient **unless** an upgrade version has been previously used to upgrade version 2.8.2 to 2.8.3.
3. For earlier installations (versions below 2.8.3, and if an upgrade has been previously installed to upgrade to version 2.8.3), the full installation of Quest Lite is required. (Note: if the full installation is required, the upgrade installation **does not** need to be performed after the full installation is completed.)
4. To determine if an upgrade version of Quest Lite version is present, it is generally easiest to use the "Add or Remove Programs" function from the Control Panel to view the Quest Lite installations. Should both an installation and an upgrade version be installed, both programs must be removed using the "Remove" function and the new version 2.8.4 installed.
5. It is recommended that users consult the Quest Lite User Manual provided on this CD prior to attempting the installation of the upgrade or full program installation.
6. After completing the installation of the upgrade or full installation, it is recommended that a test bid be submitted to the Department to ensure the program is functioning correctly and that the Quest Lite bid files can be correctly imported into the Department's Quest program. **Test bids may be submitted on a CD to the Contracts office in Room 109 of the RIDOT Headquarters, or by e-mail to [Quest@dot.ri.gov](mailto:Quest@dot.ri.gov).**

### **Installation Instructions – Upgrade Version**

Upgrade Quest Lite only if the current installed version is 2.8.3, and a previous upgrade has not been installed.

1. Close Quest Lite before attempting the installation.
2. Using the project CD, double-click on the “Upgrade Only” option provided on the Start page.
3. When prompted for a password, enter “ridot”.
4. Follow the instructions provided in the installation wizard to complete the installation.
5. When executing Quest Lite for the first time after installing the upgrade, users may be prompted to enter their company bidder codes.

### **Installation Instructions – Complete Installation**

A complete Installation of the software is required only if Quest Lite is:

1. Not installed on the computer/laptop; or
2. The installed version of Quest Lite is older than 2.8.3, i.e. 2.8.2 or under; or
3. The 2.8.3 upgrade version of Quest Lite is installed.

If any of 1 through 3 above apply, follow these instructions:

1. If a Quest Lite version 2.8.2 or older, or a 2.8.3 upgrade are currently installed,
  - a. Close Quest Lite.
  - b. Remove all the existing installation(s) of Quest Lite. To accomplish this, follow the instructions provided on pages 19 – 25 of the Quest Lite User Manual provided with this project CD. Follow the installation removal directions for the operating system in use on the machine.
2. Using the project CD, double-click on the “Complete Installation” option provided on the Start page.
3. When prompted for a password, enter “ridot”.
4. Follow the instructions provided in the installation wizard to complete the installation.
5. When executing Quest Lite for the first time after completing the installation, the user will be prompted to enter the company bidder codes provided by the Department. Once this information is entered, the installation process will be complete.

For technical assistance, contact the Contracts & Specifications office at 222-2495.