

January 7, 2020

STATE OF RHODE ISLAND AND PROVIDENCE PLANTATION
DEPARTMENT OF ADMINISTRATION

DIVISION OF PURCHASES BID NO. 7599792

RHODE ISLAND DEPARTMENT OF TRANSPORTATION

RHODE ISLAND CONTRACT NO.2019-CH-033

FEDERAL-AID PROJECT NO. FAP Nos: STPG-HSIP(074), STP-RESF(413)

Pell Bridge Ramps - Phase 1

The project limits are from the intersection of JT Connell Highway and Admiral Kalbfus Road (Route 138) to the intersection of Coddington Highway and Lake Erie Street in the Towns of Newport and Middletown, Newport County, Rhode Island.

CITY/TOWN OF Middletown, Newport

COUNTY OF NEWPORT

NOTICE TO PROSPECTIVE BIDDERS

ADDENDUM NO. 7 Prospective bidders and all concerned are hereby notified of the following changes in the Plans, Specifications, Proposal and Distribution of Quantities for this contract. These changes shall be incorporated in the Plans, Specifications, Proposal and Distribution of Quantities, and shall become an integral part of the Contract Documents.

A. Contract Dates

1. Substantial Completion Date

The Substantial Completion Date has been changed to 8/31/2021.

B. Plan Sheets

1. Plan Sheet No. 5

Replace Plan Sheet No. 5(R-2) with Plan Sheet No. 5(R-3) attached to this Addendum No. 7. Job Specific Notes have been revised.

2. Plan Sheet No. 41

Replace Plan Sheet No. 41(R-2) with Plan Sheet No. 41(R-3) attached to this Addendum No. 7.

3. Plan Sheet No. 56

Replace Plan Sheet No. 56(R-2) with Plan Sheet No. 56(R-3) attached to this Addendum No. 7.

4. Plan Sheet No. 99

Replace Plan Sheet No. 99(R-1) with Plan Sheet No. 99(R-3) attached to this Addendum No. 7.

C. General Provisions - Contract Specific

1. CS-i
Replace Page CS-i with Page CS-i(R-1) attached to this Addendum No. 7. Appendix E - Construction Soil Management Plan has been added.
2. CS-4(R-1)
Replace Page CS-4(R-1) with Page CS-4(R-2) attached to this Addendum No. 7. In Paragraph 6 - Sequence of Construction, the anticipated start date has been updated.
3. CS-9(R-1)
Replace Page CS-9(R-1) with Page CS-9(R-2) attached to this Addendum No. 7. Paragraph 22. Shop Drawings and Submittals has been updated.
4. Appendix E - Construction Soil Management Plan
Add Appendix E - Construction Soil Management Plan attached to this Addendum No. 7.

D. Specifications - Job Specific

1. JS-4(R-1)
Replace Page JS-4(R-1) with Page JS-4(R-2) attached to this Addendum No. 7. The Substantial Completion Date has been updated.
2. JS-36
Replace Page JS-36 with Page JS-36(R-1) attached to this Addendum No. 7. The Method of Measurement and Basis of Payment sections have been modified.

E. Distribution of Quantities

1. Pages 22, 22a and 23
Replace Pages 22(R-1), 22a and 23(R-1) from with Pages 22(R-2), 22a(R-1) and 23(R-2) attached to this Addendum No. 7. Quantities for item codes 702.0605 and 702.0713 have been revised.

F. Federal Wage Rates

1. Federal Wage Rates
Replace the Federal Wage Rates dated 12/20/2019 with the Federal Wage Rates dated 01/03/2020 attached to this Addendum No. 7.

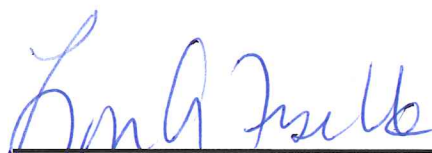

RI Department of Transportation

Administrator, Division of Project Management

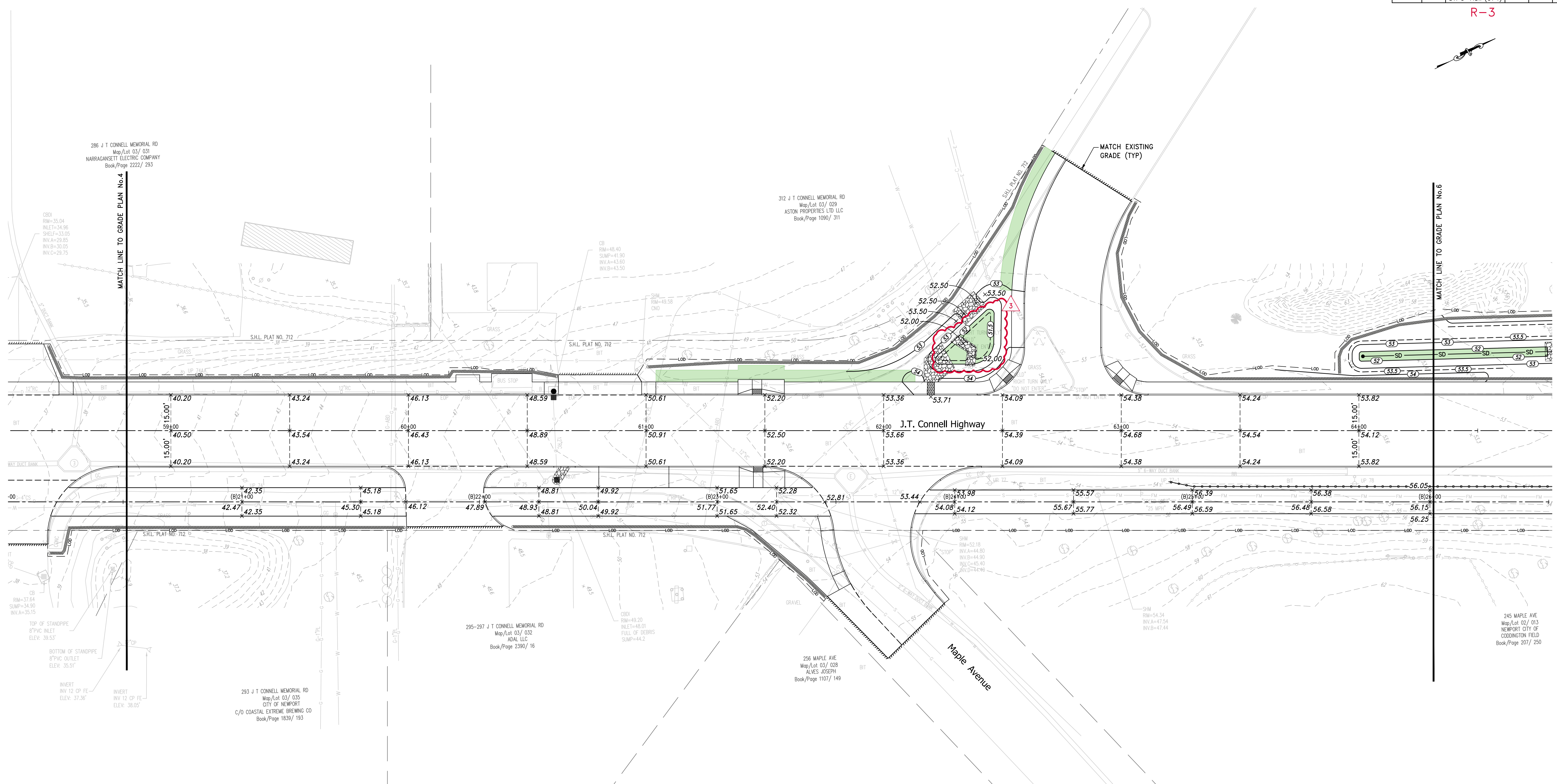
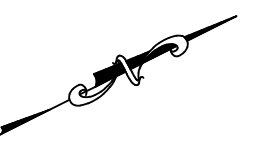

286 J T CONNELL MEMORIAL RD
Map/Lot 03/ 031
NARRAGANSETT ELECTRIC COMPANY
Book/Page 2222/ 283

312 J T CONNELL MEMORIAL RD
Map/Lot 03/ 029
ASTON PROPERTIES LTD LLC
Book/Page 1090/ 311

295-297 J T CONNELL MEMORIAL RD
Map/Lot 03/ 032
ADAL LLC
Book/Page 2390/ 16

256 MAPLE AVE
Map/Lot 03/ 028
ALVES JOSEPH
Book/Page 1107/ 149

245 MAPLE AVE
Map/Lot 02/ 013
NEWPORT CITY OF
CODDINGTON FIELD
Book/Page 207/ 250

293 J T CONNELL MEMORIAL RD
Map/Lot 03/ 035
CITY OF NEWPORT
C/O COASTAL EXTREME BREWING CO
Book/Page 1839/ 193

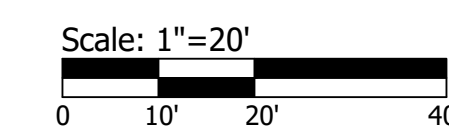

REVISIONS		
NO.	DATE	BY
1	12/23/19	KJM
2	1/2/20	KJM
3	1/7/20	KJM

RHODE ISLAND
DEPARTMENT OF TRANSPORTATION
PELL BRIDGE RAMPS - PHASE I IMPROVEMENTS TO J.T. CONNELL / CODDINGTON HIGHWAY
NEWPORT/MIDDLETOWN, RHODE ISLAND

GRADE PLAN No.5

CHECKED BY _____ DATE _____ SCALE 1"=20'



ADDENDUM No.7

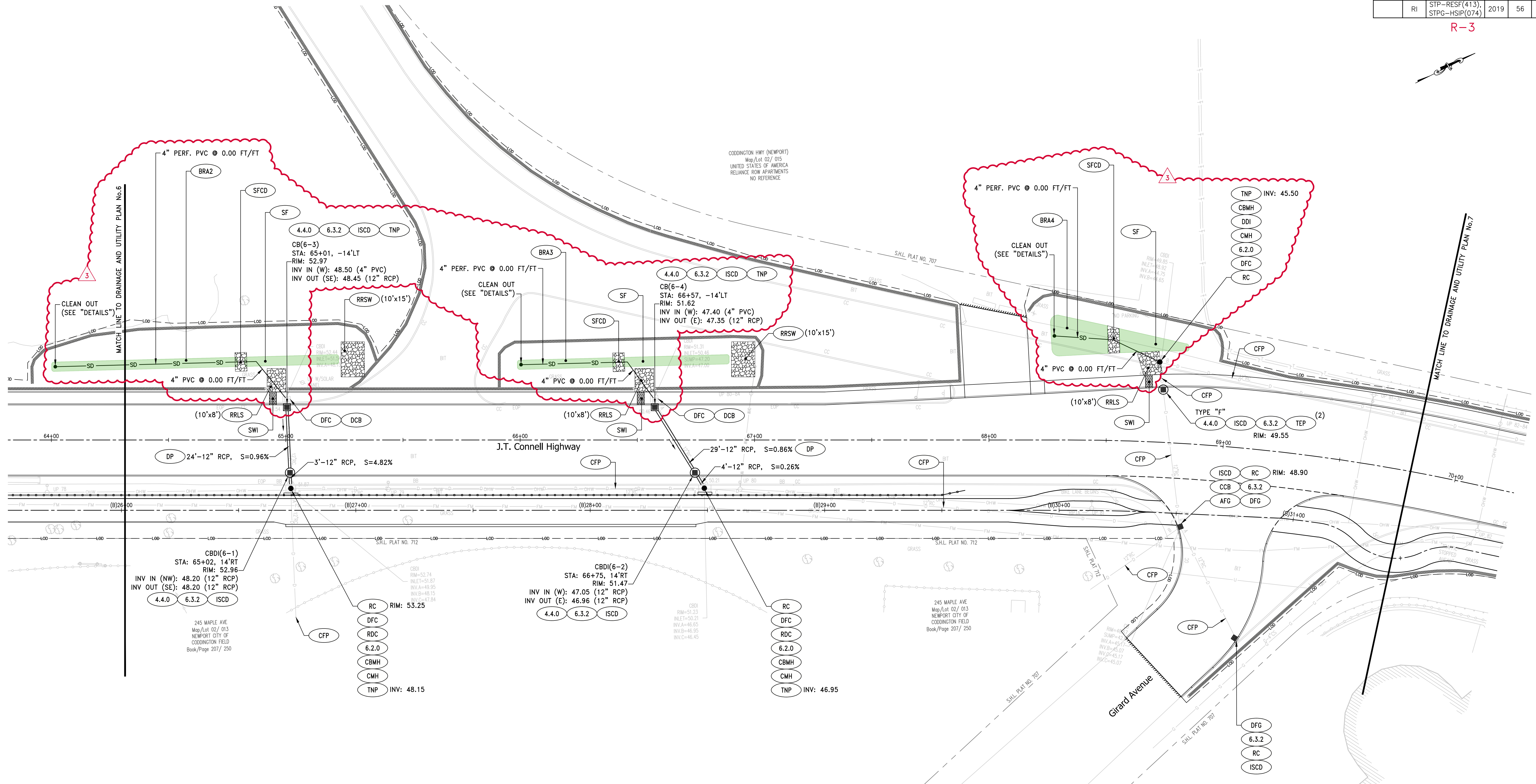
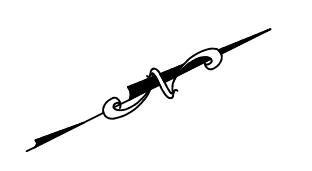

ADDENDUM No.7



REVISIONS		
NO.	DATE	BY
1	12/23/19	KJM
2	1/2/20	KJM
3	1/7/20	KJM

RHODE ISLAND
DEPARTMENT OF TRANSPORTATION

**PELL BRIDGE RAMPS - PHASE I
IMPROVEMENTS TO
J.T. CONNELL / CODDINGTON HIGHWAY**
NEWPORT/MIDDLETOWN, RHODE ISLAND

**DRAINAGE AND UTILITY
PLAN No.6**

CHECKED BY _____ DATE _____ SCALE 1"=20'

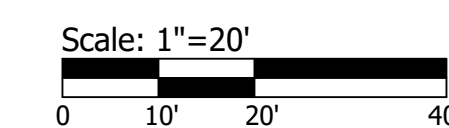

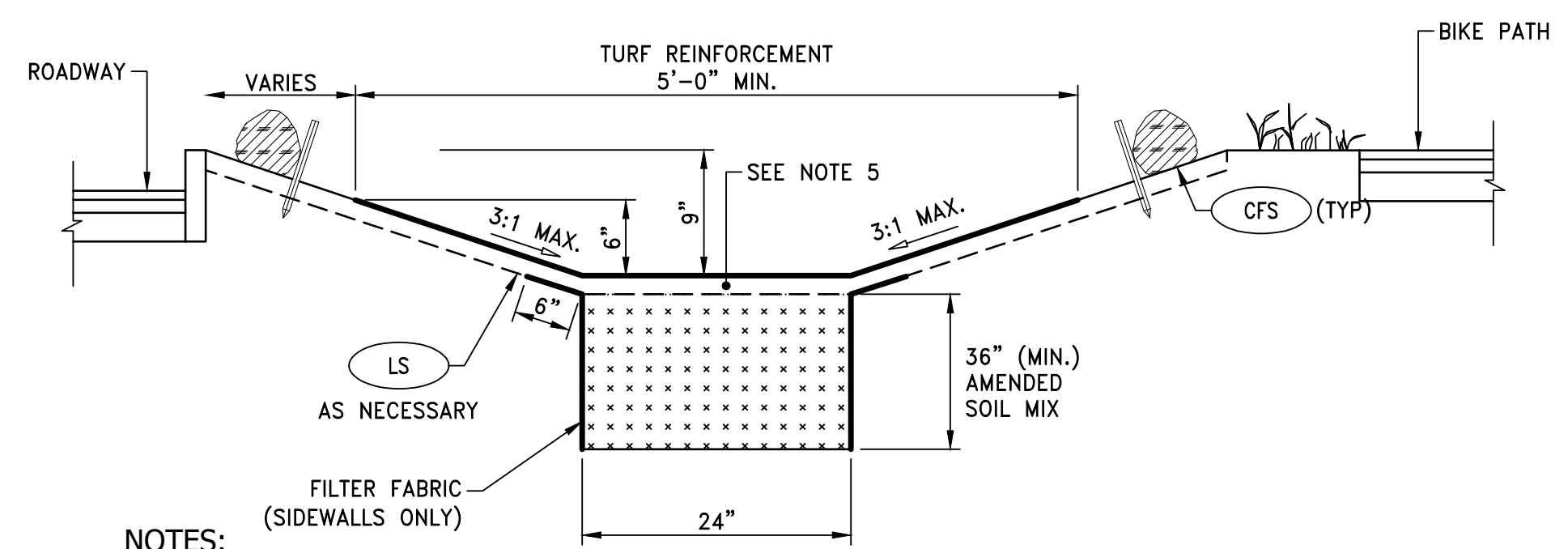

- NOTES:**
1. AMENDED SOIL MIXTURE (70-85% SAND, 15-30% ORGANIC MATTER)
 2. ITEMS INCLUDING, BUT NOT LIMITED TO, THE RIPRAP PADS, GABION BASKET CHECK DAMS, AND HDPE PIPE SHALL BE INCIDENTAL TO THE WATER QUALITY SWALE ITEM.
 3. THE CONTRACTOR SHALL TAKE SPECIAL PRECAUTION TO NOT COMPACT SOILS WITHIN THE MEDIA FOOTPRINT.
 4. FILTER FABRIC SHALL CONFORM WITH SECTION 703.02.2 OF RIDOT STANDARDS.
 5. STORM WATER TREATMENT SWALE SHALL BE SEEDED WITH KENTUCKY BLUE GRASS MIX.

WQS WATER QUALITY SWALE DETAIL
NOT TO SCALE

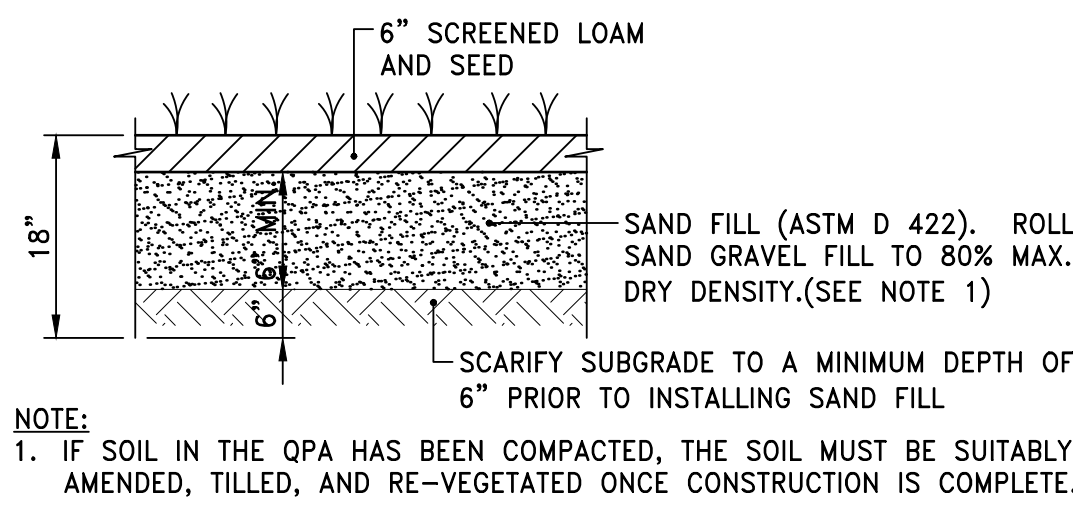

QPA QUALIFIED PERVIOUS AREA DETAIL
NOT TO SCALE

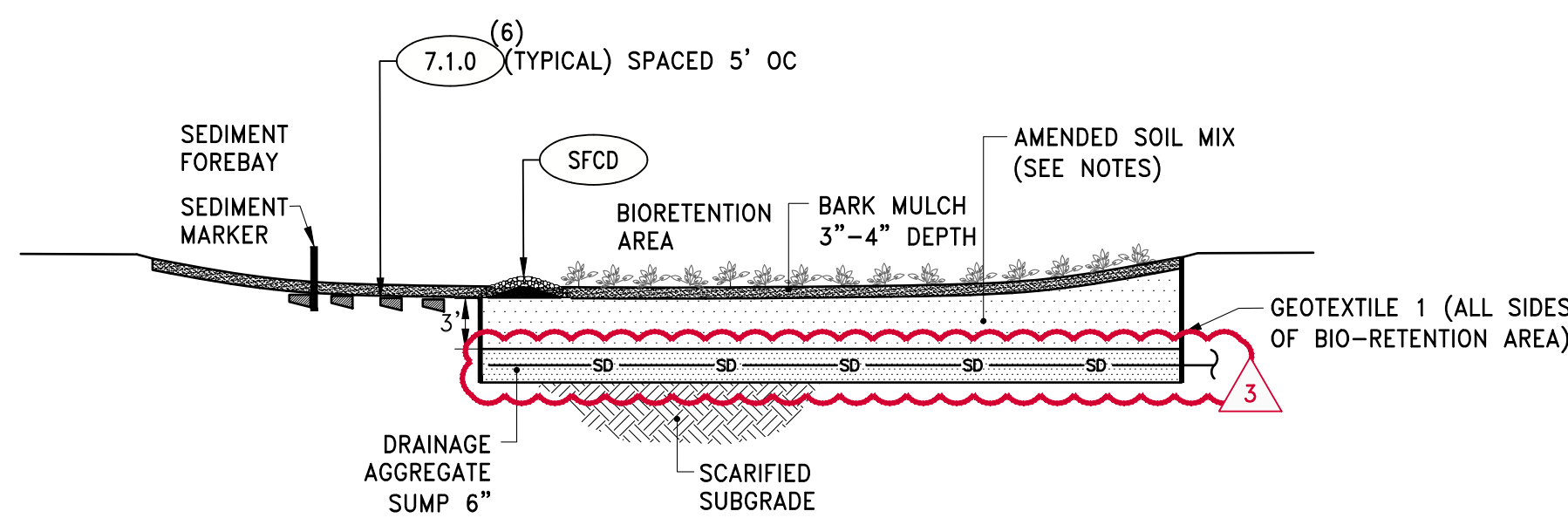

- BIO-RETENTION AREA NOTES:**
1. THE AMENDED SOIL MIX SHOULD BE A MIXTURE OF SAND, COMPOST, AND SOIL:
 - 70-85% SAND *
 - 15-30% ORGANIC MATTER/COMPOST *
 * PERCENTAGES BY VOLUMES
 2. THE SOIL MIX SHOULD BE UNIFORM, FREE OF STONES, STICKS, STUMPS, ROOTS, LARGER THAN 2 INCHES. CLAY CONTENT SHOULD NOT EXCEED 5%. SOIL PH SHOULD BE BETWEEN 5.5 AND 6.5 AND SHALL MEET ALL OTHER REQUIREMENTS OF SECTION 32.9320
 3. THE SAND COMPONENT SHOULD BE GRAVELLY SAND THAT MEETS ASTM D 422.

SIEVE SIZE	PERCENT PASSING
2 INCH	100
3/4 INCH	70-100
1/4 INCH	50-80
No. 40	15-40
No. 200	0-3
 4. THE TOPSOIL COMPONENT SHALL BE A SANDY LOAM, LOAMY SAND OR LOAM TEXTURE.
 5. THE COMPOST COMPONENT MUST BE PROCESSED FROM YARD WASTE MEETING THE RIDEM RULES AND REGULATIONS FOR AGRICULTURAL COMPOSTING.
 6. PRIOR TO THE INSTALLATION OF BIO-RETENTION MATERIALS, THE SUBGRADE SHOULD BE SCARIFIED AND MACHINERY CONTACT WITH THE SCARIFIED SUBGRADE SHOULD BE AVOIDED.
 7. ITEMS INCLUDING, BUT NOT LIMITED TO, SEDIMENT FOREBAY RIPRAP CHECK DAMS, SUBDRAIN, CLEANOUT, CONCRETE CURBING WITHIN SEDIMENT FOREBAYS, SIDEWALK INLETS, SEDIMENT MARKERS, RIPRAP PADS, AND RIPRAP SPILLWAYS SHALL BE INCIDENTAL TO THE RESPECTIVE BIORETENTION AREA ITEM.

BRA BIORETENTION AREA DETAIL
NOT TO SCALE

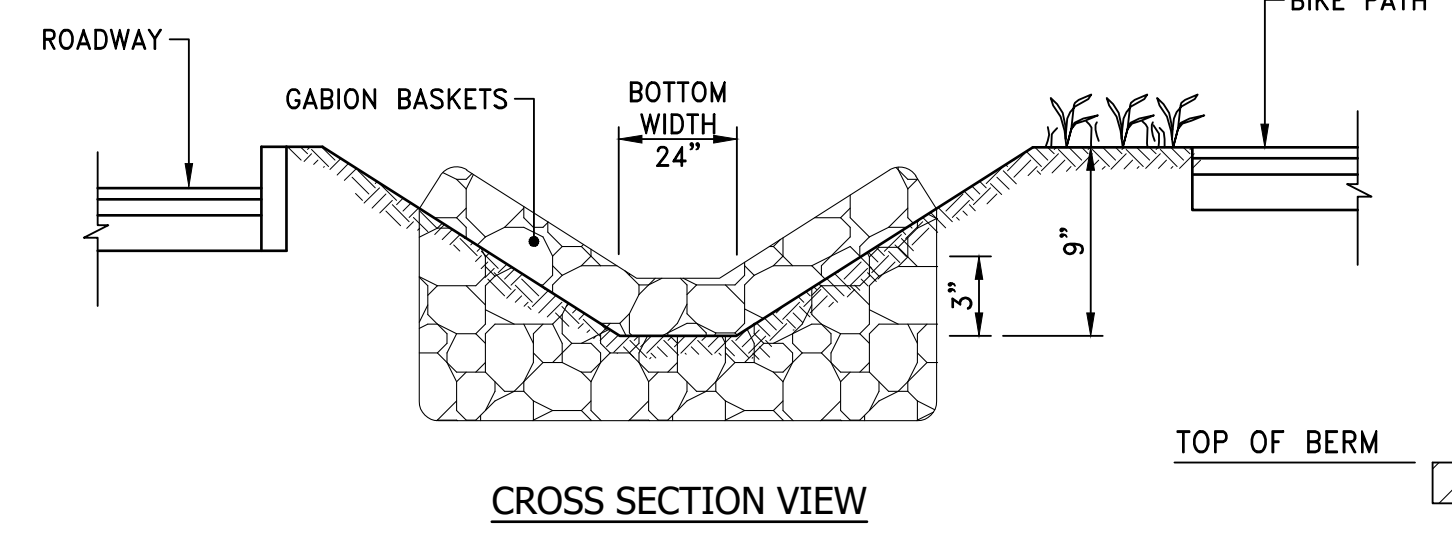

CHECK DAMS SHALL BE CONSTRUCTED WITH THE CENTER OF THE CHECK DAM DEPRESSED 0.1' TO DIRECT FLOW TO THE CENTER.

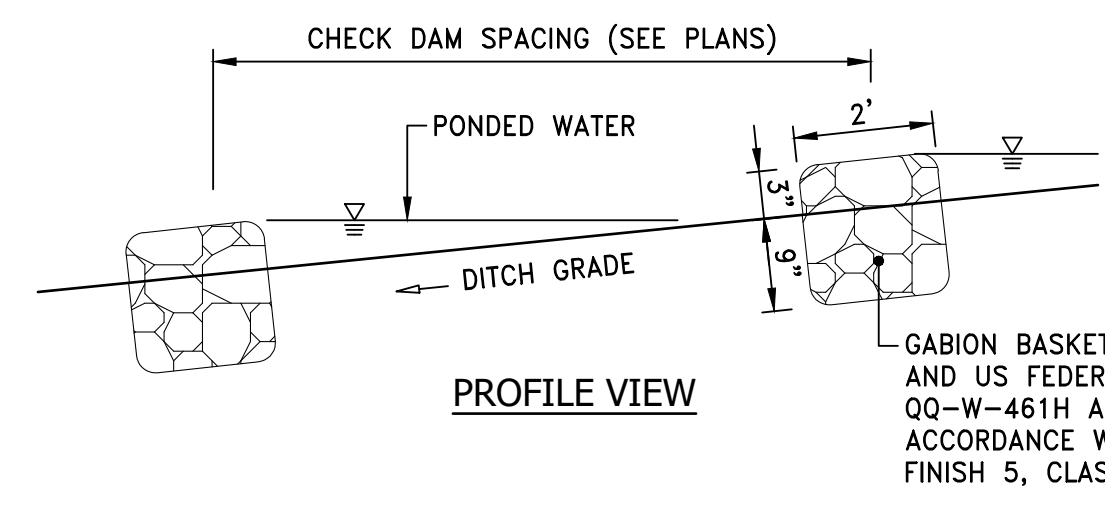

CD CHECK DAM DETAIL
NOT TO SCALE

- NOTES:**
1. ITEM SHALL BE INCIDENTAL TO THE WATER QUALITY SWALE ITEM.

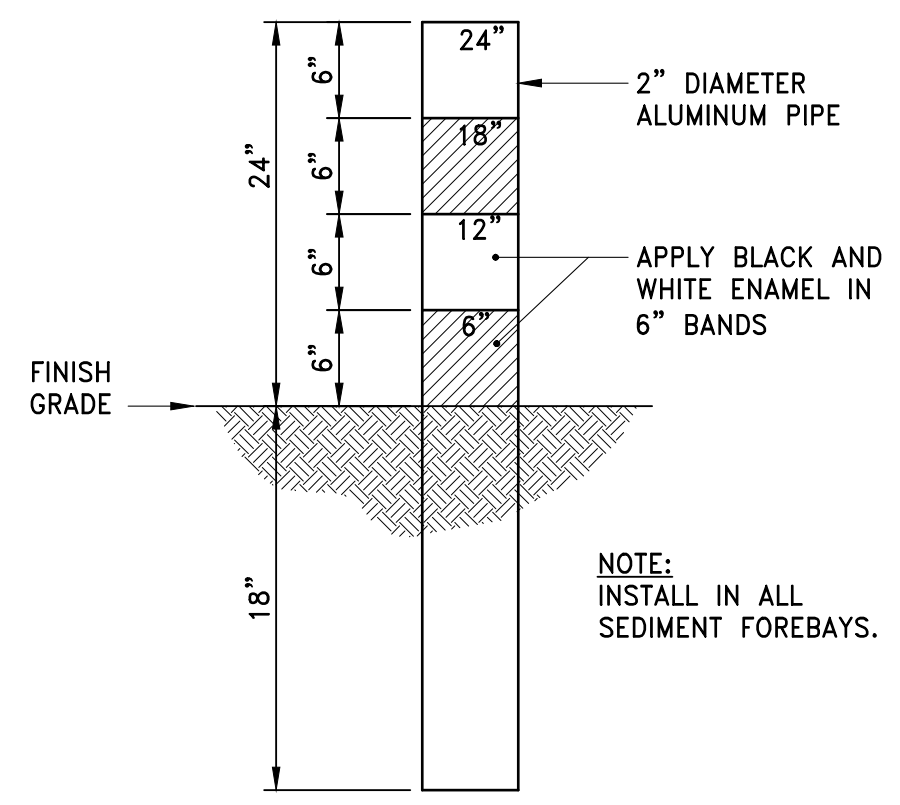

SEDIMENT MARKER DETAIL
NOT TO SCALE

- NOTES:**
1. ITEM SHALL BE INCIDENTAL TO THE RESPECTIVE BIORETENTION AREA ITEM.

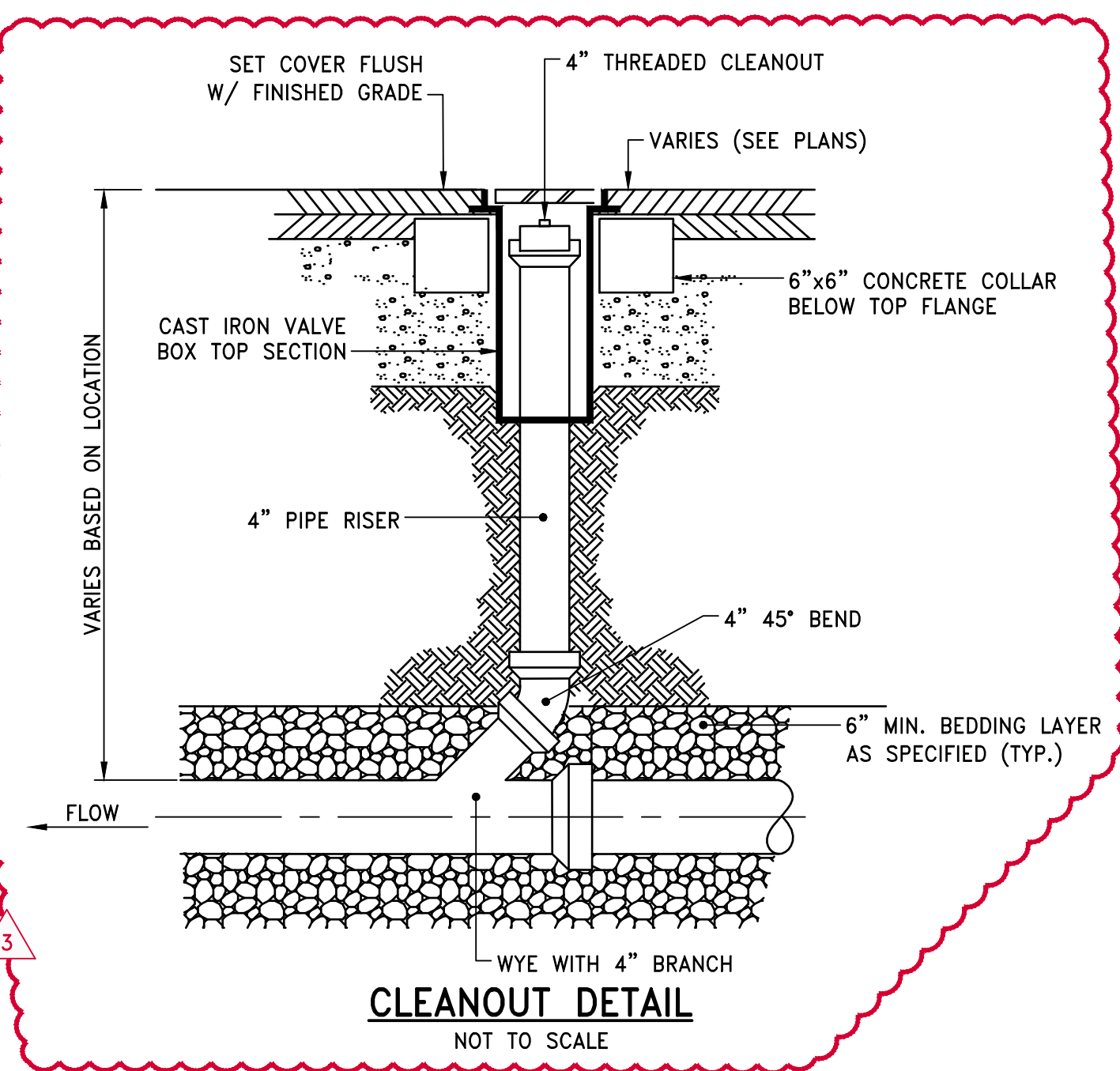

CLEANOUT DETAIL
NOT TO SCALE

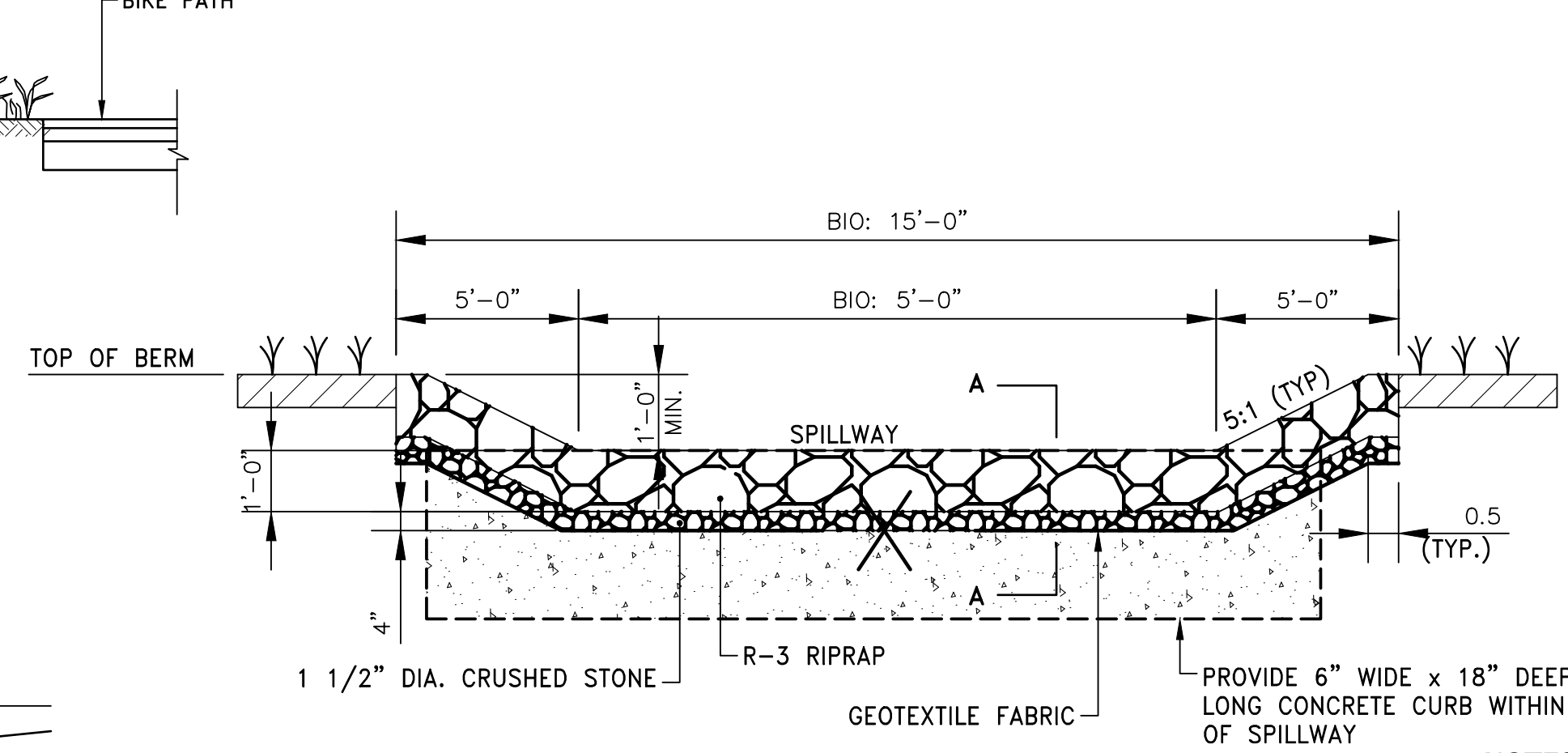

BIO = BIORETENTION AREA

RRSW RIPRAP SPILLWAY DETAIL
NOT TO SCALE

- NOTES:**
1. ITEM SHALL BE INCIDENTAL TO THE RESPECTIVE BIORETENTION AREA ITEM.
 2. CONTRACTOR SHALL FILL VOIDS BETWEEN CURB SECTIONS WITH MORTAR

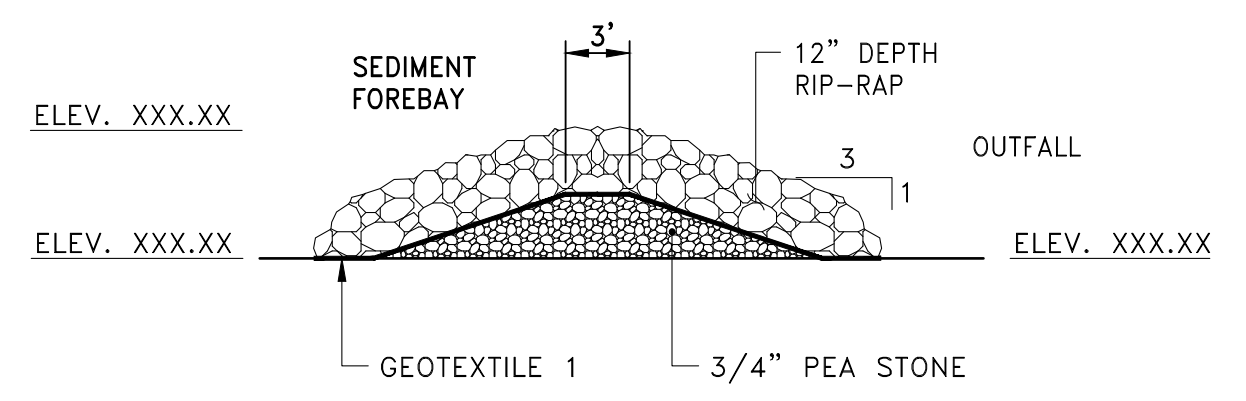

SFCD SEDIMENT FOREBAY - RIP RAP CHECK DAM
NOT TO SCALE

- NOTES:**
1. ITEM SHALL BE INCIDENTAL TO THE RESPECTIVE BIORETENTION AREA ITEM.

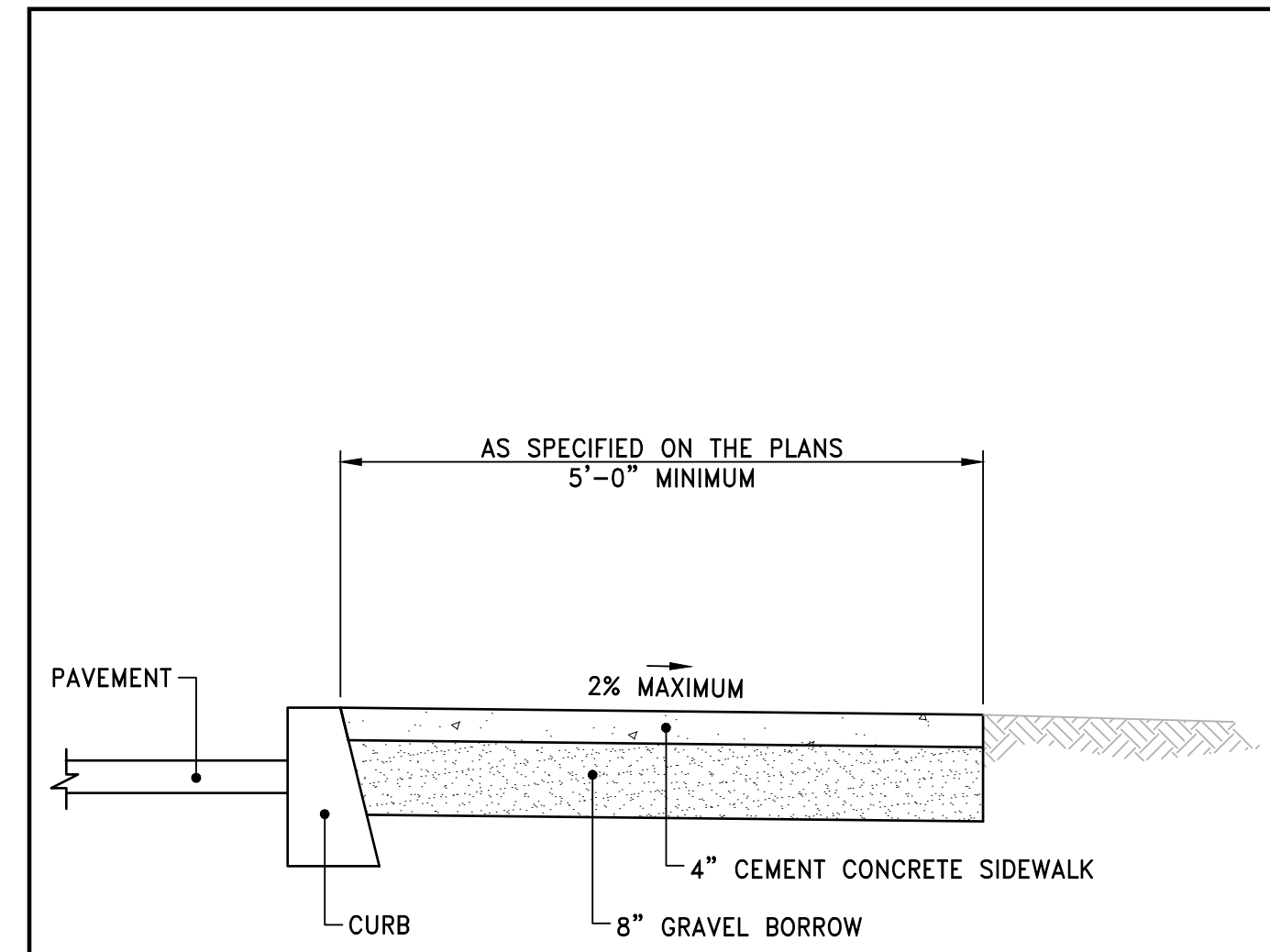

- NOTES:**
1. SHALL BE IN ACCORDANCE WITH SECTION 905 OF THE R.I. STANDARD SPECIFICATIONS.
 2. FOR CURB SETTING DETAIL REFERENCE STD. 7.6.0.

RHODE ISLAND DEPARTMENT OF TRANSPORTATION

CEMENT CONCRETE SIDEWALK

NO. 1 BY MLP DATE 3/1/05
NO. 2 BY MLP DATE 06/01/10

JUNE 15, 1998

R.I. STANDARD 43.1.0M

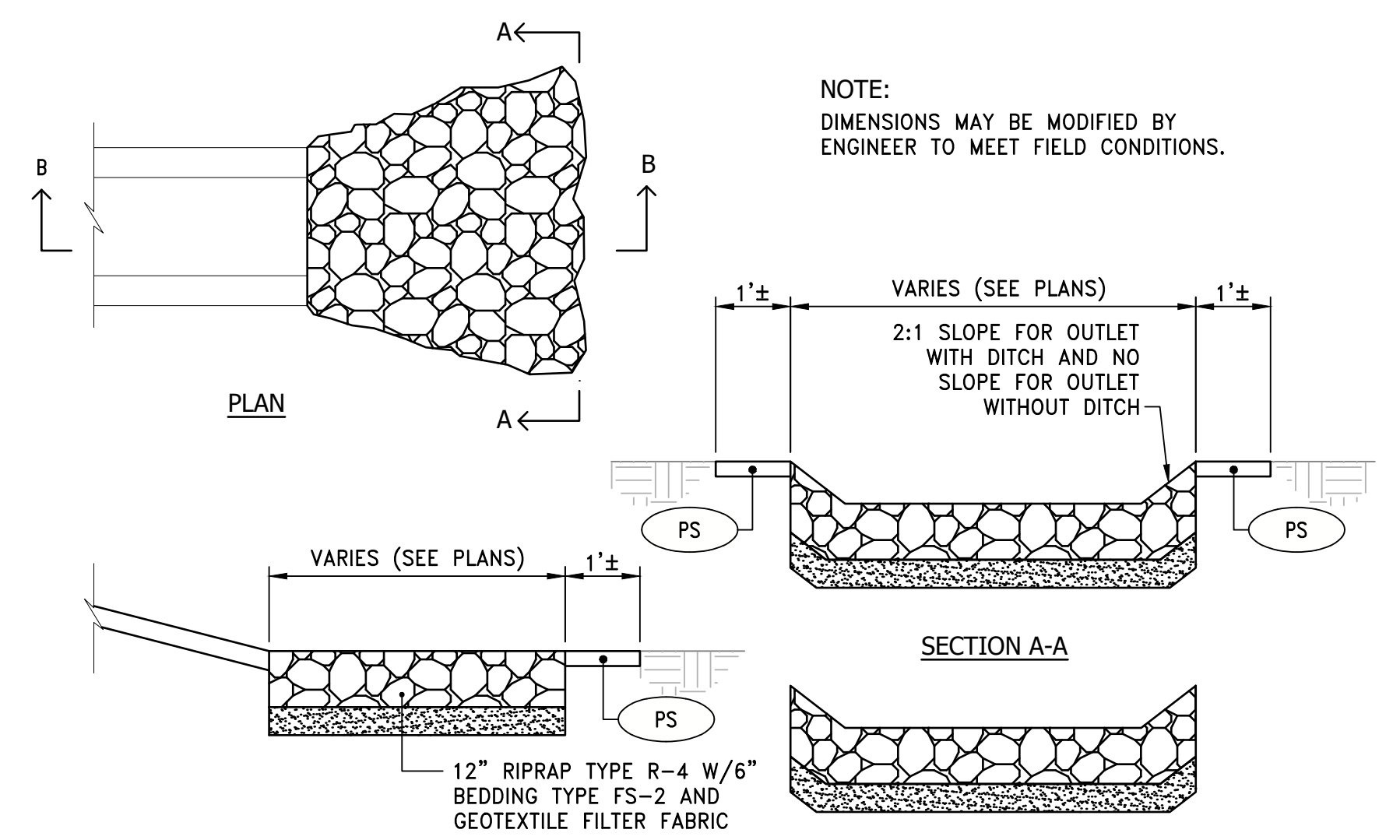

RRP RIPRAP PAD DETAIL
NOT TO SCALE

- NOTES:**
1. ITEM SHALL BE INCIDENTAL TO THE RESPECTIVE BIORETENTION AREA OR WATER QUALITY SWALE ITEM.

REVISIONS

NO.	DATE	BY
1	12/23/19	KJM
3	1/7/20	KJM

RHODE ISLAND DEPARTMENT OF TRANSPORTATION

PELL BRIDGE RAMPS - PHASE I IMPROVEMENTS TO J.T. CONNELL / CODDINGTON HIGHWAY

NEWPORT/MIDDLETOWN, RHODE ISLAND

DETAILS No.4

CHECKED BY _____ DATE _____ SCALE 1"=20'

GENERAL PROVISIONS – CONTRACT SPECIFIC

<u>PARAGRAPH</u>	<u>TITLE</u>	<u>PAGE</u>
1	Brief Scope of Work	CS – 1
2	List of Contract Drawings	CS – 1
3	Utility and Municipal Notification and Coordination	CS – 2
4	Specialty Items	CS – 3
5	Transportation Management Plan	CS – 4
6	Sequence of Construction	CS – 4
7	Special Requirements for Pavement Markings	CS – 5
8	Utility Structures and Waterways within Roadway	CS – 6
9	Contractor’s Responsibility for Damaged Storm Drains	CS – 6
10	Special Requirement for Traffic Protection	CS – 6
11	Storage of Construction Material and/or Equipment	CS – 6
12	Traffic Fines in Work Zone	CS - 7
13	Sidewalk Sawcut Notes	CS – 7
14	Blasting Restrictions	CS – 7
15	Survey Layout Notes	CS – 7
16	Right-of-Way and Damage to Property	CS – 7
17	Coordination with Other Projects	CS – 8
18	Pavement Cores	CS – 8
19	Incident Management	CS – 8
20	Police Compensation	CS – 8
21	Stormwater Pollution Prevention Plan	CS – 8
22	Shop Drawing and Submittals	CS – 9
23	Environmental Permits	CS – 9
Appendix A	Stormwater Pollution Prevention Plan	
Appendix B	Transportation Management Plan	
Appendix C	Pavement Cores	
Appendix D	Environmental Permits	
Appendix E	Construction Soil Management Plan	

5. TRANSPORTATION MANAGEMENT PLAN

Included as Appendix B to these Contract Specific General Provisions is the Transportation Management Plan (TMP) for this project. The TMP lays out the set of coordinated transportation management strategies that will be used to manage the work zone safety and mobility impacts of this project. If a discrepancy between information in the TMP and information elsewhere in the Contract Documents, the former shall govern.

The Contractor must notify RIDOT at least 3 weeks before closures, shifts or splits occur on ANY roads within the project to allow for coordination. All full closure, shifts or splits must also be implemented on Friday or Saturday night as determined by the TMP to allow motoring public time to adjust to new traffic patterns while allowing RIDOT the opportunity to evaluate its success. Construction work can commence on the Monday following the evaluation period.

The Contractor's attention is called to the applicable portions of Section 100 – Award and Execution of the Rhode Island Department of Administration Emergency Procurement Regulations, which describes the requirements for the Contractor's designation of a TMP Implementation Manager for the Contract and the requirements for the training of all Contractor and Subcontractor personnel involved in work zone design, implementation, operation, inspection, management, and/or enforcement.

The Department's latest Training Guidelines for Personnel Responsible for Work Zone Safety & Mobility is available under the "Training" section at <http://www.dot.ri.gov/documents/doingbusiness/TrainingGuidelinesWZSM.pdf>

6. SEQUENCE OF CONSTRUCTION

- A. All work shall be completed per the Traffic-Related Work Restrictions shown in the Transportation Management Plan.
- B. The Contractor must submit, for the Department's review and acceptance, a detailed construction schedule that complies with the Specification 108.03. The required Schedule Level for this project is B. Per the Specifications, the Contractor must generate the Schedules in Primavera P6, Version 7 or 8.
- C. The Contractor will not be allowed to begin construction prior to the issuance of the permit approval by RIDEM. For scheduling purposes, a start date of July 1, 2020 should be anticipated.
- D. The proposed construction and time schedule must consider and address the safe vehicle passage through the project.
- E. During the pavement removal operations, no over breakage into the operational travel lanes will be allowed.
- F. The Contractor shall maintain appropriate construction-related signing at all times. Any signs not appropriate for construction activity taking place at any given time shall be removed or covered to the satisfaction of the Engineer.

22. SHOP DRAWINGS AND SUBMITTALS

The Contractor's attention is called to the following list of submittals for various pay items. The Contractor shall study the plans and specifications for the submittal requirements. Every attempt has been made to make the following list as complete as possible. It is the Contractor's responsibility to ensure that all submittals are made in a timely manner even if they are not shown in the list below.

- 1) T11.9901 30-Foot Galvanized Steel Mast Arm Traffic Signal Post and Foundation
- 2) T12.9901 Highway Advisory Radio System
- 3) T13.8210 Accessible Pedestrian Detector - Pushbutton with Sign
- 4) T14.9901 One-Way Two-Section Bracket Mounted LED Pedestrian Signal Head 12-Inch With Countdown Timer
- 5) 911.9901 Segmental Block Retaining Wall System (including any required temporary earth support)
- 6) 919.9901 Test Pits – Retaining Walls (test pit records shall be submitted with Item 911.9901 submittals)
- 7) Documentation Required per the Construction Soil Management Plan

23. ENVIRONMENTAL PERMITS

A Request for Preliminary Determination has been submitted to the Rhode Island Department of Environmental Management (RIDEM). It shall be the Contractor's responsibility to comply with all restrictions and stipulations stated or implied by the permits and orders. There will be no special payment for work done to comply with permits and orders unless an item is provided in the proposal for a specific requirement.

Any and all deviations from the approved permit operations or conditions shall be submitted for approval to the corresponding permitting agency or agencies. Work that deviates from approved permit operations or conditions shall not begin without receipt of the proper approvals.

A copy of the permit approval will be provided to the Contractor upon issuance.

APPENDIX E

CONSTRUCTION SOIL MANAGEMENT PLAN

CONSTRUCTION SOIL MANAGEMENT PLAN

Surface Improvements Project – JT Connell Highway

1.0 General Information

This project includes reconstruction of approximately 1.5 miles of roadway, relocating the existing roadway curblines, replacing sidewalks, drainage improvements, and construction of stormwater treatment areas. Additionally, construction of a shared-use path parallel to the roadway is included. Areas of the subject property that are to be disturbed will, at a minimum, be managed in accordance with this Construction Soil Management Plan. Best management practices shall be applied to minimize erosion of exposed surfaces, control the generation of windblown dust, and ensure general worker protection.

In summary, potential contaminants of concern within the project limits include petroleum from several known leaking underground storage tanks, State Hazardous Waste Sites (SHWS), known hazardous waste generators, and naturally occurring levels of arsenic throughout the entire area. Arsenic appears to be present in the general area at levels above RIDEM regulated levels and will require special handling during earthwork activities in order to protect the public health and safety of the construction workers and surrounding population. Displaced soils will likely require off-site disposal at licensed landfills due to the presence of arsenic and other contaminants. The soil management specifications detailed herein were developed to manage all soil/fill excavated in the course of completing this contract including contaminated and non-contaminated soils. These specifications shall be utilized in areas assumed to be consistent with background conditions as defined by RIDEM and shall be handled as directed herein unless there are visual or olfactory indications of contamination as determined by the Engineer, in which case the material shall be managed as potentially contaminated soil/fill.

2.0 Soil Excavation and Removal

Soil excavated from within the proposed limits of disturbance identified on the subject property that is suspected to potentially be impacted by hazardous material shall be segregated and stockpiled at an on-site location approved by the Resident Engineer. Stockpiled soil shall be placed on 20 mil polyethylene sheeting and shall be covered by 6 mil poly or superior cover material when the stockpile is not in use, including at the end of the workday. All soil stored on-site shall be appropriately labeled and secured.

The Owner's Environmental Consultant shall be notified so that the material can be field screened (visual, olfactory, or photo-ionization detection (PID)) for an initial characterization relative to potential contamination.

Soil deemed or suspected to be impacted through the results of field screening shall be sampled by the Environmental Consultant and analyzed for waste characterization purposes sufficient to obtain approval from a licensed facility selected by the Contractor and approved by the Owner. Whereas the characterization requirements may vary depending on the receiving disposal facility's permits and policies, the Contractor must notify the Owner's Environmental Consultant what

parameters are required in order to obtain approval. The contractor must allow a minimum of 14 business days for sampling and analysis of soils subject to off-site disposal. The contractor is responsible for making all other arrangements with the landfill including preparing soil profile letters and requests for approval, manifest and bills of lading.

Soil shall be sampled and analyzed at a frequency of at least one sample per 1000 cubic yards of soil to be removed from the site or a minimum of one sample per unique soil group relative to soil disposal/reuse considerations. The Contractor shall reuse excavated soil within an area of substantial similarity of characteristics and chemical composition as to the point of origin to the maximum degree possible. Should any parameter exceed the Residential Direct Exposure Criteria (RDEC) or the GA Leachability Criteria contained in the *Rhode Island Department of Environmental Management's Rules and Regulations for the Investigation and Remediation of Hazardous Material Releases* (a.k.a. Remediation Regulations), the soil associated with the sample shall be either reused on site within the project limits or disposed of or reused at an appropriately licensed facility provided that the material is reused within an area of substantial similarity of characteristics and chemical composition as to the soil type/group of origin and without causing a nuisance condition at the receiving site.

The Environmental Consultant will provide the analytical data to the Contractor so that he can obtain approval from such a facility. Potential off-site uses for the soils include landfill cover and recycling into an asphalt batching process. Contractor will haul soil slated for off-site disposal or reuse to the designated receiving facility and shall provide the Resident Engineer with time-stamped weight slips that have been signed or notated by the receiving facility.

3.0 Staging Area(s)

Excavated material requiring additional characterization will be staged in a designated area(s) selected by the Contractor and agreed to by the Owner. The Contractor is to select an area(s) that will not impair or impede construction activities. The staging area(s) must be readily accessible and sized to adequately stage material pending either transport to an interim staging area(s) for characterization sampling and analysis or transported directly to the disposal facility.

Prior to staging any materials the Contractor shall pre-characterize the surface soils (0-6") at the staging area(s) to document the existing conditions relative to contamination which may result from using the area to stage excess or unknown materials. A minimum of two surface soil samples or one surface soil sample for every 400 square feet of staging area (whichever is greater) shall be collected by the contractor prior to staging materials at the location unless the staging area is comprised of an impervious surface material such as asphalt or concrete. The samples will be analyzed by a certified laboratory for total metals (EPA priority pollutant metals), volatile organic compounds (EPA Method 8260), semi-volatile organic compounds (EPA Method 8270), petroleum hydrocarbons (EPA Method 418.1), and Total PCBs and pesticides (EPA Method 8081 and 8082).

The Contractor shall re-sample the staging area(s) at the same location, depth and frequency as conducted prior to staging materials, after removal of all staged materials, to assess any impact from using the area to stage excess or unknown materials. The sample(s) will be analyzed by a certified laboratory for total metals (EPA priority pollutant metals), volatile organic compounds (EPA Method 8260), semi-volatile organic compounds (EPA Method 8270), petroleum hydrocarbons (EPA Method 418.1), and Total PCBs and pesticides (EPA Method 8081 and 8082).

Stockpiles located within the soil staging areas will be placed on a 20-mil HDPE liner/filter fabric and bermed to minimize the effects of contamination release. The berms shall be made a minimum of 2 feet above the existing grade with common fill, hay bales or equivalent berm material. Waste characterized as RCRA hazardous waste will not be stored on site for a period greater than sixty (60) days. All other waste must be disposed off-site within ninety (90) days of excavation. At the end of each working day, contaminated soils will be covered with 6-mil polyethylene to minimize the potential for release of contaminants. Care shall be taken to keep differing soil types from being co-mingled. Soil shall only be stockpiled with similar soils.

Stockpiles are to be segregated based on visual, olfactory, and field screening results. Similar material may be stockpiled together; however, no stockpile shall be greater than 1000 cubic yards. Each stockpile must be clearly separable from adjacent stockpiles.

Stockpiles will be clearly designated by a sign post or marker which can be cross-referenced with samples collected from the pile for characterization purposes. The signs/markers are not to be moved, except by authorized personnel and not until the soil is ready to be either reused on site or loaded for off-site disposal.

Separate staging areas, if needed will be constructed to handle the unknown, potentially hazardous soils/debris and drummed materials encountered during the project. The Contractor shall select the area to facilitate handling of the material and to minimize interference with other ongoing construction activities. The Owner or Engineer must agree with the location prior to construction.

4.0 Health and Safety

All impacted soils shall be managed in a manner sufficient to ensure health and safety of workers, the general public, and the environment. All impacted soil to be disposed of off-site shall be transported via bills of lading and/or hazardous waste manifests in accordance with the RIDEM, USEPA, and DOT regulations. Any soil materials that exhibit hazardous characteristics, as defined in 40 CFR Part 262, shall be disposed of off-site within 60 days.

Contractor shall comply with all Occupational Safety and Health Administration (OSHA) standards set forth in 29 CFR 1910.120 and any site-specific health and safety requirements established for this project. The Contractor's employees and any subcontractor's employees who will potentially encounter subsurface soil on this project are required to have OSHA 40-hour HAZWOPER health and safety training and the 8-hour OSHA annual refresher course, as applicable. Level D personal protection equipment (PPE) shall be the minimum personal protection level used for any personnel that may come in contact with subsurface soils at the subject property. The Contractor shall modify this level of PPE as site conditions necessitate.

5.0 Equipment and Personnel Decontamination

The Contractor shall prepare an Equipment and Personnel Decontamination Plan for the Engineer's Review and Approval. The plan shall indicate the means and methods for decontaminating all equipment and personnel. The Contractor shall establish a site-specific decontamination protocol for personnel and equipment utilized at the subject site. The Contractor shall encounter contaminated soils and material, and prepare its decontamination protocol accordingly. The Contractor shall

construct and maintain personnel and equipment decontamination areas for the proposed work. The Contractor shall decontaminate personnel and all construction and ancillary equipment in the Contamination Reduction Zone (CRZ) as it leaves the contaminated zone, prior to it entering the Clean/Support Zone (SZ). The Contractor shall have the decontamination protocol as part of its site-specific HASP.

6.0 Erosion Control

The Contractor shall provide measures for erosion control of stockpiled soils that are deemed or suspected to be impacted, including the installation of hay bales around all soil stockpiles, the installation of silt fences where appropriate, and the covering of all soil contaminated soil stockpiles. Impacted soil stockpiles shall be covered with a minimum of 6-mil polyethylene sheeting. Stockpiles shall be placed on no less than one layer of 20-mil polyethylene sheeting.

The following general tasks should be undertaken when appropriate:

- Control surface drainage from cuts and fills, borrow areas, and waste disposal areas. Prevent erosion and sedimentation.
- Minimize the amount of bare impacted soil exposed at one time.
- Provide temporary measures such as berms, dikes, and drains to prevent excessive stormwater flow.
- Construct fill and waste areas by selective placement to avoid erosive surface silts or clays.
- Periodically inspect earthwork to detect evidence of erosion and sedimentation.
- Perform daily inspections of stockpiles to ensure that erosion controls and polyethylene coverings are intact. Initiate needed repairs immediately.
- Prevent all tracking of soil out of the project limits whether by tire tracking, personnel tracking, airborne dust migration, sediment transport or other means, such that no contaminated soil presents a hazard to the environment, or public health, safety or welfare.

7.0 Dust Control

All construction/remedial activities shall be undertaken so as to minimize the generation of dust and to prevent any fugitive dust from migrating off-site. However, this provision does not supersede any specific requirements for methods of construction or applicable general conditions or performance obligations of the Contractor. During the progress of the work, dust emissions shall be controlled by sweeping paved areas and sprinkling of water on exposed soil surfaces, soil stockpiles, and open excavations as needed. The contractor shall perform routine air

monitoring during earthwork activities as needed to comply with OSHA 29 CFR 1910.120 requirements.

8.0 Unidentified Waste Materials

If unidentified waste materials are encountered, such as buried drums or other waste materials, all activities in the area shall immediately be halted and the area secured. The Environmental Consultant will don the appropriate personal protective equipment and characterize the waste materials through field screening (visual, olfactory, or photo-ionization detection (PID)). If for any reason the Environmental Consultant or Resident Engineer suspect that the unidentified waste materials could be potentially hazardous, the RIDEM shall be notified as soon as possible. If the unidentified waste materials are judged to represent an imminent threat to the environment or the public, a licensed hazardous waste contractor shall be immediately notified to respond to the subject property.

If the waste material encountered is containerized, it shall be appropriately overpacked for disposal off-site. If non-aqueous liquid is encountered, a hazardous waste contractor shall pump the liquid into appropriate containers.

9.0 Periodic Inspections

The Owner or the Owner's Environmental Consultant shall make periodic inspections to verify that the contractor is abiding by the decontamination plans, dust and erosion controls specified herein or as required by state and federal regulations. The Contractor shall provide the inspector access to all areas and provide any required PPE necessary to perform inspection activities. The contractor shall be required to implement corrective actions in order to control fugitive dust, sediments or improve decontamination procedures if current procedures are inadequate as evidenced by the Inspector.

JOB SPECIFIC

CODE 108.1000

PROSECUTION AND PROGRESS

In accordance with Section 108.08, Failure to Complete on Time, Para. a., Phased Completion, Interim Completion and Substantial Completion the following defines the Interim and Substantial Completion Dates and Associated Liquidated Damages:

Substantial Completion: August 31, 2021

All Contract work shall be completed, as defined by Section 101.71.

Liquidated Damages: \$2,350 per calendar day.

The Contractor shall take all precautions necessary to minimize exposure or direct contact with material suspected to be impacted by hazardous materials. Contractor shall also take all precautions necessary to avoid transport of the material through erosion or wind entrainment. This shall include, but not necessarily be limited to, stockpiling material on two layers of 6 mil polyethylene sheeting, covering stockpiled material with a layer of 6 mil polyethylene sheeting, and surrounding stockpiles with haybales or silt fence. Stockpile areas shall be selected by the Contractor and shall be subject to approval of the Engineer. Stockpiles and any associated erosion controls shall be inspected daily and restored as necessary to control dust and erosion.

The Contractor shall provide the Engineer with disposal documentation following its delivery to the selected disposal facility. This shall include time-stamped weight slips, signed by the material hauler and personnel at the disposal outlet, indicating the quantity of material disposed and cost for disposal. Contractor is required to submit this information for payment under this item.

METHOD OF MEASUREMENT: Item Code 201.9903 “Remove, Stockpile, Handle, Haul and Dispose Contaminated Soil” shall be measured for payment by the actual cost, as approved by the Engineer, for the cost of performing the work as directed by the Engineer.

BASIS OF PAYMENT: Item Code 201.9903 “Remove, Stockpile, Handle, Haul and Dispose Contaminated Soil” will be paid for at the actual dollar amount. The estimated dollar figure for this item of work is \$100,000 and is established by the Department at 100,000 units at \$1.00 each and is inserted in the proposal as an authorized amount from which the payments shall be drawn. The price so-stated constitutes full and complete compensation for all labor, materials, and equipment, including handling, removing, managing, hauling, and legally disposing of soil impacted by hazardous materials as described by this specification, tipping fees, and all other incidentals required to furnish the work, complete and accepted by the Engineer. Actual excavation of soil and transport shall be paid for under Item 202.0100 Earth Excavation and not paid for under this bid item. If material is found to be suitable for re-use on-site, the transport and placement shall be paid for under the appropriate bid item.

Distribution of Quantities

Project Name - Pell Bridge Ramps - Phase 1

Estimate Name - Addendum 7

R.I. Contract No. - 2019-CH-033

FAP Nos: STPG-HSIP(074), STP-RESF(413)

Item No.	Item Code	Description	UM	Qty.	Pay Code	Seq. No.
043	702.0533 Cont.	98+63L		1.00	0004	01
		98+63R		1.00	0004	01
Item 702.0533 Total:				**DELETED**		
044	702.0605	PRECAST CATCH BASIN 4' DIAMETER	EACH			
		STANDARD 4.4.0				
		JT CONNELL HWY/CODDINGTON HWY				
		100+71L		1.00	0004	01
		102+22L		1.00	0004	01
		104+10L		1.00	0004	01
		104+72L		1.00	0004	01
		106+69L		1.00	0004	01
		41+80R		1.00	0004	01
		45+87R		1.00	0004	01
		45+88L		1.00	0004	01
		49+60R		1.00	0004	01
		53+26R		1.00	0004	01
		60+63R		1.00	0004	01
		65+01L		1.00	0004	01
		65+02R		1.00	0004	01
		66+57L		1.00	0004	01
		66+75R		1.00	0004	01
		68+73L		1.00	0004	01
		76+85R		1.00	0004	01
		79+37R		1.00	0004	01
		82+88L		1.00	0004	01
		82+89R		1.00	0004	01
		84+82L		1.00	0004	01
		85+85L		1.00	0004	01
		88+87L		1.00	0004	01
		91+40L		1.00	0004	01
		94+39L		1.00	0004	01
		96+88L		1.00	0004	01

Distribution of Quantities

Project Name - Pell Bridge Ramps - Phase 1

Estimate Name - Addendum 7

R.I. Contract No. - 2019-CH-033

FAP Nos: STPG-HSIP(074), STP-RESF(413)

Item No.	Item Code	Description	UM	Qty.	Pay Code	Seq. No.
044	702.0605	Cont.	98+67L	1.00	0004	01
Item 702.0605 Total:				20.00		
045	702.0713	PRECAST CONCRETE DROP INLET WITH APRON STONE STANDARD 4.5.1	EACH			
		JT CONNELL HWY/CODDINGTON HWY				
		108+78L		1.00	0004	01
		44+78L		1.00	0004	01
		47+65R		1.00	0004	01

Distribution of Quantities

Project Name - Pell Bridge Ramps - Phase 1

Estimate Name - Addendum 7

R.I. Contract No. - 2019-CH-033

FAP Nos: STPG-HSIP(074), STP-RESF(413)

Item No.	Item Code	Description	UM	Qty.	Pay Code	Seq. No.
045	702.0713	Cont.				
		50+46R		1.00	0004	01
		55+76R		1.00	0004	01
		65+01L			0004	01
		66+57L		1.00	0004	01
		66+79R		1.00	0004	01
		67+97R		1.00	0004	01
		76+81R		1.00	0004	01
		76+82L		1.00	0004	01
		79+30L		1.00	0004	01
		79+30R		1.00	0004	01
		82+80R		1.00	0004	01
		85+96L		1.00	0004	01
Item 702.0713 Total:				3.00		
046	704.0100	RECONSTRUCT CATCH BASIN/CORBEL	EACH			
		CONES				
		JT CONNELL HWY/CODDINGTON HWY				
		100+69L		1.00	0004	01
		102+25L		1.00	0004	01
		104+29L		1.00	0004	01
		104+39R		1.00	0004	01
		104+42R		1.00	0004	01
		104+68L		1.00	0004	01
		104+72L		1.00	0004	01
		106+70L		1.00	0004	01
		106+72L		1.00	0004	01
		106+88R		1.00	0004	01
		108+78L		1.00	0004	01
		39+31R		1.00	0004	01
		42+24R		1.00	0004	01
		42+25L		1.00	0004	01
		43+02L		1.00	0004	01
		44+78L		1.00	0004	01

"General Decision Number: RI20200001 01/03/2020

Superseded General Decision Number: RI20190001

State: Rhode Island

Construction Types: Building, Heavy (Heavy and Marine) and Highway

Counties: Rhode Island Statewide.

BUILDING CONSTRUCTION PROJECTS (does not include residential construction consisting of single family homes and apartments up to and including 4 stories) HEAVY, HIGHWAY AND MARINE CONSTRUCTION PROJECTS

Note: Under Executive Order (EO) 13658, an hourly minimum wage of \$10.80 for calendar year 2020 applies to all contracts subject to the Davis-Bacon Act for which the contract is awarded (and any solicitation was issued) on or after January 1, 2015. If this contract is covered by the EO, the contractor must pay all workers in any classification listed on this wage determination at least \$10.80 per hour (or the applicable wage rate listed on this wage determination, if it is higher) for all hours spent performing on the contract in calendar year 2020. If this contract is covered by the EO and a classification considered necessary for performance of work on the contract does not appear on this wage determination, the contractor must pay workers in that classification at least the wage rate determined through the conformance process set forth in 29 CFR 5.5(a)(1)(ii) (or the EO minimum wage rate, if it is higher than the conformed wage rate). The EO minimum wage rate will be adjusted annually. Please note that this EO applies to the above-mentioned types of contracts entered into by the federal government that are subject to the Davis-Bacon Act itself, but it does not apply to contracts subject only to the Davis-Bacon Related Acts, including those set forth at 29 CFR 5.1(a)(2)-(60). Additional information on contractor requirements and worker protections under the EO is available at www.dol.gov/whd/govcontracts.

Modification Number	Publication Date
0	01/03/2020

* ASBE0006-006 12/01/2019

	Rates	Fringes
HAZARDOUS MATERIAL HANDLER (Includes preparation, wetting, stripping, removal scrapping, vacuuming, bagging & disposing of all insulation materials, whether they contain asbestos or not, from mechanical systems).....	\$ 36.60	22.40

ASBE0006-008 09/01/2019

	Rates	Fringes
Asbestos Worker/Insulator Includes application of all insulating materials, protective coverings, coatings & finishes to all types of mechanical systems.	\$ 43.60	29.90

BOIL0029-001 01/01/2017

	Rates	Fringes
BOILERMAKER.....	\$ 42.42	24.92

BRRIO003-001 12/01/2019

	Rates	Fringes
Bricklayer, Stonemason, Pointer, Caulker & Cleaner.....	\$ 41.00	27.83

BRRIO003-002 09/01/2019

	Rates	Fringes
Marble Setter, Terrazzo Worker & Tile Setter.....	\$ 40.26	28.59

BRRIO003-003 09/01/2019

	Rates	Fringes
Marble, Tile & Terrazzo Finisher.....	\$ 33.64	27.58

CARP0330-001 09/01/2019

	Rates	Fringes
CARPENTER (Includes Soft Floor Layer).....	\$ 38.48	28.60

Diver Tender.....	\$ 36.28	27.15
DIVER.....	\$ 49.28	28.50
Piledriver.....	\$ 37.13	28.45
WELDER.....	\$ 39.48	28.60

FOOTNOTES:

When not diving or tending the diver, the diver and diver tender shall receive the piledriver rate. Diver tenders shall receive \$1.00 per hour above the pile driver rate when tending the diver.

Work on free-standing stacks, concrete silos & public utility electrical power houses, which are over 35 ft. in height when constructed: \$.50 per hour additional.

Work on exterior concrete shear wall gang forms, 45 ft. or more above ground elevation or on setback: \$.50 per hour additional.

The designated piledriver, known as the ""monkey"": \$1.00 per hour additional.

CARP1121-002 10/01/2017

	Rates	Fringes
MILLWRIGHT.....	\$ 36.85	27.50

ELEC0099-002 06/01/2019

	Rates	Fringes
ELECTRICIAN.....	\$ 40.40	57.24%
Teledata System Installer.....	\$ 30.30	13.10%+14.53

FOOTNOTES:

Work of a hazardous nature, or where the work height is 30 ft. or more from the floor, except when working OSHA-approved lifts: 20% per hour additional.

Work in tunnels below ground level in combined sewer outfall: 20% per hour additional.

ELEV0039-001 01/01/2019

	Rates	Fringes
ELEVATOR MECHANIC.....	\$ 51.56	33.705+A+B

FOOTNOTES:

A. PAID HOLIDAYS: New Years Day; Memorial Day; Independence Day; Labor Day; Veterans' Day; Thanksgiving Day; the Friday after Thanksgiving Day; and Christmas Day.

B. Employer contributes 8% basic hourly rate for 5 years or more of service of 6% basic hourly rate for 6 months to 5 years of service as vacation pay credit.

ENGI0057-001 12/01/2019

	Rates	Fringes
Operating Engineer: (power plants, sewer treatment plants, pumping stations, tunnels, caissons, piers, docks, bridges, wind turbines, subterranean & other marine and heavy construction work)		
GROUP 1.....	\$ 42.55	25.95+a
GROUP 2.....	\$ 40.55	25.95+a
GROUP 3.....	\$ 36.17	25.95+a
GROUP 4.....	\$ 33.32	25.95+a
GROUP 5.....	\$ 39.60	25.95+a
GROUP 6.....	\$ 30.40	25.95+a
GROUP 7.....	\$ 24.40	25.95+a
GROUP 8.....	\$ 36.25	25.95+a
GROUP 9.....	\$ 40.17	25.95+a

a. BOOM LENGTHS, INCLUDING JIBS:

- 150 feet and over + \$ 2.00
- 180 feet and over + \$ 3.00
- 210 feet and over + \$ 4.00
- 240 feet and over + \$ 5.00
- 270 feet and over + \$ 7.00
- 300 feet and over + \$ 8.00
- 350 feet and over + \$ 9.00
- 400 feet and over + \$10.00

a. PAID HOLIDAYS:

New Year's Day, President's Day, Memorial Day, July Fourth, Victory Day, Labor Day, Columbus Day, Veterans Day, Thanksgiving Day, Christmas Day. a: Any employee who works 3 days in the week in which a holiday falls shall be paid for the holiday.

a. FOOTNOTES:

- Hazmat work: \$2.00 per hour additional.
- Tunnel/Shaft work: \$5.00 per hour additional.

GROUP 1: Cranes, lighters, boom trucks and derricks

GROUP 2: Digging machine, Ross Carrier, locomotive, hoist, elevator, bidwell-type machine, shot & water blasting machine, paver, spreader, graders, front end loader (3 yds. and over), vibratory hammer & vacuum truck, roadheaders, forklifts, economobile type equipment, tunnel boring machines, concrete pump and on site concrete plants.

GROUP 3: Oilers on cranes.

GROUP 4: Oiler on crawler backhoe.

GROUP 5: Bulldozer, bobcats, skid steer loader, tractor, scraper, combination loader backhoe, roller, front end loader (less than 3 yds.), street and mobile-powered sweeper (3-yd. capacity), 8-ft. sweeper minimum 65 HP).

GROUP 6: Well-point installation crew.

GROUP 7: Utility Engineers and Signal Persons

GROUP 8: Heater, concrete mixer, stone crusher, welding machine, generator and light plant, gas and electric driven pump and air compressor.

GROUP 9: Boat & tug operator.

ENGI0057-002 11/01/2019

Rates Fringes

Power Equipment Operator
(highway construction projects; water and sewerline projects which are incidental to highway construction projects; and bridge projects that do not span water)

GROUP 1.....	\$ 35.70	25.95+a
GROUP 2.....	\$ 30.40	25.95+a
GROUP 3.....	\$ 24.40	25.95+a
GROUP 4.....	\$ 30.98	25.95+a
GROUP 5.....	\$ 34.68	25.95+a
GROUP 6.....	\$ 34.30	25.95+a
GROUP 7.....	\$ 29.95	25.95+a
GROUP 8.....	\$ 31.33	25.95+a
GROUP 9.....	\$ 33.28	25.95+a

a. FOOTNOTE: a. Any employee who works three days in the week in which a holiday falls shall be paid for the holiday.

a. PAID HOLIDAYS: New Year's Day, President's Day, Memorial

Day, July Fourth, Victory Day, Labor Day, Columbus Day, Veterans Day, Thanksgiving Day & Christmas Day.

POWER EQUIPMENT OPERATOR CLASSIFICATIONS

GROUP 1: Digging machine, crane, piledriver, lighter, locomotive, derrick, hoist, boom truck, John Henry's, directional drilling machine, cold planer, reclaimer, paver, spreader, grader, front end loader (3 yds. and over), vacuum truck, test boring machine operator, veemere saw, water blaster, hydro-demolition robot, forklift, economobile, Ross Carrier, concrete pump operator and boats

GROUP 2: Well point installation crew

GROUP 3: Utility engineers and signal persons

GROUP 4: Oiler on cranes

GROUP 5: Combination loader backhoe, front end loader (less than 3 yds.), forklift, bulldozers & scrapers and boats

GROUP 6: Roller,skid steer loaders, street sweeper

GROUP 7: Gas and electric drive heater, concrete mixer, light plant, welding machine, pump & compressor

GROUP 8: Stone crusher

GROUP 9: Mechanic & welder

ENGI0057-003 12/01/2019

BUILDING CONSTRUCTION

	Rates	Fringes
Power Equipment Operator		
GROUP 1.....	\$ 41.82	25.95+a
GROUP 2.....	\$ 39.82	25.95+a
GROUP 3.....	\$ 39.60	25.95+a
GROUP 4.....	\$ 35.60	25.95+a
GROUP 5.....	\$ 32.75	25.95+a
GROUP 6.....	\$ 38.90	25.95+a
GROUP 7.....	\$ 38.47	25.95+a
GROUP 8.....	\$ 35.79	25.95+a

a. BOOM LENGTHS, INCLUDING JIBS:

- 150 ft. and over: + \$ 2.00
- 180 ft. and over: + \$ 3.00
- 210 ft. and over: + \$ 4.00
- 240 ft. and over: + \$ 5.00
- 270 ft. and over: + \$ 7.00

- 300 ft. and over: + \$ 8.00
- 350 ft. and over: + \$ 9.00
- 400 ft. and over: + \$10.00

a. PAID HOLIDAYS: New Year's Day, President's Day, Memorial Day, July Fourth, Victory Day, Labor Day, Columbus Day, Veterans Day, Thanksgiving Day & Christmas Day. a: Any employee who works 3 days in the week in which a holiday falls shall be paid for the holiday.

- a. FOOTNOTE: Hazmat work: \$2.00 per hour additional.
Tunnel/Shaft work: \$5.00 per hour additional.

POWER EQUIPMENT OPERATORS CLASSIFICATIONS

GROUP 1: Cranes, lighters, boom trucks and derricks.

GROUP 2: Digging machine, Ross carrier, locomotive, hoist, elevator, bidwell-type machine, shot & water blasting machine, paver, spreader, front end loader (3 yds. and over), vibratory hammer and vacuum truck

GROUP 3: Telehandler equipment, forklift, concrete pump & on-site concrete plant

GROUP 4: Fireman & oiler on cranes

GROUP 5: Oiler on crawler backhoe

GROUP 6: Bulldozer, skid steer loaders, bobcats, tractor, grader, scraper, combination loader backhoe, roller, front end loader (less than 3 yds.), street and mobile powered sweeper (3 yds. capacity), 8-ft. sweeper (minimum 65 hp)

GROUP 7: Well point installation crew

GROUP 8: Heater, concrete mixer, stone crusher, welding machine, generator for light plant, gas and electric driven pump & air compressor

IRON0037-001 09/16/2019

	Rates	Fringes
IRONWORKER.....	\$ 36.27	28.98

LAB00271-001 06/02/2019

BUILDING CONSTRUCTION

	Rates	Fringes
--	-------	---------

LABORER

GROUP 1.....	\$ 31.80	25.05
GROUP 2.....	\$ 32.05	25.05
GROUP 3.....	\$ 32.55	25.05
GROUP 4.....	\$ 32.80	25.05
GROUP 5.....	\$ 33.80	25.05

LABORERS CLASSIFICATIONS

GROUP 1: Laborer, Carpenter Tender, Mason Tender, Cement Finisher Tender, Scaffold Erector, Wrecking Laborer, Asbestos Removal [Non-Mechanical Systems]

GROUP 2: Asphalt Raker, Adzemen, Pipe Trench Bracer, Demolition Burner, Chain Saw Operator, Fence & Guard Rail Erector, Setter of Metal Forms for Roadways, Mortar Mixer, Pipelayer, Riprap & Dry Stonewall Builder, Highway Stone Spreader, Pneumatic Tool Operator, Wagon Drill Operator, Tree Trimmer, Barco-Type Jumping Tamper, Mechanical Grinder Operator

GROUP 3: Pre-Cast Floor & Roof Plank Erectors

GROUP 4: Air Track Operator, Hydraulic & Similar Self-Powered Drill, Block Paver, Rammer, Curb Setter, Powderman & Blaster

GROUP 5: Toxic Waste Remover

LAB00271-002 06/02/2019

HEAVY AND HIGHWAY CONSTRUCTION

Rates Fringes

LABORER

COMPRESSED AIR

Group 1.....	\$ 49.23	23.50
Group 2.....	\$ 38.75	23.50
Group 3.....	\$ 51.23	23.50

FREE AIR

Group 1.....	\$ 41.30	23.50
Group 2.....	\$ 38.75	23.50
Group 3.....	\$ 43.30	23.50

LABORER

Group 1.....	\$ 31.80	23.05
Group 2.....	\$ 32.05	23.05
Group 3.....	\$ 32.80	23.05
Group 4.....	\$ 25.30	23.05
Group 5.....	\$ 33.80	23.05

OPEN AIR CAISSON,
UNDERPINNING WORK AND
BORING CREW

Bottom Man.....	\$ 37.80	23.05
Top Man & Laborer.....	\$ 36.85	23.05

TEST BORING

Driller.....	\$ 38.25	23.05
Laborer.....	\$ 36.85	23.05

LABORER CLASSIFICATIONS

GROUP 1: Laborer; Carpenter tender; Cement finisher tender; Wrecking laborer; Asbestos removers [non-mechanical systems]; Plant laborer; Driller in quarries

GROUP 2: Adzperson; Asphalt raker; Barcotype jumping tamper; Chain saw operators; Concrete and power buggy operator; Concrete saw operator; Demolition burner; Fence and guard rail erector; Highway stone spreader; Laser beam operator; Mechanical grinder operator; Mason tender; Mortar mixer; Pneumatic tool operator; Riprap and dry stonewall builder; Scaffold erector; Setter of metal forms for roadways; Wagon drill operator; Wood chipper operator; Pipelayer; Pipe trench bracer

GROUP 3: Air track drill operator; Hydraulic and similar powered drills; Brick paver; Block paver; Rammer and curb setter; Powderperson and blaster

GROUP 4: Flagger & signaler

GROUP 5: Toxic waste remover

LABORER - COMPRESSED AIR CLASSIFICATIONS

GROUP 1: Mucking machine operator, tunnel laborer, brake person, track person, miner, grout person, lock tender, gauge tender, miner: motor person & all others in compressed air

GROUP 2: Change house attendant, powder watchperson, top person on iron

GROUP 3: Hazardous waste work within the "HOT" zone

LABORER - FREE AIR CLASSIFICATIONS

GROUP 1: Grout person - pumps, brake person, track person, form mover & stripper (wood & steel), shaft laborer, laborer topside, outside motorperson, miner, conveyor operator, miner welder, heading motorperson, erecting operator, mucking machine operator, nozzle person, rodperson, safety miner, shaft & tunnel, steel & rodperson, mole nipper, concrete worker, form erector (wood, steel and all accessories), cement finisher (this type of work only), top signal person, bottom person (when heading is 50' from shaft), burner, shield operator and TBM operator

GROUP 2: Change house attendant, powder watchperson

GROUP 3: Hazardous waste work within the "HOT" zone

PAIN0011-005 06/01/2019

	Rates	Fringes
PAINTER		
Brush and Roller.....	\$ 34.62	21.80
Epoxy, Tanks, Towers, Swing Stage & Structural		
Steel.....	\$ 36.62	21.80
Spray, Sand & Water		
Blasting.....	\$ 37.62	21.80
Taper.....	\$ 35.37	21.80
Wall Coverer.....	\$ 35.12	21.80

PAIN0011-006 06/01/2019

	Rates	Fringes
GLAZIER.....	\$ 38.18	21.80

FOOTNOTES:

SWING STAGE: \$1.00 per hour additional.

PAID HOLIDAYS: Labor Day & Christmas Day.

PAIN0011-011 06/01/2019

	Rates	Fringes
Painter (Bridge Work).....	\$ 51.00	21.80

PAIN0035-008 06/01/2011

	Rates	Fringes
Sign Painter.....	\$ 24.79	13.72

PLAS0040-001 06/03/2019

BUILDING CONSTRUCTION

	Rates	Fringes
CEMENT MASON/CONCRETE FINISHER...	\$ 36.00	27.15

FOOTNOTE: Cement Mason: Work on free swinging scaffolds under 3 planks width and which is 20 or more feet above ground and any offset structure: \$.30 per hour additional.

PLAS0040-002 07/01/2019

HEAVY AND HIGHWAY CONSTRUCTION

	Rates	Fringes
CEMENT MASON/CONCRETE FINISHER...	\$ 32.85	22.20

PLAS0040-003 07/01/2019

	Rates	Fringes
PLASTERER.....	\$ 37.55	27.50

PLUM0051-002 09/02/2019

	Rates	Fringes
Plumbers and Pipefitters.....	\$ 42.94	29.70

ROOF0033-004 12/01/2019

	Rates	Fringes
ROOFER.....	\$ 37.90	27.25

SFRI0669-001 04/01/2019

	Rates	Fringes
SPRINKLER FITTER.....	\$ 45.57	24.33

SHEE0017-002 12/01/2018

	Rates	Fringes
Sheet Metal Worker.....	\$ 36.13	35.13

TEAM0251-001 05/01/2019

HEAVY AND HIGHWAY CONSTRUCTION

	Rates	Fringes
TRUCK DRIVER		
GROUP 1.....	\$ 27.96	26.8525+A+B+C
GROUP 2.....	\$ 27.61	26.8525+A+B+C
GROUP 3.....	\$ 27.66	26.8525+A+B+C
GROUP 4.....	\$ 27.71	26.8525+A+B+C
GROUP 5.....	\$ 27.81	26.8525+A+B+C
GROUP 6.....	\$ 28.21	26.8525+A+B+C
GROUP 7.....	\$ 28.41	26.8525+A+B+C
GROUP 8.....	\$ 27.91	26.8525+A+B+C
GROUP 9.....	\$ 28.16	26.8525+A+B+C
GROUP 10.....	\$ 27.96	26.8525+A+B+C

FOOTNOTES:

A. Paid Holidays: New Year's Day, Memorial Day, Independence Day, Labor Day, Thanksgiving Day and Christmas Day, plus Presidents' Day, Columbus Day, Veteran's Day & V-J Day, providing the employee has worked at least one day in the calendar week in which the holiday falls.

B. Employee who has been on the payroll for 1 year or more but less than 5 years and has worked 150 Days during the last year of employment shall receive 1 week's paid vacation; 5 to 10 years - 2 weeks' paid vacation; 10 or more years - 3 week's paid vacation.

C. Employees on the seniority list shall be paid a one hundred dollar (\$100.00) bonus for every four hundred (400) hours worked, up to a maximum of five hundred dollars (\$500.00)

All drivers working on a defined hazard material job site shall be paid a premium of \$2.00 per hour over applicable rate.

TRUCK DRIVER CLASSIFICATIONS

GROUP 1: Pick-up trucks, station wagons, & panel trucks

GROUP 2: Two-axle on low beds

GROUP 3: Two-axle dump truck

GROUP 4: Three-axle dump truck

GROUP 5: Four- and five-axle equipment

GROUP 6: Low-bed or boom trailer.

GROUP 7: Trailers when used on a double hook up (pulling 2 trailers)

GROUP 8: Special earth-moving equipment, under 35 tons

GROUP 9: Special earth-moving equipment, 35 tons or over

GROUP 10: Tractor trailer

WELDERS - Receive rate prescribed for craft performing operation to which welding is incidental.

=====
Note: Executive Order (EO) 13706, Establishing Paid Sick Leave

for Federal Contractors applies to all contracts subject to the Davis-Bacon Act for which the contract is awarded (and any solicitation was issued) on or after January 1, 2017. If this contract is covered by the EO, the contractor must provide employees with 1 hour of paid sick leave for every 30 hours they work, up to 56 hours of paid sick leave each year. Employees must be permitted to use paid sick leave for their own illness, injury or other health-related needs, including preventive care; to assist a family member (or person who is like family to the employee) who is ill, injured, or has other health-related needs, including preventive care; or for reasons resulting from, or to assist a family member (or person who is like family to the employee) who is a victim of, domestic violence, sexual assault, or stalking. Additional information on contractor requirements and worker protections under the EO is available at www.dol.gov/whd/govcontracts.

Unlisted classifications needed for work not included within the scope of the classifications listed may be added after award only as provided in the labor standards contract clauses (29CFR 5.5 (a) (1) (ii)).

The body of each wage determination lists the classification and wage rates that have been found to be prevailing for the cited type(s) of construction in the area covered by the wage determination. The classifications are listed in alphabetical order of "identifiers" that indicate whether the particular rate is a union rate (current union negotiated rate for local), a survey rate (weighted average rate) or a union average rate (weighted union average rate).

Union Rate Identifiers

A four letter classification abbreviation identifier enclosed in dotted lines beginning with characters other than "SU" or "UAVG" denotes that the union classification and rate were prevailing for that classification in the survey. Example: PLUM0198-005 07/01/2014. PLUM is an abbreviation identifier of the union which prevailed in the survey for this classification, which in this example would be Plumbers. 0198 indicates the local union number or district council number where applicable, i.e., Plumbers Local 0198. The next number, 005 in the example, is an internal number used in processing the wage determination. 07/01/2014 is the effective date of the most current negotiated rate, which in this example is July 1, 2014.

Union prevailing wage rates are updated to reflect all rate changes in the collective bargaining agreement (CBA) governing this classification and rate.

Survey Rate Identifiers

Classifications listed under the "SU" identifier indicate that no one rate prevailed for this classification in the survey and the published rate is derived by computing a weighted average rate based on all the rates reported in the survey for that classification. As this weighted average rate includes all rates reported in the survey, it may include both union and non-union rates. Example: SULA2012-007 5/13/2014. SU indicates the rates are survey rates based on a weighted average calculation of rates and are not majority rates. LA indicates the State of Louisiana. 2012 is the year of survey on which these classifications and rates are based. The next number, 007 in the example, is an internal number used in producing the wage determination. 5/13/2014 indicates the survey completion date for the classifications and rates under that identifier.

Survey wage rates are not updated and remain in effect until a new survey is conducted.

Union Average Rate Identifiers

Classification(s) listed under the UAVG identifier indicate that no single majority rate prevailed for those classifications; however, 100% of the data reported for the classifications was union data. EXAMPLE: UAVG-OH-0010 08/29/2014. UAVG indicates that the rate is a weighted union average rate. OH indicates the state. The next number, 0010 in the example, is an internal number used in producing the wage determination. 08/29/2014 indicates the survey completion date for the classifications and rates under that identifier.

A UAVG rate will be updated once a year, usually in January of each year, to reflect a weighted average of the current negotiated/CBA rate of the union locals from which the rate is based.

 WAGE DETERMINATION APPEALS PROCESS

1.) Has there been an initial decision in the matter? This can be:

- * an existing published wage determination
- * a survey underlying a wage determination
- * a Wage and Hour Division letter setting forth a position on a wage determination matter
- * a conformance (additional classification and rate) ruling

On survey related matters, initial contact, including requests for summaries of surveys, should be with the Wage and Hour Regional Office for the area in which the survey was conducted

because those Regional Offices have responsibility for the Davis-Bacon survey program. If the response from this initial contact is not satisfactory, then the process described in 2.) and 3.) should be followed.

With regard to any other matter not yet ripe for the formal process described here, initial contact should be with the Branch of Construction Wage Determinations. Write to:

Branch of Construction Wage Determinations
Wage and Hour Division
U.S. Department of Labor
200 Constitution Avenue, N.W.
Washington, DC 20210

2.) If the answer to the question in 1.) is yes, then an interested party (those affected by the action) can request review and reconsideration from the Wage and Hour Administrator (See 29 CFR Part 1.8 and 29 CFR Part 7). Write to:

Wage and Hour Administrator
U.S. Department of Labor
200 Constitution Avenue, N.W.
Washington, DC 20210

The request should be accompanied by a full statement of the interested party's position and by any information (wage payment data, project description, area practice material, etc.) that the requestor considers relevant to the issue.

3.) If the decision of the Administrator is not favorable, an interested party may appeal directly to the Administrative Review Board (formerly the Wage Appeals Board). Write to:

Administrative Review Board
U.S. Department of Labor
200 Constitution Avenue, N.W.
Washington, DC 20210

4.) All decisions by the Administrative Review Board are final.

=====

END OF GENERAL DECISION

"