

August 23, 2019

STATE OF RHODE ISLAND AND PROVIDENCE PLANTATION
DEPARTMENT OF ADMINISTRATION

DIVISION OF PURCHASES BID No. 7598921

RHODE ISLAND DEPARTMENT OF TRANSPORTATION

RHODE ISLAND CONTRACT No. 2019-CH-083

FEDERAL-AID PROJECT NO. FAP Nos: STPG-HSIP(066), STP-RESF(401)

Old Tower Hill Rd (Rt 108 – Rt 1)

CITY/TOWN OF SOUTH KINGSTOWN

COUNTY OF WASHINGTON

NOTICE TO PROSPECTIVE BIDDERS

ADDENDUM NO. 1 Prospective bidders and all concerned are hereby notified of the following changes in the Plans, Specifications, Proposal and Distribution of Quantities for this contract. These changes shall be incorporated in the Plans, Specifications, Proposal and Distribution of Quantities, and shall become an integral part of the Contract Documents.

A. Questlite Bid File

1. The Questlite Bid File is now available for download through the State Purchasing website.

B. Plan Sheets

1. Replace Plan Sheet 13 with Sheet 13(R-1) attached to this Addendum #1. An additional limit for clean and flush pipe has been added.
2. Replace Plan Sheet 14 with Sheet 14(R-1) attached to this Addendum #1. An additional limit for clean and flush pipe has been added.
3. Replace Plan Sheet 16 with Sheet 16(R-1) attached to this Addendum #1. An additional limit for clean and flush pipe has been added.

C. Contract Specific

1. Replace Page 3 of 3 of Appendix B (Transportation Management Plan) with page 3 of 3 (R-1) attached to this Addendum #1. The Transportation Management Plan has been signed.

D. Job Specific Pages

1. Replace Job Specific Page JS-i and JS-ii with Page JS-i(R-1) and JS-ii(R-1) attached to this Addendum #1. The table of contents has been revised to reflect the additional items, and changes to item codes and page numbers.
2. Replace Job Specific Page JS-1 with Page JS-1(R-1), JS-1A, and JS-1B attached to this Addendum #2. Item Code 105.02 has been added.

E. Distribution of Quantities

1. Replace Table of Contents with Table of Contents index pages 1(R-1) through 4(R-1) attached to this Addendum #1. The Table of Contents has been revised.
2. Replace page 17 and page 18 with page 17(R-1), page 17A, and page 18(R-1) attached to this Addendum #1. The quantity for Item Code 201.0403 Cleaning and Flushing Pipe All Sizes has been revised.

David W. Froh

RI Department of Transportation
Administrator, Division of Project Management

REV.	DATE	BY	DESCRIPTION
1	12/13/10	JL	ISSUED FOR PERMIT

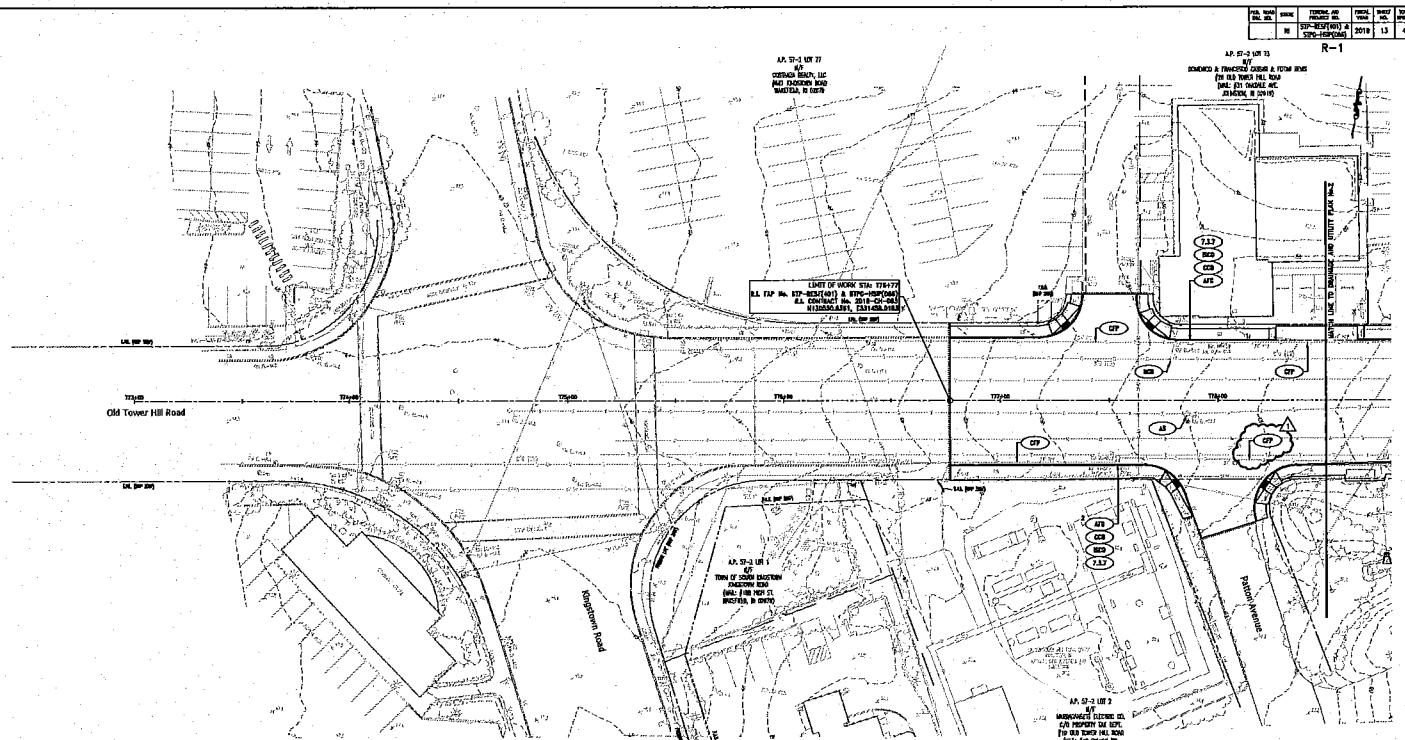

AP 57-1 LOT 77
 GEORGE HART, LLC
 100 FORTRESS ROAD
 WESTFIELD, RI 02891

AP 57-1 LOT 73
 BROWN & FROSTEN CORP & FOM BROS
 100 OLD TOWER HILL ROAD
 WESTFIELD, RI 02891

LINE OF WORK STA. 174+77.77
 U.S. FIP NO. 87-852(401) & 879-100(204)
 ALL CONTRACT NO. 2010-01-001
 (WATERMAIN, FUTURE)

AP 57-1 LOT 77
 NEW OF CONSTRUCTION
 PROPOSED NEW
 12\"/>

AP 57-1 LOT 2
 BROWN & FROSTEN CORP.
 100 OLD TOWER HILL ROAD
 WESTFIELD, RI 02891

REVISIONS		DATE		BY	
1	12/13/10	JL			

RHODE ISLAND
 DEPARTMENT OF TRANSPORTATION
 IMPROVEMENTS TO
 OLD TOWER HILL ROAD
 SOUTH KINGSTOWN, RHODE ISLAND
 DRAINAGE AND UTILITY
 PLAN No.1

SCALE: 1"=20'
 CHECKED BY: _____ DATE: _____



ADDENDUM No.1

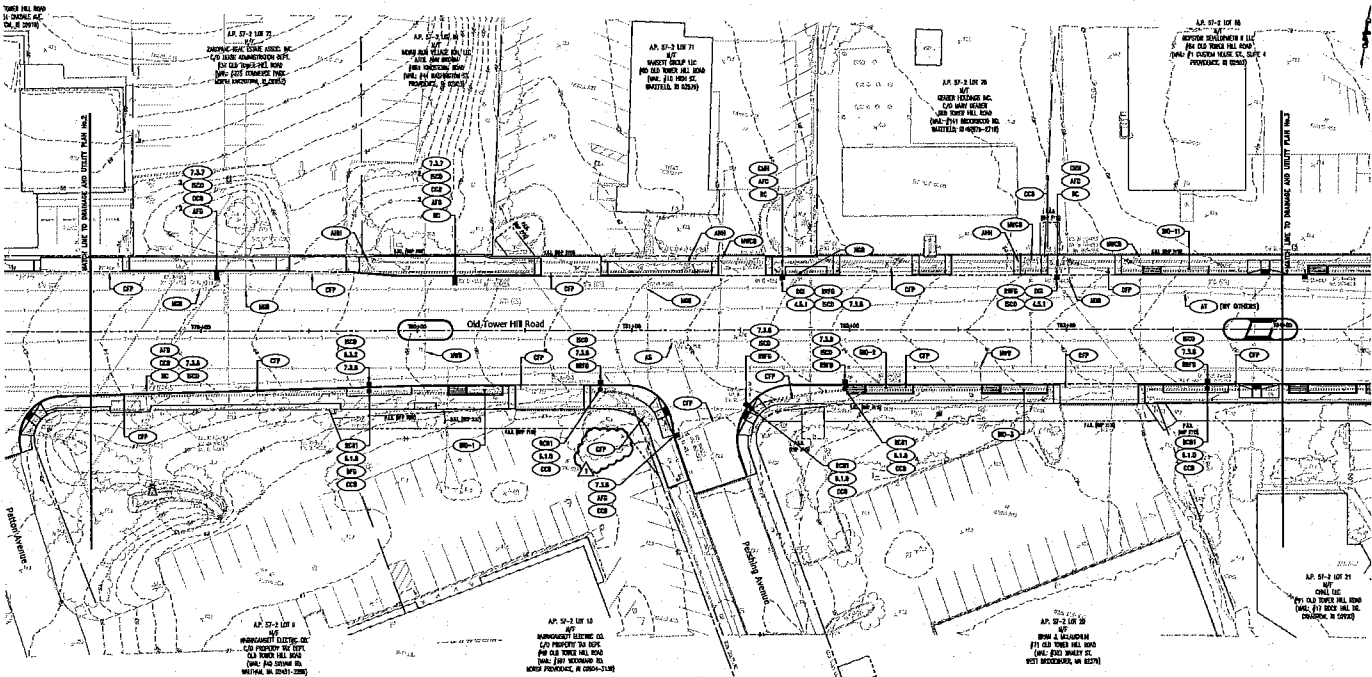

ADDENDUM No.1



REVISIONS		RHODE ISLAND DEPARTMENT OF TRANSPORTATION	
NO.	DATE	IMPROVEMENTS TO OLD TOWER HILL ROAD	
1	11/15/11	SOUTH KINGSTOWN, RHODE ISLAND	
		DRAINAGE AND UTILITY PLAN No.2	
CHECKED BY		DATE	SCALE 1"=20'

DATE	NO.	BY	REVISIONS
12/18/2018	1	MM	ISSUE FOR CONSTRUCTION

R-1

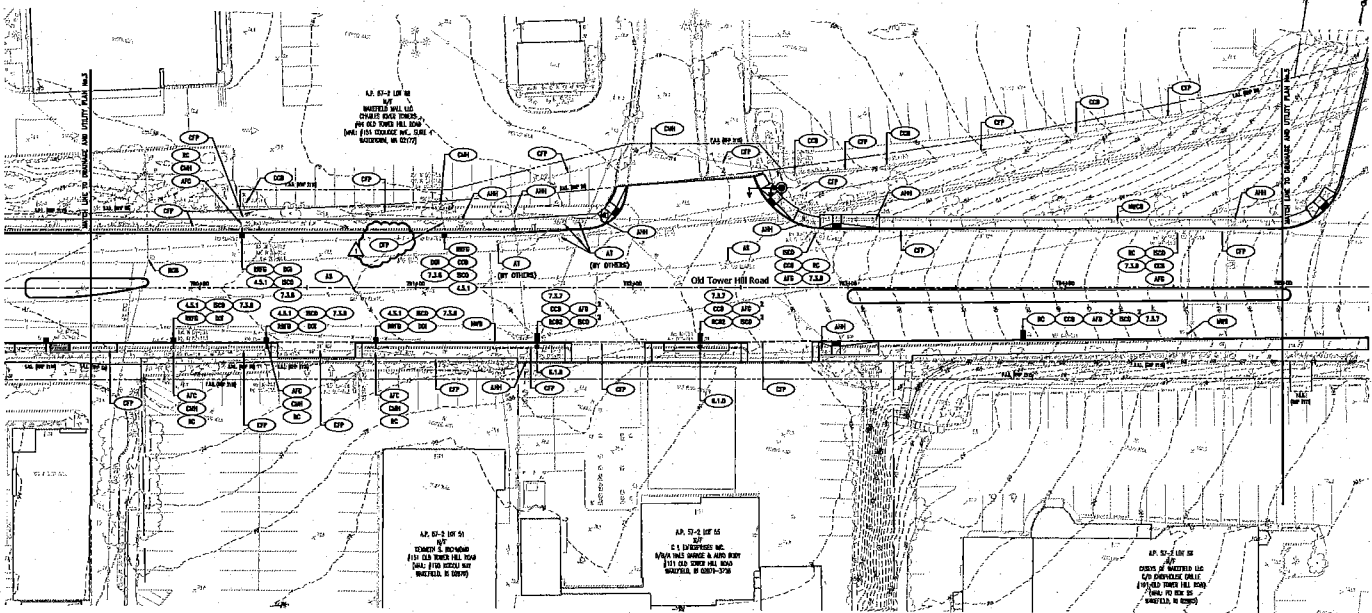

A.P. 57-3 LOT 16
 10' WIDE SIDEWALK
 FOR OLD TOWER HILL ROAD
 (SEE PLAN 57-3-101 FOR
 DETAILS & NOTES)

A.P. 57-3 LOT 15
 10' WIDE SIDEWALK
 FOR OLD TOWER HILL ROAD
 (SEE PLAN 57-3-101 FOR
 DETAILS & NOTES)

A.P. 57-3 LOT 15
 10' WIDE SIDEWALK
 FOR OLD TOWER HILL ROAD
 (SEE PLAN 57-3-101 FOR
 DETAILS & NOTES)

REVISED		NO.		DATE		BY	
1		1		12/18/2018		MM	

RHODE ISLAND
 DEPARTMENT OF TRANSPORTATION

IMPROVEMENTS TO
 OLD TOWER HILL ROAD

SOUTH KINGSTOWN, RHODE ISLAND

DRAINAGE AND UTILITY
 PLAN No. 4

CHECKED BY _____ DATE _____ SCALE 1"=20'

DRAWN BY: JMM/MSD/ML



ADDENDUM No. 1

PERFORMANCE MONITORING, CHANGES TO TMP, & CONTINGENCIES

The Contractor's TMP Implementation Manager (if identified below) is responsible for keeping the portion of the project being used by public traffic in a condition that (1) safely and adequately accommodates such traffic and (2) is in accordance with the Traffic-Related Work Restrictions, the Temporary Traffic Control Plans, and where appropriate, the other transportation management strategies identified above. The RIDOT TMP Implementation Manager or his/her responsible designee should (1) inspect the project work zones at initial setup, at the start of each subsequent work day, and just prior to extended breaks in the work (e.g., weekends) for conformance with the Temporary Traffic Control Plans, the ATSSA *Quality Guidelines for Temporary Traffic Control Devices and Features*, and where applicable, the other transportation management strategies identified above and (2) document all work zone-related feedback and complaints that are received from the public.

If at any time (1) a significant deviation from any of the strategies included in the TMP (e.g., the use of an alternate construction sequence) is desired by one or more members of the project implementation team, (2) field observations and/or data suggest that impacts to road users are or will be unacceptable, or (3) one or more performance requirements established in the TMP are not being met in the field, the RIDOT TMP Implementation Manager shall report the situation to his/her supervisor or Division/Section/Unit manager. The supervisor / manager will coordinate with the Administrator of Project Management, the State Traffic Engineer, the TMP Implementation Manager(s), the Chief Engineer, and/or other interested parties as appropriate and/or necessary to consider and determine whether revised and/or alternate strategies should be implemented in an effort to lessen the adverse safety and/or mobility impacts of the project. If the supervisor / manager deems that strategy changes should be implemented, the changes shall be documented in a revised version of the TMP and the Administrator of Project Management, the State Traffic Engineer, and the Chief Engineer must approve of the revised TMP prior to their implementation.

If a significant deviation from any of the strategies included in the TMP is requested by the Contractor, unless directed otherwise by the RIDOT the Contractor is responsible for preparing and submitting to the RIDOT TMP Implementation Manager appropriate documentation (e.g., design calculations, analysis reports, Temporary Traffic Control Plans, etc.) showing that the requested change(s) are (1) feasible and (2) expected to result in safety and mobility impacts that are no more adverse than the impacts resulting from the strategies already included in the latest approved TMP. The RIDOT will review and consider the submittal(s) as described in the preceding paragraph and will determine whether the changes should be implemented. If the requested changes are approved by the RIDOT, unless otherwise directed by the RIDOT the Contractor shall prepare and submit to the RIDOT TMP Implementation Manager a revised version of the latest approved TMP in both printed and electronic (Microsoft® Excel) format that documents all of the approved changes. Work to implement the changes shall not begin until the Administrator of Project Management, the State Traffic Engineer, and the Chief Engineer have approved of the revised TMP.

When unexpected events (e.g., crashes, inclement weather, unforeseen traffic demands, etc.) occur in a project work zone where one or more lanes are closed, the RIDOT TMP Implementation Manager or his/her responsible designee should (1) determine whether or not the lane closure(s) can/should be removed in order to improve traffic operations and/or minimize delays and (2) if deemed appropriate, take action to remove the lane closure(s).

Other Requirements:

TMP APPROVALS

All approvals must be obtained prior to start of work

ADMINISTRATOR PROJECT MNGMT		
Signature:	<i>David W. Fish</i> David Fish, P.E.	
Date:	8-1-19	
Revision #	Initials	Date

STATE TRAFFIC ENGINEER		
Signature:	<i>Steve Pristawa</i> Steve Pristawa P.E.	
Date:	8/1/2019	
Revision #	Initials	Date

CHIEF ENGINEER		
Signature:	<i>Robert Rocchio</i> Robert Rocchio, P.E.	
Date:	8/2/19	
Revision #	Initials	Date

TMP IMPLEMENTATION MANAGERS

Project managers with the primary responsibility & authority for implementation of this TMP

RIDOT
Name: _____
Title: _____
Unit: _____
Office Phone: _____
Mobile Phone: _____
E-Mail: _____

CONTRACTOR (if contract work)
Name: _____
Title: _____
Company/Unit: _____
Office Phone: _____
Mobile Phone: _____
E-Mail: _____

**SPECIFICATIONS - JOB SPECIFIC
TABLE OF CONTENTS**

<u>CODE</u>	<u>TITLE</u>	<u>PAGE</u>
105.02	Plans and Shop Drawings	JS - 1
108.03	Prosecution and Progress – Project Schedule Program & Software	JS – 1B
108.1000	Prosecution and Progress – Failure to Complete on Time	JS – 2
201.9901	Remove and Salvage Traffic Signal Equipment at Traffic Signal No. 659	JS – 3
201.9902	Remove, Stockpile, and Reset Bus Shelter	JS – 5
201.9903	Remove and Dispose Gutter Inlet	JS – 6
201.9904	Remove, Stockpile, and Reset Frame and Grate	JS – 7
212.1000	Failure to Maintain Erosion and Pollution Controls	JS – 8
704.9901	Reconstruct Catch Basin – Type 1	JS – 9
704.9902	Reconstruct Catch Basin – Type 2	
711.9901	Bioretention Curb Inlet Planter No. 1	JS – 10
711.9902	Bioretention Curb Inlet Planter No. 2	
711.9903	Bioretention Curb Inlet Planter No. 3	
711.9904	Hydrodynamic Separator Retrofit	JS – 13
905.1000	Sidewalks	JS – 15
905.9901	Furnish and Install Decorative Crosswalk	JS – 16
907.1000	Dust Control	JS – 18
923.9901	Longitudinal Pedestrian Channelizing Device	JS – 19
937.1000	Maintenance and Movement of Traffic Protection Devices	JS – 20
938.1000	Price Adjustments	JS – 21
L01.9901	Pine Bark Mulch (3” Depth)	JS – 23
L02.1000	Seeding	JS – 24
T11.9901	15-Foot Galvanized Steel Mast Arm Traffic Signal Post and Foundation	JS – 25
T12.9901	Modify Traffic Signal Controller and Cabinet	JS – 27

<u>CODE</u>	<u>TITLE</u>	<u>PAGE</u>
T13.8210	Accessible Pedestrian Detector – Pushbutton with Sign	JS – 28
T14.9901	One-way Bracket Mounted LED Pedestrian Signal Head with Countdown Timer 12-Inch	JS – 31
T14.9902	Retrofit Existing Pedestrian Signal with Countdown Timer	JS – 32

Remove Subsection 105.02, Plans and Shop Drawings, pages 1-32 and 1-33 of the RI Standard Specifications for Road and Bridge Construction in its entirety and replace it with the following:

**JOB SPECIFIC
PLANS AND SHOP DRAWINGS**

105.02 Plans and Shop Drawings. Plans shall be supplemented by Contractor-prepared Shop Drawings as necessary to control the Work and its prosecution. Shop Drawings consisting of details that are not included in the Plans but required for the Work shall be furnished to the Department. Copies of any calculations required or used to prepare the Shop Drawings shall be furnished with the submission. Manufacturer's engineering data for prefabricated material, including that for falsework and forms shall be furnished with each set of Shop Drawings.

1. The Contractor shall submit to the Department for approval or documentation, the necessary Shop Drawings in a timely manner so as not to adversely affect the Contractor's accepted schedule. The Contractor shall not perform work for items requiring shop drawings before receiving approval of the corresponding Shop Drawings. This approval shall neither confer upon the State nor relieve the Contractor of any responsibility for the accuracy and completeness of the drawings, conformity with Contract requirements and successful completion of the Contract. Prior to approval of the Contractor's shop drawing, the Contractor bears all risk and all costs of delays for items related to the respective shop drawing.
2. Shop Drawings illustrate the Contractor's way it intends to carry out the design concepts contained in the Contract and are not part of the Contract. The Contractor's submission of a Shop Drawing represents to the Engineer that the Contractor (i) coordinated the Shop Drawing with the Contract; (ii) verified and measured the field dimensions and other information; (iii) calculated all details, construction and performance criteria; and (iv) reviewed and accepted the Shop Drawings as its means and methods.
3. Submission of Shop Drawings. All shop drawings shall be submitted in a timely fashion such that the Contractor's accepted schedule will not be adversely impacted by the submittal process.

Shop drawing submittals shall be via PDF files submitted electronically by the Contractor into the Department's web-based Project Management Portal (PMP), per RIDOT procedure posted in the Documents Tab. Each shop drawing submittal shall be accompanied by design computations, cuts from manufacturers' catalogs, and/or all other supporting technical bulletins and data. Upon the Department's request, once shop drawings have been approved or approved as noted, the Contractor shall submit for the record four (4) hard copy sets of shop drawings to the Department.

- a. All Shop Drawings shall be stamped by a Rhode Island Registered Professional Engineer. The stamping of Shop Drawings shall be in accordance with the applicable requirements of the Rhode Island Board of Registration for Professional Engineers, or other Boards of Professional Registration, as applicable.
4. Approval of Shop Drawings All shop drawings will be reviewed and returned to the

Contractor for appropriate action within 45 calendar days from receipt of the submission or resubmission, or as detailed in the Contract.

- a. Shop drawings that are found to be erroneous, lacking required Professional Engineer stamps, lacking information necessary to control construction, or not in conformance with accepted design criteria will be rejected and returned to the Contractor. The Contractor shall address the Engineer's comments and resubmit revised shop drawings.
 - b. Shop drawings designated "Approved-As-Noted" may be used by the Contractor to commence corresponding work subject to satisfying the written conditions of the approval; such shop drawings shall be revised according to the notes (as applicable) and transmitted to the Engineer within fourteen calendar days of such approval.
5. There shall be no claims for additional payment by the Contractor, nor will there be an extension of time under Section 108.03 for delays resulting from resubmissions due to incomplete Shop Drawings; for the time taken by the Contractor to submit revised Shop Drawings caused by an erroneous submission; or by a previous submission either lacking the information necessary to control construction; or for not conforming to accepted design criteria. In addition, the Engineer's review time of the revised Shop Drawings will not constitute justification for an extension of time.
6. The Contract price includes the cost of furnishing all Shop Drawings, including resubmissions.

JOB SPECIFIC

**SECTION 108.03
PROSECUTION AND PROGRESS**

In accordance with **Section 108.03, PROSECUTION AND PROGRESS, Para. a., General Requirements, 1 Project Schedule Program**

The Schedule Level for this contract is **Schedule Level B.**

Table of Contents - Distribution of Quantities

Project Name - Old Tower Hill Rd (Rt 108 - Rt 1)

Estimate Name - Addendum 1

R.I. Contract No. - 2019-CH-083

FAP Nos: STPG-HSIP(066), STP-RESF(401)

ItemCode	Description	Page
201.0321	CLEARING AND GRUBBING	1
201.0402	REMOVE AND DISPOSE CONCRETE CURB	1
201.0403	REMOVE AND DISPOSE SIDEWALKS	2
201.0409	REMOVE AND DISPOSE FLEXIBLE PAVEMENT	2
201.0421	REMOVE AND DISPOSE BITUMINOUS CURB	4
201.0428	REMOVE AND DISPOSE FRAME AND GRATE OR FRAME AND COVER	4
201.0610	REMOVE AND DISPOSE DIRECTIONAL, WARNING, REGULATORY, SERVICE, AND STREET SIGNS	4
201.9901	REMOVE AND SALVAGE TRAFFIC SIGNAL EQUIPMENT AT TRAFFIC SIGNAL NO. 659	5
201.9902	REMOVE, STOCKPILE, AND RESET BUS SHELTER	5
201.9903	REMOVE AND DISPOSE GUTTER INLET	5
201.9904	REMOVE, STOCKPILE, AND RESET FRAME AND GRATE	6
202.0100	EARTH EXCAVATION	6
202.0201	ROCK EXCAVATION MECHANICAL	7
204.0100	TRIMMING AND FINE GRADING	7
206.0301	COMPOST FILTER SOCK	7
209.9901	INLET SEDIMENT CONTROL DEVICE	8
212.2100	MAINTENANCE AND CLEANING OF EROSION AND POLLUTION CONTROLS	9
302.0100	GRAVEL BORROW SUBBASE COURSE	9
401.1000	CLASS 19.0 HMA	9
401.2100	MODIFIED CLASS 12.5 HMA	9
403.0300	ASPHALT EMULSION TACK COAT	10
601.0300	CLASS A PORTLAND CEMENT CONCRETE	10
701.5312	12 INCH DUCTILE IRON WATER PIPE CLASS 52, PUSH-ON JOINT	10
701.8151	CURB STOP BOX	11
702.0511	FRAME AND COVER STANDARD 6.1.0	11
702.0517	FRAME AND GRATE, STANDARD 6.3.2	11
702.0542	GRANITE APRON STONE 5FT. STANDARD 7.3.7	12
702.0543	GRANITE APRON STONE 38'' STANDARD 7.3.8	12
702.0713	PRECAST CONCRETE DROP INLET WITH APRON STONE STANDARD 4.5.1	13
704.0100	RECONSTRUCT CATCH BASIN/CORBEL CONES	13
704.0200	RECONSTRUCT MANHOLE/CORBEL CONES	14
704.9901	RECONSTRUCT CATCH BASIN - TYPE 1	14
704.9902	RECONSTRUCT CATCH BASIN - TYPE 2	15
707.1000	ADJUST SANITARY MANHOLE	15
707.1900	ADJUST FRAME & COVER TO GRADE	15
707.2000	ADJUST FRAME AND GRATE TO GRADE	16
708.9040	CLEANING AND FLUSHING PIPE ALL SIZES	16
708.9041	CLEANING CATCH BASINS ALL TYPES AND SIZES	18
708.9042	CLEANING MANHOLES ALL TYPES AND SIZES	19
711.9901	BIORETENTION CURB INLET PLANTER NO. 1	19
711.9902	BIORETENTION CURB INLET PLANTER NO. 2	20
711.9903	BIORETENTION CURB INLET PLANTER NO. 3	20
711.9904	HYDRODYNAMIC SEPARATOR RETROFIT	20
712.0100	WATER GATE BOX	20
712.0200	GAS GATE BOX	21
905.0110	PORTLAND CEMENT SIDEWALK MONOLITHIC STANDARD 43.1.0	21
905.0115	PORTLAND CEMENT CONCRETE DRIVEWAY STANDARD 43.5.0	22
905.9901	FURNISH AND INSTALL DECORATIVE CROSSWALK	23
906.0100	SLOPE FACED GRANITE CURB - QUARRY SPLIT STRAIGHT STANDARD 7.4.0	24

Table of Contents - Distribution of Quantities

Project Name - Old Tower Hill Rd (Rt 108 - Rt 1)

Estimate Name - Addendum 1

R.I. Contract No. - 2019-CH-083

FAP Nos: STPG-HSIP(066), STP-RESF(401)

ItemCode	Description	Page
906.0101	SLOPE FACED GRANITE CURB - QUARRY SPLIT CIRCULAR STANDARD 7.4.0	24
906.0110	GRANITE CURB, QUARRY SPLIT STRAIGHT, STANDARD 7.3.0	25
906.0111	GRANITE CURB, QUARRY SPLIT CIRCULAR, STANDARD 7.3.0	27
906.0118	6' GRANITE TRANSITION CURB, QUARRY SPLIT SPECIAL TRANSITION STANDARD 7.3.2	28
906.0119	3' GRANITE TRANSITION CURB STANDARD 7.3.1	29
906.0120	GRANITE WHEELCHAIR RAMP CURB STANDARDS 7.3.3, 43.3.0 AND 43.3.1	30
906.0130	GRANITE RAMP STONE STRAIGHT STANDARD 7.3.9	31
906.0561	CEMENT CONCRETE EDGING 18 INCH LOT CURB STANDARD 7.2.3	31
906.0602	BITUMINOUS BERM STANDARD 7.5.1	31
907.0100	WATER FOR DUST CONTROL	32
914.5010	FLAGPERSONS	32
914.5020	FLAGPERSONS - OVERTIME	32
919.0101	TEST PITS	32
922.0100	TEMPORARY CONSTRUCTION SIGNS STANDARD 29.1.0 AND 27.1.1	32
923.0105	DRUM BARRICADE STANDARD 26.2.0	33
923.0120	PLASTIC PIPE BARRICADE STANDARD 26.3.0	33
923.0200	FLUORESCENT TRAFFIC CONES STANDARD 26.1.0	33
923.9901	LONGITUDINAL PEDESTRIAN CHANNELIZING DEVICES	34
925.0112	PORTABLE CHANGEABLE MESSAGE SIGN	34
928.0500	SHADOW OR ADVANCE WARNING VEHICLE WITH IMPACT ATTENUATOR AND FLASHING ARROW BOARD	34
929.0110	FIELD OFFICE	34
931.0110	CLEANING AND SWEEPING PAVEMENT	34
932.0100	CUTTING AND MATCHING ASPHALT	34
932.0200	FULL-DEPTH SAWCUT OF BITUMINOUS PAVEMENT	35
932.0220	FULL DEPTH SAWCUT OF BITUMINOUS SIDEWALK/DRIVEWAY	36
932.0230	FULL DEPTH SAWCUT OF PORTLAND CEMENT CONCRETE SIDEWALK/DRIVEWAY	37
935.0400	REMOVING BITUMINOUS PAVEMENT BY MICRO MILLING	37
936.0100	MOBILIZATION AND DEMOBILIZATION	37
937.0200	MAINTENANCE AND MOVEMENT TRAFFIC PROTECTION	38
942.0200	DETECTABLE WARNING PANEL STANDARD 48.1.0	38
L01.0102	LOAM BORROW 4 INCHES DEEP	38
L01.9901	PINE BARK MULCH (3" DEPTH)	39
L01.9902	LANDSCAPE AREAS	40
L02.0102	RESIDENTIAL SEEDING (TYPE 2)	40
L06.9901	ACER SACCARUM 'SUGAR MAPLE'	40
L06.9902	CRATAEGUS VIRIDIS 'WINTER KING'	40
L06.9903	TILIA CORDATA 'HALKA'	40
L06.9904	ULMUS AMERICANA 'PRINCETON'	40
L06.9905	CALAMAGROSTIS X ACUTIFLORA 'KARL FOERSTER'	41
L06.9906	LIRIPOE SPICATA 'BIG BLUE'	41
L11.0102	TREE PLANT PROTECTION DEVICE STANDARD 51.1.0	41
L11.0103	SHRUB PLANT PROTECTION DEVICE STANDARD 51.2.0	42
T04.5302	14 AWG 2 CONDUCTOR TWISTED SHIELDED CABLE	42
T04.5303	14 AWG 3 CONDUCTOR CABLE	42
T04.5305	14 AWG 5 CONDUCTOR CABLE	43
T05.0400	BREAK INTO EXISTING HANDHOLE	43
T05.1030	ADJUST HANDHOLE TO GRADE	43
T06.5130	3 INCH SCHEDULE 40 POLYVINYL CHLORIDE PLASTIC CONDUIT - UNDERGROUND	44

Table of Contents - Distribution of Quantities

Project Name - Old Tower Hill Rd (Rt 108 - Rt 1)

Estimate Name - Addendum 1

R.I. Contract No. - 2019-CH-083

FAP Nos: STPG-HSIP(066), STP-RESF(401)

ItemCode	Description	Page
T11.9901	15 FOOT GAL. STEEL MAST ARM TRAFFIC SIGNAL POST AND FOUNDATION	44
T12.9901	MODIFY TRAFFIC SIGNAL CONTROLLER AND CABINET	44
T13.1000	TRAFFIC DETECTORS-LOOP, STANDARD 19.6.0	44
T13.8210	ACCESSIBLE PEDESTRIAN DETECTOR - PUSHBUTTON WITH SIGN	45
T14.3513	1 WAY 3 SECTION MAST ARM MOUNTED SIGNAL HEAD 12 INCH	45
T14.9901	RETROFIT EXISTING PEDESTRIAN SIGNAL WITH COUNTDOWN TIMER	45
T14.9902	ONE-WAY BRACKET MOUNTED LED PEDESTRIAN SIGNAL WITH COUNTDOWN TIMER 12-INCH	45
T15.0100	DIRECTIONAL REGULATORY AND WARNING SIGNS	46
T20.0704	4 INCH WHITE WATERBORNE PAINT PAVEMENT MARKINGS	47
T20.0706	6 INCH WHITE WATERBORNE PAINT PAVEMENT MARKINGS	48
T20.0712	12 INCH WHITE WATERBORNE PAINT PAVEMENT MARKINGS	49
T20.0904	4 INCH YELLOW WATERBORNE PAINT PAVEMENT MARKINGS	50
T20.0906	6 INCH YELLOW WATERBORNE PAINT PAVEMENT MARKINGS	50
T20.0908	8 INCH YELLOW WATERBORNE PAINT PAVEMENT MARKINGS	51
T20.1401	WATERBORNE PAINT PAVEMENT MARKING SYMBOL - ARROW (STRAIGHT, LEFT, RIGHT OR COMBINED) STANDARD 20.1.0	51
T20.1410	WATERBORNE PAINT PAVEMENT MARKING WORD ("ONLY", "STOP", "YIELD", "AHEAD", "XING", "SCHOOL", OR OTHER) STANDARD 20.1.0	52
T20.1416	WATERBORNE PAINT PAVEMENT MARKING SYMBOL SET - BIKE LANE (HELMETED BICYCLIST AND ARROW)	53
T20.1417	WATERBORNE PAINT PAVEMENT MARKING SYMBOL SET - SHARED LANE MARKING FOR BICYCLES	53
T20.2404	4 INCH WHITE FINAL EPOXY RESIN PAVEMENT MARKINGS	54
T20.2406	6 INCH WHITE FINAL EPOXY RESIN PAVEMENT MARKINGS	54
T20.2412	12 INCH WHITE FINAL EPOXY RESIN PAVEMENT MARKINGS	55
T20.2804	4 INCH YELLOW FINAL EPOXY RESIN PAVEMENT MARKINGS	56
T20.2806	6 INCH YELLOW FINAL EPOXY RESIN PAVEMENT MARKINGS	57
T20.2808	8 INCH YELLOW FINAL EPOXY RESIN PAVEMENT MARKINGS	57
T20.3401	FINAL EPOXY RESIN PAVEMENT MARKING SYMBOL - ARROW (STRAIGHT, LEFT, RIGHT OR COMBINED) STANDARD 20.1.0	57
T20.3410	FINAL EPOXY RESIN PAVEMENT MARKING WORD ("ONLY", "STOP", "YIELD", "AHEAD", "XING", "SCHOOL", OR OTHER) STANDARD 20.1.0	58

Table of Contents - Distribution of Quantities

Project Name - Old Tower Hill Rd (Rt 108 - Rt 1)

Estimate Name - Addendum 1

R.I. Contract No. - 2019-CH-083

FAP Nos: STPG-HSIP(066), STP-RESF(401)

ItemCode	Description	Page
T20.3416	FINAL EPOXY RESIN PAVEMENT MARKING SYMBOL SET - BIKE LANE (HELMETED BICYCLIST AND ARROW)	59
T20.3417	FINAL EPOXY RESIN PAVEMENT MARKING SYMBOL SET - SHARED LANE MARKING FOR BICYCLES	59

Distribution of Quantities

Project Name - Old Tower Hill Rd (Rt 108 - Rt 1)

Estimate Name - Addendum 1

R.I. Contract No. - 2019-CH-083

FAP Nos: STPG-HSIP(066), STP-RESF(401)

Item No.	Item Code	Description	UM	Qty.	Pay Code	Seq. No.
037	708.9040 Cont.	77+89L - 79+06L		120.00	0006	01
		78+76R - 79+76R		100.00	0006	01
		79+08L - 80+16L		110.00	0006	01
		79+78R - 80+84R		110.00	0006	01
		80+17L - 81+68L		150.00	0006	01
		80+85R - 81+20R		40.00	0006	01
		81+21R - 81+53R		40.00	0006	01
		81+55R - 81+97R		45.00	0006	01
		81+70L - 82+95L		125.00	0006	01
		81+99R - 83+65R		170.00	0006	01
		82+86L - 94+51L		165.00	0006	01
		82+97L - 84+09L		115.00	0006	01
		83+67L - 85+58R		200.00	0006	01
		84+11L - 85+29L		120.00	0006	01
		85+31L - 86+92L		165.00	0006	01
		86+94L - 87+75L		85.00	0006	01
		87+77L - 88+95L		120.00	0006	01
		87+80R - 88+44R		65.00	0006	01
		88+47R - 89+28R		85.00	0006	01
		89+30R - 89+87R		60.00	0006	01
		89+31L - 90+20L		90.00	0006	01
		89+89R - 90+30R		45.00	0006	01
		90+20L - 90+21L		10.00	0006	01
		90+22L - 91+10L		90.00	0006	01
		90+32R - 90+91R		50.00	0006	01
		90+83R - 91+39R		60.00	0006	01
		91+12L - 91+13L		10.00	0006	01
		91+12L - 92+08L		100.00	0006	01
		91+57R - 92+30R		75.00	0006	01
		92+10L - 92+75L		65.00	0006	01
		92+32R - 93+80R		150.00	0006	01
		92+76L - 92+85L		30.00	0006	01
		92+76L - 93+18L		45.00	0006	01

Distribution of Quantities

Project Name - Old Tower Hill Rd (Rt 108 - Rt 1)

Estimate Name - Addendum 1

R.I. Contract No. - 2019-CH-083

FAP Nos: STPG-HSIP(066), STP-RESF(401)

<u>Item No.</u>	<u>Item Code</u>	<u>Description</u>	<u>UM</u>	<u>Qty.</u>	<u>Pay Code</u>	<u>Seq. No.</u>
037	708.9040	Cont. 93+20L - 94+04L		90.00	0006	01

Distribution of Quantities

Project Name - Old Tower Hill Rd (Rt 108 - Rt 1)

Estimate Name - Addendum 1

R.I. Contract No. - 2019-CH-083

FAP Nos: STPG-HSIP(066), STP-RESF(401)

Item No.	Item Code	Description	UM	Qty.	Pay Code	Seq. No.
037	708.9040 Cont.	94+06L - 95+90L		190.00	0006	01
		94+54L - 95+96L		145.00	0006	01
		95+89L - 96+36L		40.00	0006	01
		95+92L - 97+100L		110.00	0006	01
		SUPPL QTY		395.00	0006	01
Item 708.9040 Total:				4,360.00		
038	708.9041	CLEANING CATCH BASINS ALL TYPES AND SIZES OLD TOWER HILL ROAD	EACH			
		77+54R		1.00	0006	01
		77+87L		1.00	0006	01
		78+75R		1.00	0006	01
		79+07L		1.00	0006	01
		79+78R		1.00	0006	01
		80+17L		1.00	0006	01
		80+85R		1.00	0006	01
		81+21R		1.00	0006	01
		81+55R		1.00	0006	01
		81+88R		1.00	0006	01
		83+66R		1.00	0006	01
		85+59R		1.00	0006	01
		90+21L		1.00	0006	01
		91+14L		1.00	0006	01
		91+56R		1.00	0006	01
		92+32R		1.00	0006	01
		92+75L		1.00	0006	01
		92+85L		1.00	0006	01
		93+19L		1.00	0006	01
		93+81R		1.00	0006	01
		94+06L		1.00	0006	01
		94+52L		1.00	0006	01
		95+79L		1.00	0006	01