



State of Rhode Island
Department of Administration / Division of Purchases
One Capitol Hill, Providence, Rhode Island 02908-5855
Tel: (401) 574-8100 Fax: (401) 574-8387

ADDENDUM #3

RFQ# 7598728

TITLE: REGULAR CAB PLATFORM TRUCK

SUBMISSION DEADLINE: 05/10/2019 at 11:00 AM (REVISED)

The following items are included in this addendum:

1. Responses to submitted questions
2. Pre-bid sign-in sheet

A handwritten signature in cursive script that reads "Alyssa Ward".

Alyssa Ward
Buyer I

QUESTION:

Page 9 of 15 **Exterior Features:**

Our manufacture does not offer fender flares.

ANSWER:

The purpose of this specification is to have the entire outside surface of the front tire tread inside the outermost part of the fender or fender flare. Designs that provide this without the use of flares are acceptable.

QUESTION:

Page 3 of 15, **14 Ft. PLATFORM BODY**

A supplier asked about the 120"CA, 14" body and lift gate.

ANSWER:

RIDOT has a vehicle with this combination. Addendum #1 was issued to address this by offering an inspection of that vehicle.

QUESTION:

Page 3 of 15 **TOOL BOXES**

Can you provide any more details on the tool boxes and water tank?

ANSWER:

Below is a sketch of the proposed layout of the tool boxes with the water tank installed on top of the cross-bed box. Final placement of these components shall be discussed and approved by RIDOT Motor Pool at a prebuild meeting once all the components are received by to upfitter.

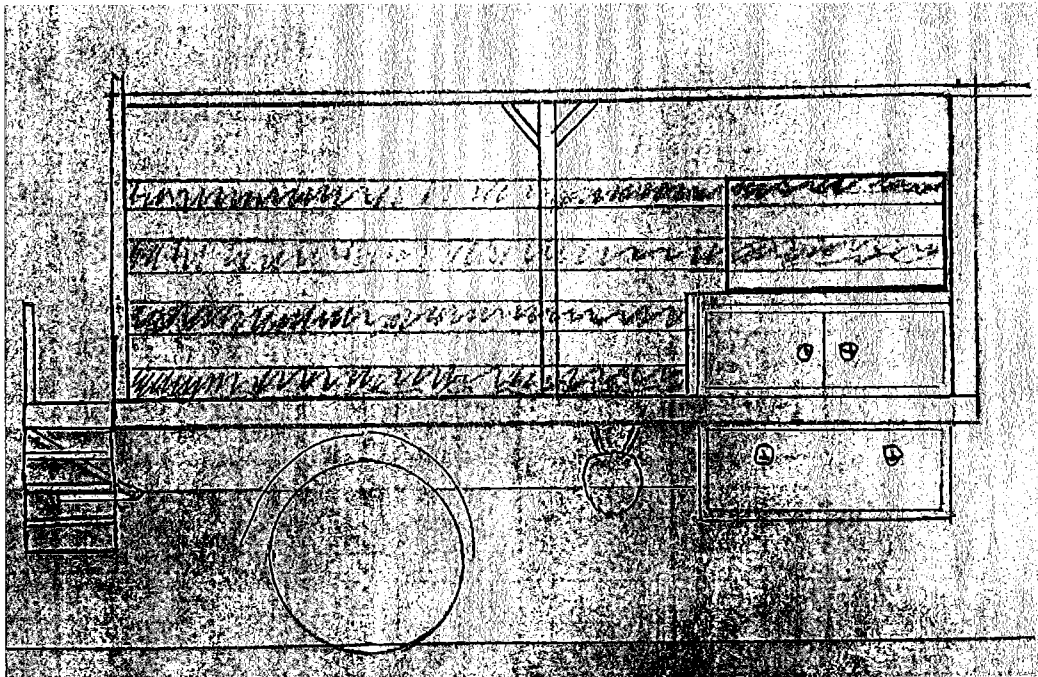

QUESTION:Page 9 of 15 **CONSOLE:**

Can you clarify the Console?

ANSWER:

The following console shall be supplied.

Supply a Havis Products center console, compatible with the chassis purchased shall be configured as follows:

30" Enclosed 10" high console - HAVIS C-3010
 Tunnel Mount Assembly - HAVIS C-TMW (Chassis specific)
 Equipment Mounting Bracket - HAVIS C-EB25-WTA-1P
 Equipment Mounting Bracket, 2.5" Mounting Space - HAVIS C-EB25-XTL-1P
 2 Lighter Plug Outlets - HAVIS C-LP-2
 Mounting component - HAVIS C-AP-0645
 Internal Cup Holders - HAVIS C-CUP2-I
 Armrest for Top Mount, Console, Large Pad - HAVIS C-ARM-103
 All required blank panels to fill console opening

All switches shall be appropriately identified as to function. All console wiring shall allow for the components to be reposition within the console for user preference.

QUESTION:Page 7 of 15 **ADDITIONAL EQUIPMENT:**

Is there a contact or vendor for the Motorola APX 1500 radio?

ANSWER:

The bidder may use any vendor or supplier that can furnish and install the Motorola APX 1500 radio listed in the specifications. Below is one contact for a supplier and installer of the radio:

<u>Supplier</u>	<u>Installer</u>
John Giacomini	CyberComm Inc.
Motorola Solutions, Inc.	90 Colorado Avenue
34 Pine Crest Drive	Warwick, Rhode Island 02888
Riverside, RI 02915	Phone: 401-738-1470
Phone (401) 433-5311	
Mobile (401) 447-4405	

QUESTION:

Please let me know if Hartford Truck in Conn is one of your vendors to build your specification for this project?

ANSWER:

Hartford Truck was the upfitter for a similar truck that we have in our fleet.

QUESTION:

The delivery time in the specification is not long enough given the present conditions with the chassis manufacturers.

ANSWER:

Page 10 of 15 TRUCK DELIVERY SCHEDULE:

Remove: "Fabrication of the unit shall be completed within one hundred twenty (120) days of the successful proposal."

Replace: "Fabrication of the unit shall be completed within two hundred and ten (210) days of the successful proposal."

QUESTION:

Can the racks be painted instead of galvanized?

ANSWER:

Page 3 of 15 14 Ft. PLATFORM BODY

Add: Racks shall be powder coated for enhanced durability and visibility (Black)

Reminders:

Page 2 of 15 GENERAL Note: It is expected that chassis providers and respective up-fitting/body builders communicate and understand the coordination that is required for this build.

Page 2 of 15 GENERAL Note: Any manufacture's deviation from the specification, no matter how minor, shall be noted on a separate sheet and be referenced to the section. The deviation shall be explained in detail and identified as an Exception, Clarification or Enhancement.

Page 11 of 15 CONCLUDING STATEMENTS: Note: All bid packages shall be submitted in duplicate including all cover sheets, responses and supporting documentation .



"NON-MANDATORY" PRE-BID CONFERENCE SIGN IN SHEET

42

BID NUMBER: 7598728
 BID TITLE: REGULAR CAB PLATFORM TRUCK
 PRE-BID DATE AND TIME: APRIL 18TH 2019 AT 1:30PM

Purchasing Representative
 ALYSSA WARD
 NON-Mandatory Pre-bid START TIME
 1:35 pm
 NON-Mandatory Pre-bid END TIME
 1:45 pm

COMPANY NAME	COMPANY REPRESENTATIVE	SIGNATURE	ADDRESS	CONTACT EMAIL	CONTACT PHONE NUMBER
1 Central Delivery RIDOT	Robert M. Roberts		1411 New State Hwy 360 Lincoln Ave	rmaduro@centralris	783-971-3959
2 Desena Truck	Loa Farley		9 BUSINESS PARK Columbia CT	LFarley@desena.com clark.stevens@hpfairfield.com	401-447-8655 860-538-5113
3 HP Fairfield	Clark Stevens				
4 Liberty Chour	Kevin Nugent		40 Bay State Rd WATERVILLE MA 150 CANTON RD WVA RD	libertychour@libertychour.com Ted.Gilman@libertychour.com	781-227-2291 401-784-3360
5 CONTRACT INT	Ted Gilman				
6 RBG INC	Rick Girard		317 Raymond Rd Raymond RI	rgirard@raymond-pump.com dave@rbginc.com	401-573-8756
7 RBG TR	Dave Girard				
8 RIDOT	Alex Pateco		300 Lincoln Ave	Alex.Pateco@dot.ri.gov	781-4872
9					
10					
11					
12					
13					
14					
15					