

REQUEST FOR QUOTE (RFQ) – BID# 7565516

2017-CB-070 REPLACEMENT OF HORTON FARM BRIDGE NO. 472

SUBMISSION DEADLINE: Friday, October 27, 2017 at 03:00 PM (ET)

PRE-BID CONFERENCE:



NO



YES

Mandatory:



NO



YES:

Any vendor who intends to submit a bid proposal in response to this solicitation must have its designated representative attend the mandatory pre-bid conference. The representative must register at the pre-bid conference and disclose the identity of the vendor whom he/she represents. Because attendance at the pre-bid conference is mandatory, a vendor's failure to attend and register at the pre-bid conference shall result in disqualification of the vendor's bid proposal as non-responsive to the solicitation.

Buyer Name: Lisa Hill

Title: Chief Buyer

**QUESTIONS** Prospective bidders are hereby notified that all questions pertaining to this contract must be submitted to the Department of Transportation in writing through its website at <http://www.dot.ri.gov/contracting/bids> by accessing the questions & answers menu located within the 'contracting', then 'bidding opportunities' link. Response to the submitted questions will also be posted under this link, phone calls will not be accepted.

SURETY REQUIRED: YES

BOND REQUIRED: YES

DISK BASED BID: ☐ NO



YES: See attached Disk Based Bidding Information

**NOTE TO VENDORS:**

Vendors must register on-line at the Rhode Island Division of Purchases website at [www.purchasing.ri.gov](http://www.purchasing.ri.gov). Offers received without the completed four-page Rhode Island Vendor Information Program (RIVIP) Generated Bidder Certification Cover Form attached may result in disqualification.

**THIS IS NOT A BIDDER CERTIFICATION FORM**



State of Rhode Island Department of Administration  
Division of Purchases

**RHODE ISLAND DEPARTMENT OF TRANSPORTATION**

**REVISED**  
**November 20, 2013**

**NOTICE TO VENDORS**

Each bid proposal for a *public works project* must include a "public copy" to be available for public inspection upon the opening of bids. **Bid proposals that do not include a copy for public inspection will be deemed nonresponsive.**

To comply with this requirement, *in addition to* the Quest Lite compatible electronic copy and one hard copy, bid proposals for *highway and bridge public works projects* must also include a duplicate original of the Quest Lite compatible electronic copy on a *read-only* CD-R media disc as the "public copy."

The public copy disc must be separately enclosed in a protective cover clearly marked "Public Copy" and include the following information (all available from the Bidder Certification Cover Form): (1) title of solicitation; (2) name of bidder and RIVIP vendor ID number; (3) bid number; and (4) date of bid.

The public copy may redact any trade secrets or commercial or financial information which is of a privileged or confidential nature pursuant to the "Access to Public Records Act," R. I. Gen. Laws §§ 38-2-1 *et seq.*

For further information on how to comply with this statutory requirement, see R. I. Gen. Laws §§ 37-2-18(b) and (j). Also see Procurement Regulations 5.11, 5.13, and 12.102.05 accessible at [www.purchasing.ri.gov](http://www.purchasing.ri.gov).

**State of Rhode Island and Providence Plantations  
Department of Transportation**

**Notice to Contractors  
Special Provisions  
Proposal  
Contract Agreement  
Contract Bond**

**for the Performance of**

**Rhode Island Contract Number: 2017-CB-070**

**Rhode Island Federal-Aid\State-Aid Project Numbers:                      BRO-472(001), STP-RESF(360)**

**Project:     Horton Farm Bridge No. 472**

**Limits:     Horton Farm Road Bridge No. 472.**

**City/Town: East Providence**

**County:     PROVIDENCE**

**Submitted By:** \_\_\_\_\_  
**Address:** \_\_\_\_\_  
\_\_\_\_\_  
\_\_\_\_\_  
**Name of Surety:** \_\_\_\_\_  
**Total Bid:** \_\_\_\_\_

**(BIDDER MUST FILL IN ALL ABOVE SPACES)**

The basis of award of the Contract will be the total bid for all quantities of work in the proposal subject to review and correction as provided for in the Rhode Island Department of Transportation Standard Specifications for Road and Bridge Construction and Standard Details.

NOTE: The State of Rhode Island Standard Specifications for Road and Bridge Construction and Standard Details consists of the following:

- The Rhode Island Standard Specifications for Road and Bridge Construction, Amended December 2010, with all revisions.
- The Rhode Island Standard Details, 1998 Edition, with all revisions.
- The Rhode Island Bridge Standard Details, 2010 Edition, with all revisions.
- The Division of Purchases Procurement Regulations Adopted December 2010.

**\* Refer to Section 12.102.05 PREPARATION OF PROPOSAL of the STATE OF RHODE ISLAND PROCUREMENT REGULATIONS regarding the use of Quest Lite software for bid preparation.**

The above documents may be obtained at the Rhode Island Department of Transportation, Contracts and Specifications Office, upon request.

**STATE OF RHODE ISLAND AND PROVIDENCE PLANTATIONS  
DEPARTMENT OF ADMINISTRATION - DIVISION OF PURCHASES**

**NOTICE TO HIGHWAY AND BRIDGE CONTRACTORS**

Sealed Proposals addressed to the State Purchasing Agent, Rhode Island Department of Administration, Division of Purchases, One Capitol Hill, Providence, Rhode Island 02903, will be opened and read in public on October 27, 2017 at 3:00PM. All bidders MUST register online at [www.purchasing.ri.gov](http://www.purchasing.ri.gov). A Bidder Certification Cover Sheet MUST accompany each bid. Bid item description and quantities estimated for this project will also be available online. Should you need assistance in registering or downloading a bid, call (401) 222-3766. Failure to comply will result in mandatory disqualification per Item 4 of Section 12.102.12 of the Division of Purchases Procurement Regulations Adopted December 2010 and RI General Law 37-2-17 which references the RI Vendor Information Program (RIVIP).

**DESCRIPTION: Accelerated Bridge Construction (ABC) of Bridge No. 472 Horton Farm Road.**

**The Contractor will be required, in accordance with the provisions of the Disadvantaged Business Enterprise Affirmative Action Certification for Contractors and Consultants, to meet the established Race-Conscious Goal, or Contract Goal, of not less than 10.00 percent of the contract bid price, to the Contractors, Subcontractors, and/or suppliers which qualify as Disadvantaged Business Enterprises (DBE's). Failure by the Contractor to demonstrate every good faith effort in fulfilling its DBE commitment during the construction period will result in the reduction in contract payments by the amount determined by multiplying the awarded contract value by the established DBE percentage, and subtracting the dollar value of the work actually performed by DBE contractors. This action will not preclude RIDOT from imposing sanctions or other remedies available as specified in paragraph (D)(C) of the Disadvantaged Business Enterprise Affirmative Action Certification for Contractors and Consultants.**

Computer Disks for competitive bidding for the above described work will be furnished by the Department of Transportation, Division of Administrative Services, Contracts & Specifications Office, Room 108, Two Capitol Hill, Providence, Rhode Island, 02903, Tel. Number (401) 222-2495. The Plans, Specifications and Special Provisions may also be examined on or after September 29, 2017 every weekday except holidays between the hours of 8:00 AM and 4:00 PM.

**The Bid Package consists of a single compact disk (CD) containing the following items: Construction Plans, Standard Specifications for Road and Bridge Construction, Compilations of Approved Specifications, Required Contract Provisions for Federal-Aid Construction Contracts, RI Division of Purchases Procurement Regulations, General Provisions, Rhode Island Standard Details, Rhode Island Bridge Standard Details, Federal Wage Rates, Contract-Specific General Provisions, Job-Specific Specifications, Distribution of Quantities, Appendices (if applicable), Quest Lite bid file, Quest Lite installation software and a Quest Lite User Manual. Only complete bid packages will be issued.**

**Prospective Bidders are hereby notified that all questions pertaining to this Contract must be submitted to the Department of Transportation in writing through its website at <http://www.dot.ri.gov/contracting/bids/> by accessing the Questions & Answers Menu located within the "Contracting", then "Contract Opportunities" link. Responses to the submitted questions will also be posted under this link. PHONE CALLS WILL NOT BE ACCEPTED.**

**For help with RIDOT's Quest Lite bid preparation software, please contact the Contracts & Specifications Office, Room 108, Two Capitol Hill, Providence, Rhode Island, 02903, Tel. Number (401)-222-2495 or e-mail [Quest@dot.ri.gov](mailto:Quest@dot.ri.gov).**

Please also note that all Bidding Documents required to be submitted and in fact submitted to the Purchasing Agent as part of a bid will be considered returned to the State and need not be returned to RIDOT.

A bid bond payable to the State of Rhode Island, in the amount of 5% of the total or gross sum of the bid must be furnished by each bidder. The Proposal Guaranty will be furnished by surety companies authorized/licensed to do business in the State of Rhode Island. The State reserves the right to retain the surety of all bidders until the successful bidder enters into the Contract or until such time as the award or cancellation of the Contract is announced at which point Sureties will be returned to all bidders by the State of Rhode Island. A performance bond of one hundred (100) percent of the contract price with a satisfactory surety company will be required of the successful bidder. All surety companies must be listed with The Department of the Treasury, Fiscal Services, Circular 570, (Latest Revision published by the Federal Register). The Department of Transportation reserves the right to reject any or all bids.

Required Contract Provisions - The attention of prospective bidders is called to the fact that this project is to be bid upon and the contract executed subject to all applicable federal laws and regulations for carrying out the provisions of the Federal-Aid Highway program..

Wages of labor on Federal -Aid Highway Projects - the prevailing rate of wages for laborers and mechanics employed by contractors or subcontractors on the initial construction of highway projects on the Federal - Aid Highway System, authorized under the Federal Highway Act of 1968, shall be paid wages at rates not less than those prevailing on the same type of work on similar construction in the immediate locality as determined by the United States Secretary of Labor, in accordance with the Act of August 30, 1935, known as the Davis - Bacon Act, under Decision Nos. 1 through 6 as applicable.

Prevailing wage rates and Davis - Bacon Wage Determination Reference Materials are available online at [www.purchasing.ri.gov](http://www.purchasing.ri.gov). It is advisable to print only the pages applicable to this bid; the rates active on the Rhode Island Vendor Information Program's bid solicitation date for this project are applicable for the duration of the contract resulting from this bid.

Work Hours Act of 1962 - This contract is subject to Work Hours Act of 1962, Public Law 87-581 and implementing regulations.

There will be no Pre-Bid Conference scheduled for this project.

## **SPECIAL NOTE**

ANY REFERENCE TO THE RHODE ISLAND DEPARTMENT OF PUBLIC WORKS OR THE DIRECTOR OF PUBLIC WORKS SHOULD BE REVISED TO THE RHODE ISLAND DEPARTMENT OF TRANSPORTATION AND THE DIRECTOR OF TRANSPORTATION RESPECTIVELY.

## **NOTICE TO ALL BIDDERS**

The Rhode Island Department of Transportation, in accordance with Title VI of the Civil Rights Act of 1964, 42 U.S.C. §§ 2000d - 2000d-4 and 49 C.F.R. Part 21, Nondiscrimination in Federally-Assisted Programs of the Department of Transportation - Effectuation of Title VI of the Civil Rights Act of 1964, issued pursuant to such Act, hereby notifies all bidders that it will affirmatively insure that in any contract entered into pursuant to this advertisement, Disadvantaged Business Enterprises will be afforded full opportunity to submit bids in response to this invitation and will not be discriminated against on the grounds of race, color, sex, national origin, age, or disability in consideration for an award.

To report bid rigging activities call: **1-800-424-9071**

The U.S. Department of Transportation (DOT) operates the above toll-free hotline Monday through Friday, 8:00 a.m. to 5:00 p.m. eastern time. Anyone with knowledge of possible bid rigging, bidder collusion, or other fraudulent activities should use the hotline to report such activities.

The hotline is part of the DOT's continuing effort to identify, and investigate highway construction contract fraud and abuse and is operated under the direction of the DOT Inspector General. All information will be treated confidentially and caller anonymity will be respected.

**Item List**

Date: 9/22/2017

Estimate Name - PS&E  
 Project Name - Horton Farm Bridge No. 472  
 R.I. Contract No. - 2017-CB-070  
 FAP Nos. - BRO-472(001), STP-RESF(360)

Seq No.	Item Code	Description	Quantity UM
001	201.0301	CUTTING AND DISPOSING ISOLATED TREES AND STUMPS (4"- 24")	1.00 EACH
002	201.0302	CUTTING AND DISPOSING ISOLATED TREES AND STUMPS (24" OR PLUS)	1.00 EACH
003	201.0401	REMOVE AND DISPOSE GRANITE CURB	800.00 LF
004	201.0408	REMOVE AND DISPOSE RIGID PAVEMENT	150.00 SY
005	201.0409	REMOVE AND DISPOSE FLEXIBLE PAVEMENT	8,450.00 SY
006	201.0414	REMOVE AND DISPOSE PIPE - ALL SIZES	80.00 LF
007	201.0415	REMOVE AND DISPOSE GUARDRAIL AND POST ALL TYPES	4,800.00 LF
008	201.0419	REMOVE AND DISPOSE FENCE	50.00 LF
009	201.0420	REMOVE AND DISPOSE CONCRETE SLAB	100.00 SY
010	201.0421	REMOVE AND DISPOSE BITUMINOUS CURB	7,350.00 LF
011	201.0425	REMOVE AND DISPOSE FLARED END SECTION	1.00 EACH
012	201.0430	REMOVE AND DISPOSE CONCRETE MEDIAN BARRIER	5,300.00 LF
013	201.0432	REMOVE AND DISPOSE HEADWALL	3.00 EACH
014	201.0601	REMOVE AND DISPOSE GROUND MOUNTED SIGNS	7.00 EACH
015	201.0604	REMOVE AND DISPOSE GROUND MOUNTED SIGN POSTS	6.00 EACH
016	201.0605	REMOVE AND DISPOSE GROUND MOUNTED SIGN BASES	7.00 EACH
017	201.0610	REMOVE AND DISPOSE DIRECTIONAL, WARNING, REGULATORY, SERVICE, AND STREET SIGNS	65.00 EACH
018	201.0613	REMOVE AND STOCKPILE LIGHT STANDARDS	61.00 EACH
019	201.0616	REMOVE AND DISPOSE LIGHT STANDARD FOUNDATIONS	53.00 EACH
020	201.0622	REMOVE AND DISPOSE OVERHEAD SIGN PANEL	1.00 EACH
021	201.0623	REMOVE AND DISPOSE OVERHEAD SIGN STRUCTURE	1.00 EACH
022	201.9901	REMOVE AND DISPOSE HANDHOLE AND RETURN FRAME AND COVER TO RIDOT	56.00 EACH
023	202.0100	EARTH EXCAVATION	1,500.00 CY
024	202.0600	LOAM EXCAVATION	150.00 CY
025	202.0800	GRAVEL BORROW	190.00 CY
026	203.0100	STRUCTURAL EXCAVATION EARTH	2,680.00 CY
027	203.0700	PERVIOUS FILL	10.00 CY
028	203.9901	CRUSHED STONE FILL ADJACENT TO STRUCTURES	73.00 CY
029	203.9902	REINFORCED CRUSHED STONE ADJACENT TO STRUCTURES	2,618.00 CY
030	204.0100	TRIMMING AND FINE GRADING	8,800.00 SY
031	205.0240	TRENCH ROCK EXCAVATION (0-7')	5,400.00 CY
032	206.0201	BALED HAY EROSION CHECK STANDARD 9.1.0	4,000.00 LF

**Item List**

Date: 9/22/2017

Estimate Name - PS&E  
 Project Name - Horton Farm Bridge No. 472  
 R.I. Contract No. - 2017-CB-070  
 FAP Nos. - BRO-472(001), STP-RESF(360)

Seq No.	Item Code	Description	Quantity UM
033	206.0208	REMOVAL OF BALED HAY EROSION CHECKS	5,050.00 LF
034	206.0230	BALED HAY EROSION CHECK AND SILT FENCE COMBINED STANDARD 9.3.0	550.00 LF
035	206.9901	CATCH BASIN INLET PROTECTION	20.00 EACH
036	207.0202	BALED HAY DITCH EROSION CHECK STANDARD 9.4.0	500.00 LF
037	212.2000	CLEANING AND MAINTENANCE OF EROSION CONTROLS	1.00 LS
038	213.0100	PLACEMENT OF MILLINGS BENEATH GUARDRAIL	5,100.00 LF
039	302.0100	GRAVEL BORROW SUBBASE COURSE	4,000.00 CY
040	401.9901	CLASS 19	3,295.00 TON
041	401.9902	MODIFIED CLASS 12.5	16,025.00 TON
042	403.0300	ASPHALT EMULSION TACK COAT	133,000.00 SY
043	410.1000	TEMPORARY PATCHING MATERIAL/TRENCHES	35.00 TON
044	601.0200	CLASS XX PORTLAND CEMENT CONCRETE	1,100.00 CY
045	701.7712	12 INCH REINFORCED CONCRETE PIPE END SECTION STANDARD 2.3.0	1.00 EACH
046	702.0517	FRAME AND GRATE, STANDARD 6.3.2	26.00 EACH
047	702.0522	FRAME AND COVER STANDARD 6.2.1	7.00 EACH
048	702.0630	PRECAST MANHOLE 4' DIAMETER STANDARD 4.2.0	1.00 EACH
049	703.0008	8" PERFORATED CONCRETE PIPE M175 WITH FILTER MATERIAL STANDARD 1.1.0	130.00 LF
050	704.9901	REPAIR CATCH BASIN - RPC	48.00 EACH
051	704.9902	REPAIR CATCH BASIN W/ GUTTER INLET - RCI	7.00 EACH
052	704.9903	REPAIR DOUBLE GRATE CATCH BASIN - RDC	20.00 EACH
053	704.9904	RECONSTRUCT DROP INLET - RPD	2.00 EACH
054	704.9905	RECONSTRUCT MANHOLE - RMH	17.00 EACH
055	707.0900	ADJUST MANHOLES TO GRADE	1.00 EACH
056	707.1900	ADJUST FRAME & COVER TO GRADE	18.00 EACH
057	707.2000	ADJUST FRAME AND GRATE TO GRADE	78.00 EACH
058	708.9040	CLEANING AND FLUSHING PIPE ALL SIZES	13,500.00 LF
059	708.9041	CLEANING CATCH BASINS ALL TYPES AND SIZES	129.00 EACH
060	708.9042	CLEANING MANHOLES ALL TYPES AND SIZES	27.00 EACH
061	708.9901	CLEAN AND REGRADE JUTE MESH DITCH	1,230.00 LF
062	708.9902	CLEAN AND REGRADE DITCH	230.00 LF
063	708.9905	CLEAN AND REGRADE RIP RAP DITCH	50.00 LF
064	709.0100	CONCRETE CONNECTING COLLAR STANDARD 1.3.0	2.00 CY



## Item List

Date: 9/22/2017

Estimate Name - PS&E  
 Project Name - Horton Farm Bridge No. 472  
 R.I. Contract No. - 2017-CB-070  
 FAP Nos. - BRO-472(001), STP-RESF(360)

Seq No.	Item Code	Description	Quantity UM
065	709.0200	CONCRETE HEADWALLS FOR PIPE CULVERTS STANDARD 2.1.0	5.00 CY
066	711.0110	3" PAVED WATERWAY CLASS I-1 STANDARD 8.4.0	170.00 SY
067	800.9920	HORTON FARM ROAD BRIDGE NO. 472 SUPERSTRUCTURE	1.00 LS
068	800.9940	HORTON FARM ROAD BRIDGE NO. 472 SUBSTRUCTURE	1.00 LS
069	803.9902	REMOVE AND DISPOSE EXISTING BRIDGE SUPERSTRUCTURE HORTON FARM ROAD BRIDGE NO. 472	1.00 LS
070	803.9904	REMOVE AND DISPOSE EXISTING BRIDGE SUBSTRUCTURE HORTON FARM ROAD BRIDGE NO. 472	1.00 LS
071	805.9920	HORTON FARM ROAD BRIDGE NO. 472 TEMPORARY EARTH RETAINING SYSTEMS	1.00 LS
072	817.2110	REPAIRS TO STRUCTURAL CONCRETE MASONRY (PATCHING MORTAR)	120.00 CF
073	819.0800	DRILL AND GROUT REINFORCING DOWELS	842.00 EACH
074	820.0110	CONCRETE SURFACE TREATMENT (PROTECTIVE COATING)	32,000.00 SF
075	836.9901	HORTON FARM ROAD BRIDGE NO. 472 STRUCTURAL CONCRETE CRACK REPAIR	88.00 LF
076	901.0101	GUARDRAIL STEEL BEAM SINGLE FACE EARTH AND ASPHALT	5,100.00 LF
077	901.0151	TERMINAL END SECTION SINGLE FACE STANDARD 34.3.2	5.00 EACH
078	901.0190	GUARDRAIL STEEL BEAM ANCHORAGE APPROACH SECTION STANDARDS 34.3.1 AND 34.3.3	2.00 EACH
079	901.0191	GUARDRAIL STEEL BEAM ANCHORAGE TRAILING END SECTION STANDARD 34.3.4	5.00 EACH
080	901.0194	GUARDRAIL CONNECTION TO BARRIER - APPROACH END SECTION - STD. 34.3.7	3.00 EACH
081	901.0195	GUARDRAIL CONNECTION TO BARRIER - TRAILING END SECTION - STD. 34.3.8	3.00 EACH
082	901.9901	GUARDRAIL INSTALLATION AT STRUCTURES STANDARD 34.1.1	50.00 LF
083	903.0206	CHAIN LINK FENCE 6' STD 31.2.0	25.00 LF
084	905.0110	PORTLAND CEMENT SIDEWALK MONOLITHIC STANDARD 43.1.0	35.00 CY
085	905.0140	BITUMINOUS SIDEWALK STANDARD 43.2.0	15.00 TON
086	906.0110	GRANITE CURB, QUARRY SPLIT STRAIGHT, STANDARD 7.3.0	1,650.00 LF
087	906.0111	GRANITE CURB, QUARRY SPLIT CIRCULAR, STANDARD 7.3.0	120.00 LF
088	906.0116	GRANITE CURB, QUARRY SPLIT 2 FOOT CORNERS, STANDARD 7.3.4	1.00 EACH
089	906.0117	GRANITE CURB - QUARRY SPLIT 3 FOOT CORNERS	1.00 EACH
090	906.0120	GRANITE WHEELCHAIR RAMP CURB STANDARDS 7.3.3, 43.3.0 AND 43.3.1	25.00 EACH
091	906.0602	BITUMINOUS BERM STANDARD 7.5.1	7,350.00 LF
092	906.0700	REMOVE, HANDLE, HAUL TRIM RESET CURB EDGING, STRAIGHT, CIRCULAR ALL TYPES	2,670.00 LF

## Item List

Date: 9/22/2017

Estimate Name - PS&E  
 Project Name - Horton Farm Bridge No. 472  
 R.I. Contract No. - 2017-CB-070  
 FAP Nos. - BRO-472(001), STP-RESF(360)

Seq No.	Item Code	Description	Quantity UM
093	906.9901	GRANITE RAMP STONE - STANDARD 7.3.9	15.00 EACH
094	907.0100	WATER FOR DUST CONTROL	10.00 MGA L
095	909.3010	PRECAST MEDIAN BARRIER DOUBLE-FACED STANDARD 40.1.0	4,050.00 LF
096	909.3021	PRECAST MEDIAN BARRIER SINGLE-FACED STANDARD 40.2.1	1,200.00 LF
097	909.3030	PRECAST MEDIAN BARRIER TRANSITION STANDARD 40.3.0	3.00 EACH
098	910.9901	RUMBLE STRIP	37,400.00 LF
099	916.0700	GUARDRAIL ENERGY ABSORBING TERMINAL IMPACT ATTENUATOR	2.00 EACH
100	919.0101	TEST PITS	10.00 EACH
101	922.0100	TEMPORARY CONSTRUCTION SIGNS STANDARD 29.1.0 AND 27.1.1	2,340.00 SF
102	923.0105	DRUM BARRICADE STANDARD 26.2.0	22,000.00 BDAY
103	923.0125	PLASTIC PIPE TYPE III BARRICADE STANDARD 26.3.1	5.00 EACH
104	923.0200	FLUORESCENT TRAFFIC CONES STANDARD 26.1.0	350.00 EACH
105	924.0113	ADVANCE WARNING ARROW PANEL	170.00 PDAY
106	925.0112	PORTABLE CHANGEABLE MESSAGE SIGN	80.00 PDAY
107	926.0120	ANCHORED PRECAST CONCRETE BARRIER FOR TEMPORARY TRAFFIC CONTROL	1,854.00 LF
108	926.0121	UNANCHORED PRECAST CONCRETE BARRIER FOR TEMPORARY TRAFFIC CONTROL STANDARD 40.5.0	3,600.00 LF
109	926.0140	REFLECTIVE DELINEATORS FOR TEMPORARY CONCRETE BARRIERS	220.00 EACH
110	926.9901	TEMPORARY IMPACT ATTENUATOR	2.00 EACH
111	926.9902	REMOVE AND RESET TEMPORARY IMPACT ATTENUATOR	31.00 EACH
112	926.9903	RELOCATE PRECAST MEDIAN BARRIER FOR TEMPORARY TRAFFIC CONTROL	68,800.00 LF
113	928.9901	TRUCK MOUNTED ATTENUATOR WITH TRUCK MOUNTED FLASHING ARROW BOARD	1,900.00 HRS
114	929.0110	FIELD OFFICE	12.00 PMO
115	931.0110	CLEANING AND SWEEPING PAVEMENT	1,400.00 HSY
116	932.0200	FULL-DEPTH SAWCUT OF BITUMINOUS PAVEMENT	18,300.00 LF
117	932.0230	FULL DEPTH SAWCUT OF PORTLAND CEMENT CONCRETE SIDEWALK/DRIVEWAY	100.00 LF
118	935.0400	REMOVING BITUMINOUS PAVEMENT BY MICRO MILLING	128,500.00 SY
119	936.0110	MOBILIZATION	1.00 LS
120	937.0200	MAINTENANCE AND MOVEMENT TRAFFIC PROTECTION	1.00 LS
121	942.0200	DETECTABLE WARNING PANEL STANDARD 48.1.0	120.00 SF

**Item List**

Date: 9/22/2017

Estimate Name - PS&E  
 Project Name - Horton Farm Bridge No. 472  
 R.I. Contract No. - 2017-CB-070  
 FAP Nos. - BRO-472(001), STP-RESF(360)

Seq No.	Item Code	Description	Quantity UM
122	943.0200	TRAINEE MAN-HOURS	4,000.00 MHRS
123	L01.0104	PLANTABLE SOIL 4 INCHES DEEP	260.00 SY
124	L02.0101	GENERAL HIGHWAY SEEDING (TYPE 1)	1,050.00 SY
125	L02.9901	GRASS MOWING	3.00 EACH
126	L11.0102	TREE PLANT PROTECTION DEVICE STANDARD 51.1.0	5.00 EACH
127	L11.0104	DRIP-LINE TREE PROTECTION DEVICE STANDARD 51.1.1	1,900.00 LF
128	T04.7500	SPLICE KIT	89.00 EACH
129	T04.9901	2 AWG MULTIPLE LIGHTING CABLE	55,771.00 LF
130	T04.9902	6 AWG MULTIPLE LIGHTING CABLE	2,188.00 LF
131	T04.9903	6 AWG GROUND WIRE	18,795.00 LF
132	T05.0100	PRECAST TYPE A HANDHOLE STANDARD 18.2.0	83.00 EACH
133	T05.0300	PRECAST TYPE B HEAVY DUTY HANDHOLE STANDARD 18.2.2	18.00 EACH
134	T05.0320	PULL BOX ON STRUCTURE TYPE V STANDARD 18.6.3	4.00 EACH
135	T06.1020	2 IN. RIGID STEEL CONDUIT - UNDERGROUND	300.00 LF
136	T06.1030	3 IN. RIGID STEEL CONDUIT-UNDERGROUND	380.00 LF
137	T06.4030	3 IN. RIGID STEEL CONDUIT IN STRUCTURE	1,260.00 LF
138	T06.5130	3 INCH SCHEDULE 40 POLYVINYL CHLORIDE PLASTIC CONDUIT - UNDERGROUND	18,700.00 LF
139	T06.5140	4 INCH SCHEDULE 40 POLYVINYL CHLORIDE PLASTIC CONDUIT - UNDERGROUND	8,200.00 LF
140	T06.5230	3 INCH SCHEDULE 80 POLYVINYL CHLORIDE PLASTIC CONDUIT - UNDERGROUND	1,100.00 LF
141	T06.5240	4 INCH SCHEDULE 80 POLYVINYL CHLORIDE PLASTIC CONDUIT - UNDERGROUND	950.00 LF
142	T07.1250	FURNISH AND INSTALL 250 WATT HIGH PRESSURE SODIUM LUMINAIRE	34.00 EACH
143	T07.1400	FURNISH AND INSTALL 400 WATT HIGH PRESSURE SODIUM LUMINAIRE	47.00 EACH
144	T08.0100	LIGHT STANDARD FOUNDATION WITH ANCHOR BOLTS STANDARD 18.1.0	82.00 EACH
145	T08.2031	ALUMINUM LIGHTING STD. 30 FT. W/ SINGLE DAVIT ARM EXTN. 10 FT. STANDARD 18.3.0	34.00 EACH
146	T08.2041	ALUMINUM LIGHTING STD. 40 FT. W/ SINGLE DAVIT ARM EXTN. 10 FT. STANDARD 18.3.0	47.00 EACH
147	T09.1000	SERVICE PEDESTAL STANDARD 18.4.0	2.00 EACH
148	T12.9901	MOBILE CAMERA SURVEILLANCE SYSTEM	1.00 EACH
149	T15.0100	DIRECTIONAL REGULATORY AND WARNING SIGNS	710.00 SF

## Item List

Date: 9/22/2017

Estimate Name - PS&E  
 Project Name - Horton Farm Bridge No. 472  
 R.I. Contract No. - 2017-CB-070  
 FAP Nos. - BRO-472(001), STP-RESF(360)

Seq No.	Item Code	Description	Quantity	UM
150	T15.0200	REMOVE AND RELOCATE DIRECTIONAL REGULATORY AND WARNING SIGN	2.00	EACH
151	T15.2000	PARKING SIGNS	8.00	SF
152	T16.0100	GROUND MOUNTED PRIMARY DIRECTIONAL SIGN PANELS EXTRUDED ALUMINUM	700.00	SF
153	T16.0300	GROUND MOUNTED PRIMARY DIRECTIONAL SIGN POST-STEEL BREAKAWAY	22.00	EACH
154	T17.0100	OVERHEAD SIGN PANELS	170.00	SF
155	T17.0203	OVERHEAD SIGN STRUCTURE 26-30 FOOT CANTILEVER - STEEL	1.00	EACH
156	T20.0006	6 INCH WHITE FAST - DRYING WATERBORNE PAVEMENT MARKING PAINT	282,400.00	LF
157	T20.0008	8 INCH WHITE FAST - DRYING WATERBORNE PAVEMENT MARKING PAINT	250.00	LF
158	T20.0012	12 INCH WHITE FAST - DRYING WATERBORNE PAVEMENT MARKING PAINT	18,280.00	LF
159	T20.0106	6 INCH YELLOW FAST - DRYING WATERBORNE PAVEMENT MARKING PAINT	178,190.00	LF
160	T20.0820	FAST DRYING WATERBORNE PAVEMENT ARROW - STRAIGHT, LEFT, RIGHT, OR COMBINED STANDARD 20.1.0	20.00	EACH
161	T20.0822	FAST DRYING WATERBORNE PAVEMENT MARKING WORD "ONLY" STANDARD 20.1.0	16.00	EACH
162	T20.1000	REMOVE EXISTING PAVEMENT MARKINGS	416,100.00	LF
163	T20.2006	6 INCH EPOXY RESIN PAVEMENT MARKINGS WHITE	34,500.00	LF
164	T20.2008	8 INCH EPOXY RESIN PAVEMENT MARKINGS WHITE	125.00	LF
165	T20.2012	12 INCH EPOXY RESIN PAVEMENT MARKINGS WHITE	9,100.00	LF
166	T20.2016	6 INCH EPOXY RESIN PAVEMENT MARKINGS YELLOW	23,100.00	LF
167	T20.2020	EPOXY RESIN PAVEMENT ARROW - STRAIGHT, LEFT, RIGHT, OR COMBINED STANDARD 20.1.0	10.00	EACH
168	T20.2022	EPOXY RESIN PAVEMENT MARKING WORD "ONLY" STANDARD 20.1.0	8.00	EACH
169	T20.2054	EPOXY RESIN PAVEMENT MARKING WORD "EXIT"	2.00	EACH

RHODE ISLAND DEPARTMENT OF TRANSPORTATION

**\* THIS IS A DISK-BASED BID \***

**ELECTRONIC BIDDING  
PROCEDURE NOTICE**

**ALL BID OFFERS MUST BE PREPARED USING THE QUEST LITE BID  
PREPARATION SOFTWARE PACKAGE**

Bidders **MUST** register in person at the RIDOT Contract Administration office to obtain the necessary Bidder Registration and Digital ID codes for the Quest Lite software.

**RIDOT Provides:**

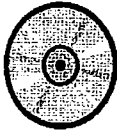

CD

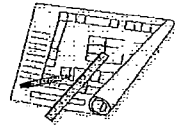

Plans (on CD)

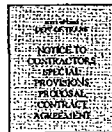

Contract Documents  
(on CD)

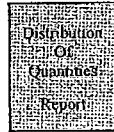

DOQ Report  
(on CD)

**Bidder Must Submit:**

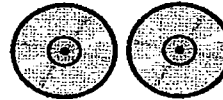

2 High-Density  
Compact Disks  
(CDs) w/Quest Lite  
Bid "zip" file\*\*



Completed &  
Signed Proposal  
(Hard Copy)

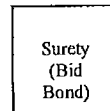

Bid Surety  
(Hard Copy)

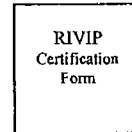

Completed & Signed  
(Hard Copy)

Contact the Contracts & Specifications Office at 222-2495 to request technical assistance on issues directly related to the Quest Lite software  
Office Hours: 8:00 AM – 4:00 PM

**\*\*Refer to the RIDOA "Notice to Contractors" for additional information on the  
"Public Copy" submission requirements.**

**NO BID OFFER WILL BE CONSIDERED**

**UNLESS ACCOMPANIED BY A COMPACT DISK (CD)**

**CONTAINING THE BID PROPOSAL FILE**

**GENERATED BY THE QUEST LITE BID PREPARATION SOFTWARE**

*Failure to comply will result in a mandatory disqualification per Section 12.102.07 of the RI  
Dept of Administration Division of Purchases Procurement Regulations*

Rhode Island Department of Transportation (RIDOT)

**Notice to Contractors**

**THIS IS A DISK-BASED BID**

Bid offers will be accepted *only on a CD generated by RIDOT-supplied software called Quest Lite; each CD must be accompanied by a hard copy signed offer printed from the software and submitted at the Bid Opening.* Minimum computer hardware and operating system requirements are listed here. *Training is strongly recommended for all new bidders and others unfamiliar with these procedures. SEE BELOW.*

**CONTACT: RIDOT CONTRACTS & SPECIFICATIONS**

Rm. 108, Two Capitol Hill, Providence, RI 02903

Phone: **401-222-2495**

Hours: **Mon – Fri, 8:00AM – 4:00PM**

**1. Required Registration Codes for Each Bidder.**

Registration Codes for RIDOT software are necessary to install and use the software; a firm only needs to register once to acquire secure, unique bidder identification codes to be used with all RIDOT disk-based construction project bids. Bidders must retain these codes for future use.

**2. The required Quest Lite installation software and all applicable Contract Documents are provided on a CD-ROM.**

The Contract Documents include the RI DOA Division of Purchases Procurement Regulations, RI Standard Specifications, Amended December 2010 and all revisions, the RI Standard Details for Highway and Bridge Construction, Bridge Standard Details, General Provisions, Special Provisions, Distribution of Quantities and Engineering Plans, and all other applicable documents

**3. Minimum Computer Hardware and Operating System Requirements.**

- Windows XP SP2 w/Pentium IV processor
- CD-ROM Drive, Floppy Drive, Printer & 15" Monitor (17" recommended)
- 20GB Hard Disk with 1GB free (40 GB with 5 GB free recommended)
- 512 MB RAM (1 GB recommended)
- 32 MB Video Card (64 MB SVGA recommended)
- Internet Explorer 6.0 SP 2

**4. Addenda, when necessary, are available on Purchases' RIVIP website.**

at: <http://www.purchasing.ri.gov/RIVIP/BidSearch.asp>

RIDOT will make all necessary addenda available at Purchases' web site. It is the plan-holders responsibility to poll the RIVIP to keep up-to-date on addenda.

**5. Training may be requested up to three days prior to the Bid Opening.**

Training is provided on request. Arrangements must be made through the RIDOT Contracts & Specifications Office at least three (3) days prior to the Bid Opening of the project.

**6. Technical Support.**

Assistance is available upon request by contacting the Contracts & Specifications office during work hours or emailing [Quest@dot.ri.gov](mailto:Quest@dot.ri.gov).

01/25/2011

# NOTICE TO HIGHWAY AND BRIDGE CONTRACTORS

Rhode Island Department of Transportation (RIDOT)  
Contracts and Specifications

## ELECTRONIC BIDDING PROCEDURES QUEST LITE UPGRADE

Effective January 1, 2011, bid offers for all RIDOT Contracts requiring the use of the Department's Quest Lite bid preparation software **MUST** be prepared using **Quest Lite Version 040408 (2.8.4)**. Failure to comply with this requirement could result in the disqualification of your bid offer.

Full installation and upgrade-only software packages, including installation directions, for Quest Lite Version **040408 (2.8.4)** will be provided on the Project Advertising CD's, which are available to prospective bidders through the Contracts and Specifications office on or after the scheduled project advertising date.

Contractors presently using Quest Lite Version 040407 (2.8.3) need only install the upgrade package to complete the conversion, **UNLESS** a previous upgrade installation was used to upgrade from 2.8.2 to 2.8.3, in which case these installations must be removed and the full installation performed. Earlier versions (2.8.2 or lower) will require the full installation in all instances.

For technical assistance, contact the Contracts and Specifications office at 222-2495.

01/21/11

## QUEST LITE VERSION 4.4.8 (2.8.4)

### UPGRADE & FULL INSTALLATION

All bid offers prepared using the Department of Transportation's Quest Lite software must use the Quest Lite Version 040408 (2.8.4). If there is no Quest Lite installation, then the full installation must be completed. For earlier versions of Quest Lite, either the upgrade or full installation will be required to be completed. Both versions (upgrade and full installation) are provided on this project CD.

Before proceeding with any installations, note the following:

1. All users must register with the Department of Transportation in order to use Quest Lite. At the time of registration, users are provided with a set of unique company ID codes (Site Code, Bidder Code and company Short Name). Users **MUST RETAIN** these codes for future use.
2. Many users who currently have Quest Lite installed will only require the installation of the upgrade version. To determine if the upgrade installation is sufficient, the present version of the Quest Lite installation must be determined. This is accomplished in Quest Lite by clicking on Help/About. If the present version is 040407 (2.8.3) then the upgrade installation is sufficient **unless** an upgrade version has been previously used to upgrade version 2.8.2 to 2.8.3.
3. For earlier installations (versions below 2.8.3, and if an upgrade has been previously installed to upgrade to version 2.8.3), the full installation of Quest Lite is required. (Note: if the full installation is required, the upgrade installation **does not** need to be performed after the full installation is completed.)
4. To determine if an upgrade version of Quest Lite version is present, it is generally easiest to use the "Add or Remove Programs" function from the Control Panel to view the Quest Lite installations. Should both an installation and an upgrade version be installed, both programs must be removed using the "Remove" function and the new version 2.8.4 installed.
5. It is recommended that users consult the Quest Lite User Manual provided on this CD prior to attempting the installation of the upgrade or full program installation.
6. After completing the installation of the upgrade or full installation, it is recommended that a test bid be submitted to the Department to ensure the program is functioning correctly and that the Quest Lite bid files can be correctly imported into the Department's Quest program. **Test bids may be submitted on a CD to the Contracts office in Room 109 of the RIDOT Headquarters, or by e-mail to [Quest@dot.ri.gov](mailto:Quest@dot.ri.gov).**



### **Installation Instructions – Upgrade Version**

Upgrade Quest Lite only if the current installed version is 2.8.3, and a previous upgrade has not been installed.

1. Close Quest Lite before attempting the installation.
2. Using the project CD, double-click on the “Upgrade Only” option provided on the Start page.
3. When prompted for a password, enter “ridot”.
4. Follow the instructions provided in the installation wizard to complete the installation.
5. When executing Quest Lite for the first time after installing the upgrade, users may be prompted to enter their company bidder codes.

### **Installation Instructions – Complete Installation**

A complete Installation of the software is required only if Quest Lite is:

1. Not installed on the computer/laptop; or
2. The installed version of Quest Lite is older than 2.8.3, i.e. 2.8.2 or under; or
3. The 2.8.3 upgrade version of Quest Lite is installed.

If any of 1 through 3 above apply, follow these instructions:

1. If a Quest Lite version 2.8.2 or older, or a 2.8.3 upgrade are currently installed,
  - a. Close Quest Lite.
  - b. Remove all the existing installation(s) of Quest Lite. To accomplish this, follow the instructions provided on pages 19 – 25 of the Quest Lite User Manual provided with this project CD. Follow the installation removal directions for the operating system in use on the machine.
2. Using the project CD, double-click on the “Complete Installation” option provided on the Start page.
3. When prompted for a password, enter “ridot”.
4. Follow the instructions provided in the installation wizard to complete the installation.
5. When executing Quest Lite for the first time after completing the installation, the user will be prompted to enter the company bidder codes provided by the Department. Once this information is entered, the installation process will be complete.

For technical assistance, contact the Contracts & Specifications office at 222-2495.