



State of Rhode Island  
Department of Administration / Division of Purchases  
One Capitol Hill, Providence, Rhode Island 02908-5855  
Tel: (401) 574-8100 Fax: (401) 574-8387

**ADDENDUM #1**

RFP # 7561481      TITLE: DESIGN/BUILD SERVICES RECONSTRUCTION OF TOLL GATE  
BR#683&684 CENTERVILLE ROAD (I-95 NB/SB)

SUBMISSION DEADLINE: DECEMBER 6, 2017 -11:30 A.M.

---

See attached.

*Lisa Hill*

---

Lisa Hill  
Chief Buyer

November 28, 2017

STATE OF RHODE ISLAND AND PROVIDENCE PLANTATIONS  
DEPARTMENT OF TRANSPORTATION  
DIVISION OF PURCHASES BID NO. 7561481  
RHODE ISLAND CONTRACT NO. 2017-DB-026  
FEDERAL AID PROJECT NO.: BRO-0683(001)

Design Build Services for Reconstruction of Tollgate Br. 683 & 684  
Superstructure Replacement Bridge Nos. 683 & 684

CITY OF WARWICK  
COUNTY OF KENT

**NOTICE TO PROSPECTIVE BIDDERS**

**ADDENDUM NO. 1:**

Prospective Bidders and all concerned are hereby notified of the following changes in the Plans, Specifications, Proposal and Distribution of Quantities for this contract. These changes shall be incorporated in the Plans, Specifications, Proposal and Distribution of Quantities, and shall become an integral part of the Contract Documents.

**Part A – Instructions for Respondents**

- a. Revised page no. 7, as attached to this Addendum No. 1.

**Part B – Technical Requirements**

- b. Revised pages 36, 37 and 40, as attached to this Addendum No. 1.

**Part D, Appendix A – Existing Information**

- c. The following documents are added to the Existing Information and are attached to this Addendum No. 1:
  - i. Substructure Dead Load Reactions
  - ii. RIDOT Tolling Project: Location No. 3 – DRAFT Design Plan

**Part D, Appendix B – BTC Documents**

- d. Replace BTC Plans Sheet Nos. 31 to 33, 66 to 69, 75 to 77, and 82 to 84 with those like-numbered sheets attached to this Addendum No. 1.
- e. Job Specific Provision 108.1000 – Prosecution and Progress

**Required Forms**

- f. The following documents are added to the Required Forms and are attached to this Addendum No. 1:
  - i. DBE Letter of Intent to Perform
  - ii. Schedule of Participation by DBE

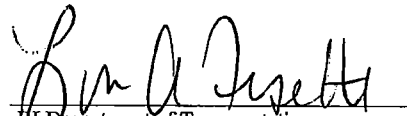
  
RI Department of Transportation  
Manager, Project Management

**ADDENDUM NO. 1  
ATTACHMENTS**

### 2.3 Project Milestone Schedule

RIDOT currently anticipates conducting this procurement in accordance with the following list of milestones. This schedule is subject to revision and RIDOT reserves the right to modify this schedule as it finds necessary, in its sole discretion.

Advertise RFP.....	September 13, 2017
Deadline for Questions and Comments .....	November 29, 2017 (@ Midnight)
Proposal Submission Date .....	December 6, 2017
Evaluate Technical Proposals (Score and Rank) .....	December 29, 2017
Open Price Proposals.....	January 3, 2018 (Tentative)
Notice of Tentative Award .....	January 31, 2018 (Tentative)
Design-Build Contract Execution.....	February 7, 2018 (Tentative)
Notice to Proceed.....	February 21, 2018 (Tentative)
Substantial Completion.....	December 27, 2019
Project Completion.....	February 19, 2020

Respondents are on notice that any earlier completion date(s) identified by Respondent in response to the RFP will be deemed by RIDOT as the contractual completion date(s) for this Project.

### 2.4 Online Proposal Questions

**There will be NO point of contact at RIDOT who will directly answer questions either in person, through email, or by telephone.**

Any pertinent questions subsequent to this solicitation must be posted at RIDOT'S "Bidding Opportunities" web page accessible at: <http://www.dot.ri.gov/contracting/bids> and follow the link to "?" to submit questions for this solicitation. Interested parties must disclose their name/company affiliation along with posted inquiry; responses to questions submitted for the subject Project will also be posted under the same questions menu.

A determination will be made by RIDOT, in coordination with the RIDOA/ Division of Purchases, whether an addendum will be required. The Q & A Forum will disable **SEVEN (7) FULL CALENDAR DAYS** prior to the due date for this Project. **Therefore, questions will not be accepted after Midnight on November 29, 2017.**

The DB-Team shall provide all utilities with 75%/90% design plans at the time of submission to RIDOT so that the preliminary utility relocation schemes can be confirmed by the utility owners.

The DB-Team shall accurately show the final location of all utilities on the record drawings for the Project.

The DB-Team shall comply with all applicable environmental laws in the performance of the utility work.

The DB-Team shall not enter into any agreement with any utility owner that purports to bind RIDOT in any way, nor shall any agreement be deemed to modify the terms of the Contract Documents.

The DB-Team specifically assumes all cost risks and risk of schedule delays associated with the utility work.

The DB-Team shall permit utility owners to inspect the work on their respective utilities.

#### **2.14.2 Anticipated Utility Relocations and Payment**

Utility reimbursement for this project for all work performed or contracted by the private utilities will be made through RIDOT utilizing conventional force account agreements.

The DB-Team shall be responsible for the cost of:

- All relocation work (if any) required for the existing RIDOT owned conduit that contains traffic and lighting related wires.
- All costs associated with locating utilities, utility coordination, and other utility related incidental work items.

Upon receipt of acceptance of the work by each respective Utility, the RIDOT will pay the utility directly, ~~and will withhold an equivalent amount from the DB-Team or from retainage to reimburse the RIDOT.~~ The RIDOT will not pay for utility work that is a betterment above and beyond what existed on, over or under the bridges prior to the DB-Team start of work at the bridge.

The DB-Team shall ensure that there are no conflicts with the proposed construction scope of work, and ensure that there are no conflicts between the utility's relocation plans. The DB-Team shall prepare and submit to RIDOT all relocation plans. The DB-Team shall assemble the information included in the relocation plans in a final and complete form and in such a manner that RIDOT may approve the submittals with minimal review. The DB-Team shall meet with RIDOT's Utilities Engineer within 20

days of the Notice to Proceed to gain a full understanding of what is required with each submittal. The DB-Team shall receive written approvals from RIDOT prior to authorizing utilities to commence relocation construction. The utilities shall not begin their relocation work until authorized by RIDOT. Each relocation plan submitted shall be accompanied by a certification from the DB-Team stating that the proposed relocation will not conflict with the overall project goals, and will not conflict with another utility's relocation plan.

#### COOPERATION WITH RIDOT'S TOLL SYSTEMS CONTRACTOR

The Contractor will be required from time to time to work with RIDOT's toll system contractor to support the continuity of toll operations throughout the project. The Contractor shall cooperate with the toll system contractor or representatives of RIDOT in order to ensure that the toll system and other functional elements do not conflict or cause any deterrent in operation.

#### DAMAGES FOR DISRUPTION OF SERVICE

In the event the Contractor causes any unscheduled disruption or adverse impact to the toll collection equipment resulting in the loss of revenue, the Contractor shall be subject to Liquidated Damages in the amount of \$4,000 per day. An 'unscheduled disruption' shall mean any event which was not planned, scheduled or approved prior by RIDOT. In addition, the Contractor shall be responsible for any cost associated with the repair (to be performed by RIDOT's toll systems contractor) of the toll collection system and or associated equipment.

#### **2.14.3 Utility Owner Contact Information**

The RIDOT project manager is the contact for existing drainage, lighting, cabinets, traffic cameras, and the associated conduit.

Refer to Part D, Appendix A for additional utility contact information.

#### **2.15 Quality Assurance (QA)**

Quality Assurance (QA) is an umbrella term that includes all activities performed to ensure that the quality of a product sufficiently meets or exceeds the standards set forth by the Contract and its project-specific requirements. QA is the responsibility of both the DB-Team and the Owner (RIDOT). To ensure that the goals for overall quality will be met, RIDOT has established the following QA requirements for this Project:

- Design QA: The design quality assurance will consist of an established Design Quality Control system established by the DB-Team and approved by RIDOT. RIDOT will also perform review of

The DB-Team shall prepare a Materials Test Book for all materials and items required within the construction scope of work. This Materials Test Book must be prepared in accordance with the latest RIDOT *Master Schedule for Sampling, Testing, and Certification of Materials*, the latest RIDOT *Standard Specifications for Road and Bridge Construction*, and the RIDOT *Procedures for Uniform Record Keeping*.

### **2.16.3 Non-Conforming Work**

Completed work that does not conform to the contract requirements for the quality of materials or workmanship shall be documented through a Non-Conformance Report (NCR). When required, an NCR shall be prepared and submitted to the Department within 24 hours after identifying the non-conformance.

The NCR shall clearly describe the element of design-build Work that is non-conforming and the nature of the non-conformance. The NCR shall further address the steps that are to be taken to ensure that the particular non-conformance will not be repeated.

The DB-Team's Design Engineer for the Work shall evaluate the effect(s) of the non-conformance on the performance, safety and service life of the Project and its elements. The proposed resolution of the non-conformance, including remedial actions if necessary, shall be fully designed and documented and shall bear the stamp of a Professional Engineer registered in the State of Rhode Island. The DB-Team's Construction QC Manager and the Quality Control Administrator shall also sign the NCR that the resolution of the non-conformance has undergone the same level of QC as the design.

RIDOT shall review and accept the proposed resolution of the NCR prior to the DB-Team implementing any corrective action. RIDOT shall ultimately have the authority to call for removal of any non-conforming work should RIDOT not agree that the remedial actions set forth by the DB-Team are sufficient. RIDOT also reserves the right to make cost adjustments for any work that, although not in conformance with the specifications, is nevertheless satisfactory to remain in place.

The DB-Team shall maintain a log of all NCR's and submit this log to RIDOT on a bi-weekly basis. Each NCR shall be numbered sequentially with a brief description, the status and an expected date for resolution.

### **2.17 Field Office**

The DB-Team shall provide office space, equipment, and services consistent with requirements of the Standard Specifications for the RIDOT Resident Engineer. ~~—This field office should be configured and equipped for joint operations by DB Team and Department staff per the RI Standard Specifications.~~ The configuration and equipping of the field office shall be coordinated between the DB-Team and the



Calc'd by: KLJ 07/17

Checked by: GJP 11/17

Bridge 683
Abutment Girder Reactions

UNFACTORED GIRDER REACTIONS (KIPS)											
Bridge 683 I-95 Southbound				Bridge 683 I-95 Northbound							
PBU No.	Beam No.	South Abutment		North Abutment		PBU No.	Beam No.	South Abutment		North Abutment	
		DC	DW	DC	DW			DC	DW	DC	DW
P1S	1	51.33	7.03	51.33	7.03	P10N	18	61.41	7.04	61.41	7.04
P2S	2	40.78	7.03	40.78	7.03	P11N	19	39.16	7.04	39.16	7.04
	3	40.78	7.03	40.78	7.03		20	39.16	7.04	39.16	7.04
P3S	4	40.78	7.03	40.78	7.03	P12N	21	39.16	7.04	39.16	7.04
	5	40.78	7.03	40.78	7.03		22	39.16	7.04	39.16	7.04
P4S	6	40.78	7.03	40.78	7.03	P13N	23	39.16	7.04	39.16	7.04
	7	40.78	7.03	40.78	7.03		24	39.16	7.04	39.16	7.04
P5S	8	40.78	7.03	40.78	7.03	P14N	25	39.16	7.04	39.16	7.04
	9	40.78	7.03	40.78	7.03		26	39.16	7.04	39.16	7.04
P6S	10	40.78	7.03	40.78	7.03	P15N	27	39.16	7.04	39.16	7.04
	11	40.78	7.03	40.78	7.03		28	39.16	7.04	39.16	7.04
P7S	12	40.78	7.03	40.78	7.03	P16N	29	39.16	7.04	39.16	7.04
	13	40.78	7.03	40.78	7.03		30	39.16	7.04	39.16	7.04
P8S	14	40.78	7.03	40.78	7.03	P17N	31	39.16	7.04	39.16	7.04
	15	40.78	7.03	40.78	7.03		32	39.16	7.04	39.16	7.04
P9S	16	40.78	7.03	40.78	7.03	P18N	33	39.16	7.04	39.16	7.04
	17	57.91	7.03	57.91	7.03		34	39.16	7.04	39.16	7.04
							35	59.09	7.04	59.09	7.04



Calc'd by: KLJ 07/17  
Checked by: GJP 11/17

Bridge 684
Substructure Girder Reactions

**UNFACTORED GIRDER REACTIONS (KIPS)**

Bridge 684 I-95 Southbound					
PBU No.	Beam No.	South Abutment		Pier	
		DC	DW	DC	DW
P1S	1	49.30	6.52	49.30	6.52
P2S	2	37.26	6.52	37.26	6.52
	3	37.26	6.52	37.26	6.52
P3S	4	37.26	6.52	37.26	6.52
	5	37.26	6.52	37.26	6.52
P4S	6	37.26	6.52	37.26	6.52
	7	37.26	6.52	37.26	6.52
P5S	8	37.26	6.52	37.26	6.52
	9	37.26	6.52	37.26	6.52
P6S	10	37.26	6.52	37.26	6.52
	11	37.26	6.52	37.26	6.52
P7S	12	37.26	6.52	37.26	6.52
	13	37.26	6.52	37.26	6.52
P8S	14	37.26	6.52	37.26	6.52
	15	37.26	6.52	37.26	6.52
P9S	16	37.26	6.52	37.26	6.52
	17	49.30	6.52	49.30	6.52

Bridge 684 I-95 Northbound					
PBU No.	Beam No.	South Abutment		Pier	
		DC	DW	DC	DW
P10N	18	56.15	6.68	56.15	6.68
P11N	19	37.26	6.68	37.26	6.68
	20	37.26	6.68	37.26	6.68
P12N	21	37.26	6.68	37.26	6.68
	22	37.26	6.68	37.26	6.68
P13N	23	37.26	6.68	37.26	6.68
	24	37.26	6.68	37.26	6.68
P14N	25	37.26	6.68	37.26	6.68
	26	37.26	6.68	37.26	6.68
P15N	27	37.26	6.68	37.26	6.68
	28	37.26	6.68	37.26	6.68
P16N	29	37.26	6.68	37.26	6.68
	30	37.26	6.68	37.26	6.68
P17N	31	37.26	6.68	37.26	6.68
	32	37.26	6.68	37.26	6.68
P18N	33	37.26	6.68	37.26	6.68
	34	56.15	6.68	56.15	6.68

PBU No.	Beam No.	Pier		North Abutment	
		DC	DW	DC	DW
P19S	35	49.30	6.52	49.30	6.52
P20S	36	37.26	6.52	37.26	6.52
	37	37.26	6.52	37.26	6.52
P21S	38	37.26	6.52	37.26	6.52
	39	37.26	6.52	37.26	6.52
P22S	40	37.26	6.52	37.26	6.52
	41	37.26	6.52	37.26	6.52
P23S	42	37.26	6.52	37.26	6.52
	43	37.26	6.52	37.26	6.52
P24S	44	37.26	6.52	37.26	6.52
	45	37.26	6.52	37.26	6.52
P25S	46	37.26	6.52	37.26	6.52
	47	37.26	6.52	37.26	6.52
P26S	48	37.26	6.52	37.26	6.52
	49	37.26	6.52	37.26	6.52
P27S	50	37.26	6.52	37.26	6.52
	51	49.30	6.52	49.30	6.52

PBU No.	Beam No.	Pier		North Abutment	
		DC	DW	DC	DW
P28N	52	56.15	6.68	56.15	6.68
P29N	53	37.26	6.68	37.26	6.68
	54	37.26	6.68	37.26	6.68
P30N	55	37.26	6.68	37.26	6.68
	56	37.26	6.68	37.26	6.68
P31N	57	37.26	6.68	37.26	6.68
	58	37.26	6.68	37.26	6.68
P32N	59	37.26	6.68	37.26	6.68
	60	37.26	6.68	37.26	6.68
P33N	61	37.26	6.68	37.26	6.68
	62	37.26	6.68	37.26	6.68
P34N	63	37.26	6.68	37.26	6.68
	64	37.26	6.68	37.26	6.68
P35N	65	37.26	6.68	37.26	6.68
	66	37.26	6.68	37.26	6.68
P36N	67	37.26	6.68	37.26	6.68
	68	56.15	6.68	56.15	6.68



DATE	BY	REVISION
2017		3

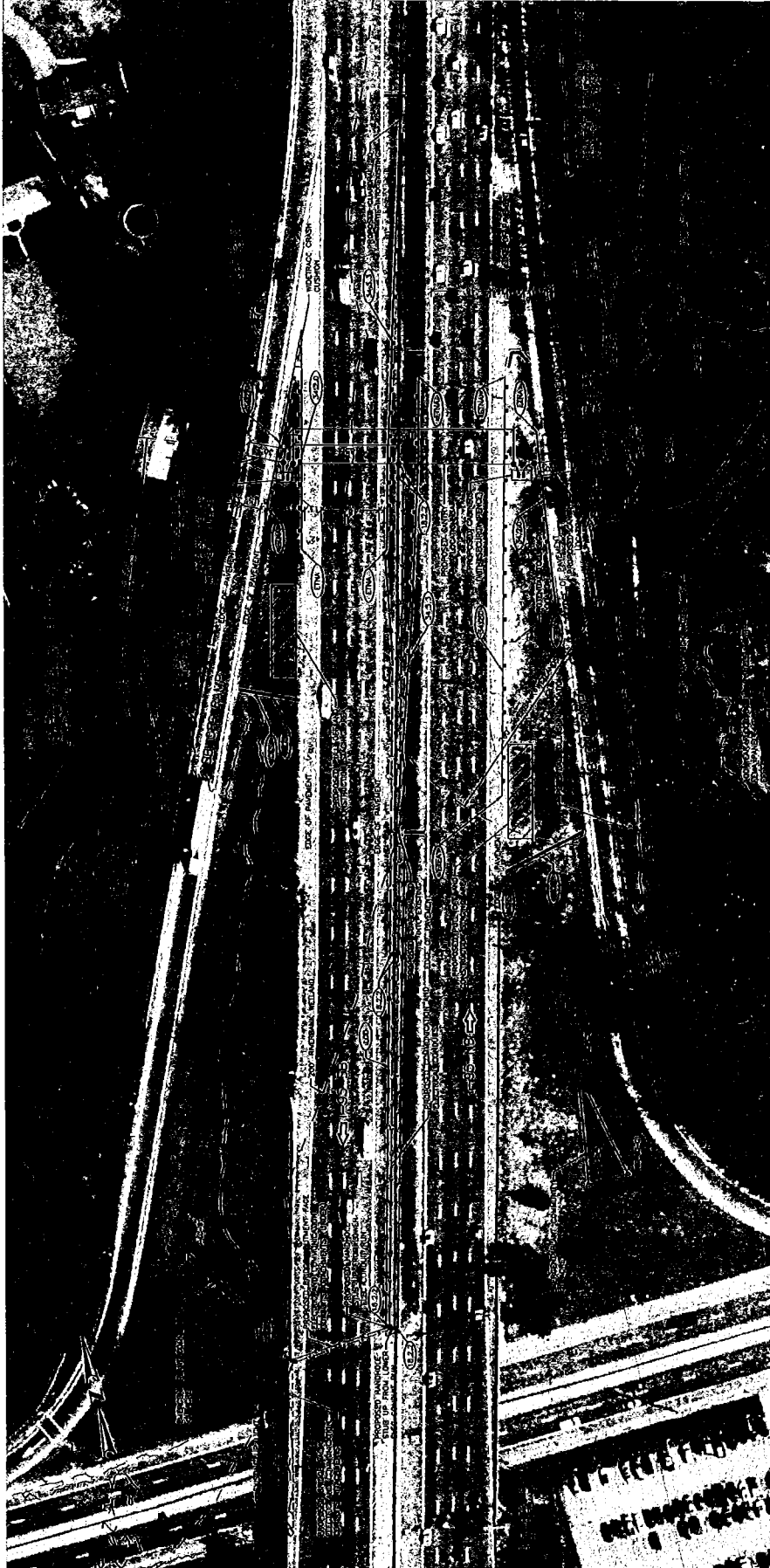

DRAFT

- NOTES:
1. FOR STANDARD PLANS SYMBOLS AND STANDARD LEGEND, SEE SHEET NO. 2.
  2. DIMENSIONS ARE APPROXIMATE.
  3. CONTRACTOR RESERVES THE RIGHT TO DETERMINE THE FOUNDATION TYPE ONCE THE EXISTING FOUNDATION CONDITION AND ENVIRONMENTAL IMPACTS ARE IDENTIFIED.
  4. PROPOSED CURB/LANE DIMENSIONS ARE APPROXIMATE.

REVISION	NO.	DATE	BY

RHODE ISLAND  
DEPARTMENT OF TRANSPORTATION  
RHODEWORKS TOLL FACILITIES -  
DESIGN, BUILD, OPERATE  
AND MAINTAIN  
WARWICK, RHODE ISLAND

GENERAL PLAN  
LOCATION: 3

CHECKED BY: JME DATE: JAN. 2017 SCALE: AS SHOWN  
DRAWN BY: JME DATE: JAN. 2017 SCALE: AS SHOWN

NO.	DATE	BY	DESCRIPTION	SCALE	DATE	NO.
01	08/14/17	XX	PRO-0825(001)			31
02						105

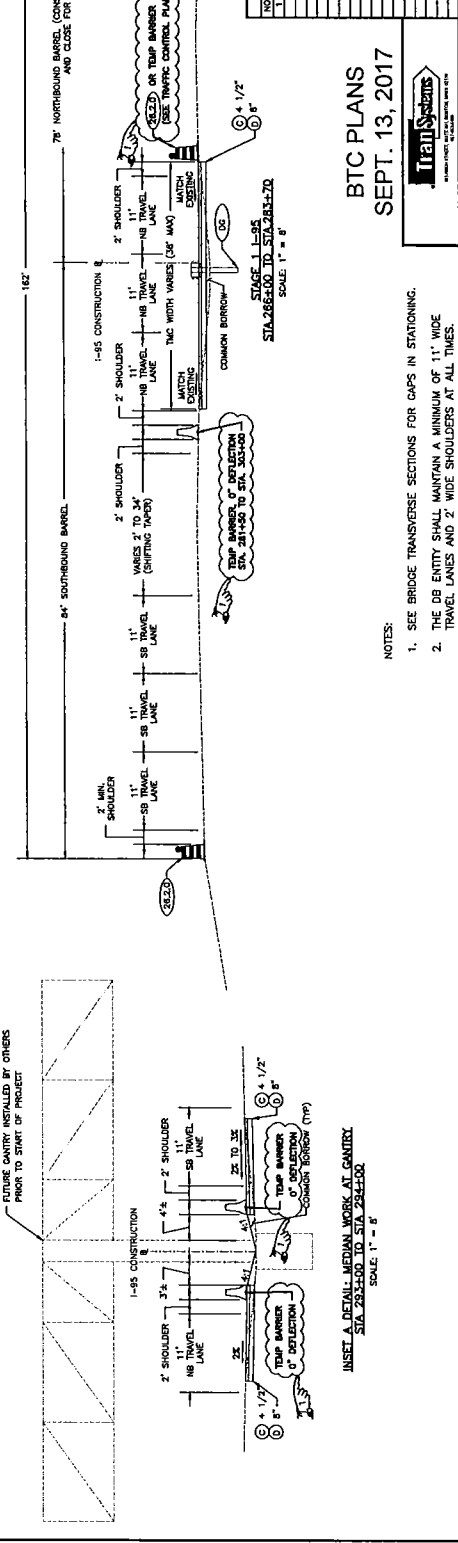
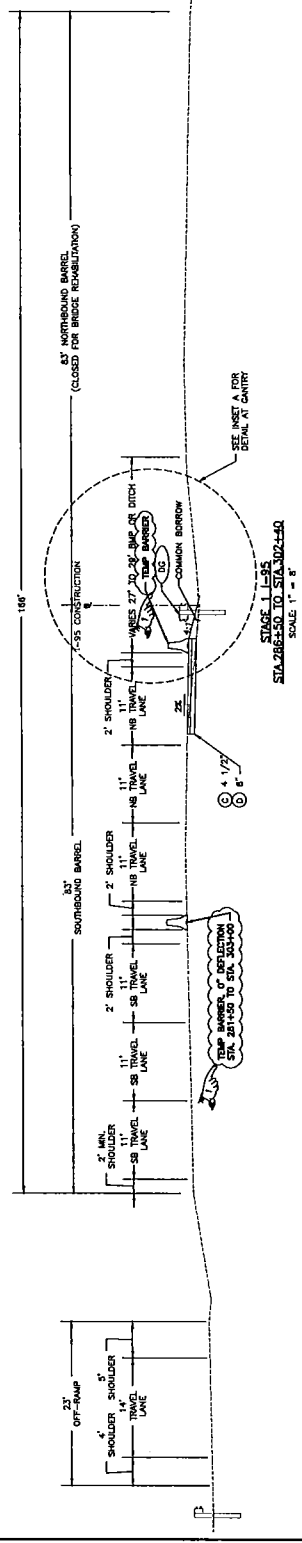
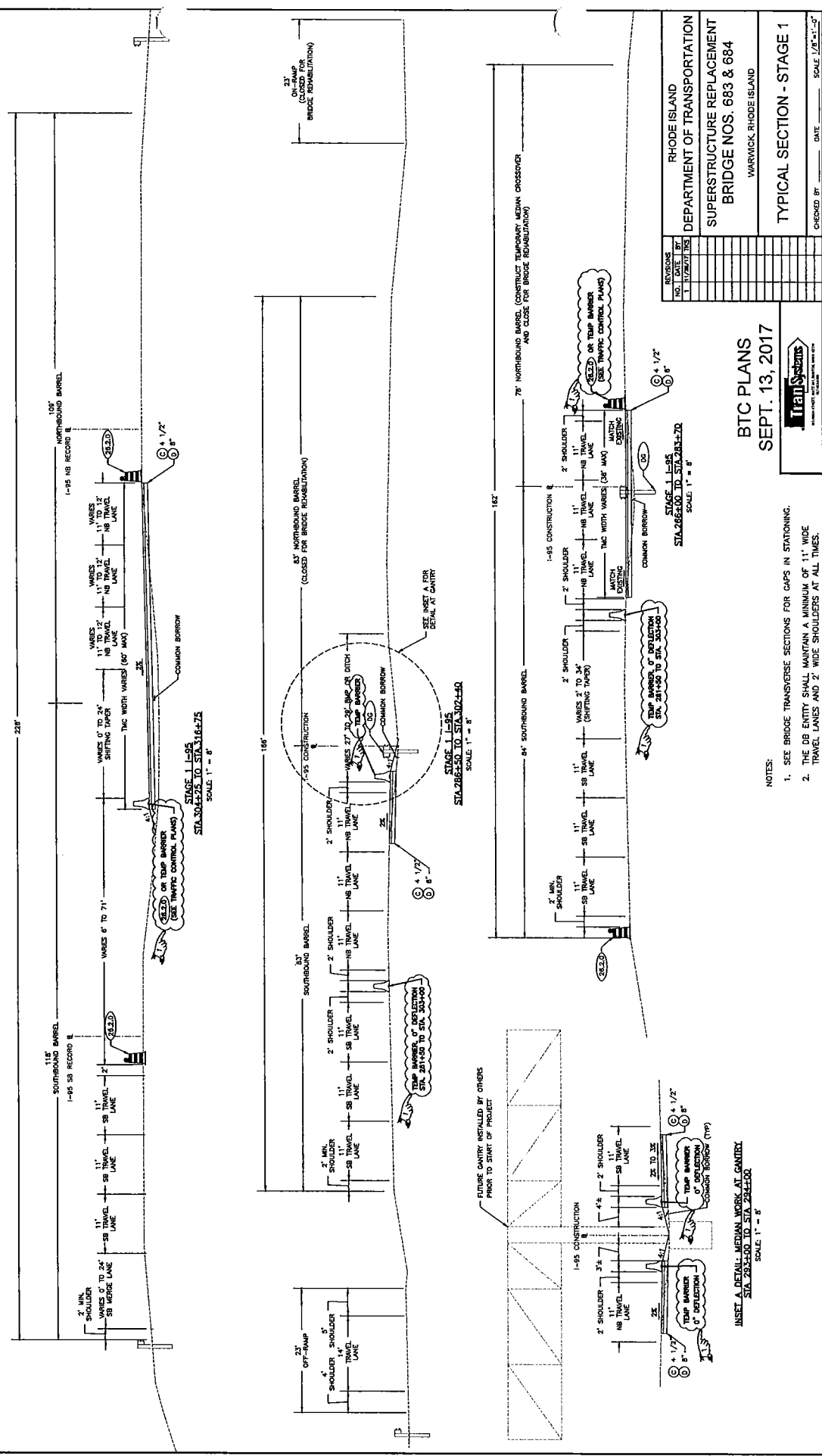

REVISIONS		DATE	BY	DESCRIPTION
1				

RHODE ISLAND  
DEPARTMENT OF TRANSPORTATION  
SUPERSTRUCTURE REPLACEMENT  
BRIDGE NOS. 683 & 684  
WARWICK RHODE ISLAND

BTC PLANS  
SEPT. 13, 2017



- NOTES:
1. SEE BRIDGE TRANSVERSE SECTIONS FOR GAPS IN STATIONING.
  2. THE DE ENTITY SHALL MAINTAIN A MINIMUM OF 11' WIDE TRAVEL LANES AND 2' WIDE SHOULDERS AT ALL TIMES.

INSET A DETAIL MEDIAN WORK AT GANTRY  
STA 287+00 TO STA 288+00  
SCALE 1" = 8'

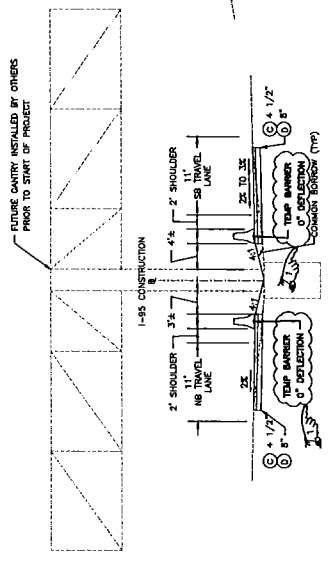

NO.	DATE	BY	REVISION
1	08-10-17	IR	ISSUE FOR BIDDING
2	08-28-17	IR	ADD 2' MIN. SHOULDER
3	09-11-17	IR	ADD 2' SHOULDER
4	09-11-17	IR	ADD 2' SHOULDER
5	09-11-17	IR	ADD 2' SHOULDER
6	09-11-17	IR	ADD 2' SHOULDER
7	09-11-17	IR	ADD 2' SHOULDER
8	09-11-17	IR	ADD 2' SHOULDER
9	09-11-17	IR	ADD 2' SHOULDER
10	09-11-17	IR	ADD 2' SHOULDER
11	09-11-17	IR	ADD 2' SHOULDER
12	09-11-17	IR	ADD 2' SHOULDER
13	09-11-17	IR	ADD 2' SHOULDER
14	09-11-17	IR	ADD 2' SHOULDER
15	09-11-17	IR	ADD 2' SHOULDER
16	09-11-17	IR	ADD 2' SHOULDER
17	09-11-17	IR	ADD 2' SHOULDER
18	09-11-17	IR	ADD 2' SHOULDER
19	09-11-17	IR	ADD 2' SHOULDER
20	09-11-17	IR	ADD 2' SHOULDER
21	09-11-17	IR	ADD 2' SHOULDER
22	09-11-17	IR	ADD 2' SHOULDER
23	09-11-17	IR	ADD 2' SHOULDER
24	09-11-17	IR	ADD 2' SHOULDER
25	09-11-17	IR	ADD 2' SHOULDER

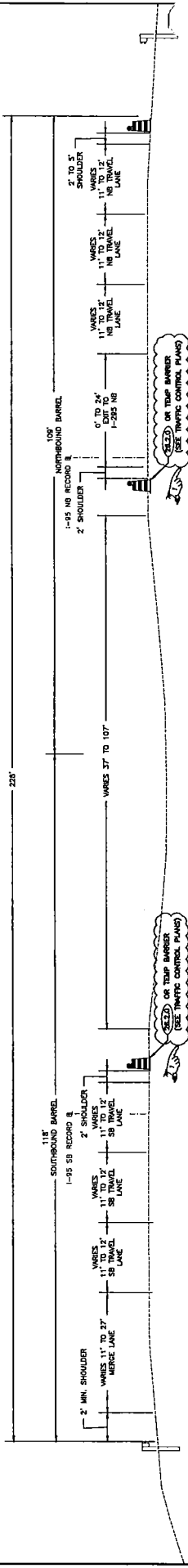

STAGE 2 I-95  
STA.306225 TO STA.311400  
SCALE: 1" = 8'

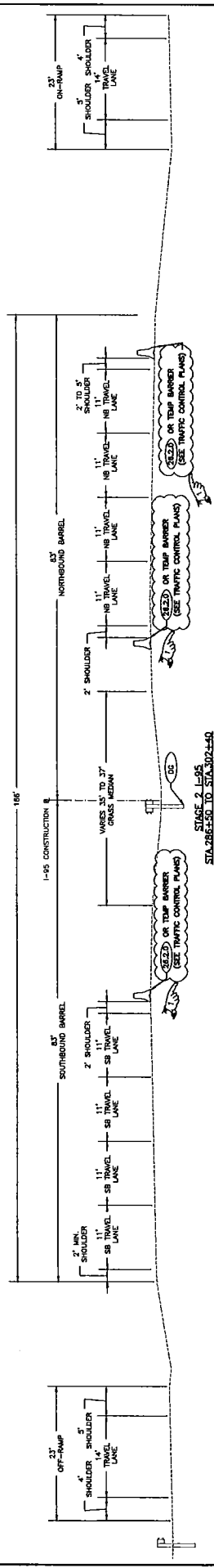

STAGE 2 I-95  
STA.286550 TO STA.302440  
SCALE: 1" = 8'

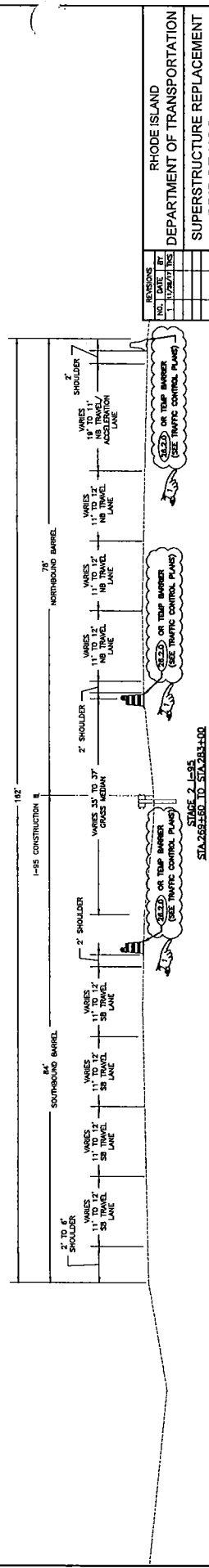

STAGE 2 I-95  
STA.263160 TO STA.268400  
SCALE: 1" = 8'

REVISIONS		NO.		DATE		BY	
1	08-10-17	IR	ISSUE FOR BIDDING				
2	08-28-17	IR	ADD 2' MIN. SHOULDER				
3	08-28-17	IR	ADD 2' SHOULDER				
4	08-28-17	IR	ADD 2' SHOULDER				
5	08-28-17	IR	ADD 2' SHOULDER				
6	08-28-17	IR	ADD 2' SHOULDER				
7	08-28-17	IR	ADD 2' SHOULDER				
8	08-28-17	IR	ADD 2' SHOULDER				
9	08-28-17	IR	ADD 2' SHOULDER				
10	08-28-17	IR	ADD 2' SHOULDER				
11	08-28-17	IR	ADD 2' SHOULDER				
12	08-28-17	IR	ADD 2' SHOULDER				
13	08-28-17	IR	ADD 2' SHOULDER				
14	08-28-17	IR	ADD 2' SHOULDER				
15	08-28-17	IR	ADD 2' SHOULDER				
16	08-28-17	IR	ADD 2' SHOULDER				
17	08-28-17	IR	ADD 2' SHOULDER				
18	08-28-17	IR	ADD 2' SHOULDER				
19	08-28-17	IR	ADD 2' SHOULDER				
20	08-28-17	IR	ADD 2' SHOULDER				
21	08-28-17	IR	ADD 2' SHOULDER				
22	08-28-17	IR	ADD 2' SHOULDER				
23	08-28-17	IR	ADD 2' SHOULDER				
24	08-28-17	IR	ADD 2' SHOULDER				
25	08-28-17	IR	ADD 2' SHOULDER				

RHODE ISLAND  
DEPARTMENT OF TRANSPORTATION  
SUPERSTRUCTURE REPLACEMENT  
BRIDGE NOS. 683 & 684  
WARWICK, RHODE ISLAND

TYPICAL SECTION - STAGE 2

CHECKED BY: \_\_\_\_\_ DATE: \_\_\_\_\_ SCALE: 1/8" = 1'-0"  
01-18-17, J03-033, J01/17/17

BTC PLANS  
SEPT. 13, 2017



- NOTES:
1. SEE BRIDGE TRANSVERSE SECTIONS FOR GAPS IN STATIONING.
  2. THE DB ENTITY SHALL MAINTAIN A MINIMUM OF 11' WIDE TRAVEL LANES AND 2' WIDE SHOULDERS AT ALL TIMES.

NO.	DATE	BY	REVISION
24	06	RF	BRIDGE CONTRACT
25			
26			

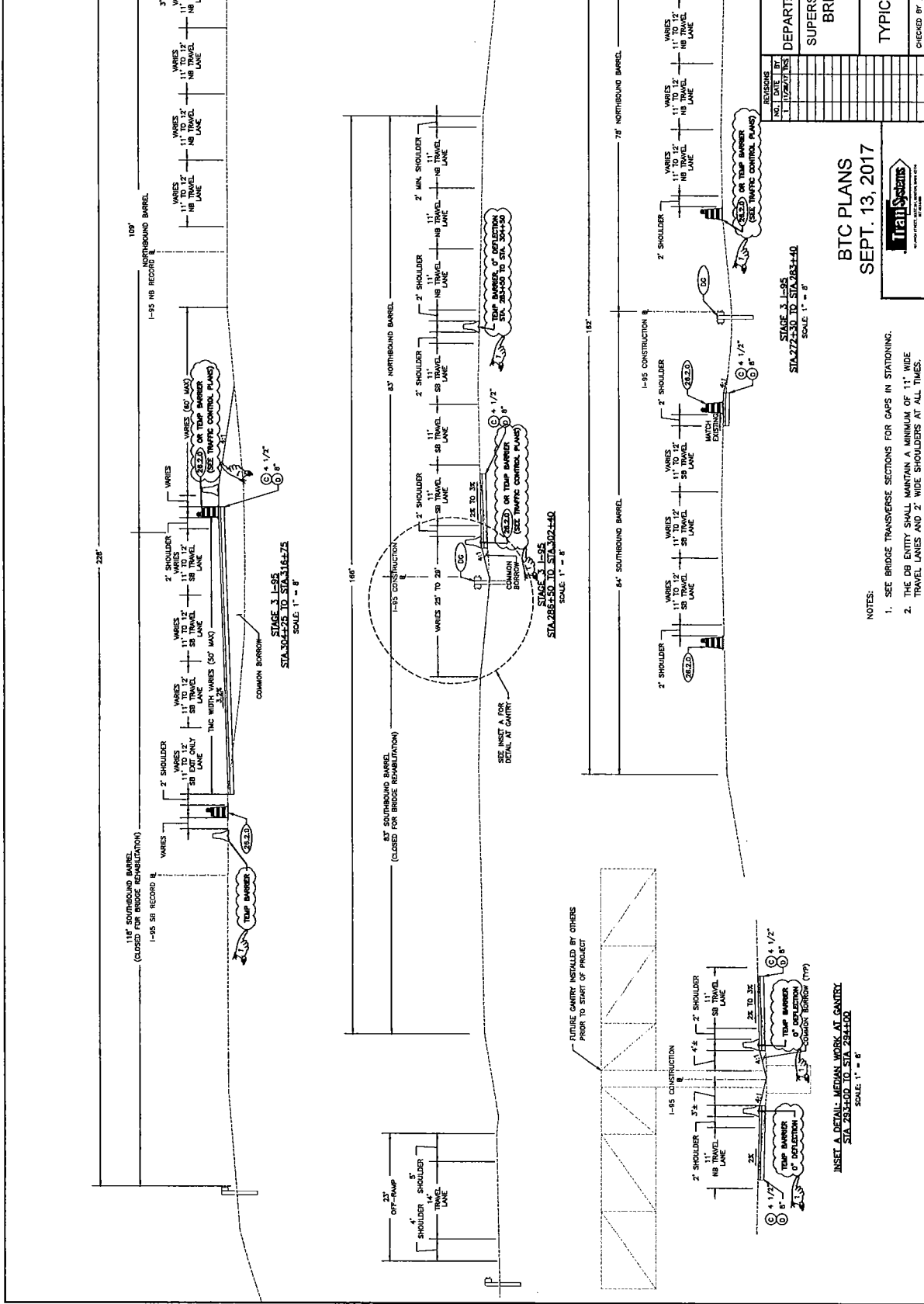

STAGE 3 I-95  
 STA 2855+00 TO STA 2883+40  
 SCALE: 1" = 8'

INSET A: DETAIL MECHANICAL WORK AT GANTRY  
 STA 2855+00 TO STA 2883+40  
 SCALE: 1" = 8'

INSET B: DETAIL MECHANICAL WORK AT GANTRY  
 STA 2883+40 TO STA 2922+00  
 SCALE: 1" = 8'

- NOTES:
- SEE BRIDGE TRANSVERSE SECTIONS FOR GAPS IN STATIONING.
  - THE DS ENTRY SHALL MAINTAIN A MINIMUM OF 11' WIDE TRAVEL LANES AND 2' WIDE SHOULDERS AT ALL TIMES.

BTC PLANS  
 SEPT. 13, 2017

TRAIL SYSTEMS  
 WARRICK, RHODE ISLAND

RHODE ISLAND  
 DEPARTMENT OF TRANSPORTATION  
 SUPERSTRUCTURE REPLACEMENT  
 BRIDGE NOS. 683 & 684  
 WARRICK, RHODE ISLAND

TYPICAL SECTION - STAGE 3  
 CHECKED BY: \_\_\_\_\_ DATE: \_\_\_\_\_ SCALE: 1/8" = 1'-0"  
 011 WP-VI-3300-003 UNUSUAL

NO.	DATE	BY	REVISION
01	02	RE	PRO-CURS(001)
02	03	RE	PRO-CURS(001)
03	04	RE	PRO-CURS(001)
04	05	RE	PRO-CURS(001)
05	06	RE	PRO-CURS(001)
06	07	RE	PRO-CURS(001)
07	08	RE	PRO-CURS(001)
08	09	RE	PRO-CURS(001)
09	10	RE	PRO-CURS(001)

1	DATE	BY	REVISION
1	02/13/2017	RE	PRO-CURS(001)

RHODE ISLAND			
DEPARTMENT OF TRANSPORTATION			
SUPERSTRUCTURE REPLACEMENT			
BRIDGE NOS. 683 & 684			
WARWICK, RHODE ISLAND			
TRAFFIC CONTROL STAGE 1			
SHEET 3 OF 10			
CHECKED BY	DATE	SCALE	1" = 40'

BTR SYSTEMS			
TRAFFIC CONTROL PLANS			
SEPT. 13, 2017			

ES-1	(72'x60')
W3-1	(48'x48')
W3-2	(36'x36')
W20-1	(36'x36')

ES-1	(72'x60')
W3-1	(48'x48')
W3-2	(36'x36')
W20-1	(36'x36')

ES-1	(72'x60')
W3-1	(48'x48')
W3-2	(36'x36')
W20-1	(36'x36')

ES-1	(72'x60')
W3-1	(48'x48')
W3-2	(36'x36')
W20-1	(36'x36')

ES-1	(72'x60')
W3-1	(48'x48')
W3-2	(36'x36')
W20-1	(36'x36')

ES-1	(72'x60')
W3-1	(48'x48')
W3-2	(36'x36')
W20-1	(36'x36')

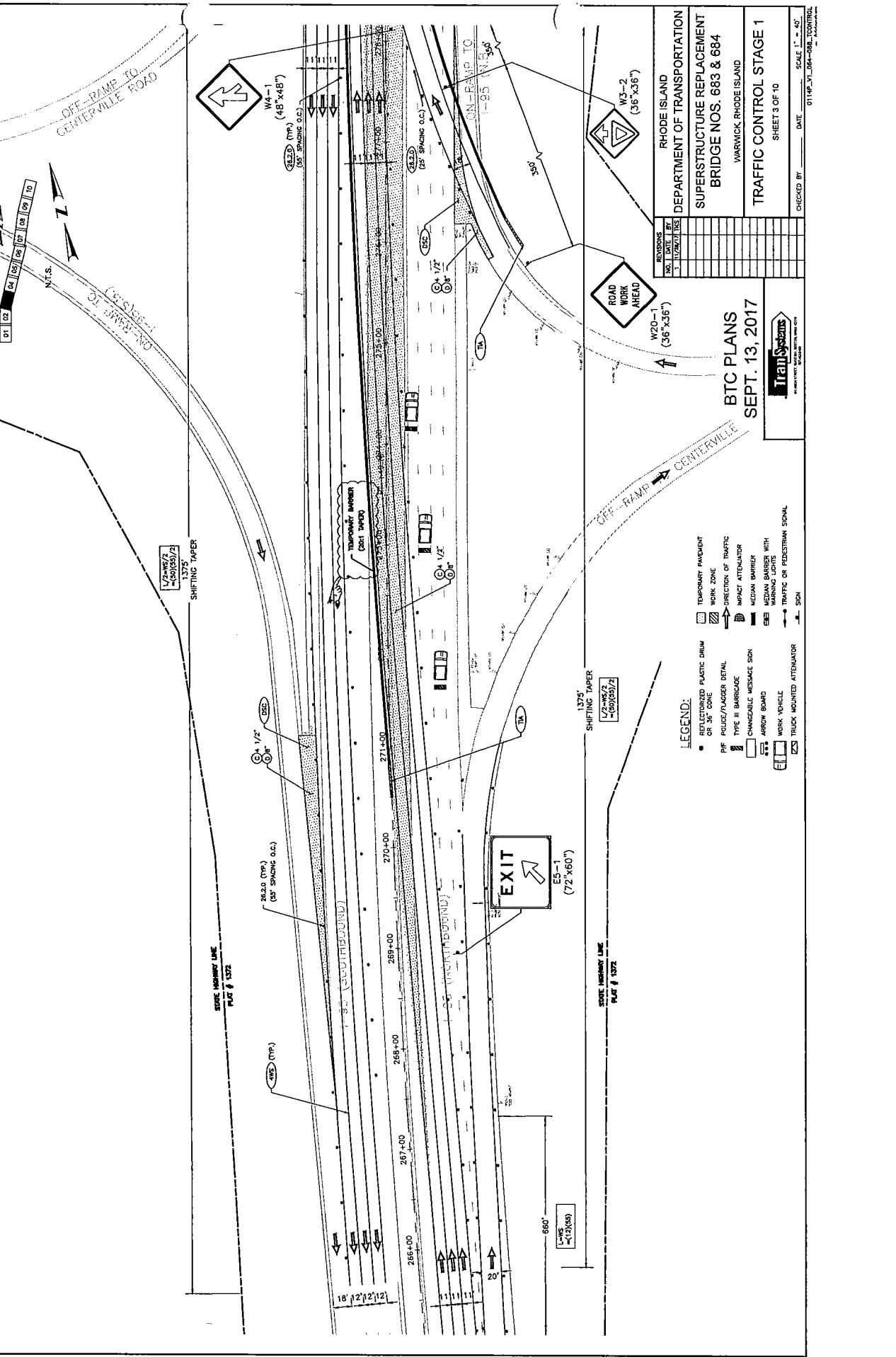

**LEGEND:**

- REFLECTORIZED PLASTIC DRUM
- OR 30' CONE
- PF POLICE/TARDER DETAIL
- TYPE III BARRICADE
- CHANGEABLE MESSAGE SIGN
- ARROW BOARD
- WORK VEHICLE
- TRUCK MOUNTED ATTENUATOR
- TEMPORARY PAVEMENT
- WORK ZONE
- DIRECTION OF TRAFFIC
- IMPACT ATTENUATOR
- MEDIAN BARRIER
- MEDIAN BARRIER WITH MARKING LIGHTS
- TRAFFIC OR PEDESTRIAN SIGNAL
- ROAD WORK AHEAD
- EXIT
- SHIFTING TAPER
- TRANSVERSE BARBER
- OFF-RAMP TO CENTERVILLE ROAD
- STATE HIGHWAY LINE
- STATE HIGHWAY LINE

NO.	DATE	BY	REVISION
1	08/27/10	BRD-CBB3(001)	
2	09/10/10		
3	09/10/10		
4	09/10/10		
5	09/10/10		
6	09/10/10		
7	09/10/10		
8	09/10/10		
9	09/10/10		
10	09/10/10		
11	09/10/10		
12	09/10/10		
13	09/10/10		
14	09/10/10		
15	09/10/10		

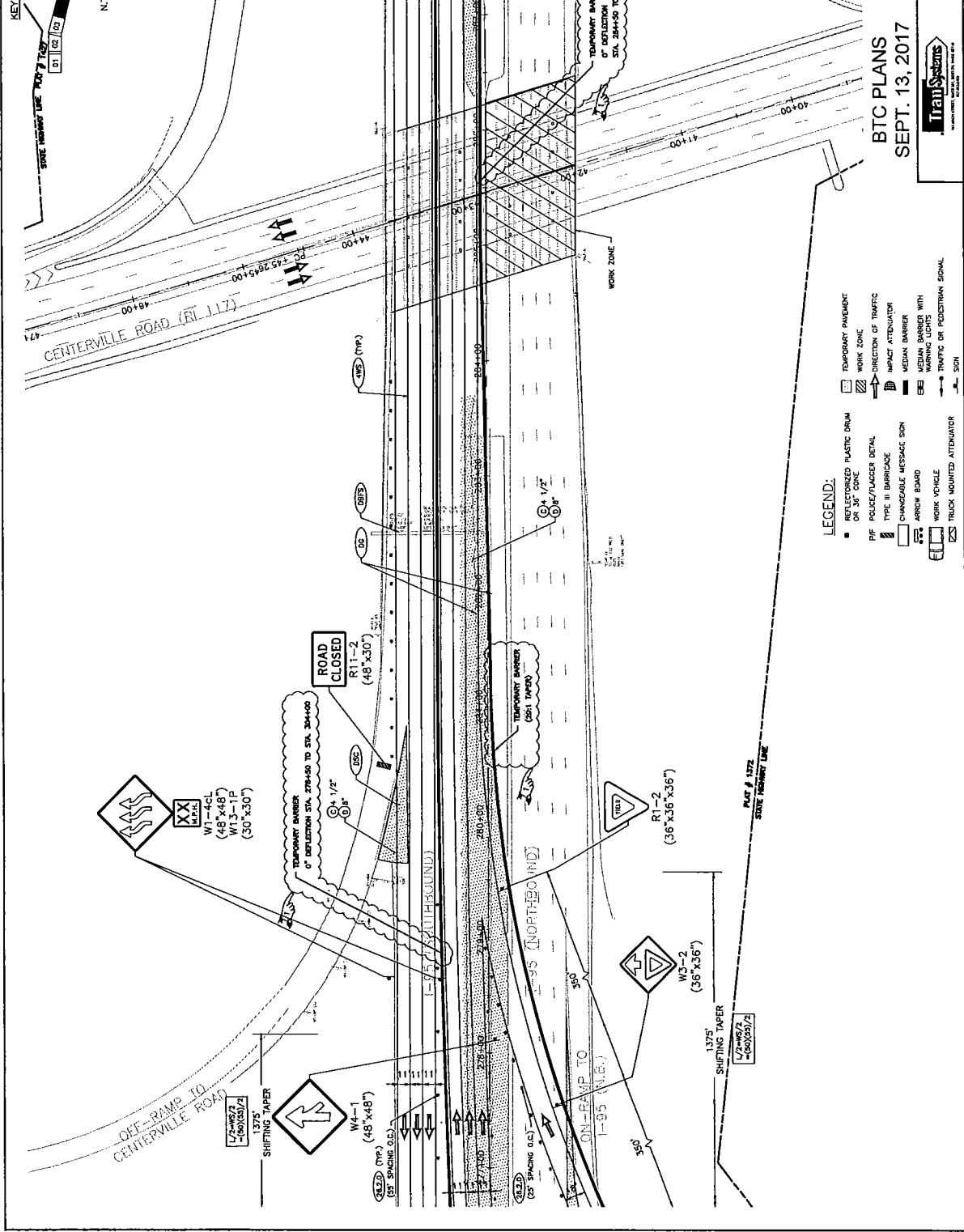
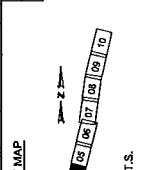

- LEGEND:**
- REFLECTORIZED PLASTIC DRUM
  - REFLECTORIZED PLASTIC DRUM
  - P/F POLICE/FLASHER DETAIL
  - TYPE II BARRIAGE
  - CHANGEABLE MESSAGE SIGN
  - ARROW BOARD
  - WORK VEHICLE
  - TRUCK MOUNTED ATTENUATOR
  - TEMPORARY PAVEMENT
  - WORK ZONE
  - DIRECTION OF TRAFFIC
  - IMPACT ATTENUATOR
  - MEDIAN BARRIER
  - MEDIAN BARRIER WITH WARNING LIGHTS
  - TRAFFIC OR PEDESTRIAN SIGNAL
  - TEMPORARY BARRIER OF DEFLECTION
  - TYPE II BARRIAGE
  - CHANGEABLE MESSAGE SIGN
  - ARROW BOARD
  - WORK VEHICLE
  - TRUCK MOUNTED ATTENUATOR

NO.	DATE	BY	REVISION
1	08/27/10	BRD-CBB3(001)	
2	09/10/10		
3	09/10/10		
4	09/10/10		
5	09/10/10		
6	09/10/10		
7	09/10/10		
8	09/10/10		
9	09/10/10		
10	09/10/10		
11	09/10/10		
12	09/10/10		
13	09/10/10		
14	09/10/10		
15	09/10/10		

RHODE ISLAND  
 DEPARTMENT OF TRANSPORTATION  
 SUPERSTRUCTURE REPLACEMENT  
 BRIDGE NOS. 683 & 684  
 WARWICK RHODE ISLAND  
 TRAFFIC CONTROL STAGE 1  
 SHEET 4 OF 10  
 CHECKED BY \_\_\_\_\_ DATE \_\_\_\_\_ SCALE 1" = 40'

**BTC PLANS**  
**SEPT. 13, 2017**



0114P-317-354-684-CONTROL

REV.	DATE	BY	DESCRIPTION
01	02/03/14	BR	BRIDGE NO. 683 & 684
02	03/04/14	BR	BRIDGE NO. 683 & 684
03	07/08/15	BR	BRIDGE NO. 683 & 684
04	07/08/15	BR	BRIDGE NO. 683 & 684
05	07/08/15	BR	BRIDGE NO. 683 & 684
06	07/08/15	BR	BRIDGE NO. 683 & 684
07	07/08/15	BR	BRIDGE NO. 683 & 684
08	07/08/15	BR	BRIDGE NO. 683 & 684
09	07/08/15	BR	BRIDGE NO. 683 & 684
10	07/08/15	BR	BRIDGE NO. 683 & 684

KEY MAP

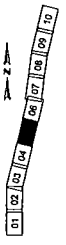

N.T.S.

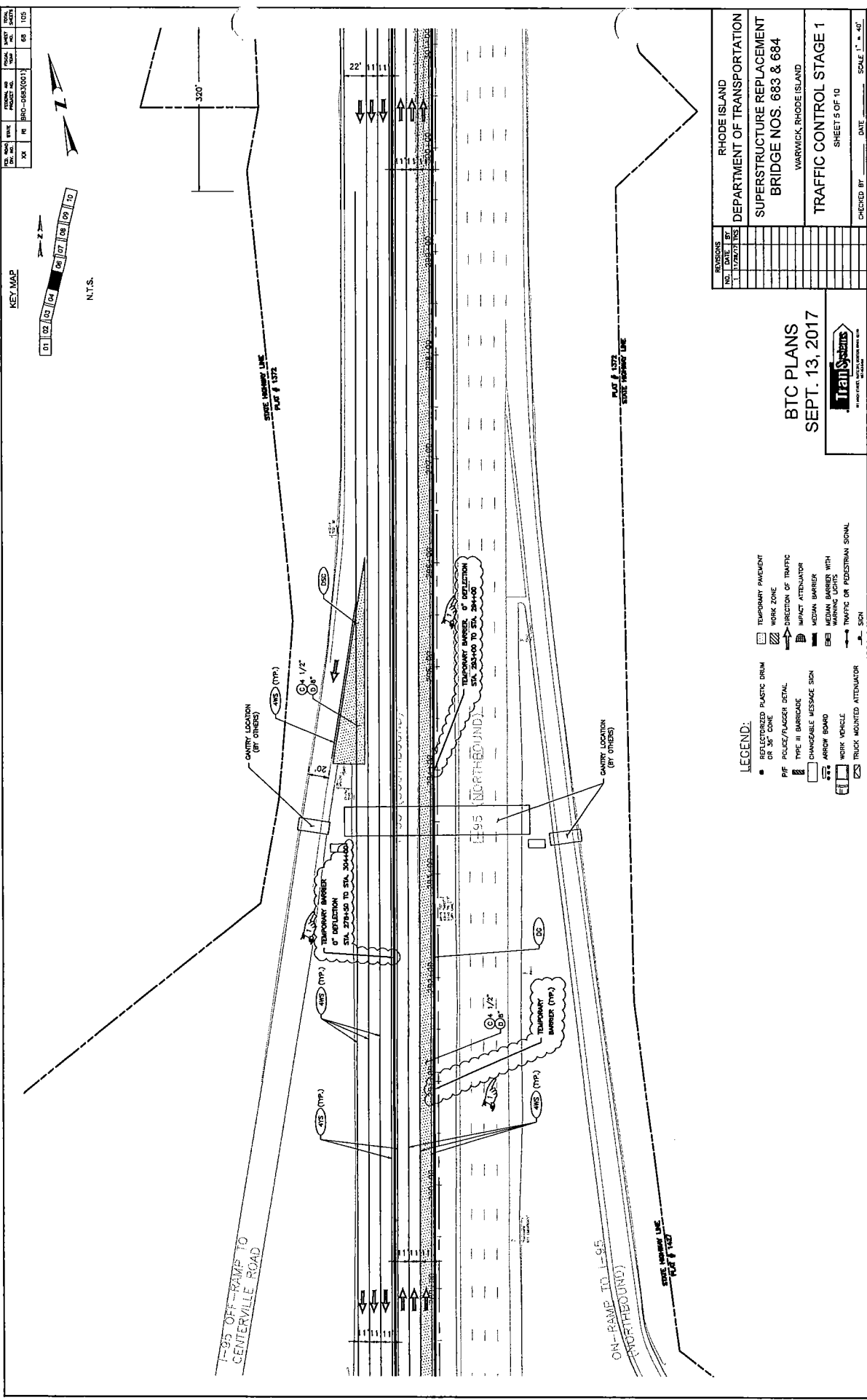

REV.	DATE	BY	DESCRIPTION
01	02/03/14	BR	BRIDGE NO. 683 & 684
02	03/04/14	BR	BRIDGE NO. 683 & 684
03	07/08/15	BR	BRIDGE NO. 683 & 684
04	07/08/15	BR	BRIDGE NO. 683 & 684
05	07/08/15	BR	BRIDGE NO. 683 & 684
06	07/08/15	BR	BRIDGE NO. 683 & 684
07	07/08/15	BR	BRIDGE NO. 683 & 684
08	07/08/15	BR	BRIDGE NO. 683 & 684
09	07/08/15	BR	BRIDGE NO. 683 & 684
10	07/08/15	BR	BRIDGE NO. 683 & 684

RHODE ISLAND  
DEPARTMENT OF TRANSPORTATION  
SUPERSTRUCTURE REPLACEMENT  
BRIDGE NOS. 683 & 684  
WARWICK, RHODE ISLAND  
TRAFFIC CONTROL STAGE 1  
SHEET 5 OF 10  
CHECKED BY: \_\_\_\_\_ DATE: \_\_\_\_\_ SCALE: 1" = 40'

BTC PLANS  
SEPT. 13, 2017



- LEGEND:**
- REFLECTORIZED PLASTIC DRUM
  - PL POLICE/FLORGER SIGNAL
  - TYPE II BARRIAGE
  - CHANGEABLE MESSAGE SIGN
  - ARROW BOARD
  - WORK VEHICLE
  - TRUCK MOUNTED ATTENUATOR
  - TEMPORARY PAVEMENT
  - WORK ZONE
  - DIRECTION OF TRAFFIC
  - IMPACT ATTENUATOR
  - MEDIAN BARRIER
  - MEDIAN BARRIER WITH WARNING LIGHTS
  - TRAFFIC OR PEDESTRIAN SIGNAL
  - SN
  - DEFLECTOR
  - TYPE III BARRIAGE
  - ARROW BOARD
  - WORK VEHICLE
  - TRUCK MOUNTED ATTENUATOR
  - TEMPORARY PAVEMENT
  - WORK ZONE
  - DIRECTION OF TRAFFIC
  - IMPACT ATTENUATOR
  - MEDIAN BARRIER
  - MEDIAN BARRIER WITH WARNING LIGHTS
  - TRAFFIC OR PEDESTRIAN SIGNAL
  - SN

NO.	DATE	BY	PROJECT NO.	SHEET NO.	TOTAL SHEETS
68				68	105

KEY MAP

DATE: 01 02 03 04 05 06 07 08 09 10

N.T.S.

SOLE MORTARY LINE  
PAGE # 1772

1320'  
SUPERSTAGE AND  
MERGING PAPER

134' 2" - 885' 45.2"  
- (13) (66) - (24) (86) / 2

SOLE MORTARY LINE  
PAGE # 1713

320'

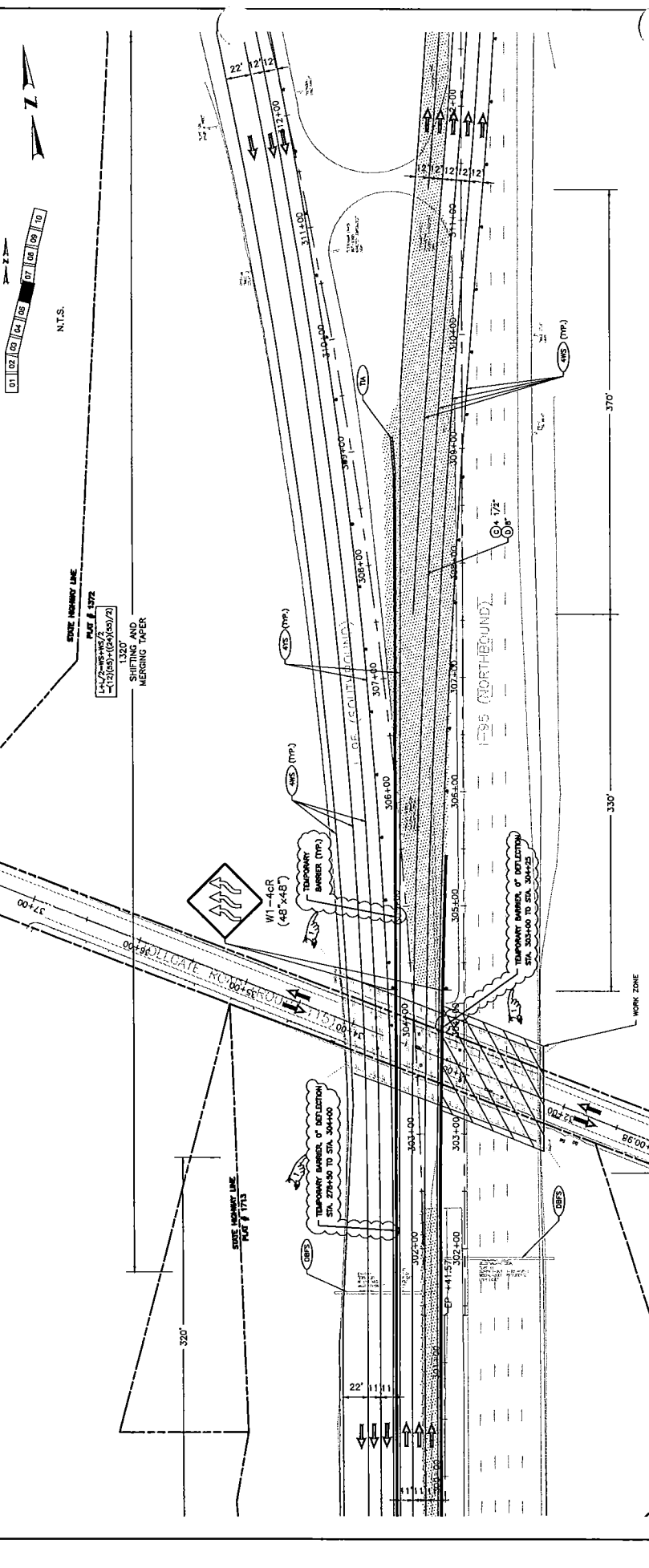

1989'  
SHEETS 1-10  
PAGE # 572  
SOLE MORTARY LINE

1989'  
SHEETS 1-10  
PAGE # 572  
SOLE MORTARY LINE

1989'  
SHEETS 1-10  
PAGE # 572  
SOLE MORTARY LINE

1989'  
SHEETS 1-10  
PAGE # 572  
SOLE MORTARY LINE

1989'  
SHEETS 1-10  
PAGE # 572  
SOLE MORTARY LINE

REVISIONS

NO.	DATE	BY	DESCRIPTION

NOTE:  
1. FOR TRAFFIC CONTROL PLANS INVOLVING TOLL GATE ROAD  
SEE TRAFFIC DETAILS.

RHODE ISLAND  
DEPARTMENT OF TRANSPORTATION  
SUPERSTRUCTURE REPLACEMENT  
BRIDGE NOS. 683 & 684  
WARWICK, RHODE ISLAND  
TRAFFIC CONTROL STAGE 1  
SHEET 6 OF 10

BTC PLANS  
SEPT. 13, 2017

TrainSystems  
TRANSPORTATION SOFTWARE

CHECKED BY: \_\_\_\_\_ DATE: \_\_\_\_\_ SCALE 1" = 40'

LEGEND:

- REFLECTORIZED PLASTIC DIBOL
- OR PLASTIC DIBOL
- P/F POLICE/FLAGER DETAIL
- TYPE II BARRIAGE
- CHANGABLE MESSAGE SIGN
- ARROW BOARD
- WORK VEHICLE
- TRUCK MOUNTED ATTENUATOR
- TEMPORARY PAINTMENT
- WORK ZONE
- DIRECTION OF TRAFFIC
- IMPACT ATTENUATOR
- MEDIAN BARRIER
- MEDIAN BARRIER WITH WARNING LIGHTS
- TRAFFIC OR PEDESTRIAN SIGNAL
- SIGN

SOLE MORTARY LINE  
PAGE # 572





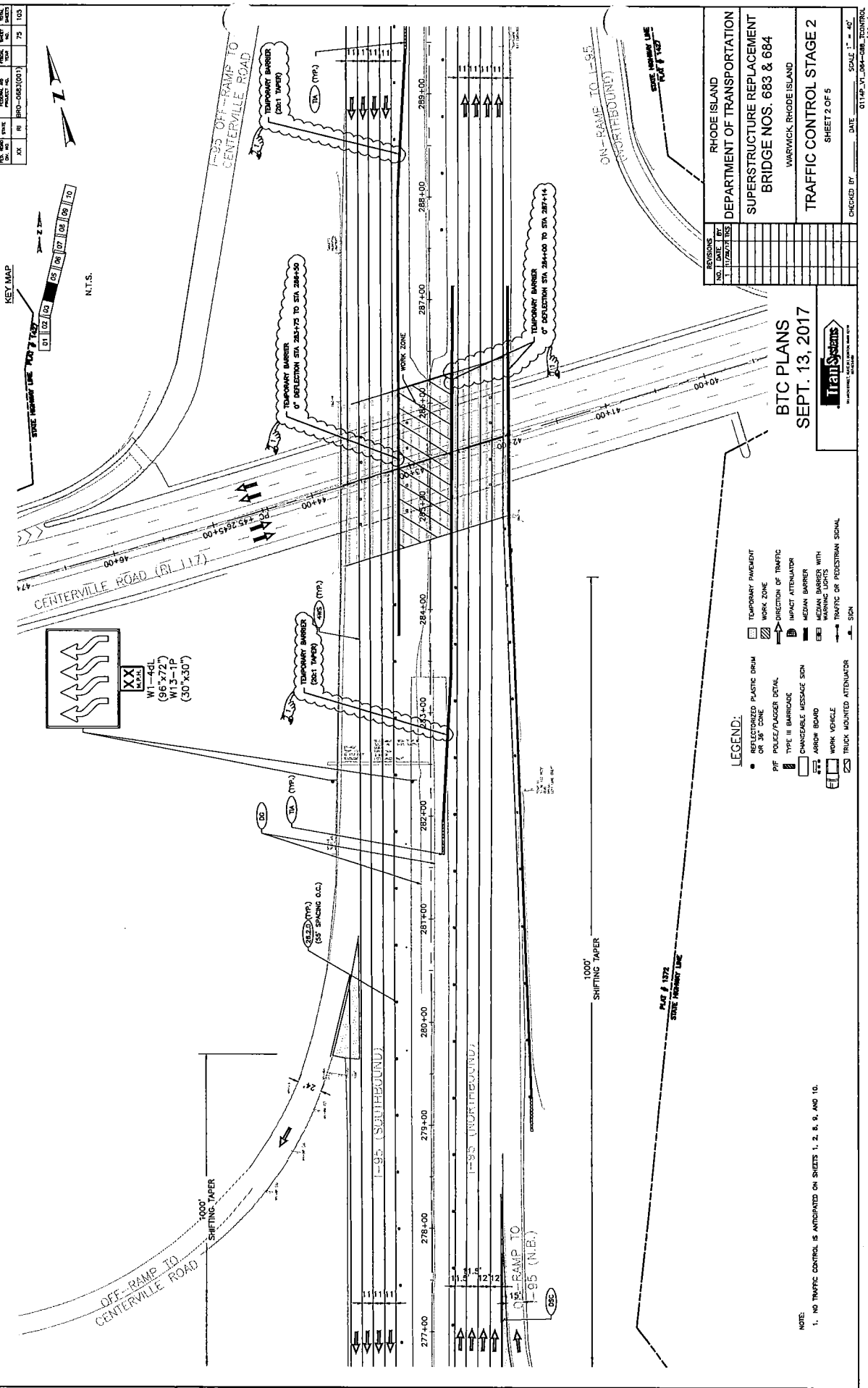
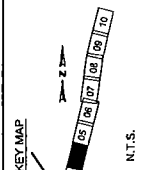

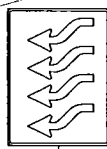





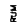

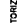
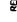

REV.	DATE	BY	DESCRIPTION
01	02/10/15		
02	02/10/15		
03	02/10/15		
04	02/10/15		
05	02/10/15		
06	02/10/15		
07	02/10/15		
08	02/10/15		
09	02/10/15		
10	02/10/15		



  
**XX** MARK
   
 W1-4dL
   
 (96' x 72')
   
 W13-1P
   
 (30' x 30')

RHODE ISLAND	
DEPARTMENT OF TRANSPORTATION	
SUPERSTRUCTURE REPLACEMENT	
BRIDGE NOS. 683 & 684	
WARWICK, RHODE ISLAND	
TRAFFIC CONTROL STAGE 2	
SHEET 2 OF 5	
REVISED BY	DATE
01	10/26/15

**BTC PLANS**  
**SEPT. 13, 2017**  

- LEGEND:**
-  REFLECTORIZED PLASTIC DRUM ON 3/4" CONC.
  -  P/F POLICE/TRUCKER DETAIL
  -  TYPE III BARRIAGE
  -  CHANGEABLE MESSAGE SIGN
  -  ARROW BOARD
  -  WORK VEHICLE
  -  TRUCK MOUNTED ATTENUATOR
  -  TEMPORARY PAVEMENT
  -  WORK ZONE
  -  DIRECTION OF TRAFFIC
  -  IMPACT ATTENUATOR
  -  MEDIAN BARRIER
  -  TEMPORARY BARRIER (BAY TURNER)
  -  MEDIAN BARRIER WITH WARNING LIGHTS
  -  TRAFFIC OR PEDESTRIAN SIGNAL
  -  SIGN

NOTE:  
 1. NO TRAFFIC CONTROL IS ANTICIPATED ON SHEETS 1, 2, 3, 4, 5, 9, AND 10.

NO.	DATE	BY	REVISIONS
01	02	04	06
07	08	09	10
11	12	13	14
15	16	17	18
19	20	21	22
23	24	25	26
27	28	29	30
31	32	33	34
35	36	37	38
39	40	41	42
43	44	45	46
47	48	49	50
51	52	53	54
55	56	57	58
59	60	61	62
63	64	65	66
67	68	69	70
71	72	73	74
75	76	77	78
79	80	81	82
83	84	85	86
87	88	89	90
91	92	93	94
95	96	97	98
99	100	101	102

KEY MAP



N.T.S.

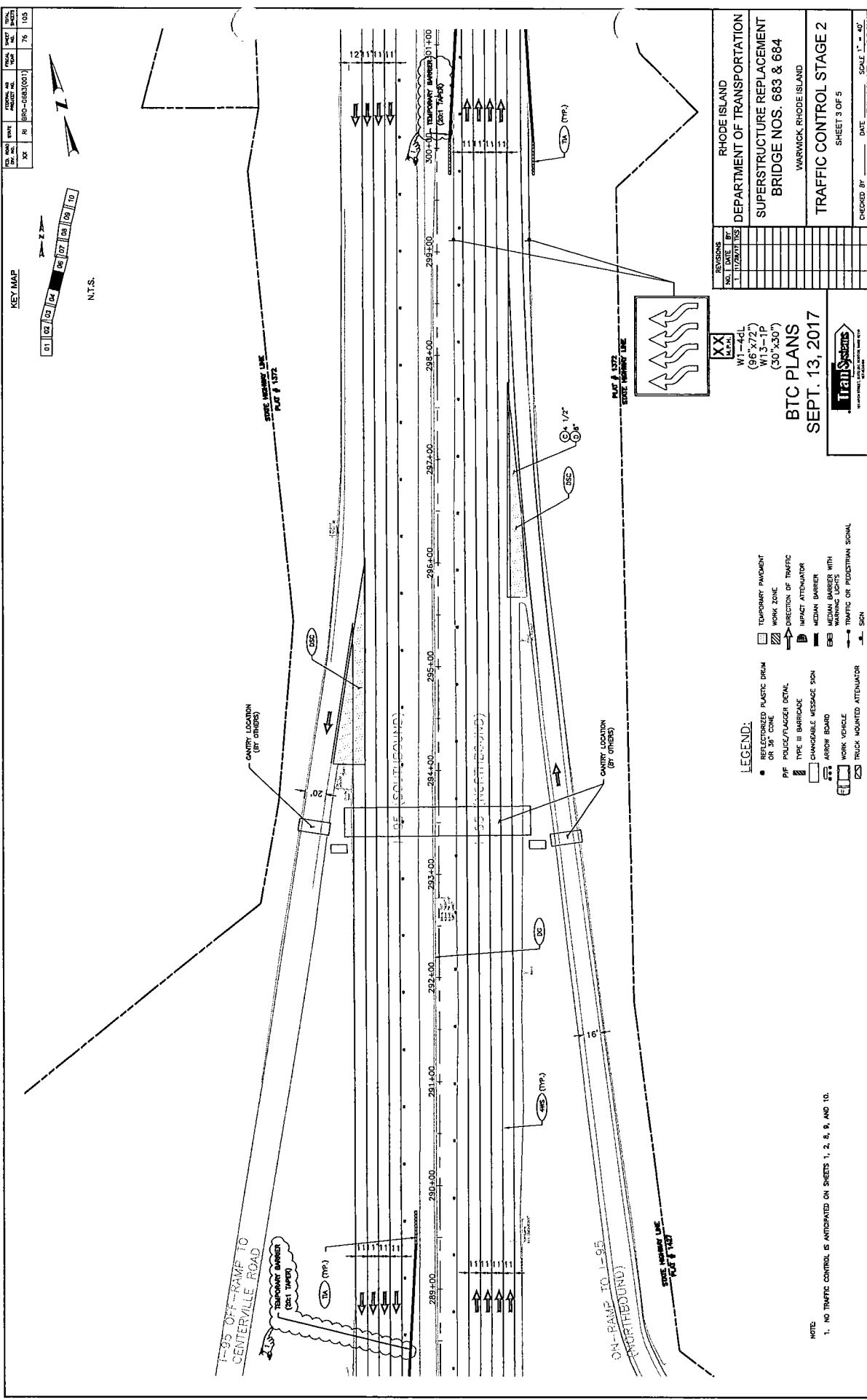

NO.	DATE	BY	REVISIONS
01	02	04	06
07	08	09	10
11	12	13	14
15	16	17	18
19	20	21	22
23	24	25	26
27	28	29	30
31	32	33	34
35	36	37	38
39	40	41	42
43	44	45	46
47	48	49	50
51	52	53	54
55	56	57	58
59	60	61	62
63	64	65	66
67	68	69	70
71	72	73	74
75	76	77	78
79	80	81	82
83	84	85	86
87	88	89	90
91	92	93	94
95	96	97	98
99	100	101	102

RHODE ISLAND  
DEPARTMENT OF TRANSPORTATION  
SUPERSTRUCTURE REPLACEMENT  
BRIDGE NOS. 683 & 684  
WARWICK RHODE ISLAND  
TRAFFIC CONTROL STAGE 2  
SHEET 3 OF 5  
CHECKED BY \_\_\_\_\_ DATE \_\_\_\_\_ SCALE 1" = 40'

XX  
W1-4GL  
(96'x72')  
W13-TP  
(30'x30')

**BTC PLANS**  
SEPT. 13, 2017

- LEGEND:**
- REFLECTORIZED PLASTIC DEGM OR 3/8" CONE
  - P/F POLICE/LAGGER DEFL
  - TYPE III BARRICADE
  - CHANGEABLE MESSAGE SIGN
  - ARROW BOARD
  - WORK VEHICLE
  - TRUCK MOUNTED ATTENUATOR
  - TEMPORARY PAVEMENT
  - WORK ZONE
  - DIRECTION OF TRAFFIC
  - IMPACT ATTENUATOR
  - MEDIAN BARRIER
  - LEGIAN BARRIER WITH WARNING LIGHTS
  - TRAFFIC OR PEDESTRIAN SIGNAL
  - SON

NOTE:  
1. NO TRAFFIC CONTROL IS ANTICIPATED ON SHEETS 1, 2, 4, 9, AND 10.

REV.	DATE	BY	DESCRIPTION				
01	02/03	04	05	07	08	09	10
02	03	04	05	07	08	09	10
03	04	05	07	08	09	10	
04	05	07	08	09	10		
05	07	08	09	10			
06	07	08	09	10			
07	08	09	10				
08	09	10					
09	10						
10							

KEY MAP  
 STATE HIGHWAY LINE  
 PLAT # 1372

STATE HIGHWAY LINE  
 PLAT # 1372

STATE HIGHWAY LINE  
 PLAT # 1372

STATE HIGHWAY LINE  
 PLAT # 1372

STATE HIGHWAY LINE  
 PLAT # 1372

STATE HIGHWAY LINE  
 PLAT # 1372

STATE HIGHWAY LINE  
 PLAT # 1372

STATE HIGHWAY LINE  
 PLAT # 1372

STATE HIGHWAY LINE  
 PLAT # 1372

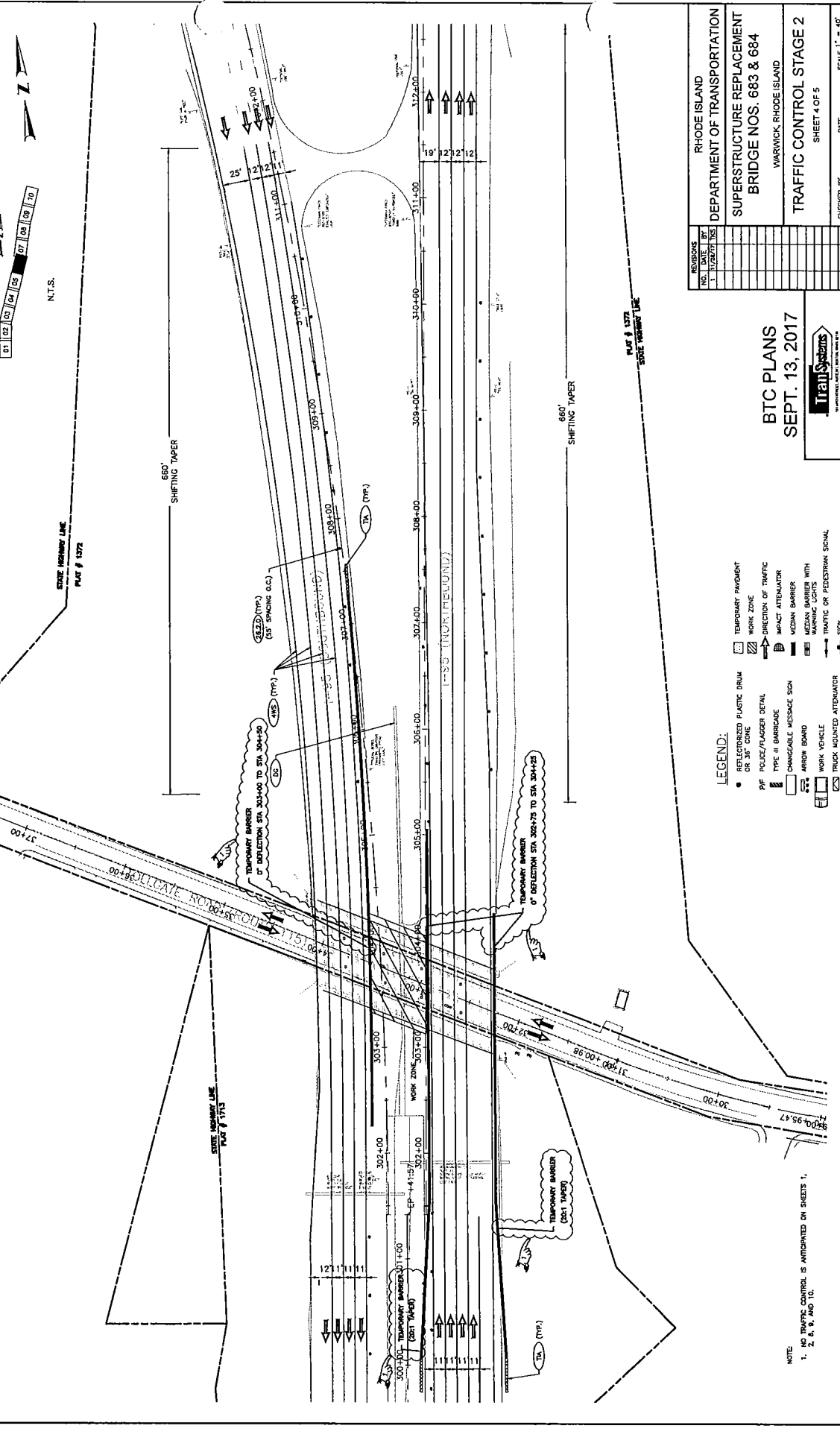

KEY MAP  
 STATE HIGHWAY LINE  
 PLAT # 1372

STATE HIGHWAY LINE  
 PLAT # 1372

STATE HIGHWAY LINE  
 PLAT # 1372

STATE HIGHWAY LINE  
 PLAT # 1372

STATE HIGHWAY LINE  
 PLAT # 1372

STATE HIGHWAY LINE  
 PLAT # 1372

STATE HIGHWAY LINE  
 PLAT # 1372

STATE HIGHWAY LINE  
 PLAT # 1372

STATE HIGHWAY LINE  
 PLAT # 1372

REVISIONS	NO.	DATE	BY	DESCRIPTION				
	1	02/03	04	05	07	08	09	10
	2	03	04	05	07	08	09	10
	3	04	05	07	08	09	10	
	4	05	07	08	09	10		
	5	07	08	09	10			
	6	08	09	10				
	7	09	10					
	8	10						
	9							
	10							

RHODE ISLAND  
 DEPARTMENT OF TRANSPORTATION  
 SUPERSTRUCTURE REPLACEMENT  
 BRIDGE NOS. 683 & 684  
 WARWICK, RHODE ISLAND

BTC PLANS  
 SEPT. 13, 2017

TRAFFIC CONTROL STAGE 2  
 SHEET 4 OF 5

CHECKED BY: \_\_\_\_\_ DATE: \_\_\_\_\_ SCALE: 1" = 40'

0174P-01, 024-08, CONTROL

LEGEND:  
 REFLECTORIZED PLASTIC DRUM ON 3/4" SIGN  
 POLICE/VAGNER DETAIL  
 TYPE II BARRICADE  
 CHANGEABLE MESSAGE SIGN  
 ARROW BOARD  
 WORK VEHICLE  
 TRUCK MOUNTED ATTENUATOR

NOTE:  
 1. NO TRAFFIC CONTROL IS ANTICIPATED ON SHEETS 1, 2, 8, 9, AND 10.

NO.	DATE	BY	REVISION
82	10/10/10	JK	REVISED
103	10/10/10	JK	REVISED

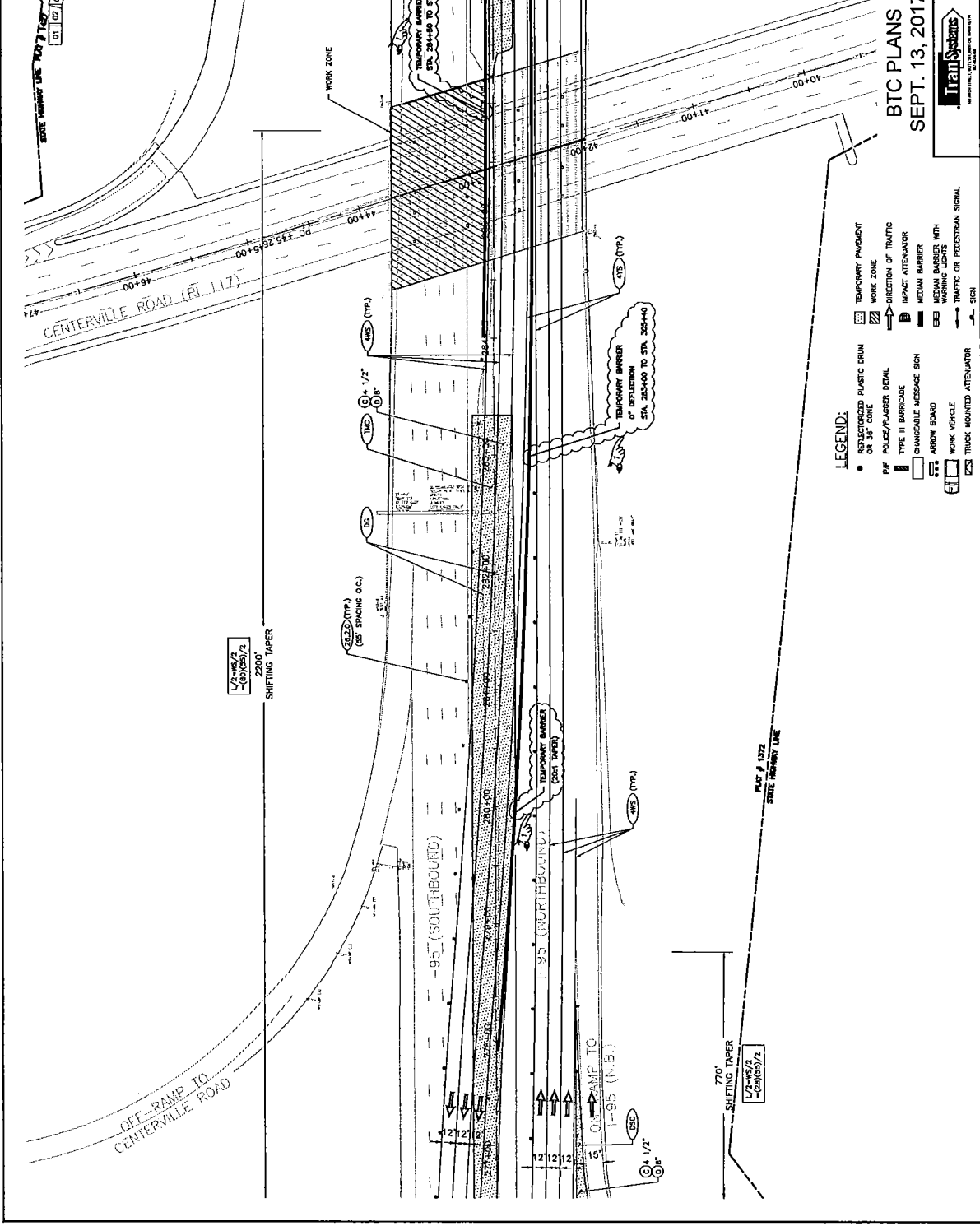
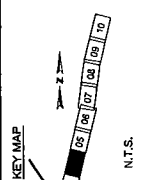

NOTE:  
1. FOR TRAFFIC CONTROL PLANS INVOLVING CENTERVILLE ROAD SEE TRAFFIC DETAILS.

REVISIONS	NO.	DATE	BY	REVISION

RHODE ISLAND  
DEPARTMENT OF TRANSPORTATION  
SUPERSTRUCTURE REPLACEMENT  
BRIDGE NOS. 683 & 684  
WARWICK, RHODE ISLAND  
TRAFFIC CONTROL STAGE 3  
SHEET 4 OF 10

CHIEF ENGINEER: \_\_\_\_\_  
DATE: \_\_\_\_\_  
SCALE: 1" = 40'

BTC PLANS  
SEPT. 13, 2017

LEGEND:

- RESURFACED PAVEMENT
- TEMPORARY PAVEMENT
- WORK ZONE
- TYPE II BARRIAGE
- IMPACT ATTENUATOR
- CHANGEABLE MESSAGE SIGN
- ARROW BOARD
- WORK VEHICLE
- TRUCK MOUNTED ATTENUATOR
- TEMPORARY BARRIER
- WORK ZONE
- DIRECTION OF TRAFFIC
- IMPACT ATTENUATOR
- MEDIAN BARRIER
- TRAFFIC OR PEDESTRIAN SIGNAL
- TRUCK MOUNTED ATTENUATOR
- SIGN



SEPT. 13, 2017

TRAFFIC CONTROL STAGE 3

BRIDGE NOS. 683 & 684

WARWICK, RHODE ISLAND

DEPARTMENT OF TRANSPORTATION

RHODE ISLAND

SCALE: 1" = 40'

DATE: \_\_\_\_\_

NO.	DATE	BY	REVISION
01	02/04		
02	03/04		
03	07/08		
04	08/10		
05	09/10		
06	08/10		
07	08/10		
08	08/10		
09	08/10		
10	08/10		
11	08/10		
12	08/10		
13	08/10		
14	08/10		
15	08/10		

KEY MAP



N.T.S.

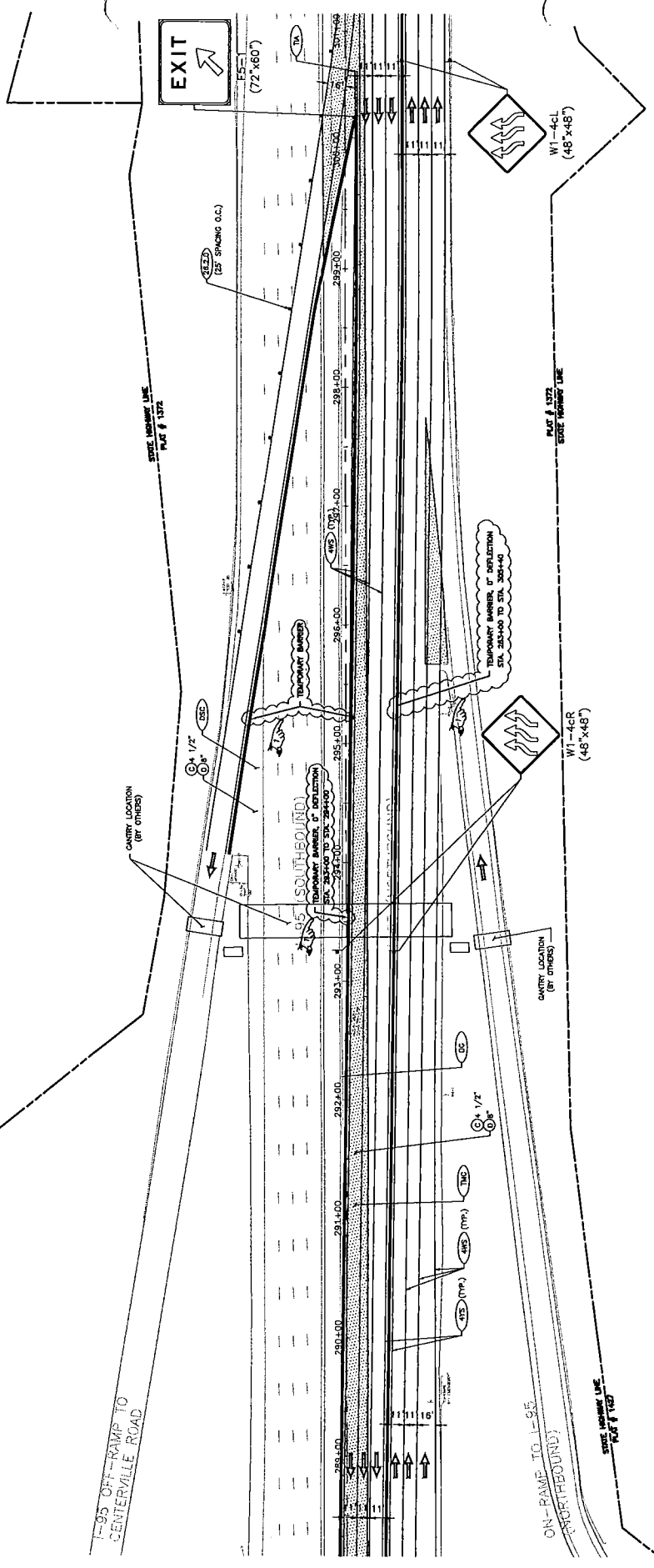

REVISIONS	
NO.	DATE
1	02/20/10

RHODE ISLAND  
DEPARTMENT OF TRANSPORTATION  
SUPERSTRUCTURE REPLACEMENT  
BRIDGE NOS. 683 & 684  
WARWICK, RHODE ISLAND  
TRAFFIC CONTROL STAGE 3  
SHEET 5 OF 10  
CHECKED BY: \_\_\_\_\_ DATE: \_\_\_\_\_ SCALE: 1" = 40'  
DATE: 01/14/10 BY: JRM-CBB-CON/CONTROL

BTC PLANS  
SEPT. 13, 2017



- LEGEND:**
- REFLECTORIZED PLASTIC DRUM
  - ORANGE WORK ZONE
  - P/F POLICE/FLASHER SIGNAL
  - TYPE III BARRIQUADE
  - CHANGEABLE MESSAGE SIGN
  - ARROW BOARD
  - WORK VEHICLE
  - TRUCK MOUNTED ATTENUATOR
  - TEMPORARY AVISMENT
  - WORK ZONE
  - DIRECTION OF TRAFFIC
  - IMPACT ATTENUATOR
  - MEDIAN BARRIER
  - MEDIAN BARRIER WITH WARNING LIGHTS
  - TRUCK MOUNTED ATTENUATOR
  - WORK VEHICLE
  - TRUCK MOUNTED ATTENUATOR

NO.	DATE	BY	PROJECT NO.	SHEET NO.
01	02/03/07	BR	BRC-0883(001)	84
02	02/03/07	BR	BRC-0883(001)	84
03	02/03/07	BR	BRC-0883(001)	84
04	02/03/07	BR	BRC-0883(001)	84
05	02/03/07	BR	BRC-0883(001)	84

**KEY MAP**

STATE HIGHWAY LINE  
PLAT # 1322

STATE HIGHWAY LINE  
PLAT # 1713

EXIT (72'x60')

EXIT OPEN ES-2 (48'x36')

1/2"MS/2" (50)(50/2) SHIFTING TAPER

1/2"MS/2" (50)(50/2) SHIFTING TAPER

W1-461 (48'x48')

1/2"MS/2" (50)(50/2) SHIFTING TAPER

TEMPORARY BARRIER OF DEFLECTION STA. 304+00 TO STA. 304+20

TEMPORARY BARRIER OF DEFLECTION STA. 304+00 TO STA. 304+40

1/2"MS/2" (50)(50/2) SHIFTING TAPER

TEMPORARY BARRIER OF DEFLECTION STA. 304+00 TO STA. 304+40

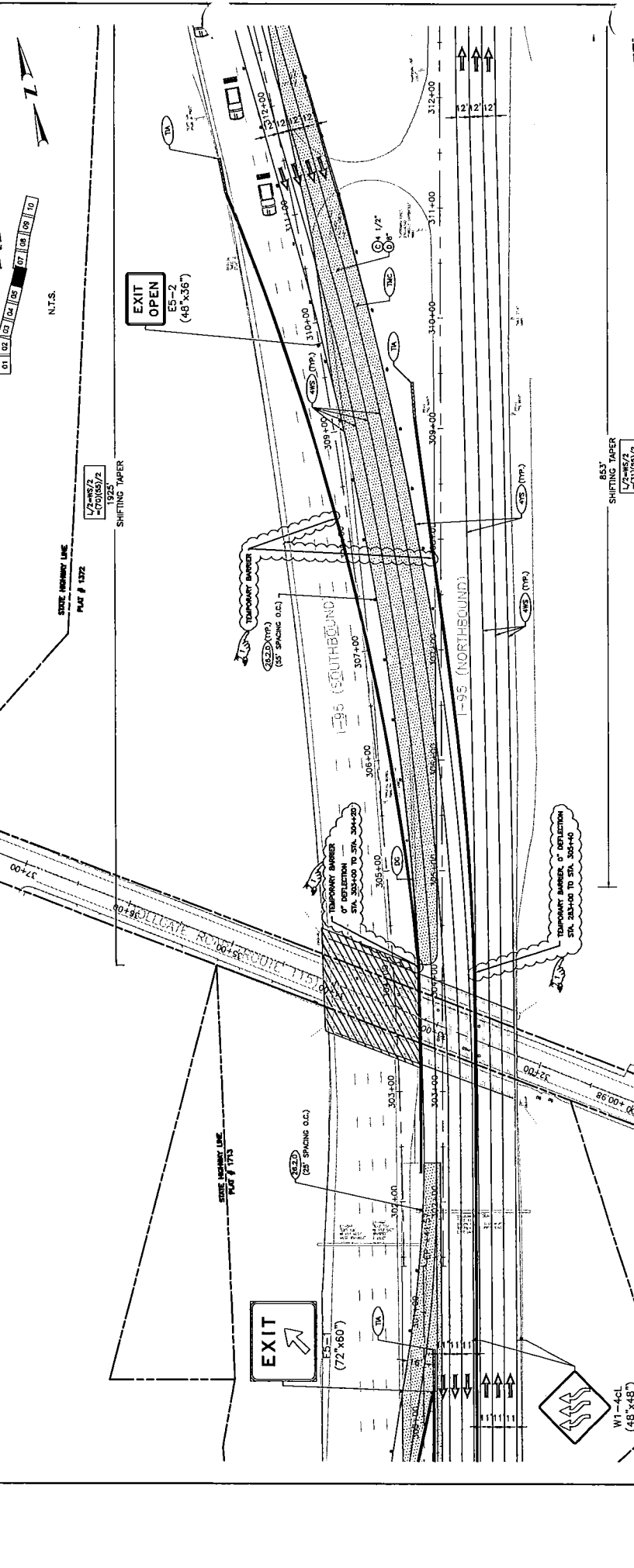

**NOTE:**  
1. FOR TRAFFIC CONTROL PLANS INVOLVING TOLL GATE ROAD SEE TRAFFIC DETAILS.

1/2"MS/2" (50)(50/2) SHIFTING TAPER

1/2"MS/2" (50)(50/2) SHIFTING TAPER

1/2"MS/2" (50)(50/2) SHIFTING TAPER

1/2"MS/2" (50)(50/2) SHIFTING TAPER

1/2"MS/2" (50)(50/2) SHIFTING TAPER

1/2"MS/2" (50)(50/2) SHIFTING TAPER

1/2"MS/2" (50)(50/2) SHIFTING TAPER

1/2"MS/2" (50)(50/2) SHIFTING TAPER

1/2"MS/2" (50)(50/2) SHIFTING TAPER

NO.	DATE	BY	REVISIONS

RHODE ISLAND  
DEPARTMENT OF TRANSPORTATION  
SUPERSTRUCTURE REPLACEMENT  
BRIDGE NOS. 683 & 684  
VARIWICK RHODE ISLAND  
TRAFFIC CONTROL STAGE 3  
SHEET 6 OF 10

SCALE 1" = 40'

CHECKED BY: \_\_\_\_\_ DATE: \_\_\_\_\_

**LEGEND:**

- TEMPORARY PAVERS
- WORK ZONE
- DIRECTION OF TRAFFIC
- IMPACT ATTENUATOR
- MEDIAN BARRIER
- MEDIAN BARRIER WITH WARNING LIGHTS
- TRAFFIC OR PEDESTRIAN SIGNAL
- TRUCK MOUNTED ATTENUATOR
- WORK VEHICLE
- CHANGEBLE MESSAGE SIGN
- ARROW BOARD
- TYPE 11 BARRICADE
- POLICE/FLOODED DETAIL
- REFLECTORIZED PLASTIC DRAW OR 3" SIGN

**BTC PLANS**  
SEPT. 13, 2017

STATE HIGHWAY LINE  
PLAT # 1322

STATE HIGHWAY LINE  
PLAT # 1713

STATE HIGHWAY LINE  
PLAT # 1322

STATE HIGHWAY LINE  
PLAT # 1713

**Job Specific Provision**  
**SECTION 108.1000**  
**PROSECUTION AND PROGRESS**

**Subsection 108.08; Failure to Complete on Time**

**Part a. Phased Completion, Interim Completion and Substantial Completion**

The Job Specific Substantial Completion date shall be taken as that given by this RFP, Part A - Instructions to Respondents, under Section 2.3 - Project Milestone Schedule.

Rates for Liquidated Damages associated with the above Substantial Completion date will be as follows:

- \* \$2,700 per day (Calendar Day or Fixed Date basis)
- \* \$3,700 per day (Work Day basis)

# DBE Letter of Intent to Perform

PROJECT:

NAME OF PROPOSER: \_\_\_\_\_

FROM: \_\_\_\_\_  
(Disadvantaged Business Enterprise)

TO: \_\_\_\_\_  
(Name of Contractor)

1. My company is currently certified as a Disadvantaged Business Enterprise (DBE) by the state of Rhode Island. There have been no changes affecting the ownership, control or independence of my company since my last certification review.
2. If any such change occurs prior to my company's completion of this proposed work, I will give written notification to your firm and RIDOT.
3. My firm will provide to you, upon request, for the purpose of obtaining subcontractor approval: (a) a resume stating the qualifications and experience of the superintendent or foreperson who will supervise on-site work; (b) a list of equipment owned or leased by my firm for use on the project; and (c) a list of all projects (public or private) which my firm is currently performing, is committed to perform, or intends to make a commitment to perform. I shall include for each project the names and telephone number of a contact person for the contracting organization, the dollar value of the work, a description of the work, and my firm's work schedule for the project.
4. If you are awarded the contract, my company intends to enter into an agreement with your firm to perform the items of work or other activity described on the following sheet for the prices indicated.
5. My firm has the ability to manage, supervise and perform the activity described on the following page.

\_\_\_\_\_  
DBE Signature

\_\_\_\_\_  
Date



## Schedule of Participation by Disadvantaged Business Enterprises (DBE)

PROJECT: \_\_\_\_\_

BID NO.: \_\_\_\_\_

NAME OF PROPOSER: \_\_\_\_\_

Name, Address, and Phone Number of DBE	Name of Activity	DBE Contractor Activity Percent	Total Percent Eligible for Credit

**DBE Percentage Total: \_\_\_\_\_%**

SIGNATURE: \_\_\_\_\_ DATE: \_\_\_\_\_ TEL. NO.: \_\_\_\_\_

NAME AND TITLE (PRINT): \_\_\_\_\_