

State of Rhode Island



Department of Administration
Division of Purchases
One Capitol Hill
Providence, RI 02908

**REQUEST FOR QUOTE (RFQ) - Bid #7464395
RHODE ISLAND STATE POLICE HEADQUARTERS PARKING IMPROVEMENTS**

**ADDENDUM #4
May 31, 2013**

SUBMISSION DEADLINE: Thursday, June 13, 2013 at 2:00 PM (EDT)

PRE-BID CONFERENCE: NO

QUESTIONS: Question periods concerning this solicitation have expired. Questions received were answered and posted on the Internet as Addendum 2 to this solicitation. It is the responsibility of all interested parties to download this information.

SURETY REQUIRED: YES

BOND REQUIRED: YES, FIVE PERCENT (5%)

PUBLIC COPY (R.I. Gen. Laws 37-2-18(j): NO - This requirement applies to all public works projects (vertical and horizontal) exceeding Five Hundred Thousand (\$500,000) dollars and any combination of base bid plus all alternates.

DISK BASED BID: YES (See attached Disk Based Bidding Information)

NOTE TO VENDORS:

Vendors must register on-line at the Rhode Island Division of Purchases website at www.purchasing.ri.gov. Offers received without the completed four-page Rhode Island Vendor Information Program (RIVIP) Generated Bidder Certification Cover Form attached may result in disqualification.

**George Welly
Interdepartmental Project Manager**

THIS IS NOT A BIDDER CERTIFICATION FORM



ADDENDUM #4 (continued)

Disk Based Bidding Information

File Format

All disk based bid files are ZIP files that you can open using the WinZip 8.1 software. The ZIP file will contain one or more files based on the type of Bid/RPF.

Downloading the Disk Based Bid

Bids that have a file for download are marked with a "D" in the Info field of the bid search results. The "D" will be an active link to the WinZip file until the bid reaches its opening date. Clicking on the active "D" link will allow you to open or save the ZIP file associated with the bid. Opening the WinZip file will download a copy to your computer's temporary directory.

Opening the Disk Based Bid

Once downloaded, you can open the ZIP file with WinZip and view the Microsoft Office files contained within the WinZip file. Immediately save (extract) the individual files to an appropriate directory on your computer, such as "Desktop" or "My Documents".

FOR THE DEPARTMENT OF TRANSPORTATION AND OTHER SPECIFIC PROJECTS:

Completing the Disk Based Bid

Once the Microsoft Office files are properly saved, open the individual files and enter the required information in the appropriate fields. Save each file again to capture the new information you entered.

Submitting the Disk Based Bid

Save the completed files to a CD or diskette. Label the CD or diskette with the Bid/RFP number and bidder's name (company name, not contract name). Submit as instructed in the Bid or RFP solicitation document.



ADDENDUM #4 (continued)

The complete set of Project Bidding Documents can be found at the State Purchasing Web Site (www.purchasing.ri.gov) **RFQ #7464395** and as follows in this Section. Potential bidders should download and read the Solicitation Information provided by the Division of Purchases in its entirety. **Note to vendors: Note that this Addendum 4 replaces the Invitation to Bid and the Solicitation Information included in the original offering. The Solicitation Information and Invitation to Bid in the original offering are hereby withdrawn. Addendum 2, included below as Exhibit A in its entirety, includes revisions to specifications, and answers to all questions received by May 16, 2013.**

Note that changes to the Project Manual compared to the original document are in Addendum 2, dated May 20, 2013, and include an Additional Specification Sections for Hot Mix Asphalt 9.5 and 12.5; notwithstanding language in these additional specifications, the answer to question 4 concerning testing for asphalt mixes prevails, and the contractor is NOT responsible for testing samples at the plant. Addendum 2, Question 2 reconfirmed that there will be no price adjustments for Liquid Asphalt or Diesel Fuel, consistent with Section 13.26 in Section 000800, page 10, Supplementary Conditions in the Project Manual; notwithstanding this language, unit prices are still required in the bid forms in order to calculate additive and deductive change orders.

Note also that all changes to the Project Plans compared to the original document are also in Addendum 2, dated May 20, 2013, in the form of Revised Site Layout Plan C2.

There are two additional revisions appearing for the first time in this Addendum 4, appearing in “ADDITIONAL INFORMATION MODIFYING SPECIFICATIONS and BID FORM” below.

Finally, note that the completion date of June 30, 2013, cited in the Bid Form, Section 000-410 of the Project Manual, on pages 6, 8 and 9 of 10 has been extended to Twenty working days from Purchase order issued by Central Purchasing.

In the event of any conflict between information in this addendum 4 and other project documents, language in the addendum shall prevail.

SCOPE OF WORK

All Labor, Material, Equipment, Services, Tools, Incidentals and Administration to complete The Rhode Island State Police Headquarters (HQ) Parking Improvements, including but is not limited to: bituminous paving and sitework, landscaping, concrete sidewalks, bituminous sidewalks, concrete work, curb installation, berm installation, pavement removal, gravel base installation, drainage work, surface restoration, re-grading, fine grading, ADA accessible ramp



ADDENDUM #4 (continued)

installation, utility adjustments, pavement markings, traffic control, traffic protection, tree removal, tree protection, signage, specialties, miscellaneous equipment, miscellaneous furnishings, and miscellaneous tasks as listed within the Plans and the Project Manual.

Complete details of the scope of work are available in:

- Project Manual - Rhode Island State Police Headquarters (HQ) Parking Improvements, as amended in addendum 2; and
- RI State Police Headquarters (HQ) Construction Plans, as amended in addendum 2.

Potential Offerers are advised to review all sections of this solicitation carefully and to follow instructions completely, as failure to make a complete submission as described elsewhere herein may result in rejection of the proposal.

ADDITIONAL INFORMATION MODIFYING SPECIFICATIONS and BID FORM:

1. Existing utilities will not be marked in the field. The contractor shall use caution when performing work in area. Damage to any existing utilities during construction will be the responsibility of the contractor to repair at no additional cost to the owner. The contractor is required to hire a utility sub-surface investigator to locate underground utilities; this additional effort should be reflected in the total lump sum base bid amount.
2. All existing language in Section 9 on page 9 of 10 of the Bid Form regarding liquidated damages should be stricken and replaced with the Following:
“Liquidated Damages: The Contractor acknowledges and recognizes that in the case of failure to meet the project completion date, the owner has the right to charge liquidated damages in the amount of \$1000.00/per day until the work is completed. The total liquidated damages will be deducted from the project final payment.”

TERMS AND CONDITIONS FOR THIS BID

RIVIP

It is the Vendor's responsibility to check and download any and all addenda from the RIVIP. This offer may not be considered unless a signed RIVIP generated Bidder Certification Cover Form is attached and the Unit Price column is completed. The signed Certification Cover Form must be attached to the front of the offer. When delivering offers in person to One Capitol Hill, vendors are advised to allow at least one hour additional time for clearance through security checkpoints.



ADDENDUM #4 (continued)

SURETY

Bidder is required to provide a bid surety in the form of a bid bond, or a certified check payable to the state of Rhode Island, in the amount of a sum not less than five percent (5%) of the bid price. Bid surety must be attached to the bid form. The successful bidder will also be required to furnish performance and labor and payment bonds at time of tentative contract award.

WAGE

Bidders are advised that all provisions of title 37 chapter 13 of the general laws of Rhode Island apply to the work covered by this request, and that payment of the general prevailing rate of per diem wages and the general prevailing rate for regular, overtime, and other working conditions existing in the locality for each craft, mechanic, teamster, or type of workman needed to execute this work is a requirement for both contractors and subcontractors. The prevailing wage table may be obtained at the Rhode Island Division of Purchases home page by internet at www.purchasing.ri.gov. Select "Bidding Information", then "General Information" and then select "Prevailing Wage Table". The State of Rhode Island uses the general decision number ri20100001. Printing the entire document averages approximately one minute per page - you may want to print only the pages applicable to your bid. Bidders note: in the event this bid specifies price offers on a time-and-materials basis, i.e., an hourly rate, any or all bids submitted in an amount less than the prevailing rate in effect for the work covered by this request as of the date of bid issuance shall be rejected by the Division of Purchases.

INSURANCE

An insurance certificate in compliance with provisions of item 31 (insurance) of the general conditions of purchase is required for comprehensive general liability, automobile liability, and workers' compensation and must be submitted by the successful bidder(s) to the division of purchases prior to award. The insurance certificate must name the state of Rhode Island as certificate holder and as an additional insured. Failure to comply with these provisions may result in rejection of the offeror's bid. Annual renewal certificates must be submitted to the agency identified on the purchase order. Failure to do so may be grounds for cancellation of contract.

Note: If this bid covers construction, school busing, hazardous waste, or vessel operation, applicable coverages from the following list must also be submitted to the division of purchases prior to award: * professional liability insurance (aka errors & omissions) - \$1 million or 5% of estimated project cost, whichever is greater. * builder's risk insurance - coverage equal to face amount of contract for construction. * school busing - auto liability coverage in the amount of \$5 million. * environmental impairment (aka pollution control) - \$1 million or 5% of face amount of contract, whichever is greater. * vessel operation - (marine or aircraft) - protection & indemnity coverage required in the amount of \$1 million.



ADDENDUM #4 (continued)

LICENSE

Vendor (owner of company) is responsible to comply with all licensing or state permits required for this type of service. A copy of license/permit should be submitted with this bid. In addition to these license requirements, bidder, by submission of this bid, certifies that any/all work related to this bid, and any subsequent award which requires a Rhode Island license(s), shall be performed by an individual(s) holding a valid Rhode Island license.



INVITATION TO BID

Purchaser: The Rhode Island Department of Administration, Division of Purchases
One Capitol Hill, Providence, RI 02908-5855

Owner/Agent: The Rhode Island State Police
311 Danielson Pike, Scituate, RI 02857

Architect: Crossman Engineering
151 Centerville Road
Warwick, Rhode Island 02886
Tel. 401-738-5660 Fax: 401-738-8157

Project: Rhode Island State Police Headquarters Parking Improvements,
311 Danielson Pike, Scituate, RI 02857

Completion Time: Twenty working days from Purchase Order issued by Central Purchasing.

General Contractors are invited to submit sealed bids on the above Project, to the Purchaser at the above address, on or before:

Time: 2:00 PM EDT Date: Thursday, June 13, 2013

Note: Complete details of the scope of work are available in a download at the Rhode Island Division of Purchases website at www.purchasing.ri.gov (labeled with the date of this Solicitation Information document), which includes the Project Drawings and Project Manual.

Bidder is required to provide a Bid Security in the form of a Bid Bond, or a certified check payable to the **State of Rhode Island**, in the amount of a sum no less than five percent (5%) of the Bid Price.

Refer to "Instructions to Bidders" for other Bidding Requirements.

Bidders' attention is referred to State requirements pertaining to conditions of employment to be observed, including the Equal Employment Opportunity Act and requirements that 10 percent of the dollar value of the work must be performed by Minority Business Enterprises, and wage rates to be paid under the Contract for this project must be in accordance with those prevailing wages on file in the Rhode Island Department Of Labor, Office of the Director, and included in this Project Manual. Bidders are subject to terms, conditions and provisions of State's General Conditions of Purchase, and to the provisions of Chapters 2, 12, 13 and 14.1 of Title 37, General Laws of the State of Rhode Island 1956, as amended.

The Office of Purchases reserves the right to accept or reject any or all Bids.

George Welly, Interdepartmental Project Manager

END OF DOCUMENT

State of Rhode Island



**Department of Administration
Division of Purchases
One Capitol Hill
Providence, RI 02908**

**REQUEST FOR QUOTE (RFQ) - Bid #7464395
RI STATE POLICE HQ PARKING IMPROVEMENTS**

ADDENDUM #4 (continued)

**Exhibit (A)
Addendum 2
May 20, 2013**



Solicitation Information

RFQ #7464395

Date: May 20, 2013

Title: Rhode Island State Police HQ Parking Improvements

Closing Date and Time: May 28, 2013 at 11:30 am Local Prevailing Time

ADDENDUM # 2

Notice to Vendors:

Attached are vendor questions with state responses.

No additional questions will be answered.

Attachments to this Addendum:

1. Additional Specification Sections: Hot Mix Asphalt 9.5 and 12.5
2. C2 : Revised Site Layout Plan

Question 1. Who do we contact at State Police to arrange a site visit?

A. A non-mandatory site visit has been scheduled for 11:00 AM on Wednesday, May 22, 2013 at the State Police Headquarters in Scituate, please refer to Addendum One to this RFQ on the Purchasing website.

Question 2 . In the project specs, there is no indication that there will be a price adjustment for liquid asphalt, but in the bid sheets, there is no place to make that adjustment. Which is it?

A. There shall be no liquid asphalt and diesel fuel price adjustment for this project.

Question 3. The specs for the base course for this job call for a 12.5 millimeter asphalt mix for the base course, but that is not consistent with the state standard of 19 millimeters. That is the old state Class One. Can 19 mm superpave be substituted for 12.5 mm base course?

A. The proposed pavement structure as referenced on the plans will be the pavement used for this project, no substitutions will be accepted. Supplemental Specifications for Hot Mix Asphalt 9.5 and 12.5 are included in this addendum.

Question 4. Testing for asphalt mixes at the asphalt plant are specified, But who will do that, the project engineer? This conflicts with the current specs for supermix paving.

A. Testing will be the responsibility of the Division of Capital Projects and Property Management.

Question 5. There is language on page nine of the RFQ in the last paragraph concerning technical reviews. What does that mean?

A. This language is deleted. Please refer to Addendum One to this RFQ on the Purchasing website for exact wording for the deleted language.

Question 6. There is language in the solicitation talking about minority business enterprise participation. Is that applicable to the full scope of the job?

A. That is a goal. The successful bidder will be required to work with the MBE Administrator to achieve this goal. The MBE office is available at (401) 574-8253.

Question 7. What are the project work hour limitations?

A. The work hours are in the project manual see section 010000 - 4 subsection 1.12.

Question 8. In section 000410 Bid Form on page 2 of 10 under #2 Allowances there is section 2.2 and 2.3 that both refer to trench excavation. Please indicate the location of the trench excavation that these allowances are referencing.

A. The Allowance was established for the purposes of unforeseen Conditions incase Trench Excavation is necessary, at this time exact locations are not known.

Question 9. Starting on page 3 of 10 under #5 Unit Prices there are a total of 54 items of work. Please provide the location and quantity for each item listed.

A. The Purpose of the Unit Prices is to verify requisitions and if a change in scope of work is required due to unforeseen conditions, the Divisions of Purchases and Capital Projects has a unit cost from the Successful Vendor for the work need to be completed.

Question 10. Drawing number C-2 indicates trees to be transplanted. Where are the locations for the transplanted trees?

A. See attached Revised C-2 Drawing.

Question 11. Drawing number C-3 shows a detail for loam – seed. The note on this detail indicates the contractor is responsible to water these areas for one year. Can this time requirement be shortened?

A. No the Project should be bid as indicated.

HOT MIX ASPHALT CLASS 9.5

DESCRIPTION:

Hot Mix Asphalt-Class 9.5 shall conform to the requirements of the Specifications as noted in the Contract Documents, including Section 401 Dense Graded Bituminous Pavements, with the following exceptions and modifications.

MATERIALS:

1. Aggregate

The aggregate shall conform to the 3 to <10 million ESAL requirements of Table 5 in AASHTO M 323. No more than 10% of the aggregate shall be natural sand. All aggregate properties of Section M.03 shall apply.

2. Performance Graded Binder

The binder shall meet the requirements of PG 64-28, Grade S as specified in AASHTO M 320 and MP 19.

3. Mix Design

HMA mixes shall conform to AASHTO M 323, "Standard Specification for Superpave Volumetric Mix Design". The design procedure shall follow AASHTO R 35 "Standard Practice for Superpave Volumetric Design for Hot-Mix Asphalt (HMA)". The design specifications found in AASHTO M 323 shall supersede those found in the Standard Specifications. A mix design using PG 64-28 Grade S shall be used to determine the design binder content. The following specific requirements and exceptions to AASHTO M 323 shall apply.

- a. N_{initial} shall be 6, N_{design} shall be 50 and N_{max} shall be 75 gyrations.
- b. A moisture susceptibility test will not be required.
- c. The mix shall be designed at 4% voids.
- d. The VMA shall be greater than or equal to 16.5%.
- e. The VFA shall be 70 to 80 percent.
- f. The mix shall be coarse graded as defined in Section 6.1.3 of AASHTO M 323.
- g. The dust to binder ratio ($P_{0.075}/P_{be}$) shall be 0.5 – 1.0. The design effective binder content shall be used to calculate this ratio.

- h. No RAP will be allowed in the mix.
- i. In addition to the sieves listed in Table 3 of AASHTO M 323, the 0.600 mm, 0.300 mm and 0.150 mm sieves will be required. The 50.0 mm and 37.5 mm sieves will not be required.

The following procedures shall be adhered to for the mix design:

- Three trial blends shall be submitted and accepted before beginning the mix design procedure.
- All trial mixture data and calculations determined for Section 9 of AASHTO R 35 shall be submitted to the Engineer. The Engineer will determine which trial mixture shall be used for the mix design procedure.
- After the mix design is completed it shall be submitted to the Engineer for acceptance.

The gyratory cores and Rice (AASHTO T 209) samples at the design binder content shall be submitted to the Engineer.

A successful plant trial batch shall be performed before production of the HMA begins.

CONSTRUCTION METHODS:

1. Plant Laboratory

In addition to the requirements of Section 930 of the Rhode Island Department of Transportation Standard Specifications for Road and Bridge Construction 2004 Edition and latest addenda, the contractor provided lab shall be equipped with the following:

Gyratory compactor conforming to AASHTO T 312 and two molds.

All equipment required to determine the theoretical maximum specific gravity in accordance with AASHTO T 209 Test Method A and Section 13.1. A metal pycnometer and electronic digital vacuum gauge shall also be provided.

All sieves required for the mix design process.

Facilities and equipment to perform a wet-wash in accordance with AASHTO T-30 and a faucet spray hose shall be provided.

2. Mix Production

Samples will be taken at the plant every 600 tons. The following mix production tolerances shall apply:

- a. The air voids (V_a) shall be 3.0 – 5.0 percent.
- b. The voids in mineral aggregate (VMA) shall be 16.5% minimum.

The following tolerances for gradation shall apply:

12.5mm	100%
9.5mm	90% - 100%
4.75mm	90% max
2.36mm	Established by the mix design $\pm 5\%$
0.075mm	Greater than or equal to 2.0%

In-place density shall be 92% of the theoretical maximum density obtained at the plant.

- 3. The Contractor is responsible for providing testing samples at the plant. Testing at the plant will not be conducted by the Engineer.

HOT MIX ASPHALT CLASS 12.5

DESCRIPTION:

Hot Mix Asphalt-Class 12.5 shall conform to the requirements of the Specifications as noted in the Contract Documents, including Section 401 Dense Graded Bituminous Concrete Pavements, with the following exceptions and modifications.

MATERIALS:

1. Aggregate

The aggregate shall conform to the 3 to <10 million ESAL requirements of Table 5 in AASHTO M 323. No more than 10% of the aggregate shall be natural sand. All aggregate properties of Section M.03 shall apply.

2. Performance Graded Binder

The binder shall meet the requirements of PG 64-28, Grade S as specified in AASHTO M 320 and MP 19.

3. Mix Design

HMA mixes shall conform to AASHTO M 323, "Standard Specification for Superpave Volumetric Mix Design". The design procedure shall follow AASHTO R 35 "Standard Practice for Superpave Volumetric Design for Hot-Mix Asphalt (HMA)". The design specifications found in AASHTO M 323 shall supersede those found in the Standard Specifications. A mix design using PG64-28 Grade S shall be used to determine the design binder content. The VMA and $VMA_{\text{effective}}$ shall be calculated for each asphalt content during the mix design process. The following specific requirements and exceptions to AASHTO M 323 shall apply.

- a. N_{initial} shall be 6, N_{design} shall be 50 and N_{max} shall be 75 gyrations.
- b. A moisture susceptibility test will not be required.
- c. The mix shall be designed at 4% voids.
- d. The VMA shall be greater than or equal to 15.5%.
- e. The VFA shall be 70 to 80 percent.
- f. The mix shall be coarse graded as defined in Section 6.1.3 of AASHTO M 323.

- g. The dust to binder ratio ($P_{0.075}/P_{be}$) shall be 0.5 – 1.0. The design effective binder content shall be used to calculate this ratio.
- h. No RAP will be allowed in the mix.
- i. In addition to the sieves listed in Table 3 of AASHTO M 323, the 0.600 mm, 0.300 mm and 0.150 mm sieves will be required. The 50.0 mm and 37.5 mm sieves will not be required.

The following procedures shall be adhered to for the mix design:

- Three trial blends shall be submitted and accepted before beginning the mix design procedure.
- All trial mixture data and calculations determined for Section 9 of AASHTO R 35 shall be submitted to the Engineer. The Engineer will determine which trial mixture shall be used for the mix design procedure.
- After the mix design is completed it shall be submitted to the Engineer for acceptance.

The gyratory cores and Rice (AASHTO T 209) samples at the design binder content shall be submitted to the Engineer.

A successful plant trial batch shall be performed before production of the HMA begins.

CONSTRUCTION METHODS:

1. Plant Laboratory

In addition to the requirements of Section 930 of the Rhode Island Department of Transportation Standard Specifications for Road and Bridge Construction 2004 Edition and latest addenda, the contractor provided lab shall be equipped with the following:

- Gyratory compactor conforming to AASHTO T 312 and two molds.
- All equipment required to determine the theoretical maximum specific gravity in accordance with AASHTO T 209 Test Method A and Section 13.1. A metal pycnometer and electronic digital vacuum gauge shall also be provided.
- All sieves required for the mix design process.
- Facilities and equipment to perform a wet-wash in accordance with AASHTO T-30 and a faucet spray hose shall be provided.

2. Mix Production

Samples will be taken at the plant every 600 tons. The following mix production tolerances shall apply:

- a. The air voids (V_a) shall be 3.0 – 5.0 percent.
- b. The voids in mineral aggregate (VMA) shall be 15.5% minimum.
- c. The percent passing the #200 sieve shall be 2.0% minimum.

The following tolerances for gradation shall apply:

19.0mm	100%
12.5mm	90% - 100%
9.5mm	90% max
2.36mm	Established by the mix design $\pm 5\%$
0.075mm	Greater than or equal to 2.0%

In-place density shall be 92% of the theoretical maximum density obtained at the plant.

- 3. The Contractor is responsible for providing testing samples at the plant. Testing at the plant will not be conducted by the Engineer.

NEW PAVEMENT STRUCTURE
 1 1/2" BITUMINOUS SURFACE COURSE
 3" BITUMINOUS BASE COURSE
 8" GRAVEL BORROW SUBBASE

GRADING NOTE

THE NORTHERLY AND EASTERLY NEW PARKING AREAS ARE TO BE CONSTRUCTED TO DRAIN TOWARDS THE EXISTING DRIVE AISLE AND ARE TO BE SLOPED BETWEEN 1% MIN. - 2% MAX.

NOTES

1. CONTRACTOR SHALL USE CAUTION WHEN WORKING NEAR EXISTING LIGHT POLES NEAR THE NEW NORTHERLY PARKING AREAS.
2. CONTRACTOR TO SAWCUT EXISTING CURB IF PROPOSED CURB DOES NOT MATCH AT AN EXISTING JOINT.
3. ALL STRIPING TO HAVE 2 (TWO) APPLICATIONS.

PLAN REVISIONS FOR ADDENDUM No. 1

- GRASS SWALE ELIMINATED - PROPOSED SOUTHERLY PARKING AREA
- LOCATION OF TREES TO BE TRANSPLANTED - PROPOSED SOUTHERLY AND EASTERLY PARKING AREAS
- NOTES ADDED TO USE SMALL EQUIPMENT AND/OR HAND DIG IN AREAS OF EXISTING UTILITIES AND GUARDRAIL POST INSTALLATION - PROPOSED NORTHERLY AND SOUTHERLY PARKING AREAS
- GRADE TO DRAIN ARROWS ADDED - ALL PROPOSED PARKING AREAS
- SAWCUT NOTE ADDED
- PAVEMENT STRIP APPLICATION NOTE ADDED
- R.I. STD. 8.1.0 ELIMINATED FROM SHEET C3 (REMOVED FROM PROJECT SCOPE)

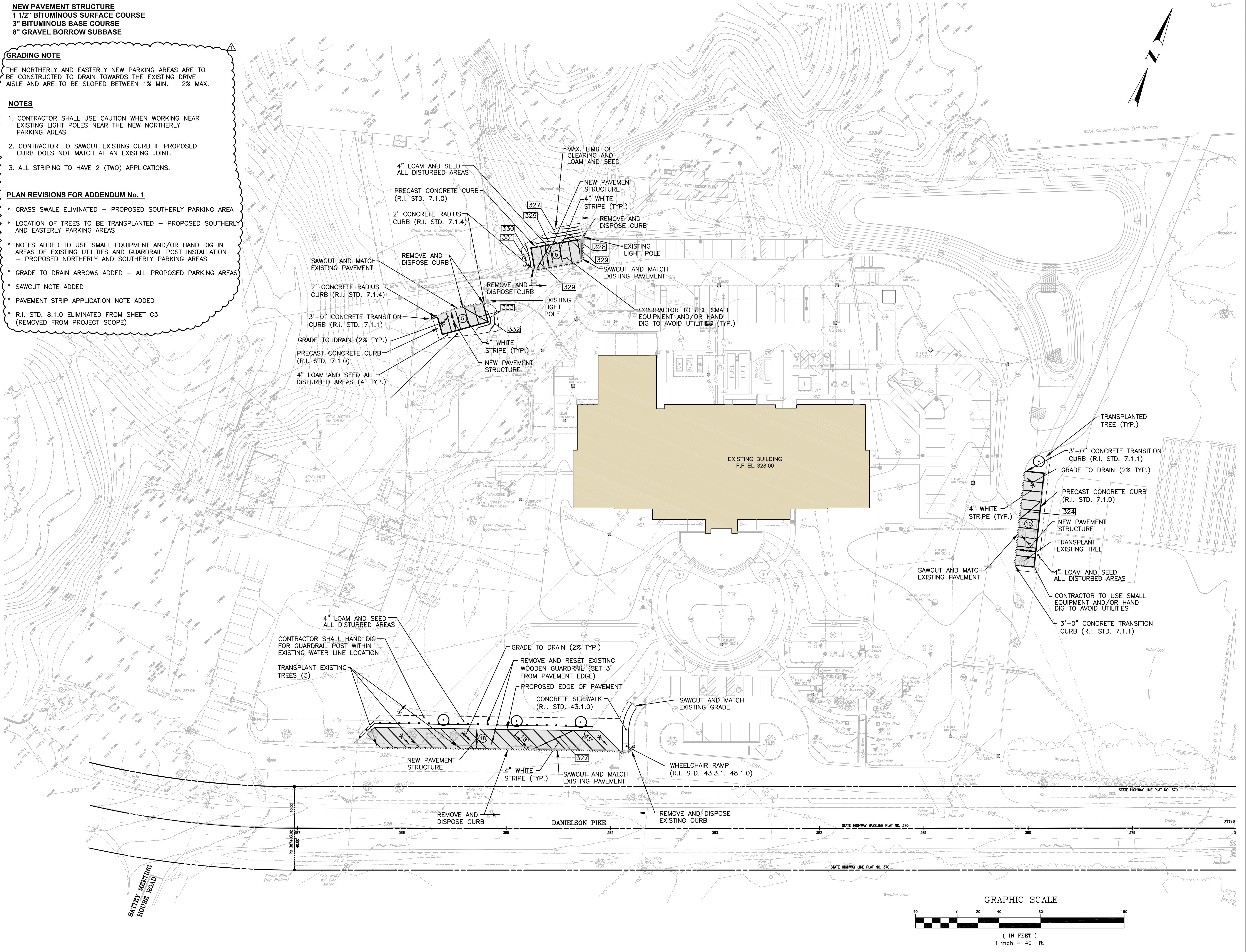

KEY PLAN

PROPOSED PARKING IMPROVEMENTS

RHODE ISLAND STATE POLICE HEADQUARTERS
 311 DANIELSON PIKE
 NORTH SCITUATE, RHODE ISLAND

PREPARED FOR:
RHODE ISLAND DEPARTMENT OF ADMINISTRATION
 DIVISION OF CAPITAL PROJECTS and PROPERTY MANAGEMENT
 ONE CAPITOL HILL
 PROVIDENCE, RI 02908-5859

DRAWING TITLE:
SITE LAYOUT PLAN

DATE: MAY 2013 SCALE: 1"=40'

DWG. NAME: 1852.20-C02-SITE-R1.dwg

REVISIONS

NUMBER	REMARKS	DATE
1	ADDENDUM No. 1	05/17/13